

# Past Symmetries

Concept 1 - Low Budget

**Program concept:** Acceptance is radical, recollection is dramatic. Theater holds a mirror up to our lives and our decisions, this courtyard does the same. The scars of the past fulfil this design concept as the existing orthogonal sculptures remain. We embrace the inescapable symmetry of the courtyard and relish a return to the original color palette. Intuitively whole and cognitively honest, *Past Symmetries* unites - rather than overrules - forgotten decisions. This design encourages students, actors, and visitors to see - rather than overlook - the space they occupy.

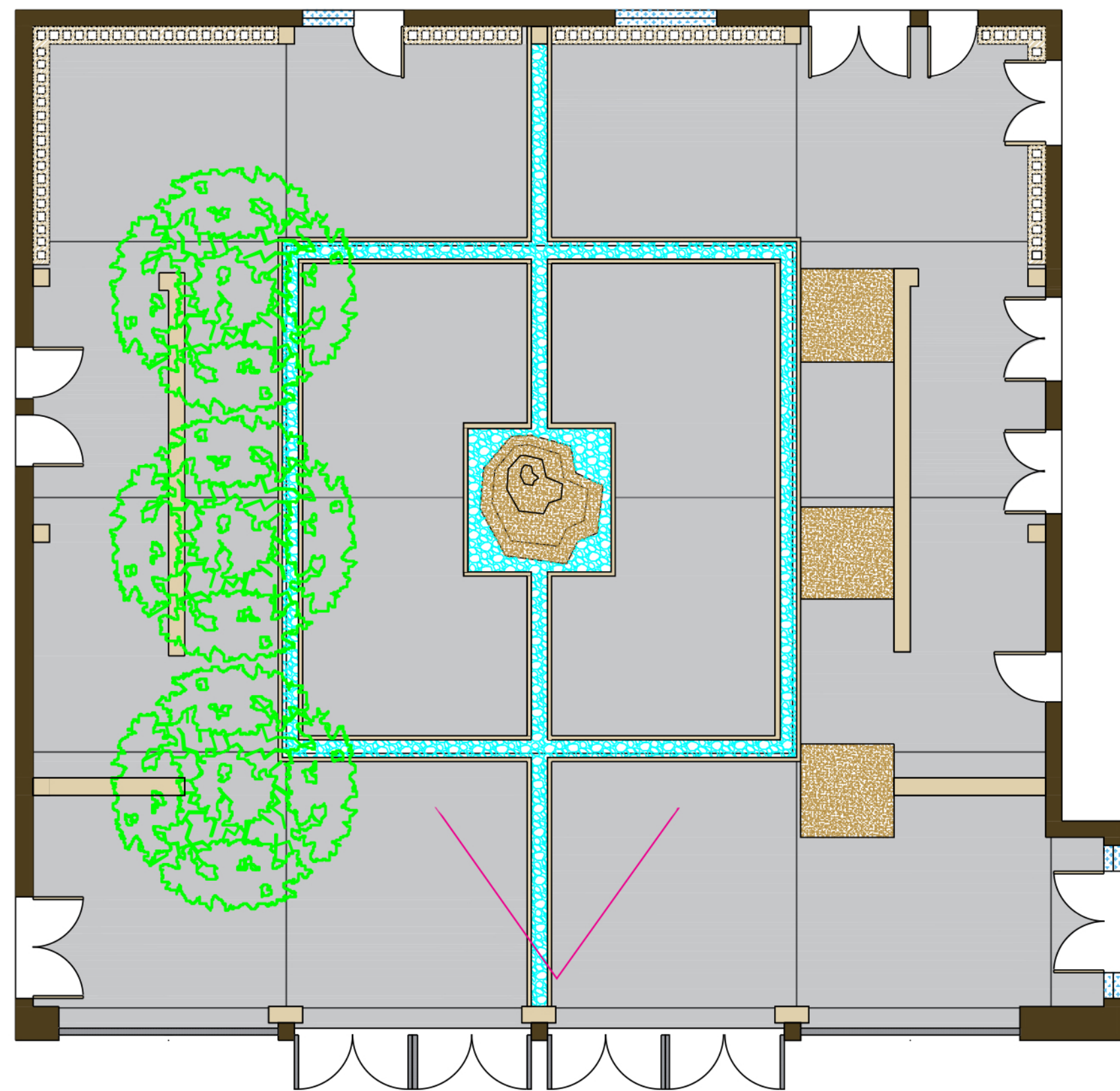
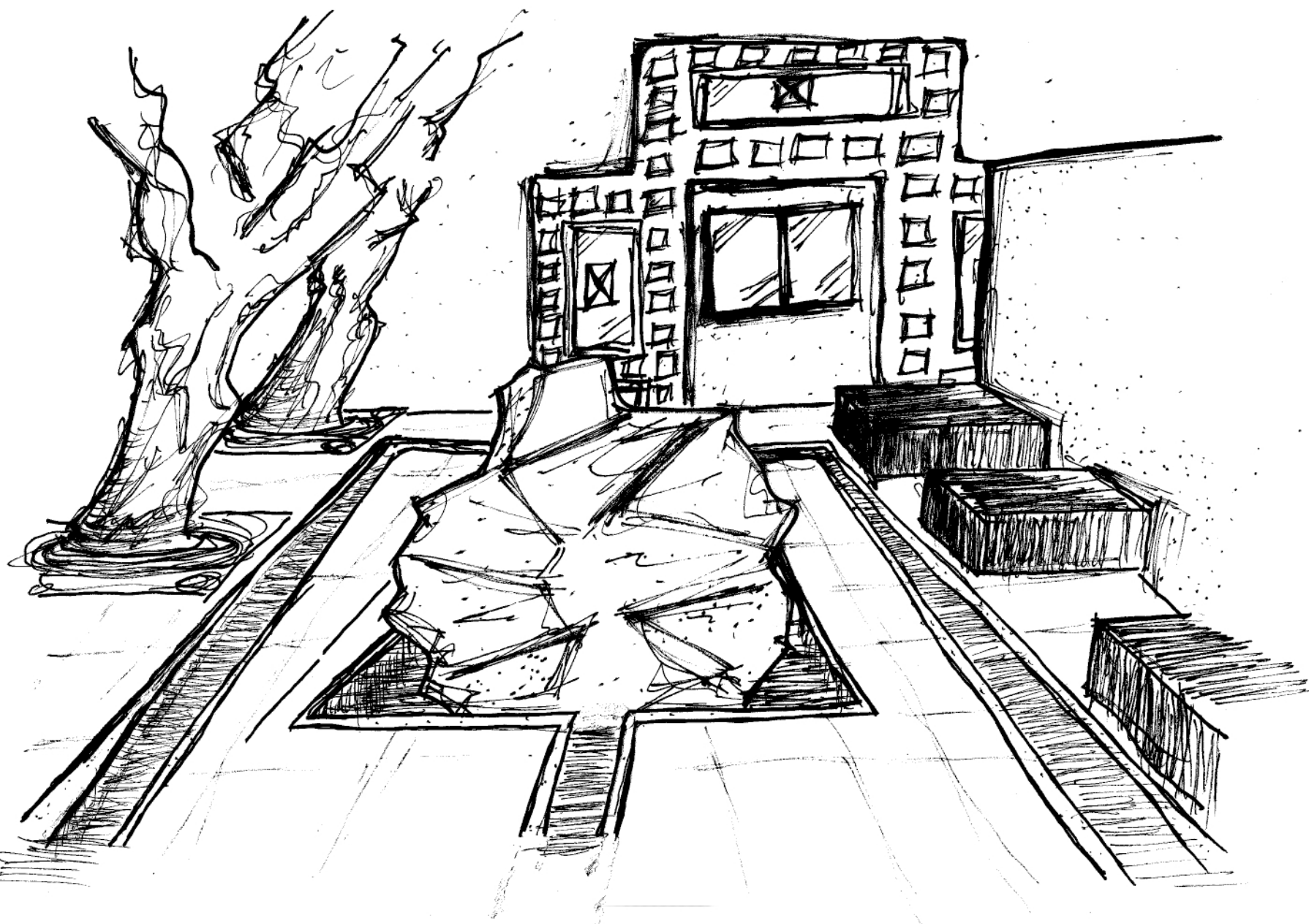

# Blurred Boundaries

Concept 2 - Mid Budget

**Program concept:** Macgowan Hall lacks a sense of place, the Murphy Sculpture Garden provides one. The Courtyard of Theaters faces sculptures that perform a silent play across undulations in the landscape. Concept 2 brings these characters into the courtyard, intentionally eroding the boundaries between the beloved Sculpture Garden and our existing space. The iconic brise soleil remains a core part of *Blurring Boundaries* to shroud this new corner of the MSG in mystique. The skylight is widened to counter the sense of enclosure. The skylight is widened to counter the sense of enclosure.

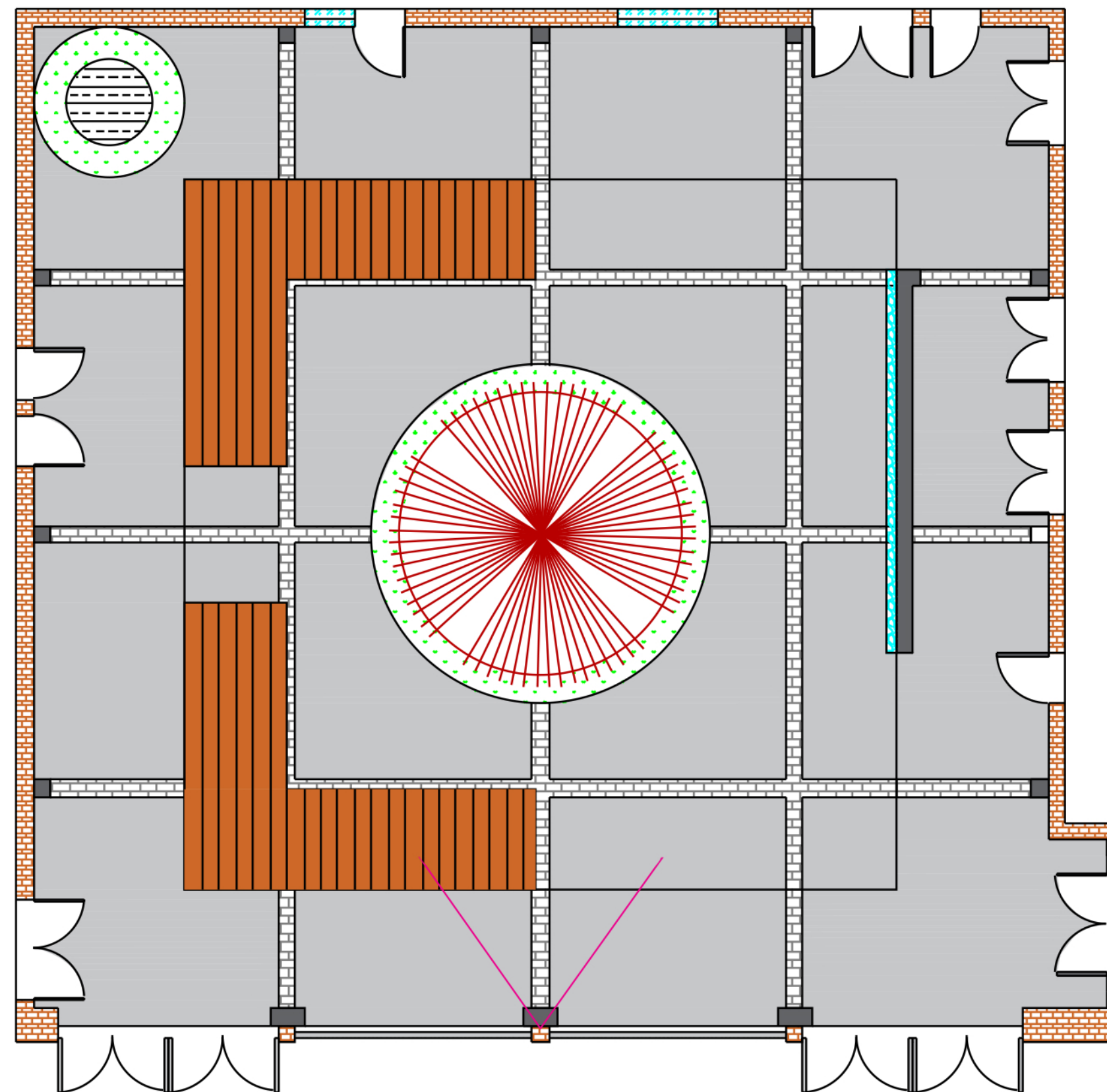
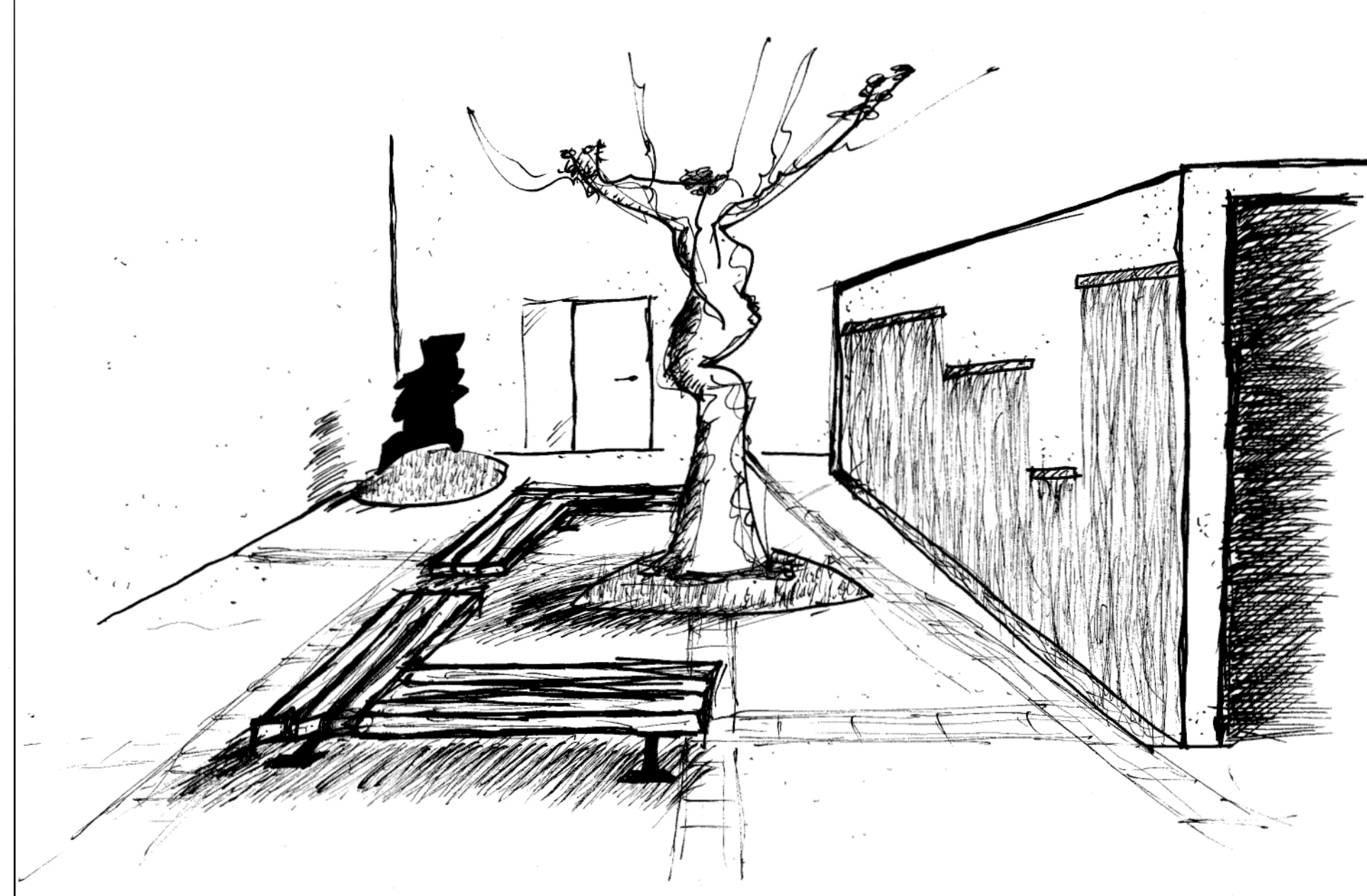

# Destination Theater

Concept 3 - High Budget

**Program concept:** Concept 3 promotes our courtyard as a space worthy of the world-renowned institution that houses it. In this design concept, students and actors take pride in the space - they could rehearse and study among the naturalistic plantings on the ground floor. Visitors from accros the city would enjoy the second-story bar among the palm canopy. Meanwhile, the sense of confinement remains, ensuring our courtyard retains a personal/exclusive feel - a jewel in the crown of the UCLA Theater department.

Ground Floor

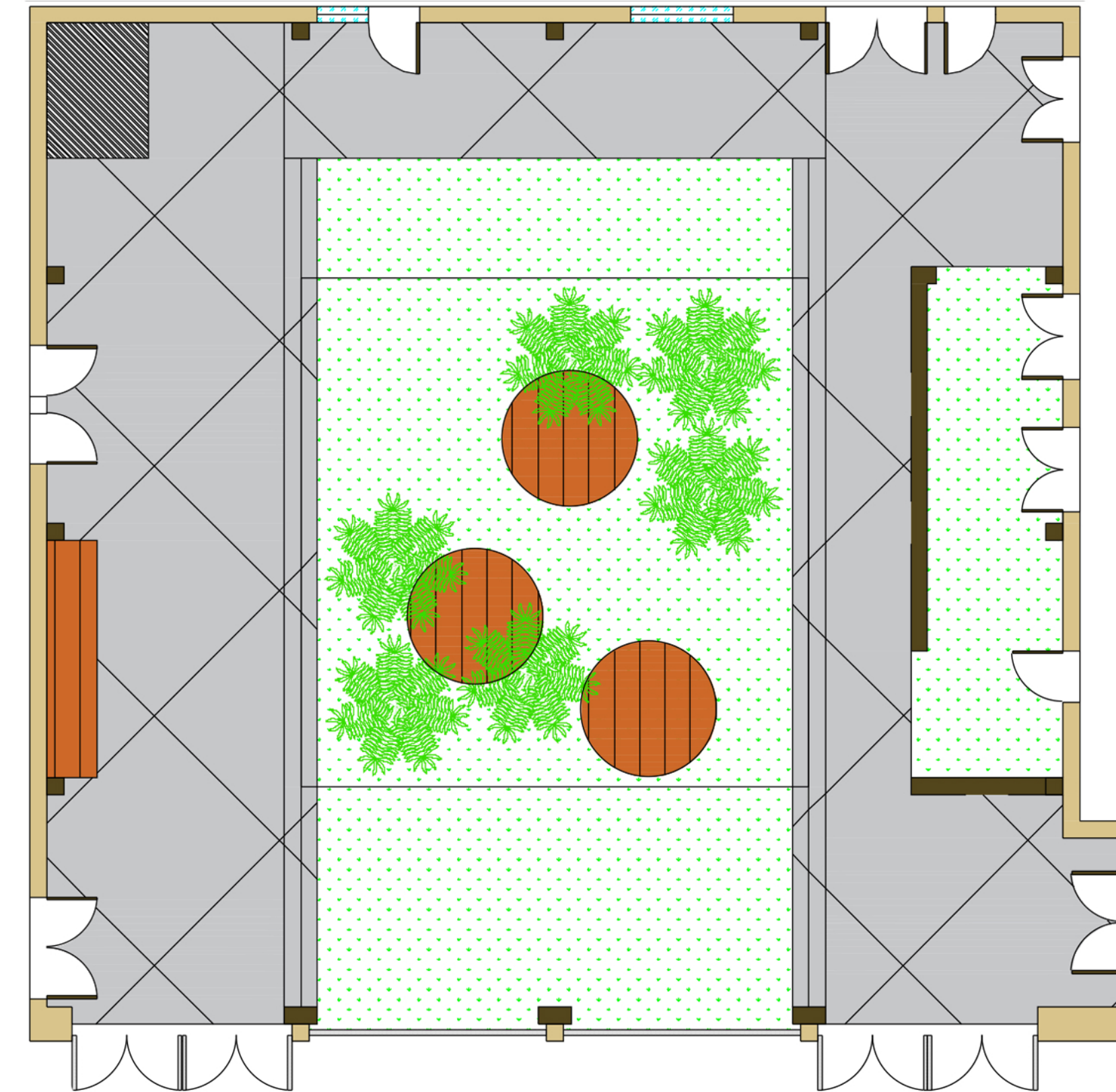

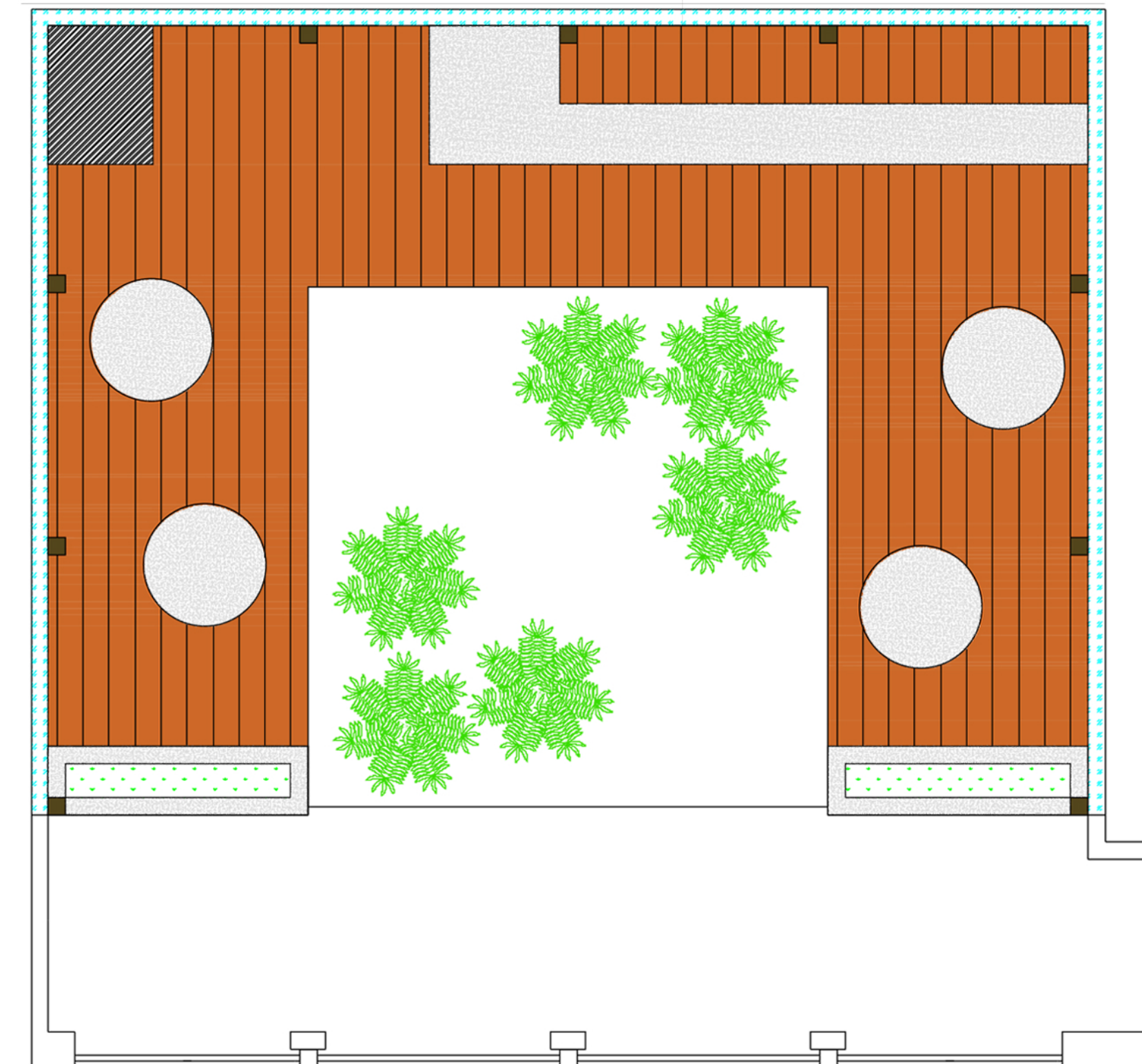

First Floor

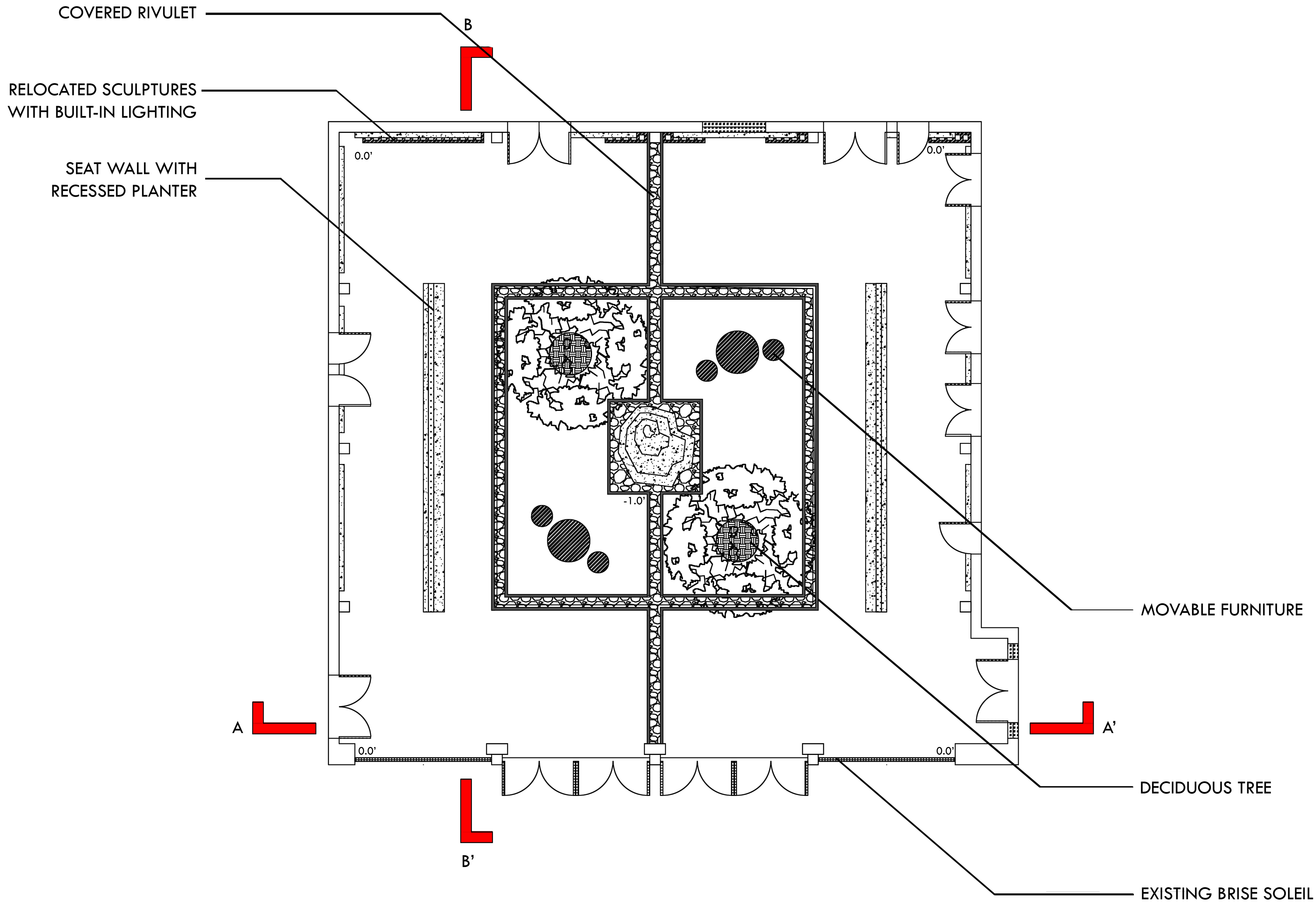

STUDENT NAME: Tom Hurst	
COURSE: LD1	
INSTRUCTOR: Steven Chavez	
SITE NAME AND ADDRESS: Macgowan Hall UCLA Campus 245 Charles E Young Dr., Los Angeles, CA, 90095	
DRAWING TITLE: THREE DESIGN ALTERNATIVES	
AERIAL IMAGE: 	
<p><b>Legend</b></p> <ul style="list-style-type: none"> <li><span style="display: inline-block; width: 10px; height: 10px; background-color: #cccccc; border: 1px solid black; margin-right: 5px;"></span> Pavers</li> <li><span style="display: inline-block; width: 10px; height: 10px; background-color: #d9ead3; border: 1px solid black; margin-right: 5px;"></span> Stone</li> <li><span style="display: inline-block; width: 10px; height: 10px; background-color: #cfe2f3; border: 1px solid black; margin-right: 5px;"></span> Water</li> <li><span style="display: inline-block; width: 10px; height: 10px; background-color: #f4cccc; border: 1px solid black; margin-right: 5px;"></span> Elevator</li> <li><span style="display: inline-block; width: 10px; height: 10px; background-color: #f4cccc; border: 1px solid black; margin-right: 5px;"></span> Brick</li> <li><span style="display: inline-block; width: 10px; height: 10px; background-color: #d9ead3; border: 1px solid black; margin-right: 5px;"></span> Planted Area</li> <li><span style="display: inline-block; width: 10px; height: 10px; background-color: #f4cccc; border: 1px solid black; margin-right: 5px;"></span> Wood</li> <li><span style="display: inline-block; width: 10px; height: 10px; background-color: #cfe2f3; border: 1px solid black; margin-right: 5px;"></span> Glass</li> <li><span style="display: inline-block; width: 10px; height: 10px; background-color: #f4cccc; border: 1px solid black; margin-right: 5px;"></span> Statue</li> <li><span style="display: inline-block; width: 10px; height: 10px; background-color: #f4cccc; border: 1px solid black; margin-right: 5px;"></span> Brise Soleil</li> <li><span style="display: inline-block; width: 10px; height: 10px; background-color: #f4cccc; border: 1px solid black; margin-right: 5px;"></span> Metal</li> <li><span style="display: inline-block; width: 10px; height: 10px; background-color: #f4cccc; border: 1px solid black; margin-right: 5px;"></span> Deciduous Tree</li> <li><span style="display: inline-block; width: 10px; height: 10px; background-color: #f4cccc; border: 1px solid black; margin-right: 5px;"></span> Palm</li> </ul>	
NORTH ARROW: 	
SCALE BAR: 0 4 8 16'-0"	
DRAWING SCALE: 1/8" = 1'-0"	
SHEET NUMBER: L-1	SHEET NUMBER IN SET: 1 of 4

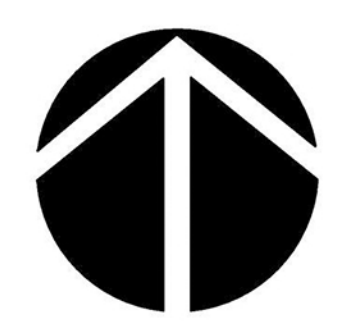

STUDENT NAME: Thomas Hurst	
COURSE: LD1	
INSTRUCTOR: Steven Chavez	
SITE NAME AND ADDRESS: Macgowan Hall UCLA Campus 245 Charles E Young Dr., Los Angeles, CA, 90095	
DRAWING TITLE: SITE PLAN	
AERIAL IMAGE: 	
CONCEPT STATEMENT: <b>Past Symmetries</b> corrects two key issues in Macgowan Hall: circulation and balance. These issues are corrected by relocating primary access points to the center of the brise soleil, duplicating the existing vestibule, and introducing an orthogonal water feature. This design mirrors the existing site structure to define paths of circulation with minimal intervention. Balance is restored by emphasizing symmetrical planes around a central plaza. Iconic aspects of the existing design remain, including the box office window and sculptures along the rear wall.	
NORTH ARROW: 	
SCALE BAR: 0 2 4 8'-0" 	
DRAWING SCALE: 1/4" = 1'-0"	
SHEET NUMBER: L-2	SHEET NUMBER IN SET: 2 of 4

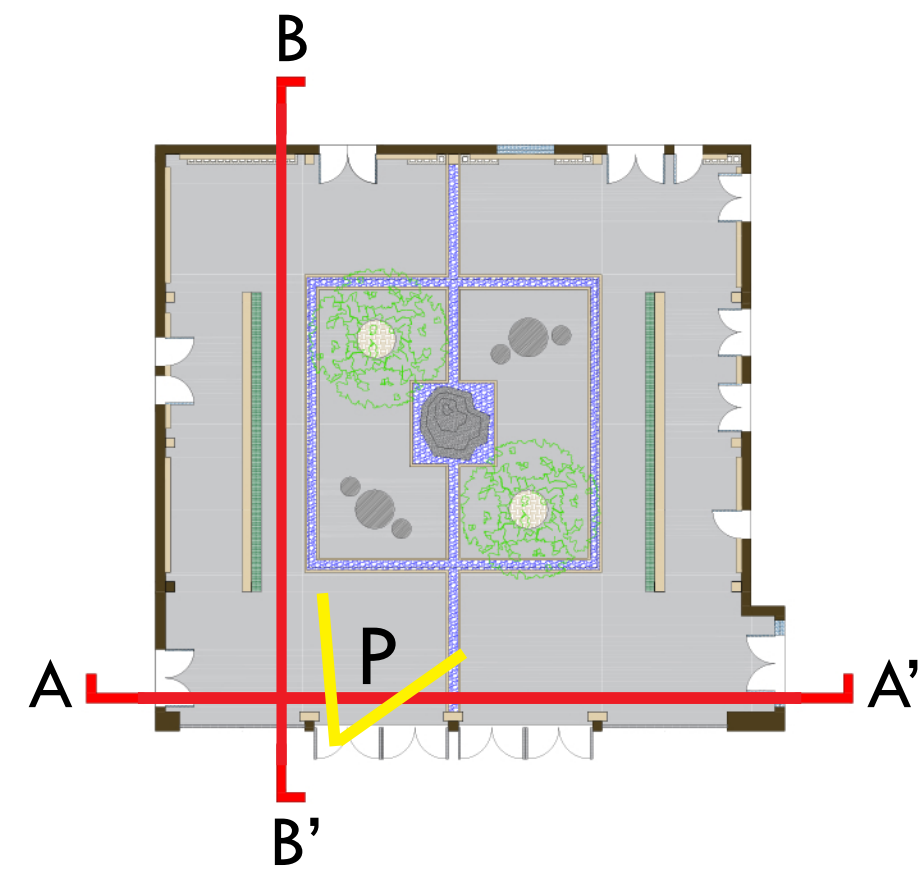

P

NTS



A

A'

SEASONAL  
STORMWATER  
FEATURE

BOX OFFICE

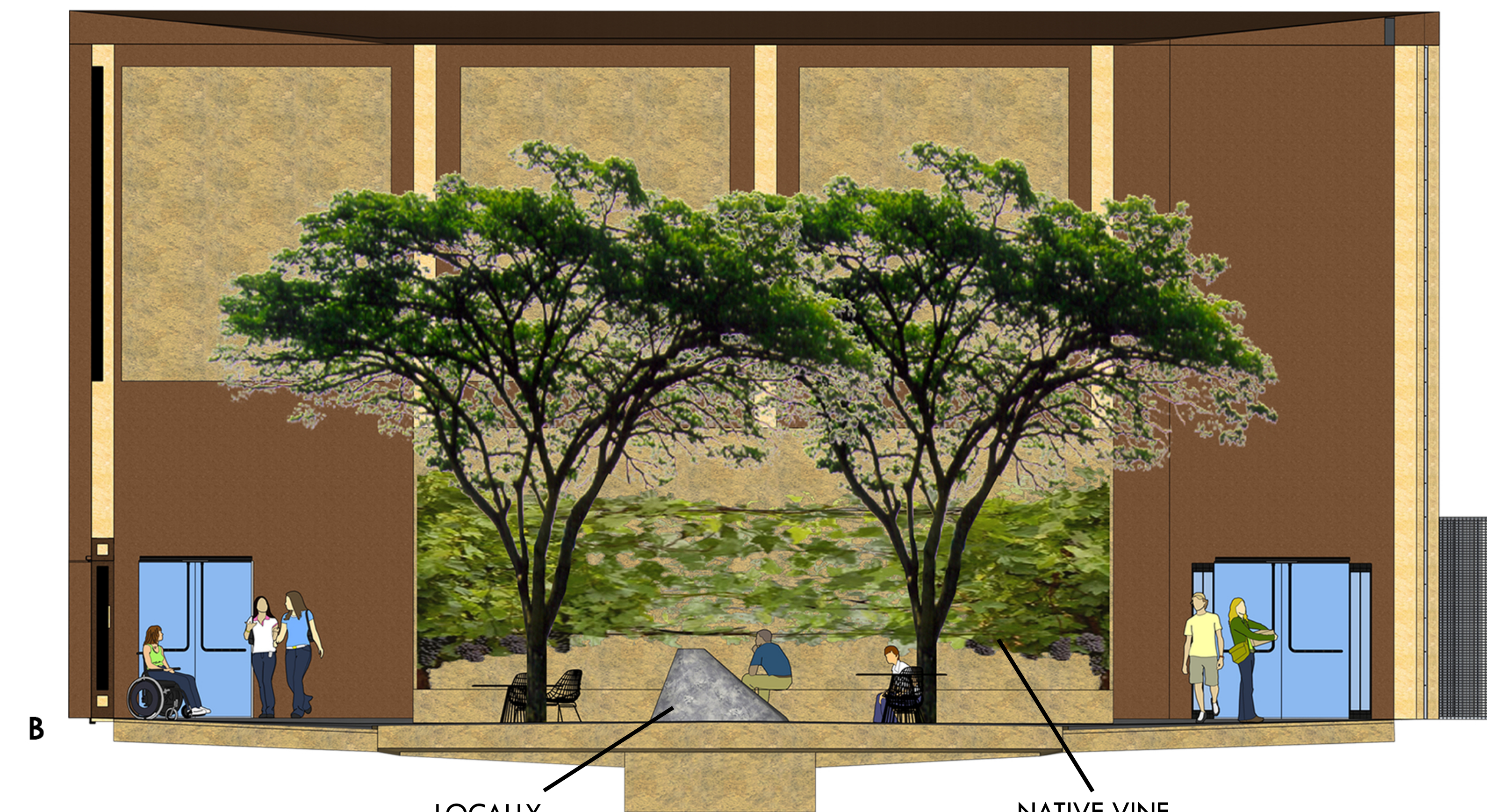

B

B'

LOCALLY  
SOURCED  
BOULDER

NATIVE VINE

STUDENT NAME:

Tom Hurst

COURSE:

LD1

INSTRUCTOR:

Steven Chavez

SITE NAME AND ADDRESS:

Macgowan Hall  
UCLA Campus  
245 Charles E Young Dr.,  
Los Angeles, CA, 90095

DRAWING TITLE:

SITE SECTIONS AND  
PERSPECTIVE

AERIAL IMAGE:

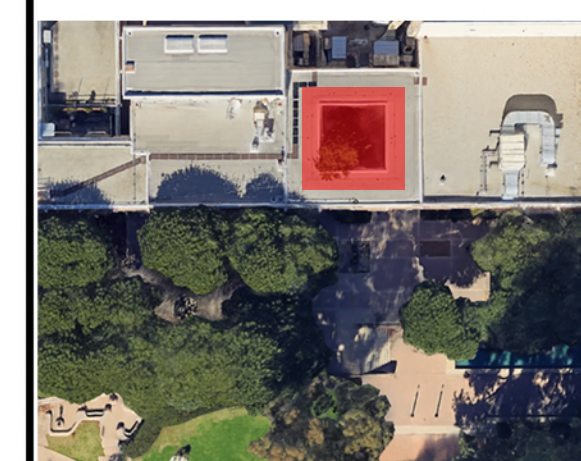

DRAINAGE AND MATERIALS:

Roof drains into seasonal stormwater feature. High points of ground floor are consistent along the interior perimeter of the site.

Natural elements are chosen to reflect the history and conditions of Los Angeles e.g. limestone boulder, clematis ligusticifolia, fraxinus dipetala.

Flagstone paving contrasts symmetry of the site. Existing cast-in-place concrete walls and protrusions remain.

NORTH ARROW:



SCALE BAR:

0 2 4 8'-0"

DRAWING SCALE:

1/4" = 1'-0"

SHEET NUMBER:

L-3

SHEET NUMBER IN SET:

3 of 4

