

PROJECT BY PATRESE WINTER
LED BY STEVEN CHAVEZ
LDG: CONCEPT DEVELOPMENT | SUMMER 2025



THE GREAT WALL OF LOS ANGELES PARK MASTER PLAN



TON FOREBEARS OF CIVIL RIGHTS GAY RIGHTS DAUGHTERS OF BILITIS MATTACHINE SOCIETY GINSBERG & TH

UCLA Extension
LANDSCAPE ARCHITECTURE

TABLE OF CONTENTS

A creative journey in three acts—**Laying the Groundwork (Pre-Design)**, **Designing the Vision (Design Development)** and **Building the Dream (Final Designs)**—this project brings history, community, and imagination together to reimagine the park around the Great Wall of Los Angeles.



LAYING THE GROUNDWORK

03 | OVERVIEW

04 | HISTORY

05 | CONTEXT + INVENTORY

06 | SITE ANALYSES

09 | SITE CONSTRAINTS

10 | SITE OPPORTUNITIES

11 | CASE STUDY 1

12 | CASE STUDY 2

13 | CASE STUDY 3



DESIGNING THE VISION

14 | THREE CONCEPT PARTI DIAGRAM

15 | DESIGN ALTERNATIVE 1

16 | DESIGN ALTERNATIVE 2

17 | DESIGN ALTERNATIVE 3

18 | MASTER PLAN CONCEPT



BUILDING THE DREAM

19 | MASTER PLAN

20 | ENLARGEMENTS

24 | SECTION ELEVATIONS

25 | PERSPECTIVES

27 | MODEL

31 | WALK TROUGH VIDEO

32 | FINAL THOUGHTS

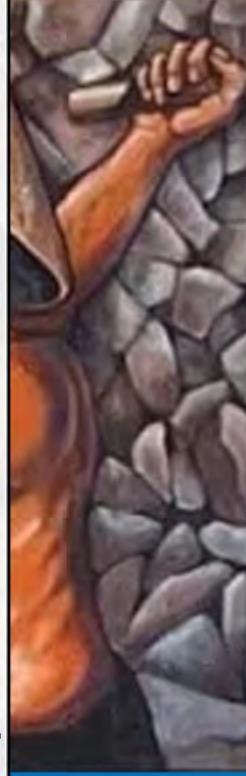

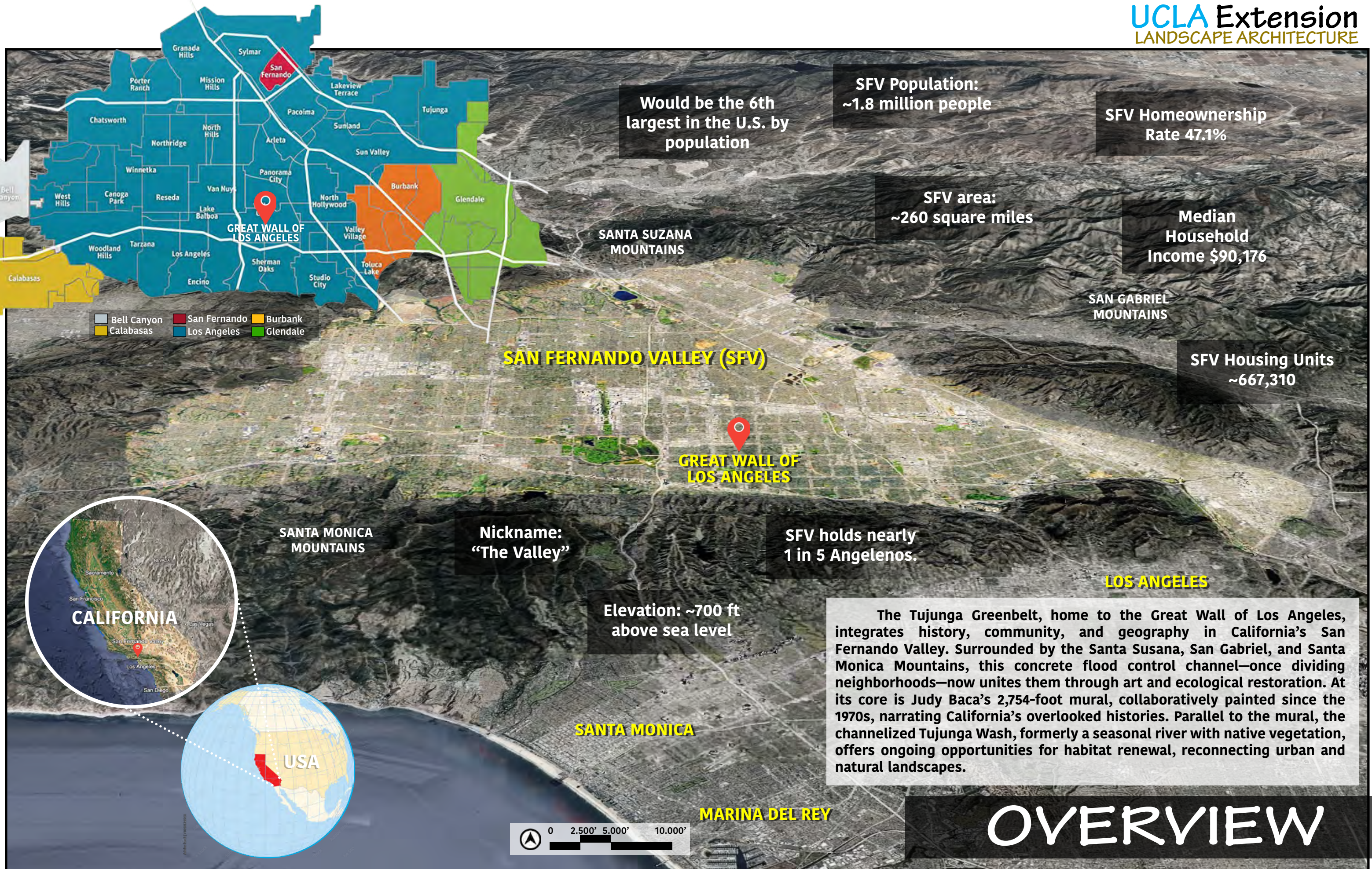

Would be the 6th largest in the U.S. by population

SFV Population: ~1.8 million people

SFV Homeownership Rate 47.1%

SFV area: ~260 square miles

Median Household Income \$90,176

SFV Housing Units ~667,310

SAN FERNANDO VALLEY (SFV)

GREAT WALL OF LOS ANGELES

Nickname: "The Valley"

SFV holds nearly 1 in 5 Angelenos.

Elevation: ~700 ft above sea level

LOS ANGELES

The Tujunga Greenbelt, home to the Great Wall of Los Angeles, integrates history, community, and geography in California's San Fernando Valley. Surrounded by the Santa Susana, San Gabriel, and Santa Monica Mountains, this concrete flood control channel—once dividing neighborhoods—now unites them through art and ecological restoration. At its core is Judy Baca's 2,754-foot mural, collaboratively painted since the 1970s, narrating California's overlooked histories. Parallel to the mural, the channelized Tujunga Wash, formerly a seasonal river with native vegetation, offers ongoing opportunities for habitat renewal, reconnecting urban and natural landscapes.

OVERVIEW

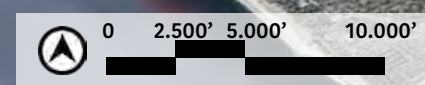

Historical Map of San Fernando Valley

Indigenous Stewardship
For thousands of years the Tongva people live throughout the San Fernando Valley, relying on the seasonal flow of the Tujunga Wash for water, food, and spiritual life.



Mission San Fernando Founded
Spanish colonizers establish the mission, displacing Native communities and starting agricultural development in the valley.



Catastrophic Flooding Hits LA Region
Devastating rains kill over 100, leading to channelization of the LA River and Tujunga Wash.



Olympic Panels Added
New mural sections honor the LA Olympics and expand the timeline.



Greenbelt Phase One
The first greenbelt trail and native plantings are added beside the mural, reconnecting the site with nature and community.

September 8,
1797

February
1938

October
2002

Before
1769

1904

Summer
1984

August
2017

April 5,
1876

August
1974

Early
2009

Rail Connection Reaches the Valley
The railroad links L.A. to San Francisco, spurring rapid growth across the expanding San Fernando Valley region.



LA Aqueduct Construction Begins
Water from Owens Valley fuels agriculture and suburban growth in the Valley.

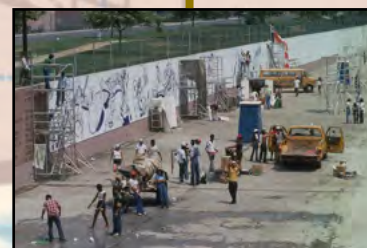

Great Wall Mural Begins
Judy Baca and SPARC launch the first section with 80+ youth artists.

Mural Restoration
SPARC restores all 2,750 feet of the mural under tough flood channel conditions, completing the work in 2011.



National Historic Recognition
The Great Wall of Los Angeles is designated a National Historic Site by the U.S. Department of the Interior.

HISTORY



**INVENTORY
LEGEND**

- SITE BOUNDARY
- HISTORIC MURAL WALL
- PERIMETER SECURITY FENCE
- STORMWATER RETENTION BASIN

- ☼ SPOTLIGHTS (MURAL ILLUMINATION)
- ☐ SIGN
- ⊕ WATER PIPE
- U UTILITIES BOX

- ▬ DESIGNED CONCRETE BENCH
- ☐ BENCH
- ☐ PICNIC TABLE
- ☐ BRIDGE

- 🚌 BUS STOP
- OVERHEAD UTILITY PIPE (FRESH WATER MAIN)

CONTEXT + INVENTORY

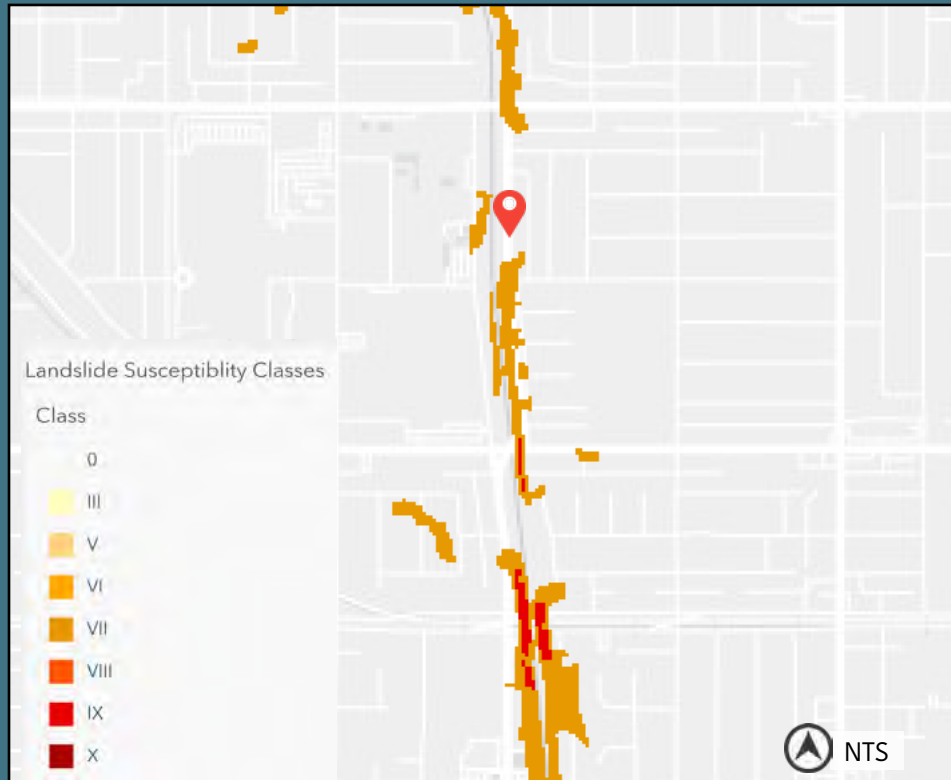

SEISMIC HAZARDS: LANDSLIDE SUSCEPTIBILITY - Source: [CADOC](#)



SUMMER SUN PATH AND SHADE AT 9AM



WINTER SUN PATH AND SHADE AT 9AM

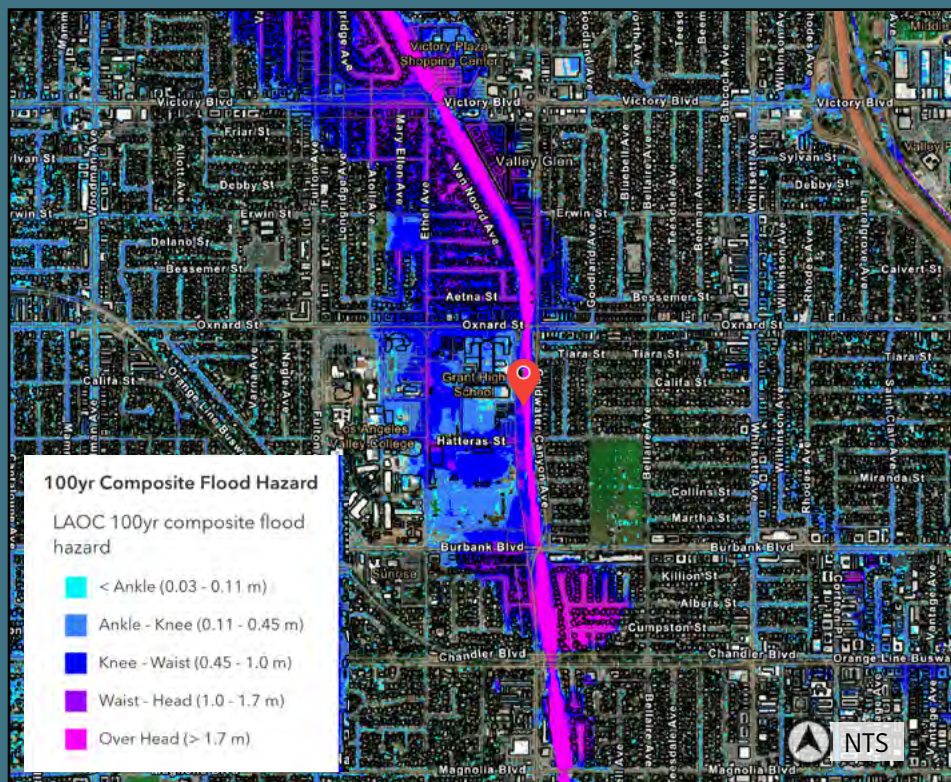

100 YR COMPOSITE FLOOD HAZARD MAP - Source: [UC Irvine](#)



SUMMER SUN PATH AND SHADE AT 4PM



WINTER SUN PATH AND SHADE AT 4PM

SITE ANALYSES

EXISTING TREE

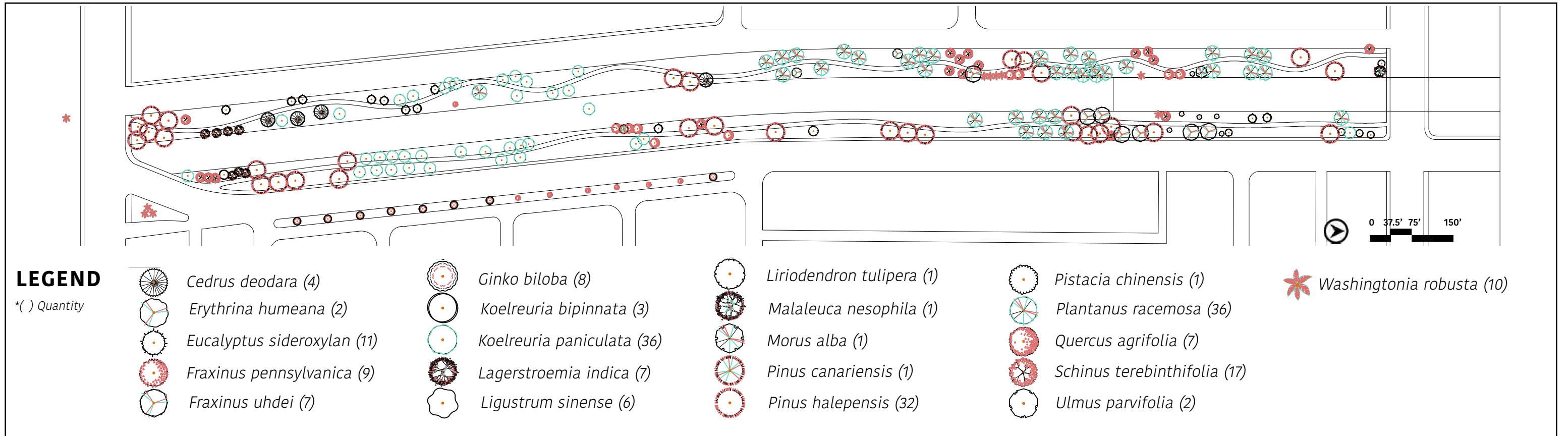

EXISTING TREE CANOPY

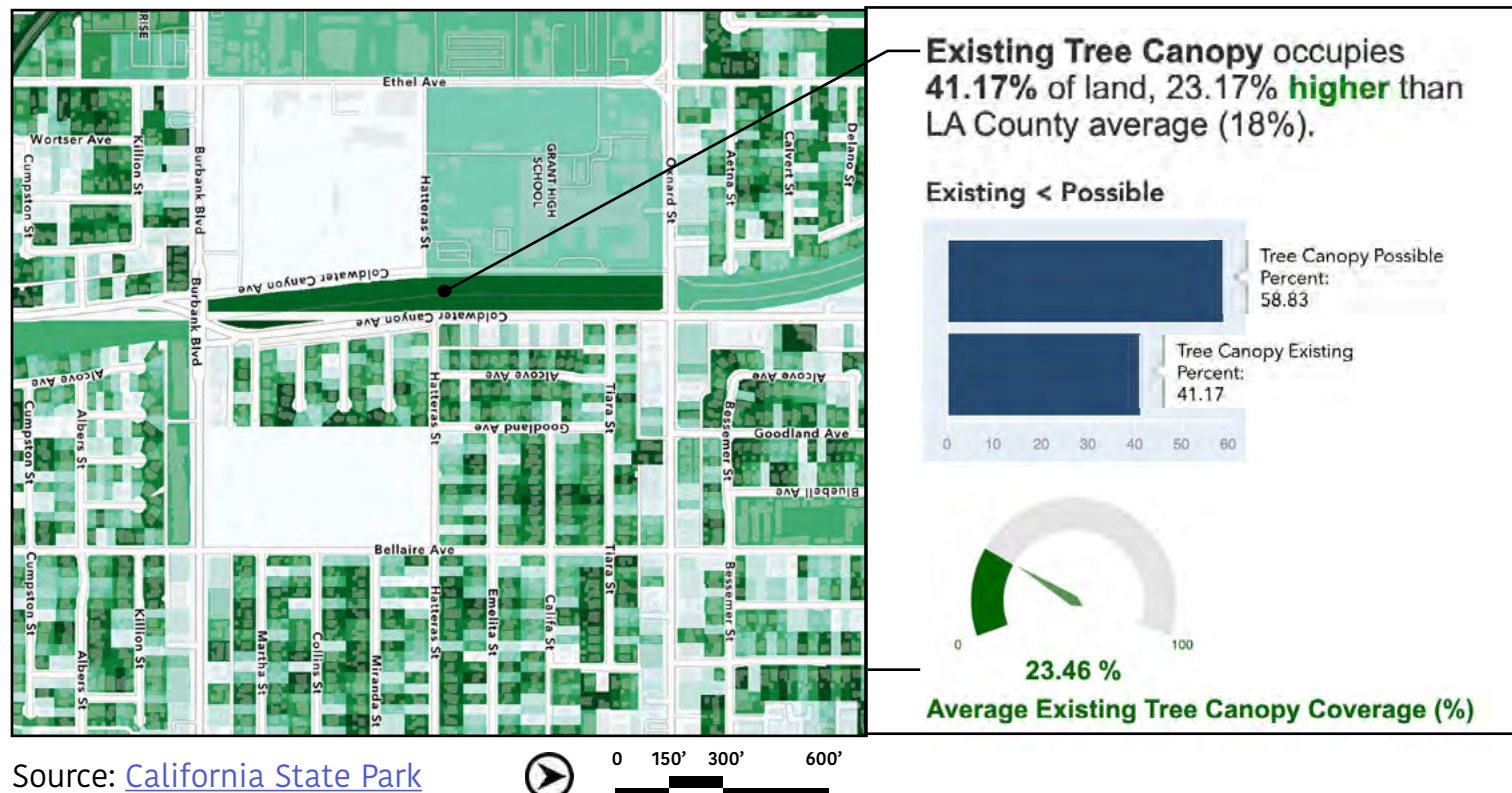

FAUNA

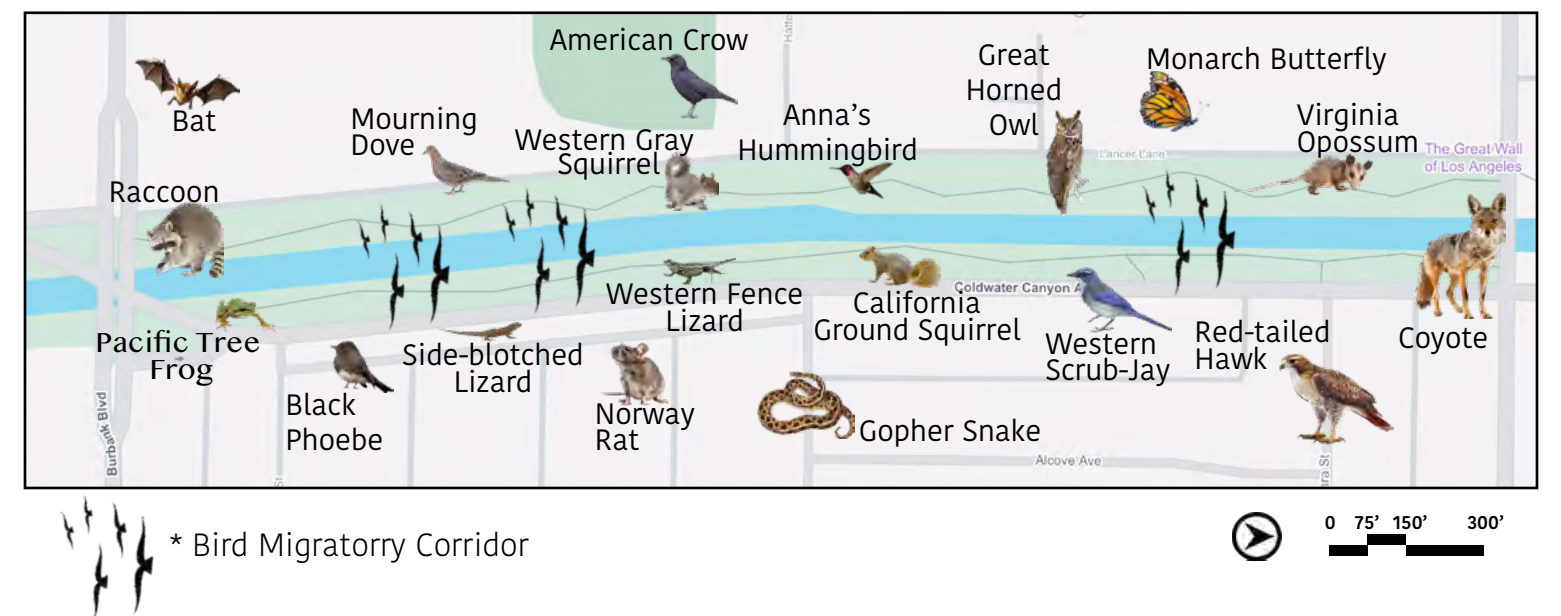

SITE ANALYSES

SITE CONSTRAINTS

- 1 HEAT & MICROCLIMATE**
Site experiences high summer temperatures despite tree canopy, limiting comfort and usability.
- 2 TRAFFIC & NOISE**
Fast-moving vehicles and loud roads affect safety and peaceful use of the space.
- 3 MISSING AMENITIES**
No restrooms, food options, shade structures, or seating reduces comfort and length of visits.
- 4 TREE HEALTH**
Mature trees show signs of structural risk, raising safety and maintenance concerns.
- 5 CHANNEL DESIGN**
Tujunga Channel was engineered for stormwater—not for human interaction or visual access.
- 6 LIMITED WALKABILITY**
Narrow sidewalks and walkways along Burbank Blvd and Oxnard Ave reduce pedestrian safety.
- 7 POOR VISIBILITY & WAYFINDING**
Lack of clear signage and visual connection between mural and park creates disorientation.
- 8 UNDERUTILIZED SPACE**
No clear gathering spaces, programming, or activity zones to draw consistent community use.
- 9 MURAL DISCONNECT**
The chain-link fence and lack of proximity create a barrier between people and mural.
- 10 ACCESSIBILITY GAPS**
Limited ADA access to mural edges and uneven paths exclude some users.
- 11 LACK OF IDENTITY**
Few visual or cultural markers make the space feel generic or unmemorable.
- 12 SAFETY & SECURITY**
Sparse lighting and isolation in areas reduce the sense of safety, especially at night.

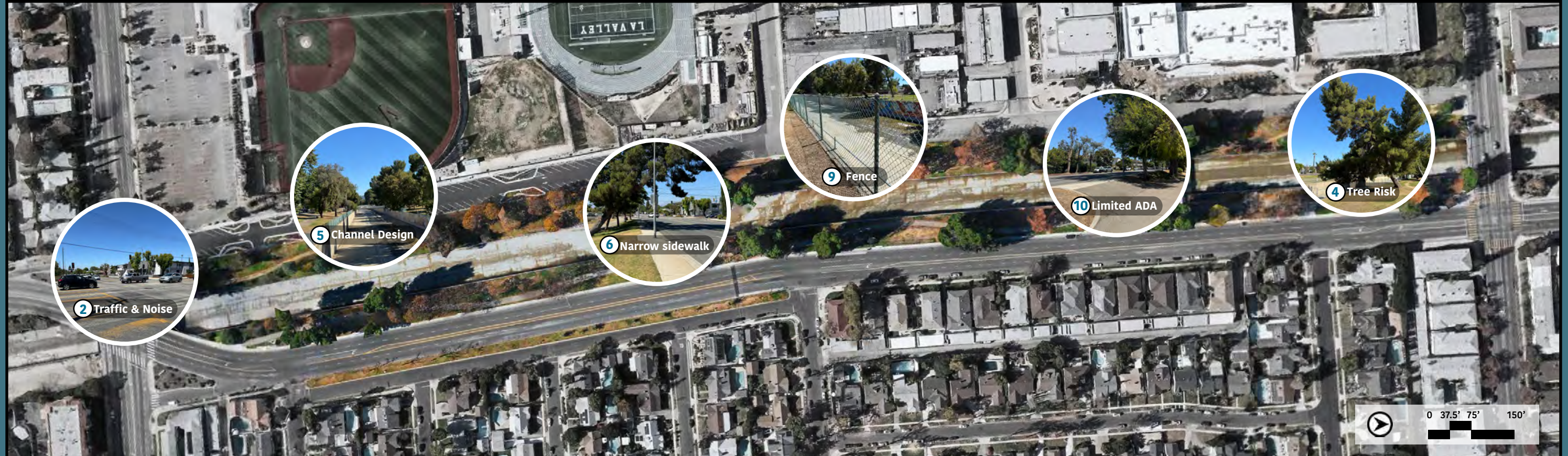

SITE OPPORTUNITIES

- 1 COMMUNITY LEARNING & ACTIVITY HUB**
Establish an outdoor museum and visitor center with restrooms, flexible spaces for classes, events, and community programs.
- 2 MURAL VIEWING PLATFORMS**
Designated platforms to provide immersive and accessible mural experiences.
- 3 EXPANDED WALKWAYS**
Widen paths along Burbank Blvd to improve safety and pedestrian flow.
- 4 ATTRACTIVE FENCING**
Replace chain link with welcoming, artistic barriers to reconnect mural and park.
- 5 CAFÉ SPACE**
Introduce food and beverage options to increase draw and comfort.
- 6 INCLUSIVE ACCESS & TRANSIT COMFORT**
Enhance ADA accessibility to the mural and improve public transit stops with shaded seating and clear signage—ensuring a welcoming experience for all visitors.
- 7 IMPROVED SIGNAGE & OUTREACH**
Add educational, directional, and interpretive signage, and expand outreach to raise awareness of the mural and park.
- 8 NIGHTTIME LIGHTING**
Add soft uplighting to trees and walkways for extended safe use.
- 9 IMPROVED SIGNAGE & OUTREACH**
Enhance visibility with educational signs and outreach efforts to draw visitors.
- 10 POLLINATOR & NATIVE PLANT GARDENS**
Create habitat-rich gardens to support biodiversity and seasonal interest.
- 11 ARTISTIC & CULTURAL PROGRAMMING**
Use open space for performances, exhibitions, or cultural gatherings that celebrate local identity and creativity.
- 12 STORMWATER CAPTURE & GREEN INFRASTRUCTURE**
Integrate bioswales, rain gardens, and retention areas to manage runoff and showcase sustainability.



CASE STUDY 1

East Side Gallery - Berlin, Germany



LOCATION: Berlin, Germany – Along the Spree River in the Friedrichshain-Kreuzberg district.

TIMELINE: Wall constructed in 1961; Wall fell in 1989; East Side Gallery painted in 1990; Restoration and promenade development ongoing since 2000.

LEAD DESIGNERS: International group of over 100 artists coordinated by Christine MacLean and David Monty

CLIENT: City of Berlin (Public Spaces Office).

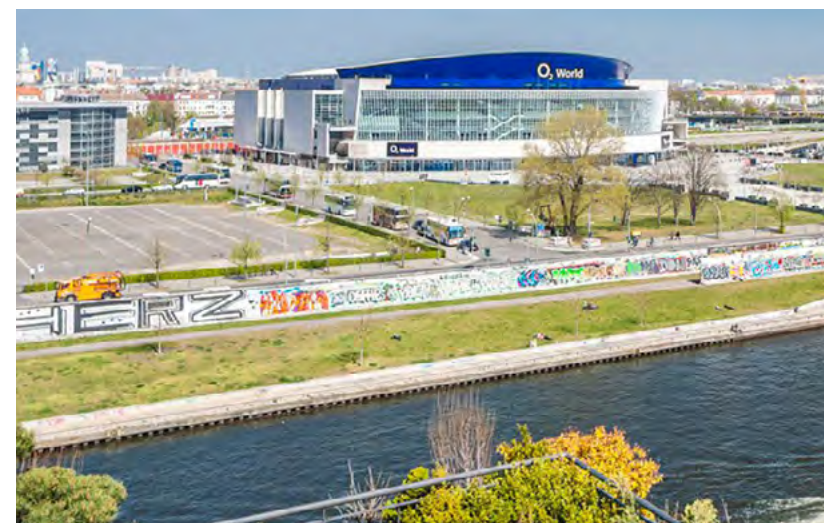

PROJECT OVERVIEW:

Reclaims a historically restricted urban corridor along the Spree River, transforming the former Berlin Wall into a global symbol of peace and public art. Like the Great Wall of Los Angeles, it turns a barrier into a linear community space for storytelling and cultural memory, while opening the waterfront for public use.

WHAT WORKED WELL:

Environmental Benefits:

- Opened the former death strip as a riverfront promenade and green corridor.
- Improved public space with river access and soft landscaping.
- Preserved the Wall while creating new urban permeability.

SOCIAL IMPACT:

- Created the world's longest open-air mural gallery, celebrating unity and reflection.
- Became a site for gathering, education, and tourism.
- Provided pedestrian and cycling access along the Spree.

ECONOMIC IMPACT:

- Boosted local tourism and creative economy.
- Attracted private investment and revitalized nearby areas.
- Supported small businesses and hospitality sectors.

WHAT COULD BE IMPROVED:

- Limited habitat restoration and biodiversity integration.
- Commercial pressures and gentrification risk displacing local communities.
- Some murals face damage and tagging, requiring stronger conservation efforts.
- Needs more community-led programming to balance tourism with local use.

CASE STUDY 2

San Pedro Creek Culture Park – San Antonio, Texas

LOCATION: Downtown San Antonio, along San Pedro Creek
TIMELINE: Planning began in 2013; Phases opened from 2018 to present
Length: 2.2 miles (planned full build-out)
LEAD DESIGNERS: Muñoz & Company, HDR, Pape-Dawson Engineers, and local artists
CLIENT: Bexar County, City of San Antonio

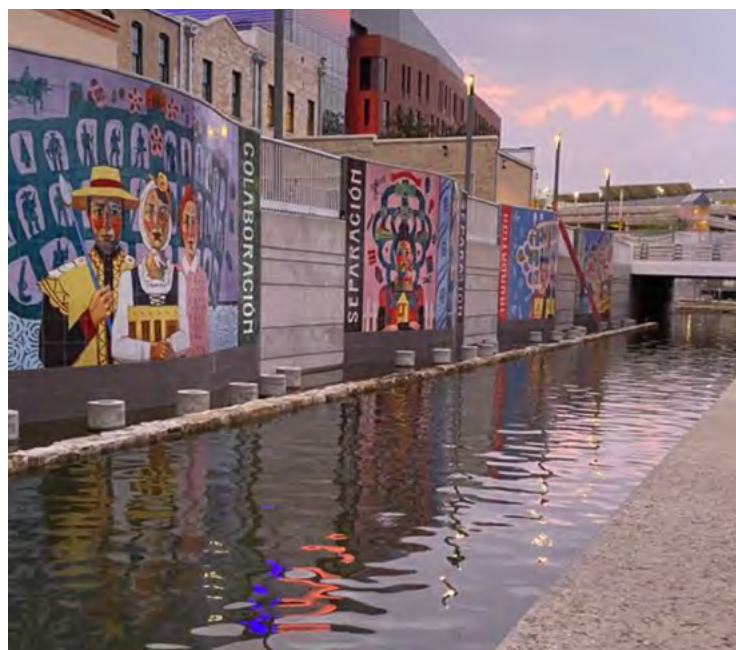
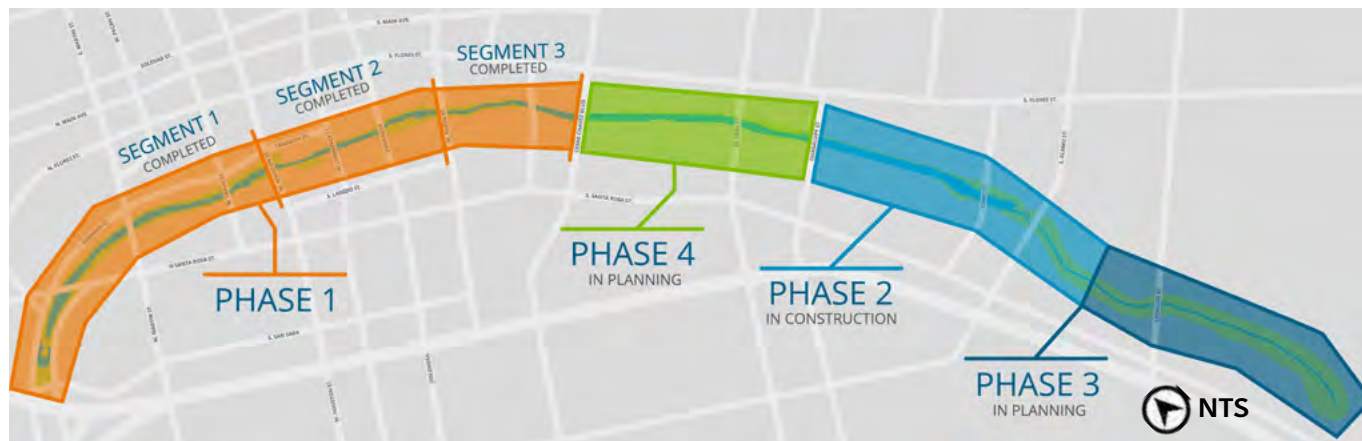

PROJECT OVERVIEW:

San Pedro Creek Culture Park transforms a neglected flood channel into a linear culture park, combining creek restoration, flood management, public art, and cultural storytelling. Like the Great Wall of Los Angeles, it reclaims infrastructure and turns it into a community landmark with murals, mosaics, and interpretive art celebrating local identity.

WHAT WORKED WELL:

ENVIRONMENTAL BENEFITS:

- Restored creek ecosystem with native plants and buffers.
- Improved stormwater management and flood control.
- Reduced heat with green infrastructure and shaded areas.

SOCIAL IMPACT:

- Created a safe, accessible park with trails and plazas.
- Installed murals and mosaics reflecting Indigenous, Mexican, and Tejano history.
- Hosted community events and cultural programs.

ECONOMIC IMPACT:

- Boosted downtown redevelopment and business growth.
- Increased property values and local investment.
- Created jobs in construction, art, and maintenance.

WHAT COULD BE IMPROVED:

- Water quality remains impacted by upstream runoff.
- Some areas need more shade for thermal comfort.
- Future art phases could include more community co-authorship.
- Long-term maintenance funding for art and landscape is needed.

CASE STUDY 3

East River Waterfront Esplanade – New York City, NY

LOCATION: Lower Manhattan, along the East River.

TIMELINE: Planning began in the early 2000s; Phases opened from 2011 to present.

Length: Over 2 miles

LEAD DESIGNERS: SHoP Architects, Ken Smith Workshop

CLIENT: NYC Economic Development Corporation (NYCEDC)



PROJECT OVERVIEW:

Reclaims industrial waterfront for public use, similar to the Great Wall's reclamation of the LA River channel for mural art

WHAT WORKED WELL:

ENVIRONMENTAL BENEFITS:

- Introduced native and salt-tolerant plantings
- Stormwater-managed bioswales and permeable paving.
- Improved microclimate with shade structures and trees.

SOCIAL IMPACT:

- Provided safe pedestrian and cycling access
- Created diverse public spaces: seating piers, gardens, playgrounds.
- Integrated public art and lighting for safety and culture.

ECONOMIC IMPACT:

- Boosted foot traffic and property values in adjacent neighborhoods.
- Attracted private investment in formerly neglected waterfront.
- Created new job opportunities in retail and maintenance.

WHAT COULD BE IMPROVED:

- Limited habitat value due to heavy recreational use and hardscape dominance.
- Storm surge resilience could be strengthened (some upgrades underway post-Hurricane Sandy).
- Greater equity in programming and access for low-income communities nearby.

1.

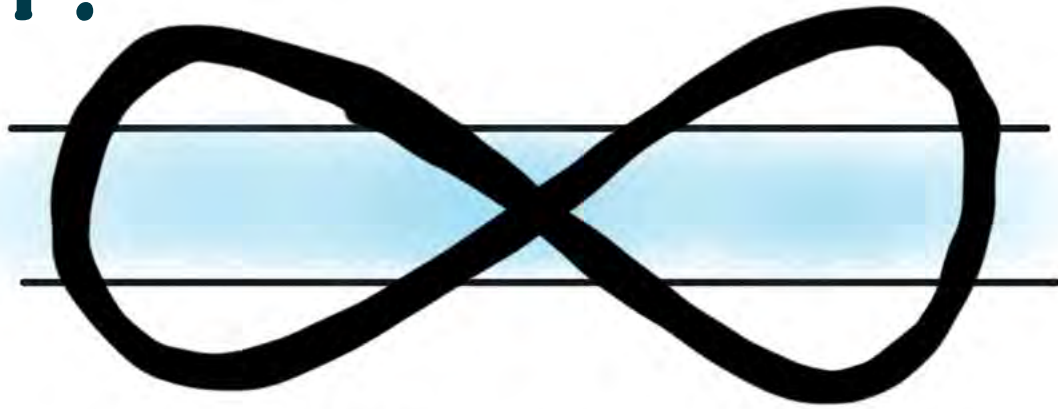

ETERNAL STORYTELLING
THE HISTORY ISN'T OVER

2.

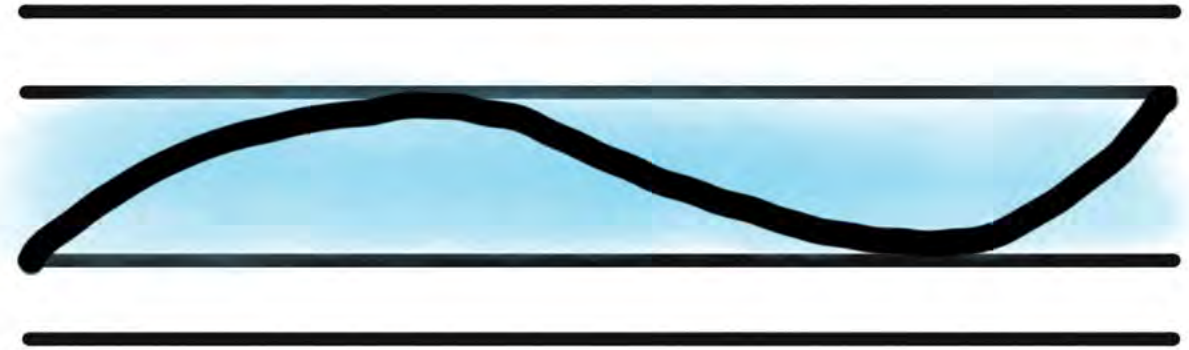

CONTINUITY AND FLOW
THE RIVER AND MURAL - CONTINUOUS JOURNEY

3.

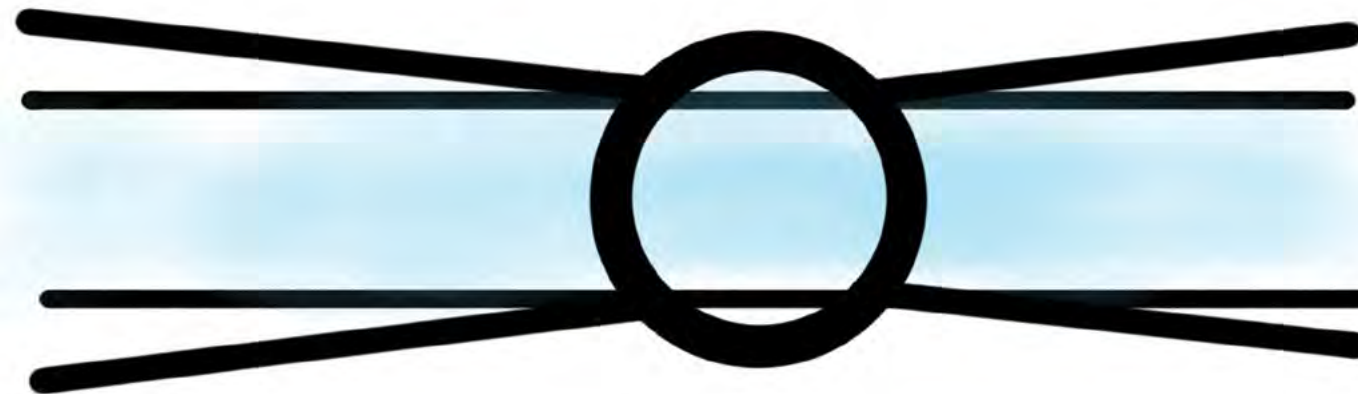

CIRCLE OF REFLECTION AND LINES OF ACTION
FROM THE CORE WE ACT SPREADING CHANGE IN
MULTIPLES DIRECTIONS

THREE CONCEPT PARTI DIAGRAMS

MINIMAL INVESTMENT OPTION

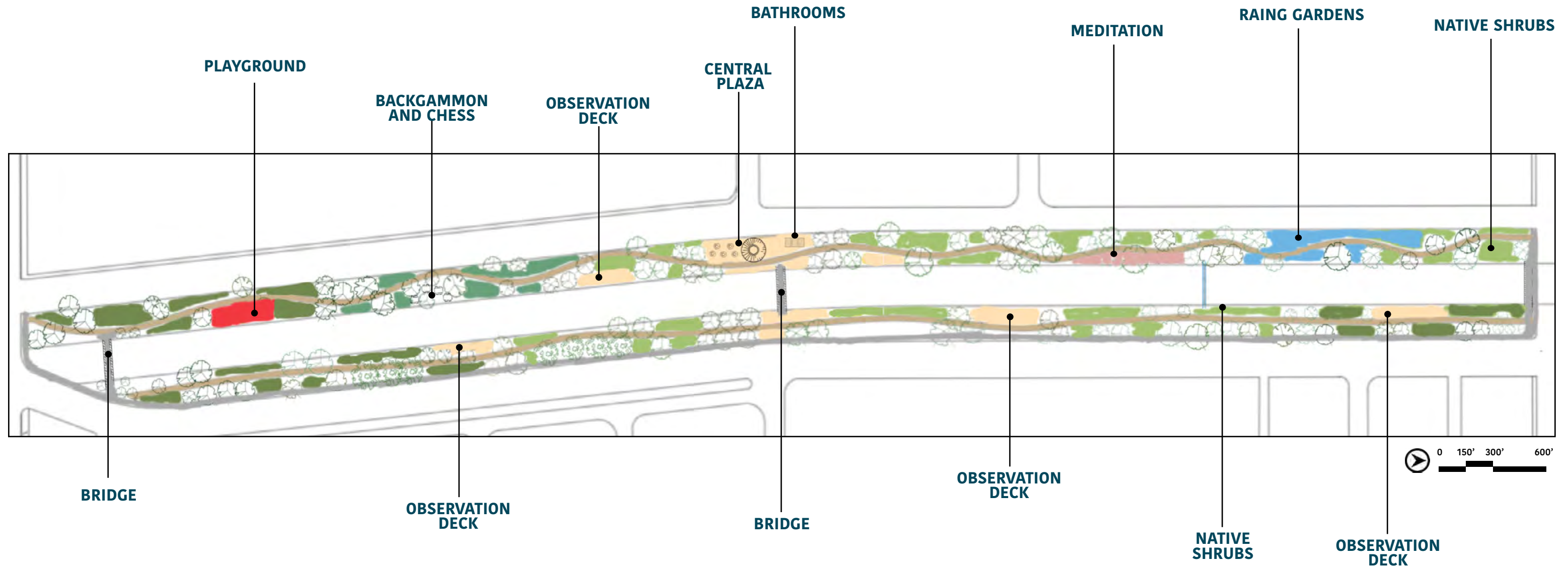

DESIGN ALTERNATIVES

MID-RANGE INVESTMENT OPTION

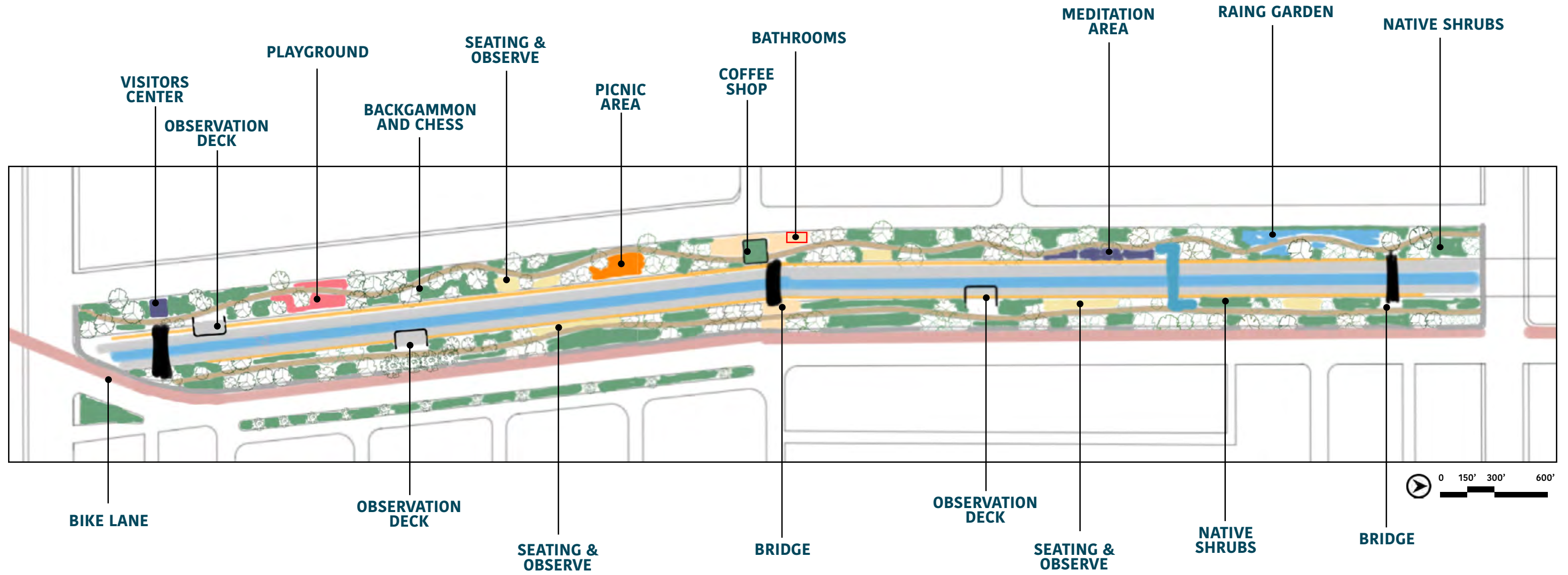

DESIGN ALTERNATIVES

PREMIUM INVESTMENT OPTION

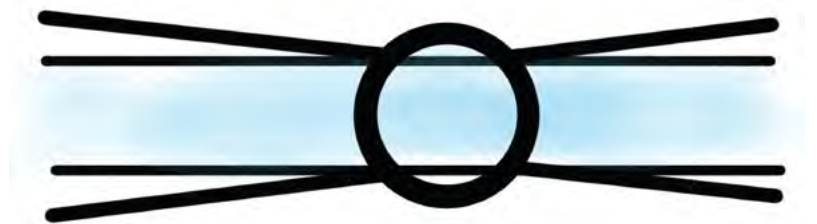
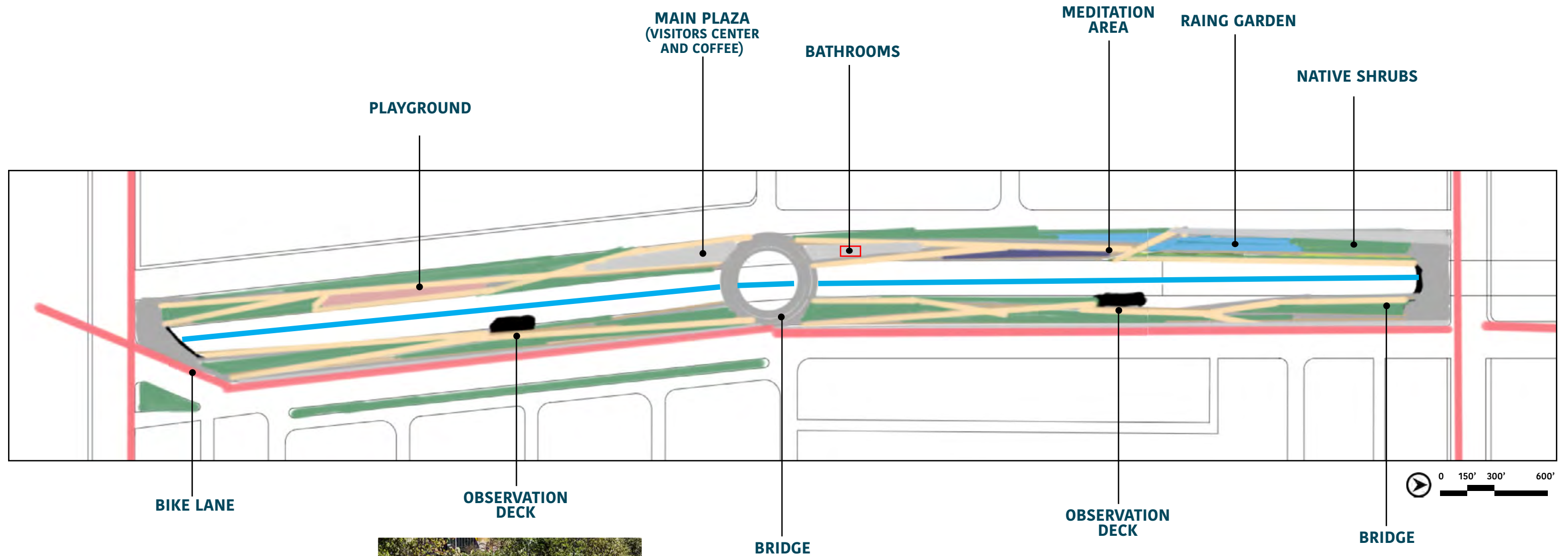

CIRCLE OF REFLECTION AND LINES OF ACTION
FROM THE CORE WE ACT & SPREADING CHANGE IN
MULTIPLES DIRECTIONS

DESIGN ALTERNATIVES



CIRCLE OF REFLECTION AND LINES OF ACTION
FROM THE CORE WE ACT SPREADING CHANGE IN
MULTIPLES DIRECTIONS

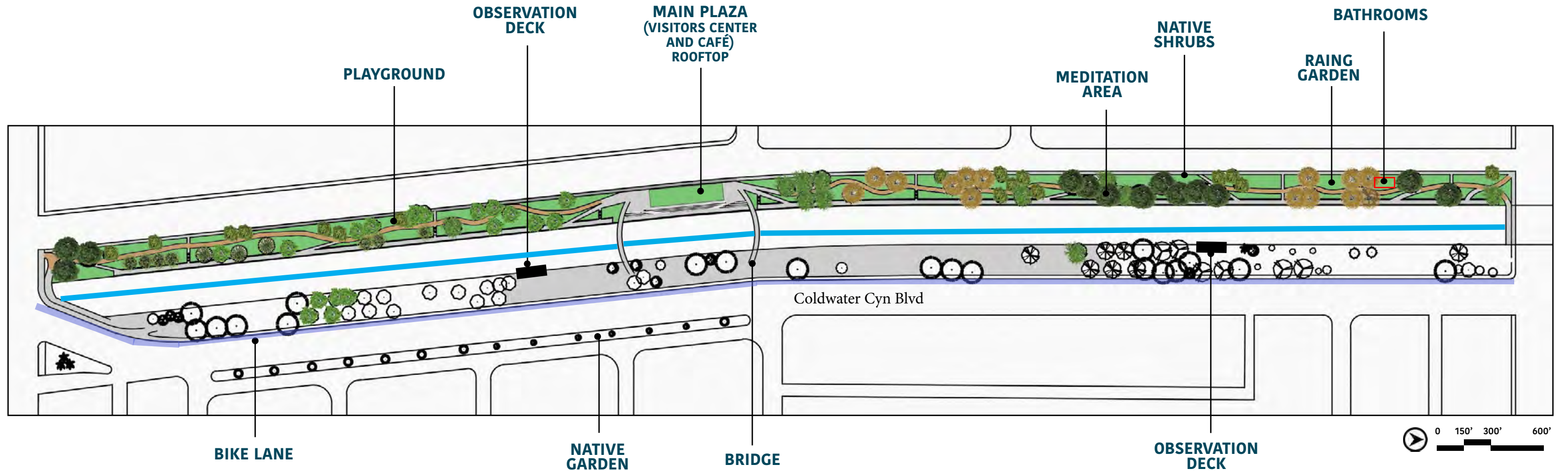
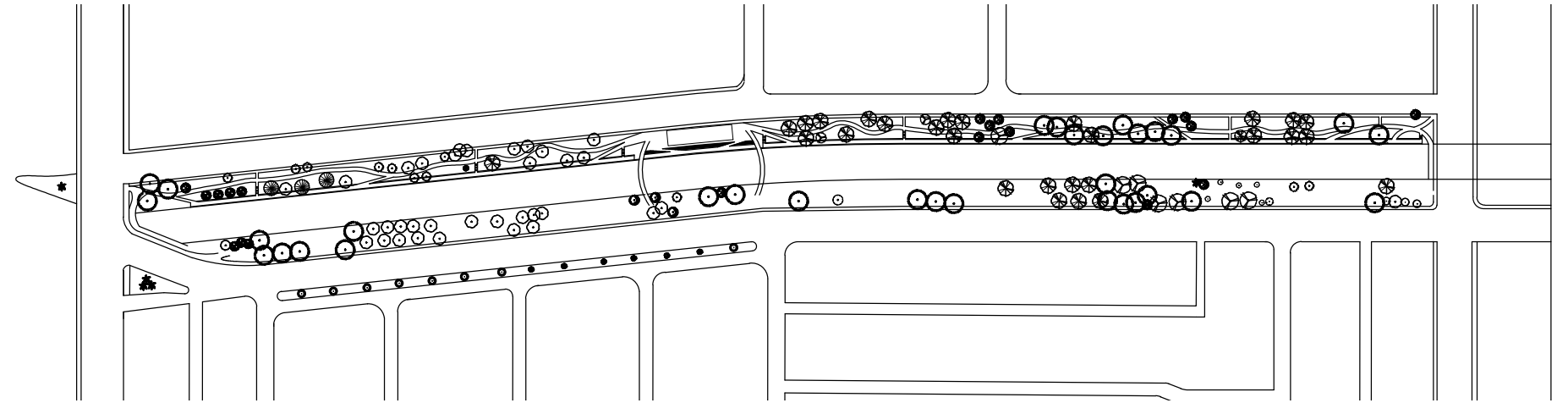

MASTER PLAN CONCEPT

Circle of Reflection, Lines of Action

My vision is to let the mural shine as the heart of the park—a living canvas that reflects our past and reminds us of the lessons we must carry forward. From this reflection emerges my parti: a circle of contemplation, encircled by radiating lines of action. At the core lies the river and the Great Wall of Los Angeles, where memory and history converge. From this center, a visitors' hub anchors the space, surrounded by pathways that branch outward like ripples—each one leading to native gardens, rain gardens, play areas, meditation nooks, and spaces for movement and exercise. Together, these elements embody a landscape that honors history while propelling us into a more thoughtful, resilient, and connected future.

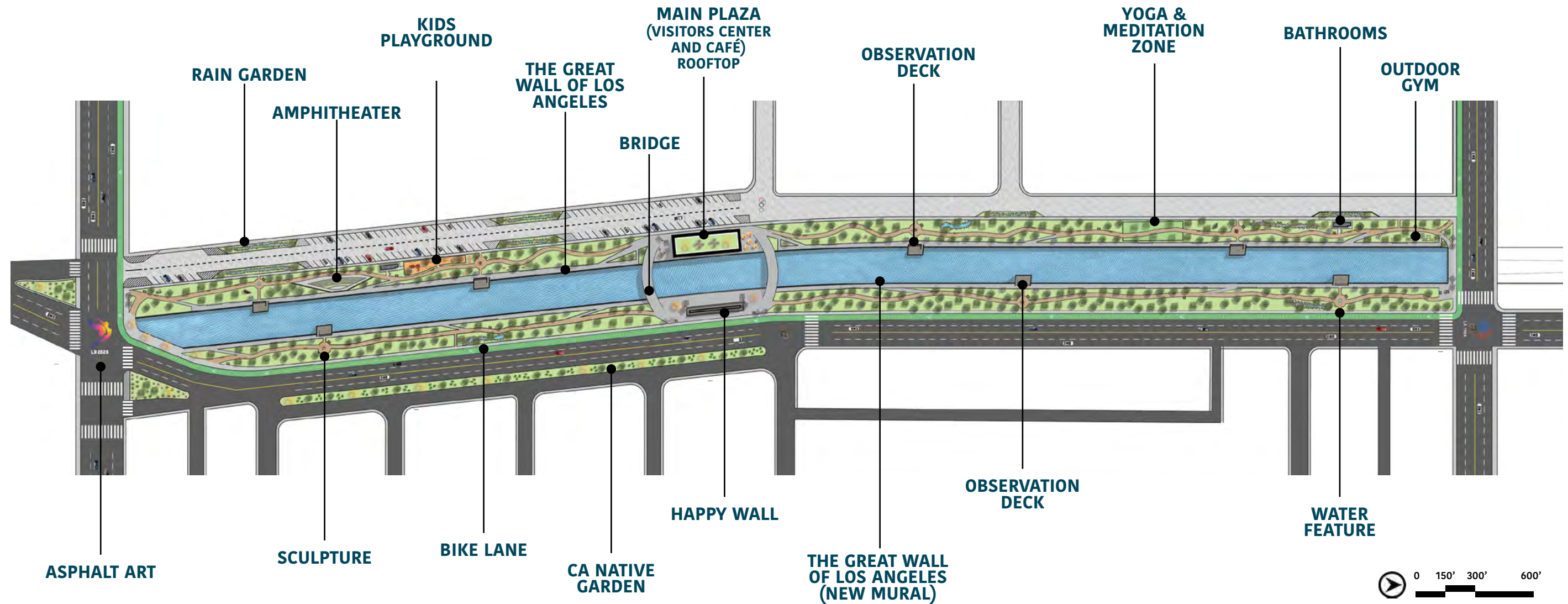

MASTER PLAN

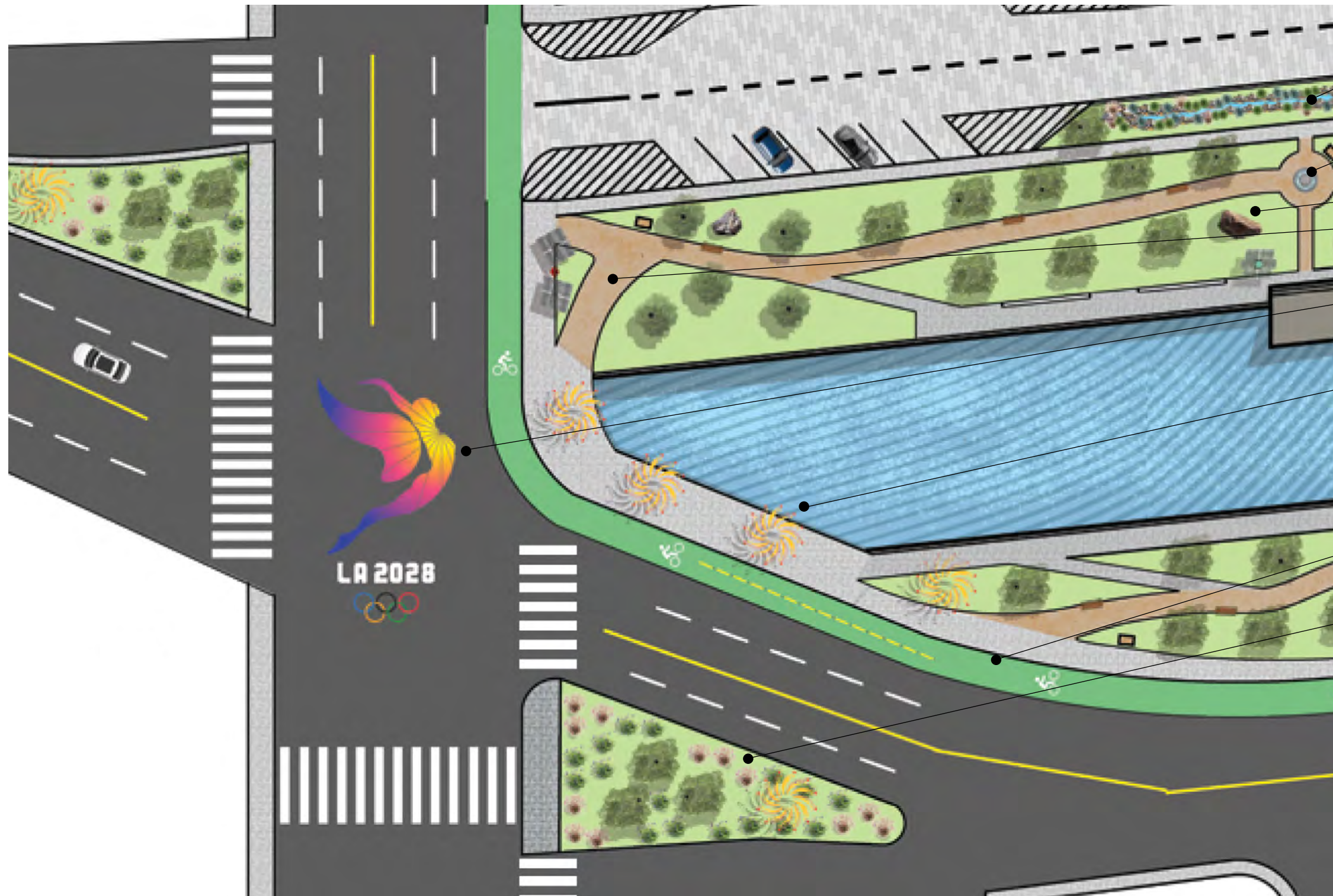

- RAIN GARDEN
- WATER FEATURE
- SCULPTURAL BOULDER
- SOLAR TREE
- ASPHALT ART
- WINDCATCH TREE
- BIKE LANE
- CA NATIVE GARDEN

KEY MAP

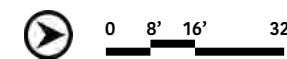
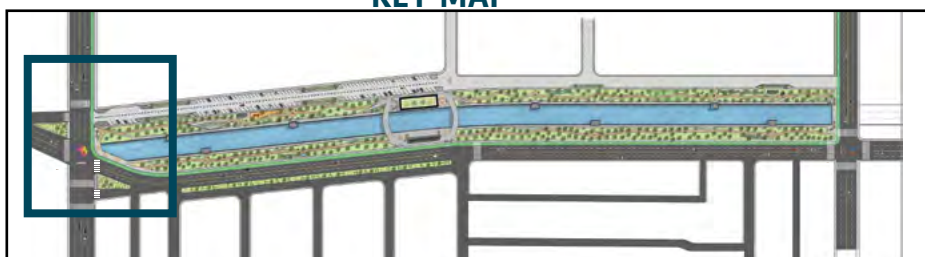

ENLARGEMENT 1

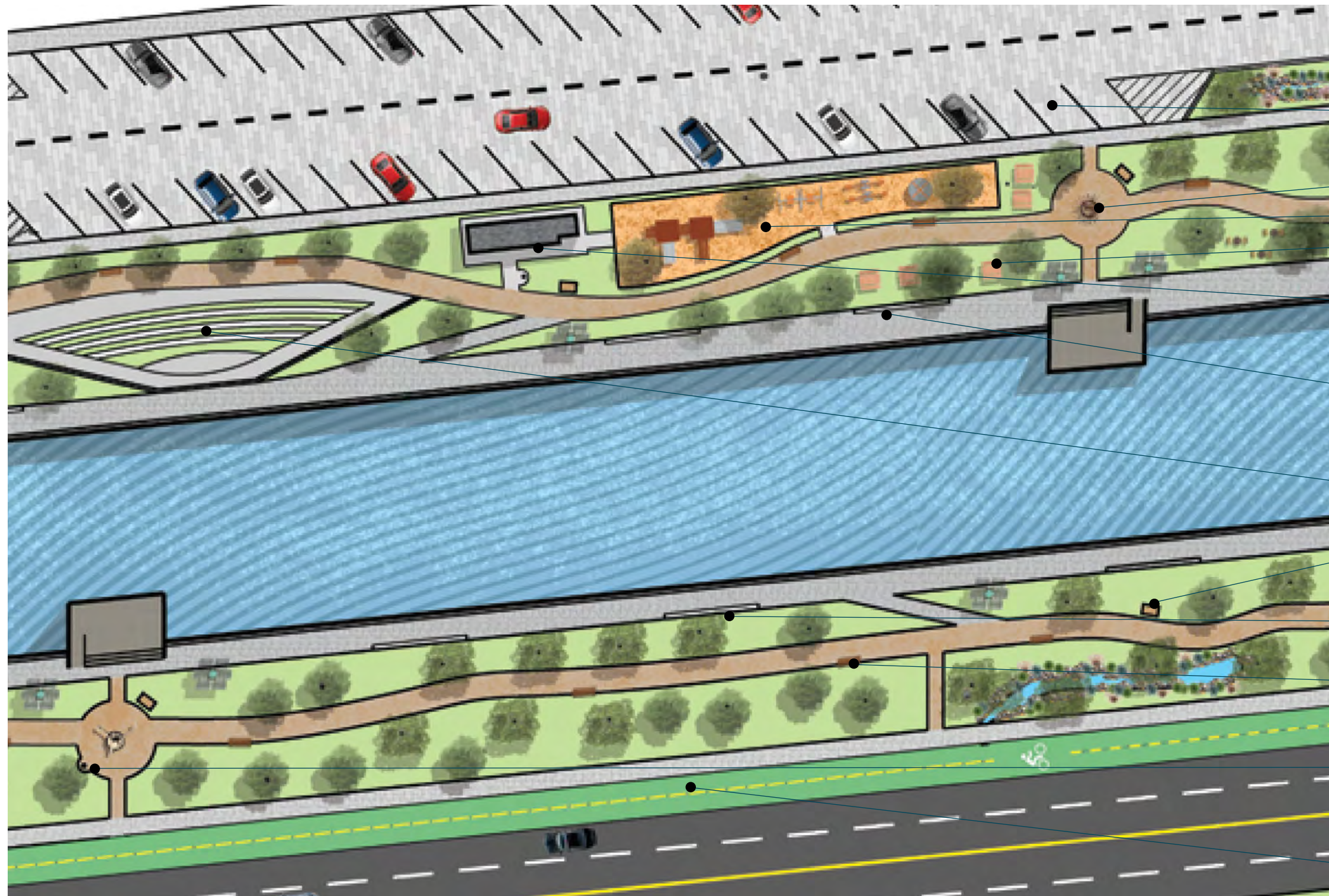

PARKING

SCULPTURE

KIDS PLAYGROUND

PICNIC TABLE

RESTROOMS

CONCRETE BENCH

AMPHITHEATER

WAYFIDING SIGNAGE

CONCRETE BENCH

BENCH

DRINKING FOUNTAIN

CA NATIVE GARDEN

KEY MAP

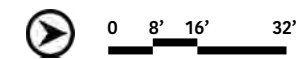
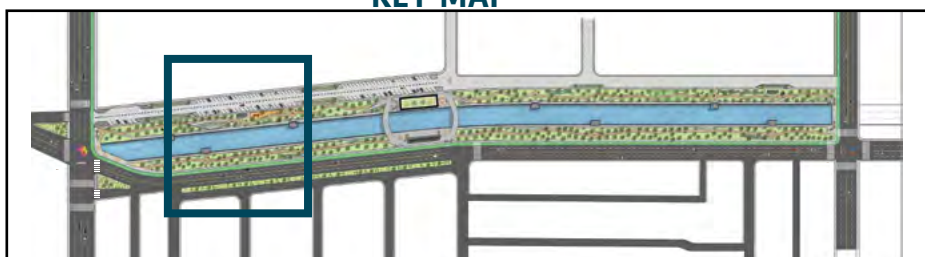

ENLARGEMENT 2

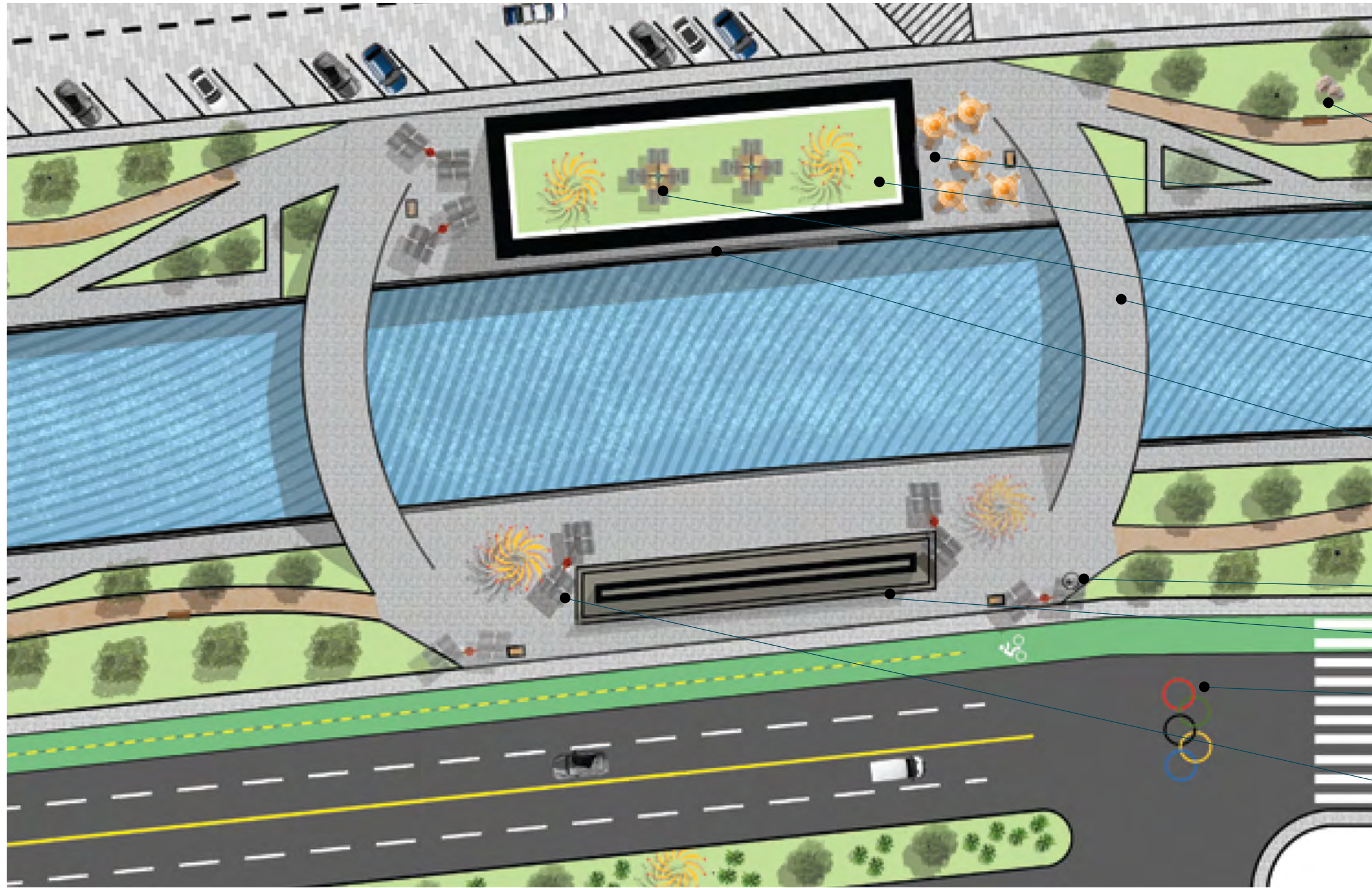

- SCULPTURAL BOULDER
- OUTDOOR CAFÉ SEATING
- VISITOR CENTER WITH ROOFTOP OBSERVATION DECK
- SOLAR TREE
- BRIDGE
- GREAT WALL OF LOS ANGELES (MURAL PANEL)
- DRINKING FOUNTAIN
- HAPPY WALL
- ASPHALT ART
- SOLAR TREE

KEY MAP

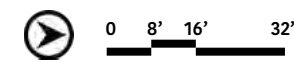
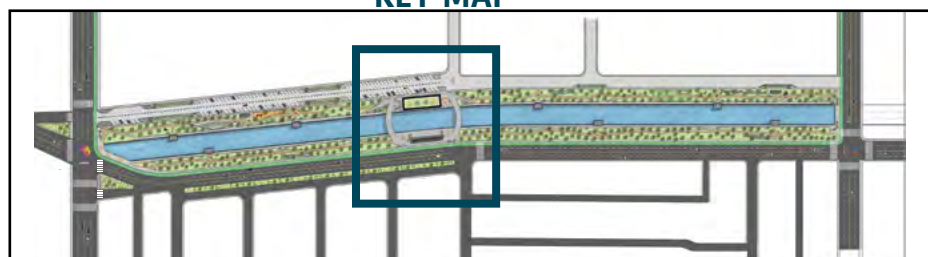

ENLARGEMENT 3

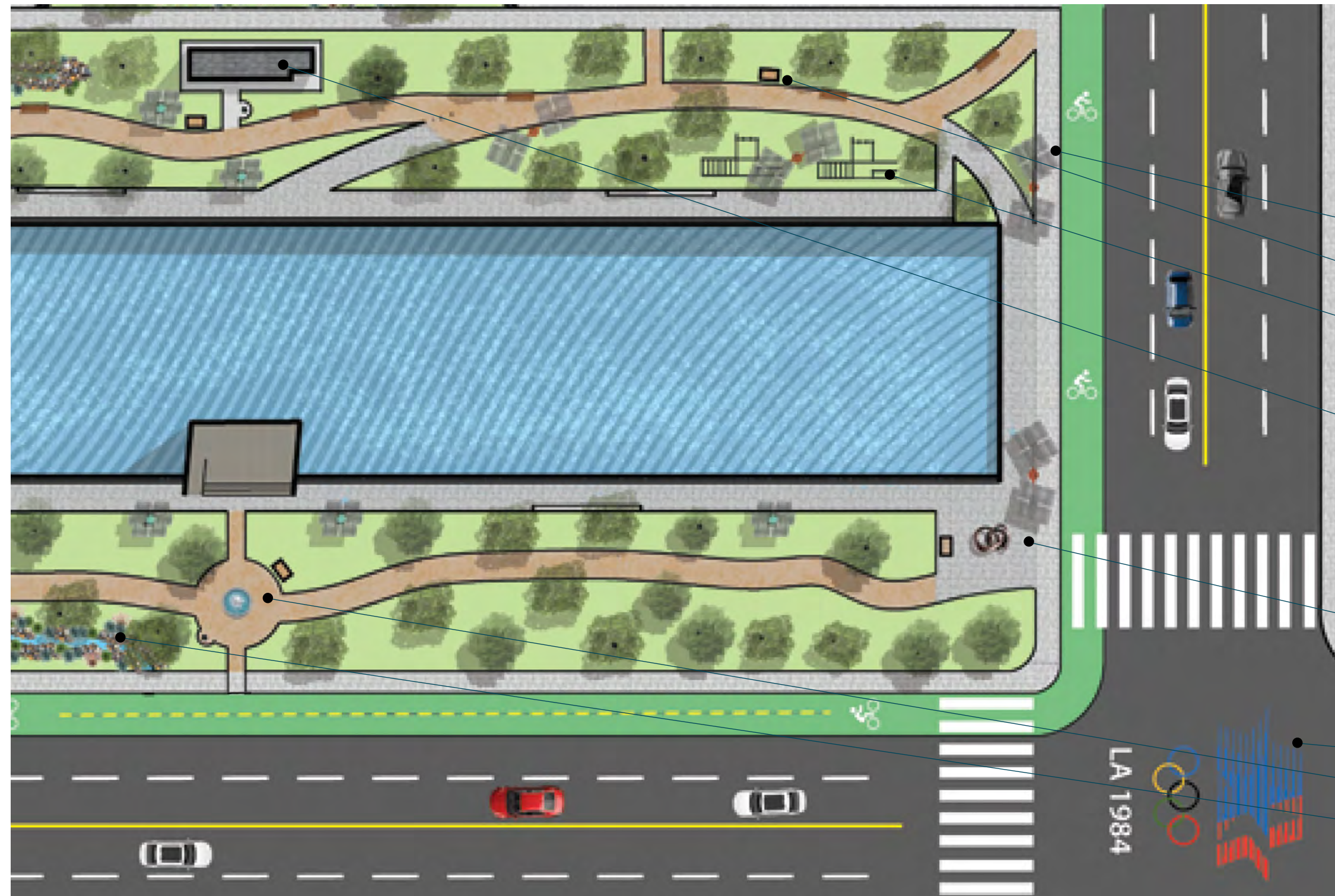

- SOLAR TREE
- WAYFIDING SIGNAGE
- OUTDOOR GYM
- RESTROOMS
- SCULPTURE
- ASPHALT ART
- WATER FEATURE
- RAIN GARDEN

KEY MAP

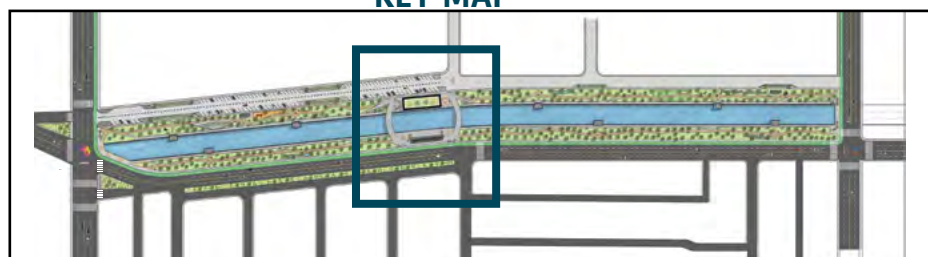

ENLARGEMENT 4

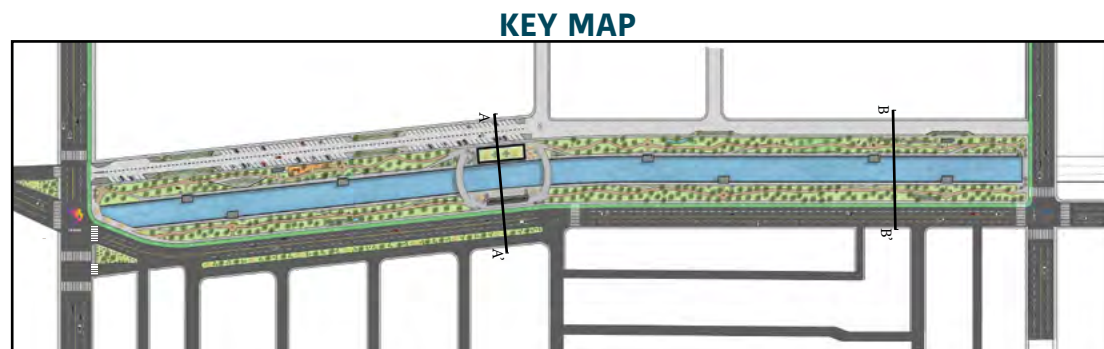
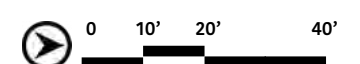
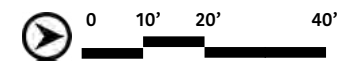
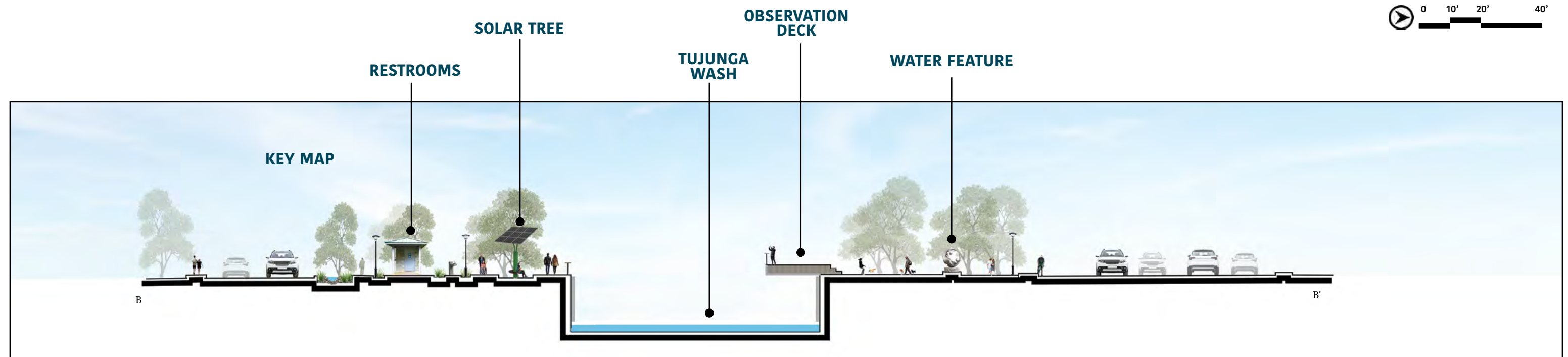
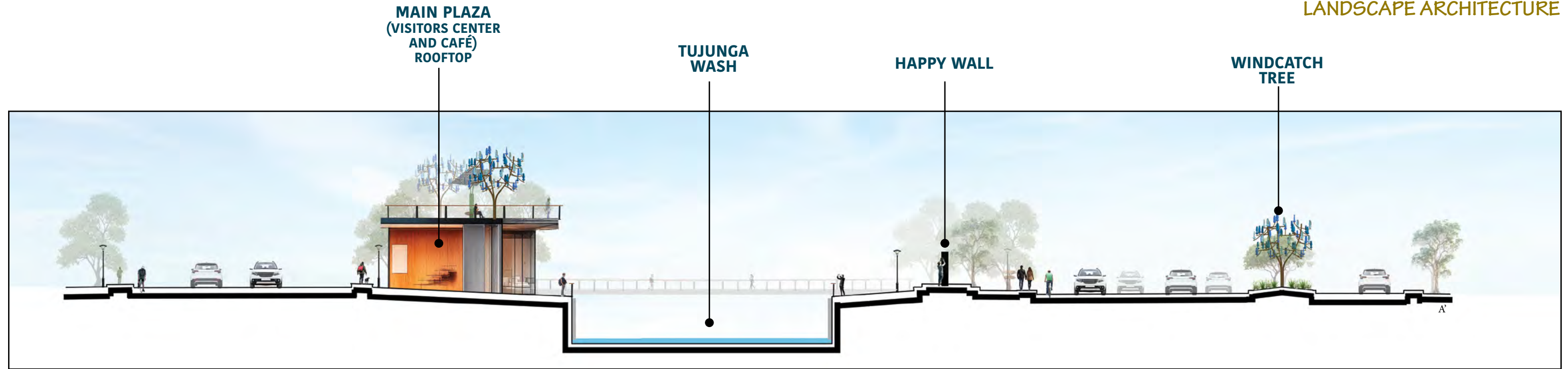

SECTION ELEVATION

The pathway along the channel provides seating, views, and a tranquil space for reflective walks.

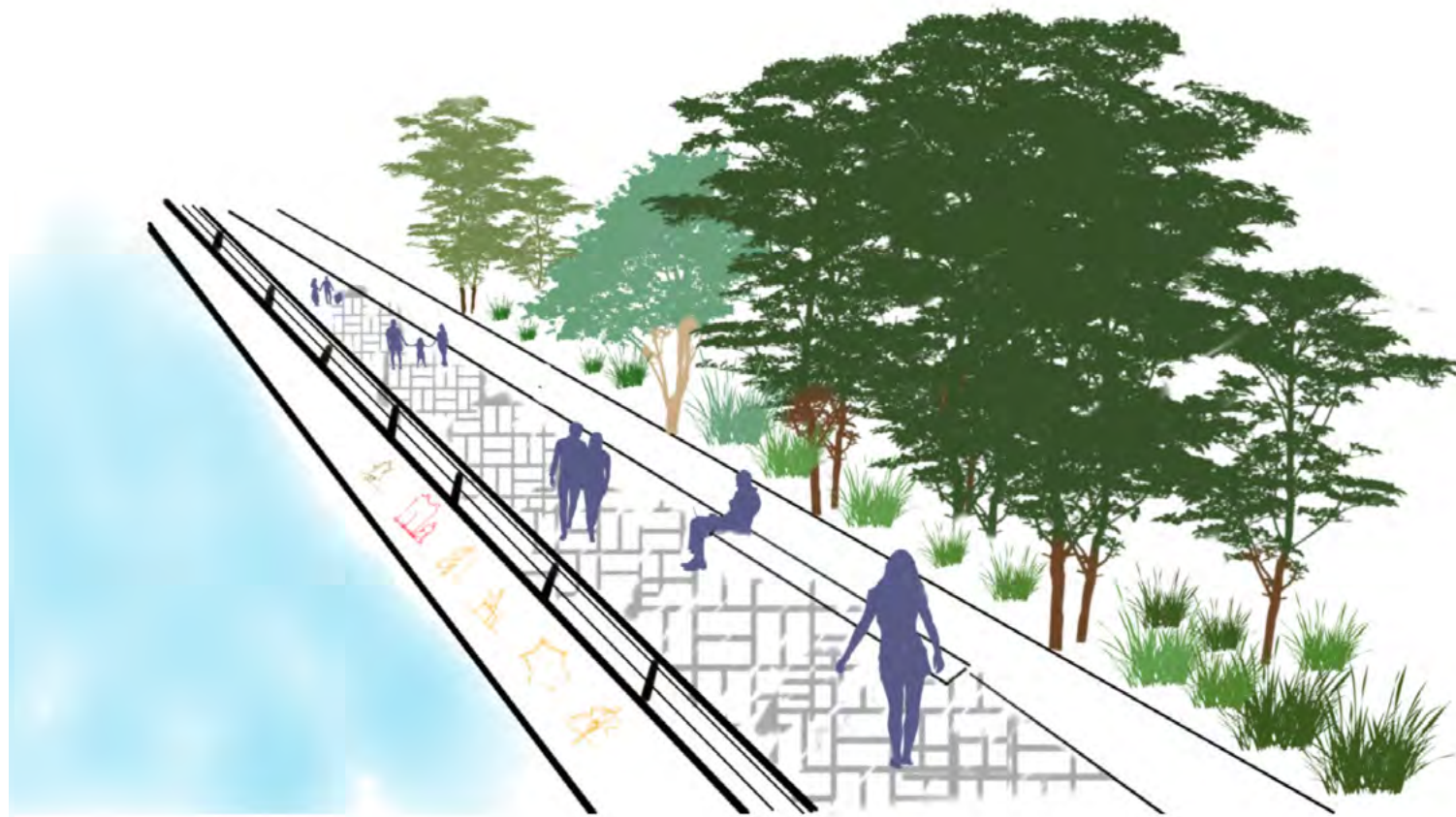

KEY MAP

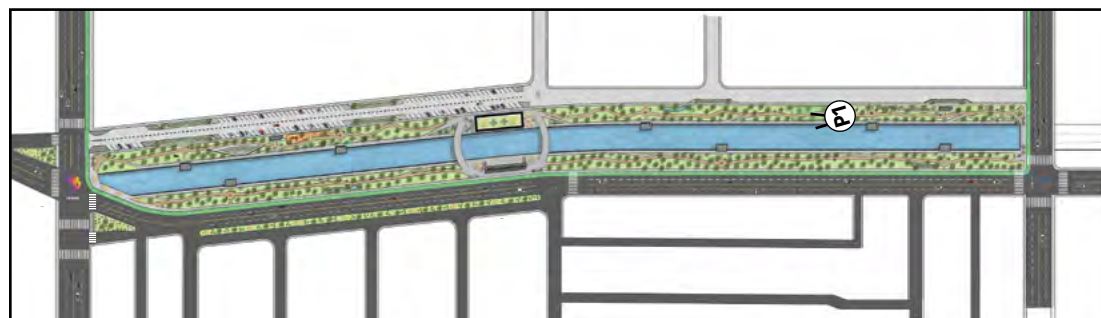

PERSPECTIVE 1

“The Happy Wall brings mural-making to everyone — a colorful, hands-on way for visitors to play, create, and leave their mark at the park!”



KEY MAP

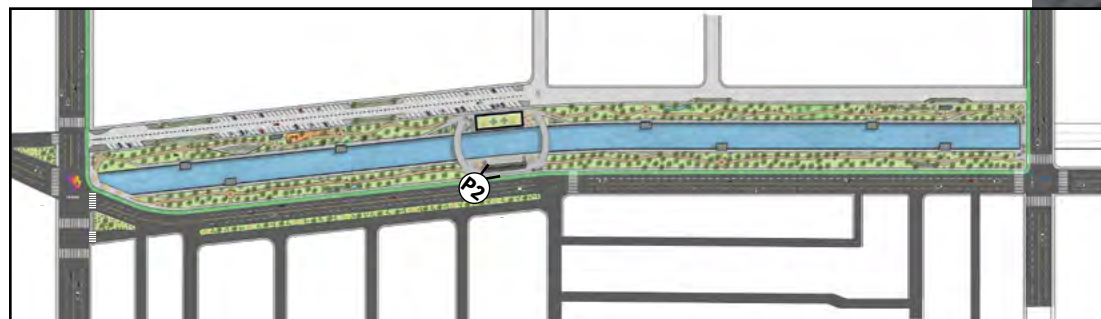

PERSPECTIVE 2

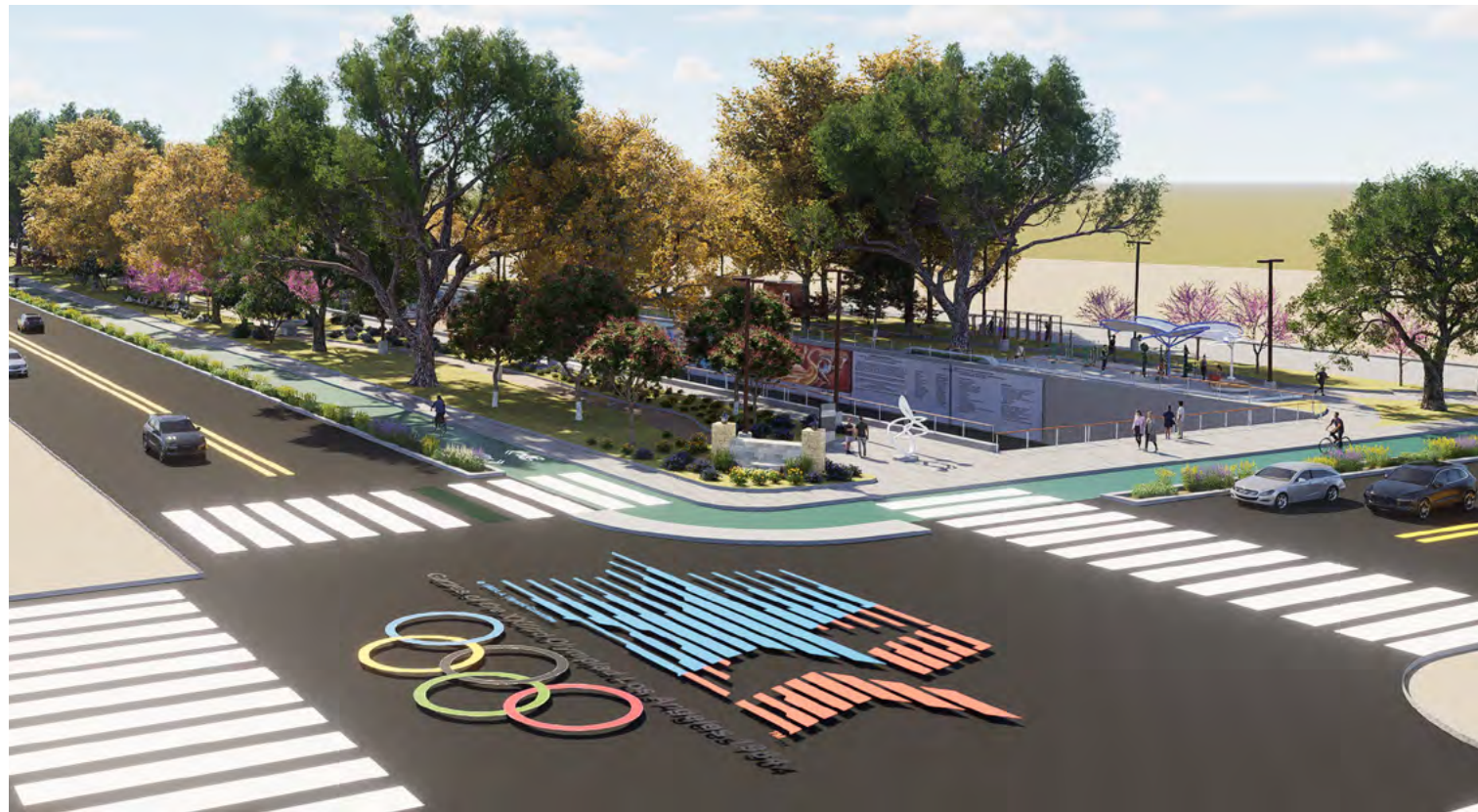

DIGITAL MODEL



DIGITAL MODEL



DIGITAL MODEL



DIGITAL MODEL

WALK TROUGH VIDEO

<https://www.youtube.com/watch?v=phuJzMv6uzg>

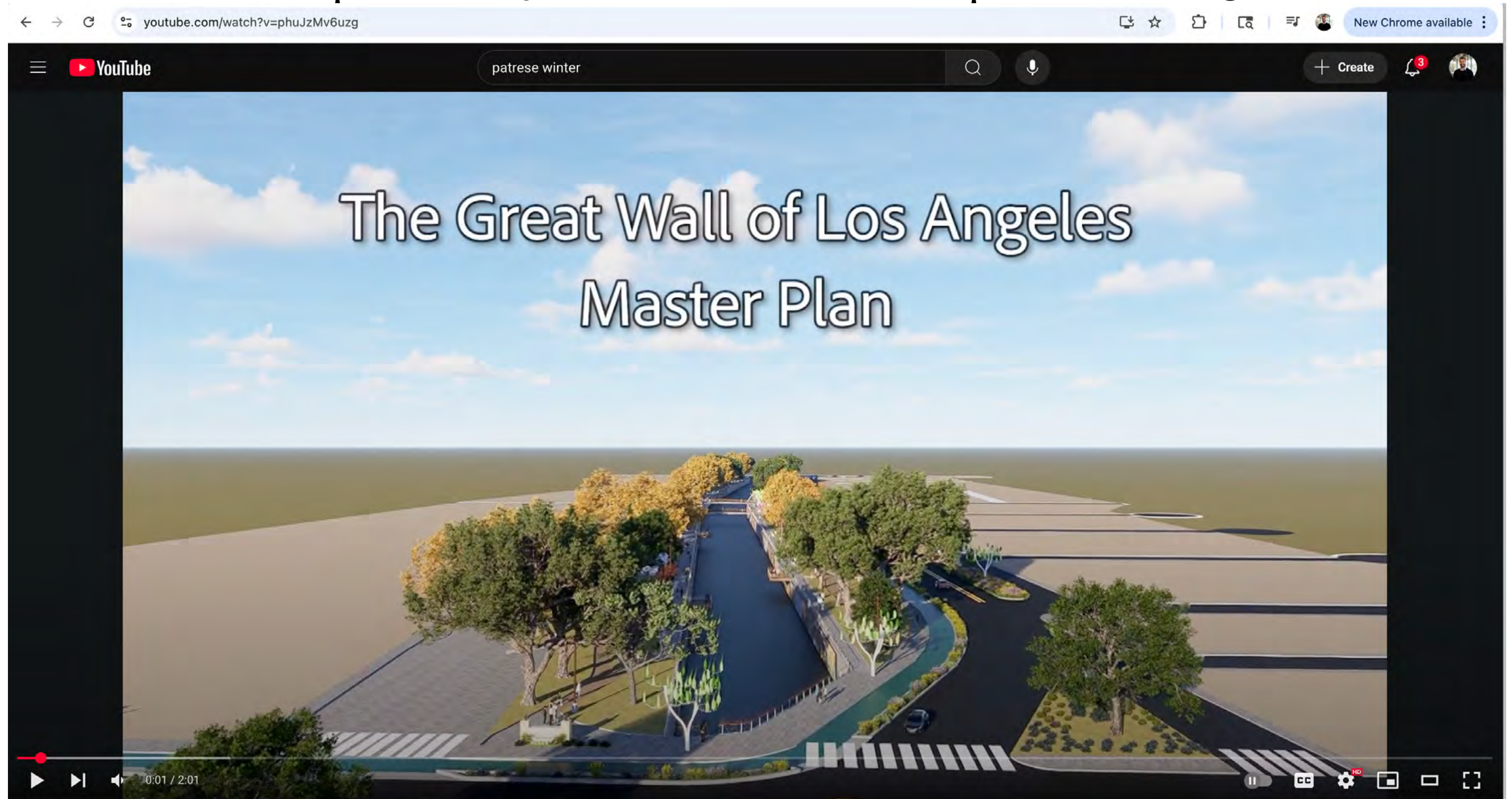

The Great Wall of Los Angeles Park Master Plan | Patrese Winter

 Patrese Winter
1 subscriber

[Analytics](#) [Edit video](#)

[Like](#) 1 [Dislike](#) [Share](#) [Ask](#) [Promote](#) [More](#)

All From your search From Patrese Winter >

FINAL THOUGHTS

Completing this project is more than the close of a studio—it’s a tribute to history, memory, and the communities whose stories shape us. In reimagining the park of the Great Wall of Los Angeles, I’ve not only explored the landscape but also the threads of resilience, justice, and belonging woven into it. This is where design becomes storytelling, where space honors spirit, and where the past inspires a more inclusive and hopeful future.



I am deeply grateful to Professor Steven Chavez for his guidance and for encouraging me to fully explore my ideas. I also want to acknowledge my classmates, whose creativity and energy constantly inspire me and remind me that this is not a solitary journey. As we celebrate our two-year milestone in the program—with only one year ahead—I carry with me the joy, motivation, and camaraderie that make this path so much more meaningful and fun.

— Patrese Winter