

Heritage to Horizon:

REIMAGINING THE KEN DYDA CIVIC CENTER

CATHERINE EISENBERG
UCLA EXTENSION LANDSCAPE ARCHITECTURE
CAPSTONE 2025
INSTRUCTOR: MEG COFFEE



TABLE OF CONTENTS

INTRODUCTION		49	Area 3 Enlargement: Renewable Peninsula
04	Project Statement	50	Renewable Peninsula: Section Elevation
05	Project Justification	51	Renewable Peninsula: Perspectives
		52	Plant Palette
RESEARCH + ANALYSIS		CONCLUSION	
06	Site History	53	Goals Achievement Evaluation
08	Site Location	54	Citations
09	Zoning		
10	Landmarks		
11	Views		
12	Cultural Adjacencies		
13	Site boundaries + Features		
14	Existing Features + Built Amenities		
18	Goals + Objectives		
22	Design Methodologies		
24	Users + Stakeholders		
25	Program Elements + Space Needs		
26	Site Analysis		
30	Site Constraints		
31	Site Opportunities		
32	Design Precedents		
CONCEPT DEVELOPMENT			
35	Design Metaphor		
36	Concept Development		
MASTER PLAN DESIGN			
42	Illustrative Plan		
43	Area 1 Enlargement: Civic Duties		
44	Civic Duties: Section Elevation		
45	Civic Duties: Perspectives		
46	Area 2 Enlargement: Re-wilding		
47	Re-Wilding: Section Elevation		
48	Re-Wilding: Perspectives		

PROJECT STATEMENT

The Ken Dyda Civic Center is envisioned as a model of sustainable landscape design—one that **honors** the rich ecological heritage of the Palos Verdes Peninsula while embracing innovative infrastructure for the **future**.

Through the **thoughtful integration** of drought-tolerant native gardens, inclusive pathways, and adaptable outdoor community spaces, the design establishes a **vibrant civic landmark**. It enhances **ecological health** and resilience, strengthens **community** connections, and reflects the distinctive coastal **character** of Rancho Palos Verdes.

PROJECT JUSTIFICATION

The Ken Dyda Civic Center, a former Nike missile site that has housed Rancho Palos Verdes City Hall since the mid-1970s, requires comprehensive landscape renovation to create a cohesive connection between municipal buildings while addressing the underutilized outdoor spaces that currently lack organization and an identity reflective of the Peninsula's unique coastal character.

Currently RPV has no true space for the community. While services exist at public parks, there is no dedicated indoor space where residents can gather for classes, recreate, connect or even come together during an emergency - this became ever more evident after the severe Portuguese Bend landslide in 2024. In this coastal community, natural disasters are a serious consideration and while the current city hall houses many of the cities resources, the public do not have a safe space to go to in the case of disaster.

The land requires modernization to address accessibility challenges, incorporate sustainable water management systems including stormwater management, protect the fragile ecosystem and to create a more welcoming community hub for residents of all ages and abilities. Currently the aging civic center contains disconnected outdoor spaces which include a tennis court, a helipad, a seating area with a barbecue, a dog park and an open grassy area.

The vision for the civic center is that it that serves as the heart of community in RPV by offering a range of programming such as: indoor and outdoor spaces for community gatherings, passive recreation, tourist view points and possibly even event rentals. This space deserves to be celebrated through a thoughtful and careful design that not only highlights the natural ecology and beautiful views of the existing land but also utilizes the civic space in a way that serves the community needs.

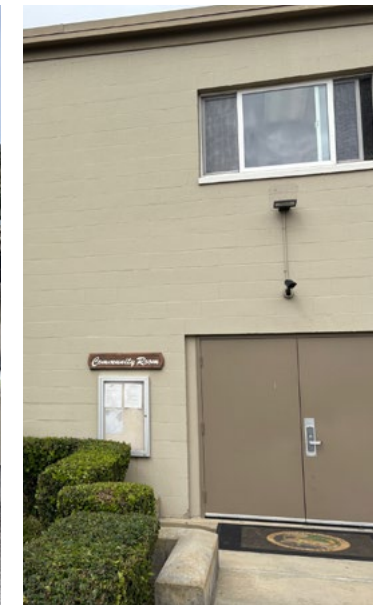

HISTORY

Tongva Inhabitants:
The Palos Verdes Peninsula was a home to the Tongva people for thousands of years, with archaeological evidence indicating long-term settlement.



Rancho de los Palos Verdes:
In the early 1800s, Juan Jose Sepulveda began using a portion of this land for cattle, which was formally granted to his family in 1846 as the 31,629-acre Rancho de los Palos Verdes.



Frank Vanderlip's Vision:
In 1913, Frank Vanderlip, an east coast banker, purchased the Rancho de los Palos Verdes property to establish a planned community.



Peninsula Plans:
In the 1930's there was an original plan for the entire peninsula. But then each city developed slowly and in their own way. In the 40's and 50's The Gruen plan was an idea for a peninsula-wide plan before the housing boom of the grandview neighborhood. It included a peninsula center, research park, places for recreation and a golf course. This never came to fruition but had the idea of larger gathering spaces for the whole community.



RPV Incorporated:
As a planned community with a desire to preserve its natural beauty, the city of Rancho Palos Verdes was incorporated on Sept 7, 1973, becoming the last of the four cities on the Palos Verdes Peninsula to do so. The others being Rolling Hills, Rolling Hills Estates, and Palos Verdes Estates.



Rancho San Pedro:
In 1784, the area became part of Rancho San Pedro, a vast Spanish land grant to Manuel Dominguez.



Early American & Development Era Cattle and Agriculture:
The land was used for cattle ranching and later, in the late 19th century, by Japanese farmers who cultivated crops like beans, peas, and tomatoes.



Palos Verdes Estates:
Frank Vanderlip formed a land syndicate and development trust, leading to the creation of Palos Verdes Estates in 1923, a planned community with deed restrictions to control its development.



Missile Site:
The LA-55 Nike missile site in Rancho Palos Verdes, CA was established in 1956 and remained in use until 1974. It was one of 16 Nike missile sites set up in Southern California during the 1950s as part of the "Ring of Steel" defense system. These sites were designed to protect against potential Soviet nuclear attacks. This site housed everything needed to run the facility including: missile silos, bunkers, facilities for people to stay, and a command station. The radio control stations were located at Del Cerro (now taken down). The gun placements were placed to target enemy aircraft and were meant to facilitate the protection of the shore. Eventually the missile sites became obsolete and were shut down by the Federal Government

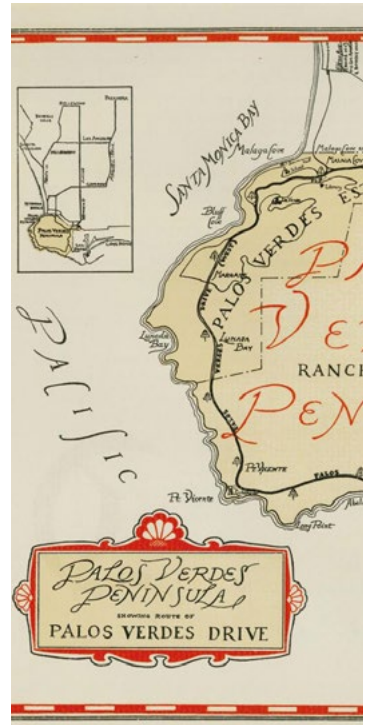

New City Hall:
1975 The newly incorporated city moves to its new city hall. The City's General Plan, states on page 86: "City offices are located on the Nike Missile Site under an interim lease. The City's goal is to acquire this site when it is finally disposed of by the Federal Government. It is the City's intent to use the site for a civic center and parkland. While the Nike Site is not in the geographic center of the City, it has the potential for becoming a strong focal point for the community."

HISTORY

CONTEXT | Site Location

**Ken Dyda Civic Center and Rancho Palos Verdes City Hall
30940 Hawthorne Boulevard,
Rancho Palos Verdes, CA 90275**

Site info

The Ken Dyda Civic Center encompasses Point Vicente Park, Rancho Palos Verdes City Hall and other city related maintenance areas. It is surrounded on the southern perimeter by Alta Vicente Nature Preserve. There are remains of the site's historical past which includes an empty 5,000 sq ft coast guard bunker and other various remnants of a cold war era military presence.



State of California



County of Los Angeles

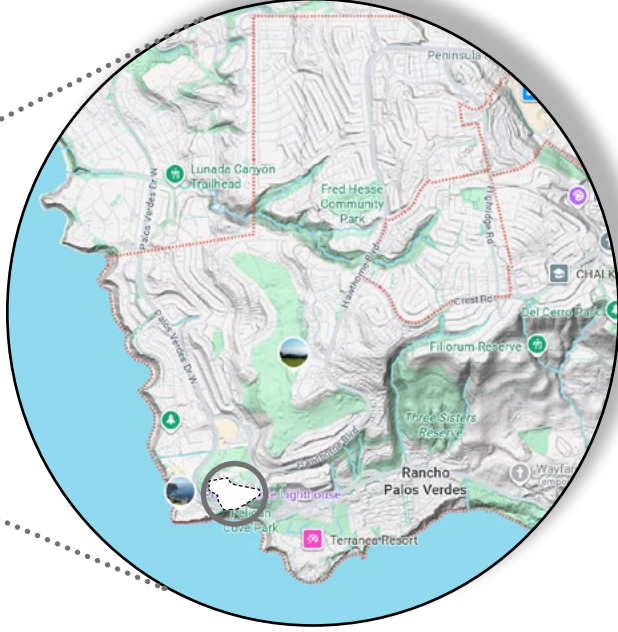

City of Rancho Palos Verdes

Site Specs

County: Los Angeles
Size: 261,454 Sq Ft
Ownership: City Council
Zoning: Institutional, public
APN number: 7573-006-024
Parcel Number: 056201002
AIN: 7573002913, 7573002908
City and community: 104, 4th district

Existing buildings: Rancho Palos Verdes started leasing the land from the federal government in 1975, then the buildings and land were deeded to the city in 1978. Since 1979 City Hall offices have been housed in the circa 1950s military buildings with the addition of multiple temporary trailers over the years.

CONTEXT | Zoning

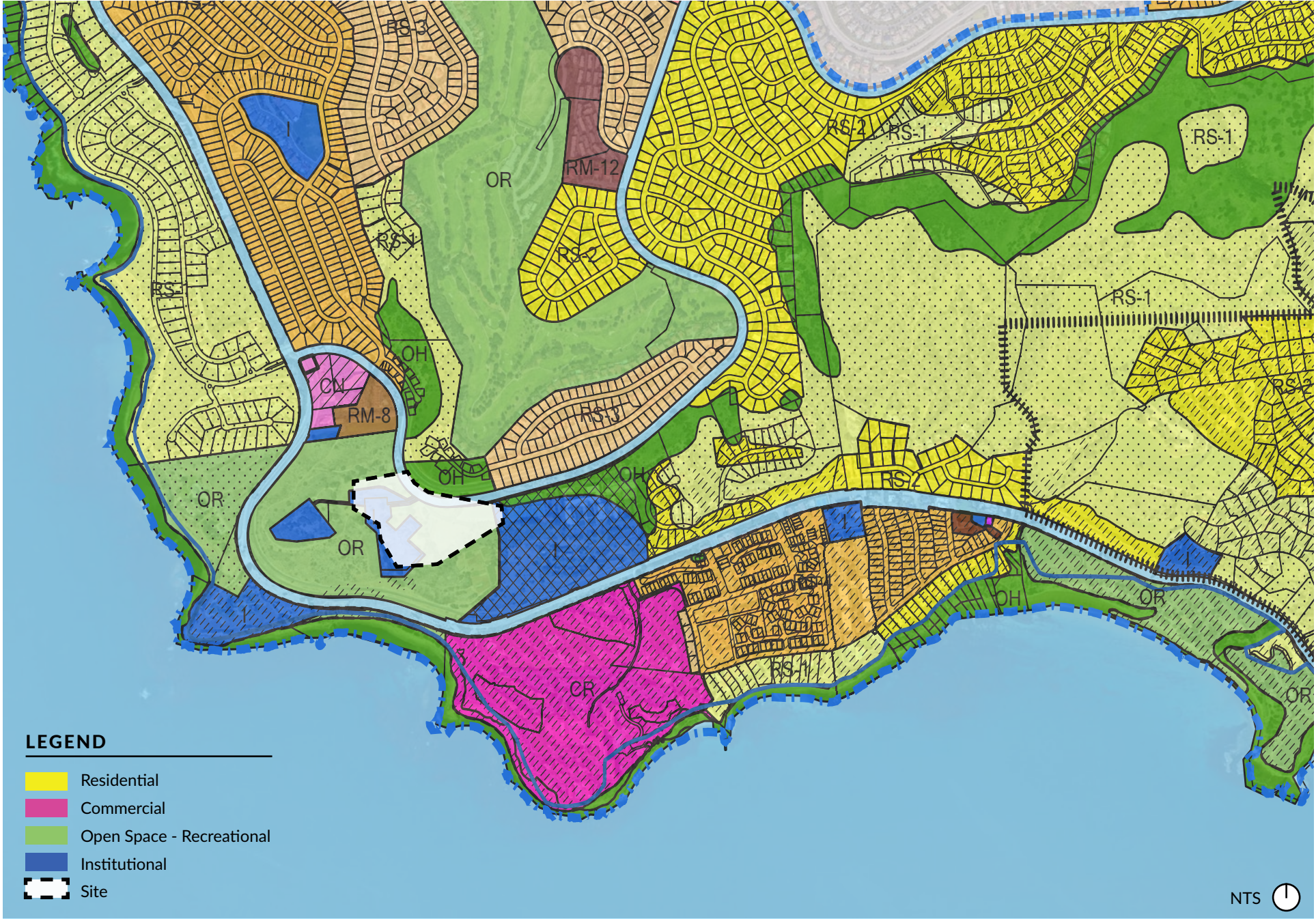

LEGEND

- Residential
- Commercial
- Open Space - Recreational
- Institutional
- Site

NTS

CONTEXT | Neighboring Landmarks



CONTEXT | Views



CONTEXT | Cultural Adjacencies

The **Olmsted Brothers** created a regional plan for Palos Verdes in 1915. Although not all of the original 16,000 acres were developed according to the Olmsted plan, the team's influence is still visible today. Most notably in the Malaga Cove Plaza and Library, Farnham Martin's Park and Catalina View Gardens.

The peninsula has been a popular backdrop for numerous **films and television shows** including: Inception, Pirates of the Carribean movie franchise, Dunkirk, 50 first dates, Step Brothers, Charlie's Angels, and the Lethal Weapon movie franchise. TV shows include: The O.C., True Detective, Lucifer and Beverly Hills 90210.

Wayfarer's Chapel was designed in 1951 by **Lloyd Wright**, perched on a bluff overlooking the Pacific. It stood as a stunning embodiment of organic modernism. Due to the extreme landslides of 2024, the church is currently dismantled - awaiting it's new location to be decided.

NTS

CONTEXT | Site Boundaries + Features

RPV City Hall
 Parking
 Main Entrance
 Park Ranger Trailer
 Point Vicente Park
 Tennis Courts
 Overflow Parking Lot
 Coast Guard Bunker
 Dog Park
 Helipad
 Hiking Trails
 Maintenance Yard and RPVtv
 Alta Vicente Nature Reserve
 Views to Pacific Ocean

50' 150'





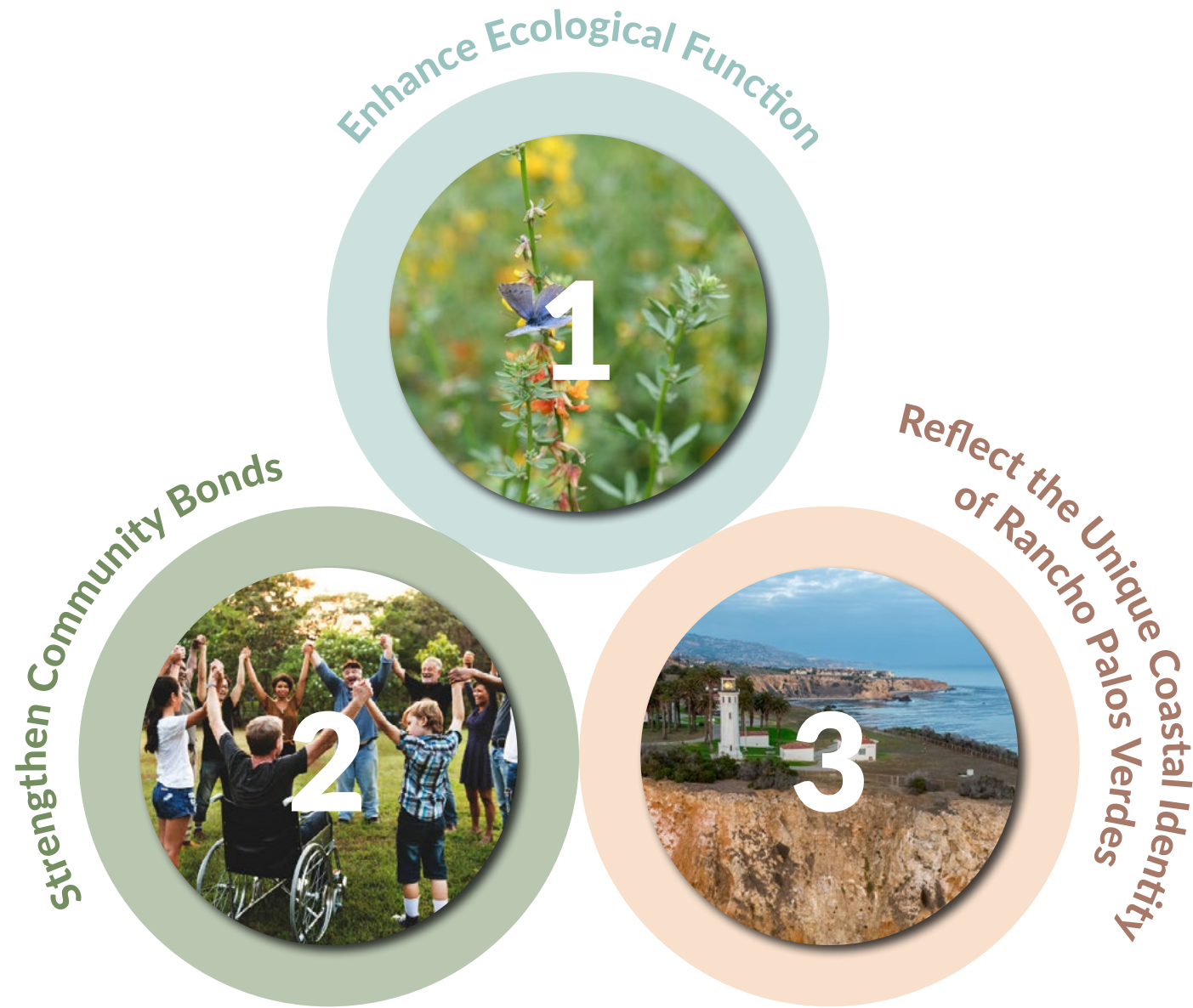

Enhance Ecological Function

OBJECTIVES AND PROGRAM



Promote Natural Heritage

- Honor biodiversity through extensive use of native plant communities.
- Plantings that serve both human needs and supports native wildlife.
- Create habitat that supports the endangered Palos Verdes Blue Butterfly.



Protect from Threats

- Prioritize locally-adapted vegetation with a focus on native plants to create a resilient landscape.
- Fire resilient landscaping methods for habitat creation.



Demonstrate Municipal Leadership in Environmental Stewardship

- Sustainable stormwater management solutions like: added bioswales, underground cisterns for rainwater harvesting and reuse on site.
- Adaptive reuse of materials on site
- Updated village green meeting LEED open space criteria
- Plant screening for maintenance enclosures

Strengthen Community Bonds

OBJECTIVES AND PROGRAM



Spaces for Gathering: Indoors

- Open Layout Community Center with multipurpose rooms to be used for a variety of uses like: classes, yoga, education, and spaces for art.
- Expanded public restrooms and facilities
- Reception/info center
- Revenue generating elements like:
 - Multipurpose event space
 - Coastal Cafe
 - Leasable office space

Spaces for Gathering: Outdoors

- Outdoor flexible spaces that have ample shade.
- Expanded village green
- Amphitheater built into the existing grade with 500-person capacity and permanent outdoor stage.
- Outdoor picnic areas
- Trailhead facilities for connections to the surrounding Nature Preserve.

Offer Opportunities for Education

- Improved wayfinding with information relating to ecological and historic heritage.
- Educational signage throughout park
- Entry signage in honor of the historic heritage of the site

Reflect the Unique Coastal Identity of Rancho Palos Verdes

OBJECTIVES AND PROGRAM



Create Atmosphere

- Use local materials and design elements that reflect unique features of the peninsula
- Biophilic City Hall offices
- Open concept City Hall with glass walls to maximize views
- Educate visitors about the site's evolution through thoughtful interpretive elements, wayfinding, and displays throughout the landscape
- Welcome plaza with shade structures

Ensure Easy Access for Everyone

- ADA accessibility to all program areas
- Enhanced park entrance with clear signage for more street visibility
- Easy to read signs and wayfinding at trail entrances and educational signage
- Sustainable parking lots providing shade
- Improved pedestrian circulation
- Easily accessible dog park with ample shade and seating

Increase daily facilities

- Public restrooms in multiple locations
- Water stations throughout the park
- Increase trash cans
- Easily accessible paths to hiking trails
- Bike storage and locks
- Main entry for loading and drop off or pickup.

DESIGN METHODOLOGIES



Frederick Law Olmsted

- Keeping in line with the Olmsted brother's design of the Malaga Cove Plaza and Library in Palos Verdes Estates, the design will emphasize the "genius of place" to create a democratic space that can bring diverse social classes together.
- Careful orchestration of movement to create designed circulation systems that support sequential experiences for all visitors.
- Using programmatic flexibility "greenswards" and open areas that can accommodate various activities, allowing the community to adapt spaces for their changing needs.
- Orient major spaces to maximize views.
- Integrate the infrastructure within naturalistic designs.
- Particular attention to edges and transition zones between different landscape types.
- Olmsted believed that landscape can contribute to the well-being of individuals and society as a whole.

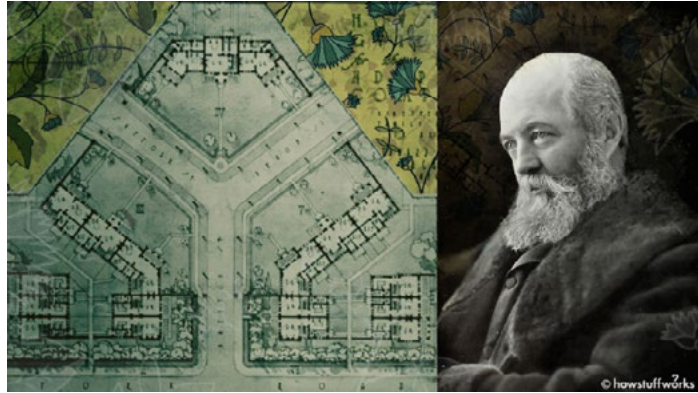

Goals: Enhance Ecological Function Strengthen Community Bonds Reflect Unique Coastal Identity



A Pattern Language

By Christopher Alexander, Sara Ishikawa and Murray Silverstein

- A Pattern Language's fundamental premise is that "people should design for themselves their own houses, streets, and communities." Emphasizing the human scale approach to design.
- Positive Outdoor Space: Ensure outdoor areas feel enclosed and comfortable. Create comfortable outdoor rooms with the help of tree places.
- Pedestrian priority: design walkways and paths that prioritize human movement.
- Integrate building and landscape: ensuring buildings relate to each other and open onto meaningful outdoor spaces.
- Use garden walls to provide seating and define spaces along with water features as a focal point and cooling element.
- Human scale considerations: views and vistas, sheltered outdoor spaces and seating arrangements at conversation distance.

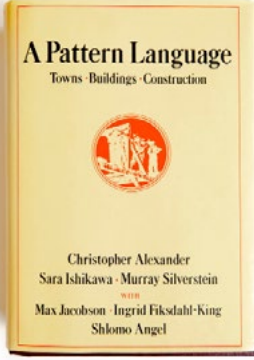

Goals: Enhance Ecological Function Strengthen Community Bonds Reflect Unique Coastal Identity

DESIGN METHODOLOGIES



Design with Nature

By Ian L. McHarg

- Using a holistic, ecologically-informed approach to planning and design with an emphasis on sustainability.
- Considering ecological determinism to define the natural features of the site, including hydrology, vegetation, and topography before and during the design process. This view of natural processes will help guide design decisions.
- Using the overlay analysis to place buildings on the most geologically stable areas with minimal disruption to natural drainage. Orienting buildings to capture ocean breezes for passive cooling while protecting against strong winds.
- Align roads and pathways with natural contours to minimize grading and maximize arrival sequence that reveals views progressively.
- Design bioswales and retention areas that follow natural drainage patterns to maximize stormwater management efficiency.
- Preserve existing native plant communities where possible and design new landscapes that extend and connect these communities to create habitat corridors.
- Link the city hall landscape to larger peninsula systems.

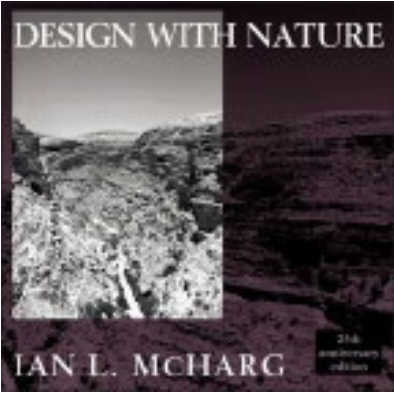

Goals: Enhance Ecological Function Strengthen Community Bonds Reflect Unique Coastal Identity



Low Impact Development, LID

- Use the idea of Infiltration, filtration and evapotranspiration to reduce the volume and flow rate of surface runoff into the ocean.
- Roof water management will help control the water flow at the building scale.
- Design architectural ways of capturing water along the building perimeter.
- Use permeable paving as much as possible, especially taking advantage of the chance to capture water in the parking lot, parking medians, tree wells and bio-retention cells between parking bays.
- Use decorative boulders, decomposed granite and other natural materials to create dry creek beds that activate during rain events and create an entry sequence.
- Utilize demonstration gardens as a change for a "learning lab" with signage explaining how the water features work and interactive elements.
- Convert standard curb cuts and gutters to directing water into bioswales.
- Combine LID with bicycle lanes and pedestrian movements to create a complete street integration.

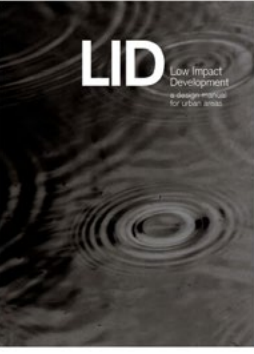

Goals: Enhance Ecological Function Strengthen Community Bonds Reflect Unique Coastal Identity

PROGRAMMING | Users + Stakeholders

Rancho Palos Verdes Demographics Overview

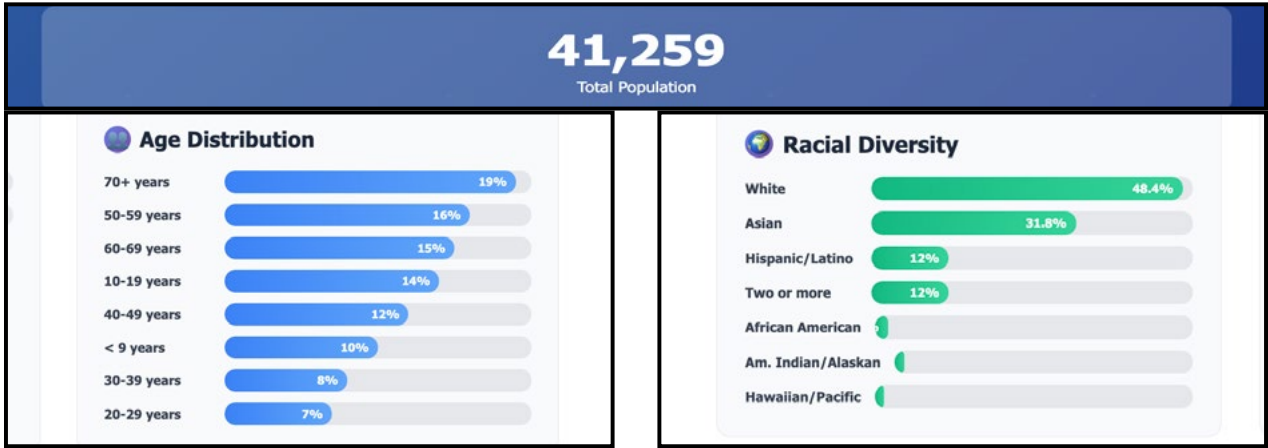

- Over 50% of the population is over the age of 50.
- Gender mix is 50/50.
- The racial diversity is predominantly White and Asian.
- Over a quarter of the population is foreign-born.

Current Users

City Hall Visitors & Staff



- 65 full time employees and staff at City Hall
- Part time employees and staff at City Hall
- Park Rangers and associated staff
- RPVtv staff

Recreationalists



- Local residents of all adjacent neighborhoods
- Tourists and visitors
- Tennis players and active recreation seekers
- Dog Owners
- RC Helicopter flyers
- Hikers and passive recreation seekers

Stakeholders

- Employees and staff at City Hall
- Park Rangers and associated staff
- RPVtv
- Palos Verdes Conservancy
- City of Rancho Palos Verdes



Wildlife and Flora



- Palos Verdes Blue Butterfly
- Palos Verdes Conservancy
- Local wildlife

PROGRAMMING | Space Needs + Program Elements

1. Community Hub (Total 24,080 GSF)

- Council Chambers & Public Engagement
- Community Center
- Cultural & Recreation Facilities

2. Administrative Complex (Total 35,590 GSF)

City Hall Departments

3. Landscape and Outdoor Amenities (7.9 acres total)

Open Space (7.9 acres total)

Active Recreation

Trails & Access

4. Supporting Infrastructure (Total 28,414 GSF)

Public Safety Facilities

Utilities & Site Infrastructure

Transportation & Access

The total civic center encompasses 18.9 acres with a gross building total of 665,887 GSF, representing a modern, integrated municipal complex designed to serve both administrative functions and community needs.

Design desires

- Community Center with large space for classes, rentals, etc.
- Large open outdoor space for long standing community events
- Passive recreation
- Better wayfinding and pedestrian circulation
- A space that reflects the peninsula culture and gives more identity to the civic center
- More designated habitat for wildlife and pollinators
- A space for smaller gatherings outdoors
- Multiple event spaces, possibly for rentals like weddings
- Trailhead facilities for entrances to Alta Vicente Preserve, building connections to network of trail systems

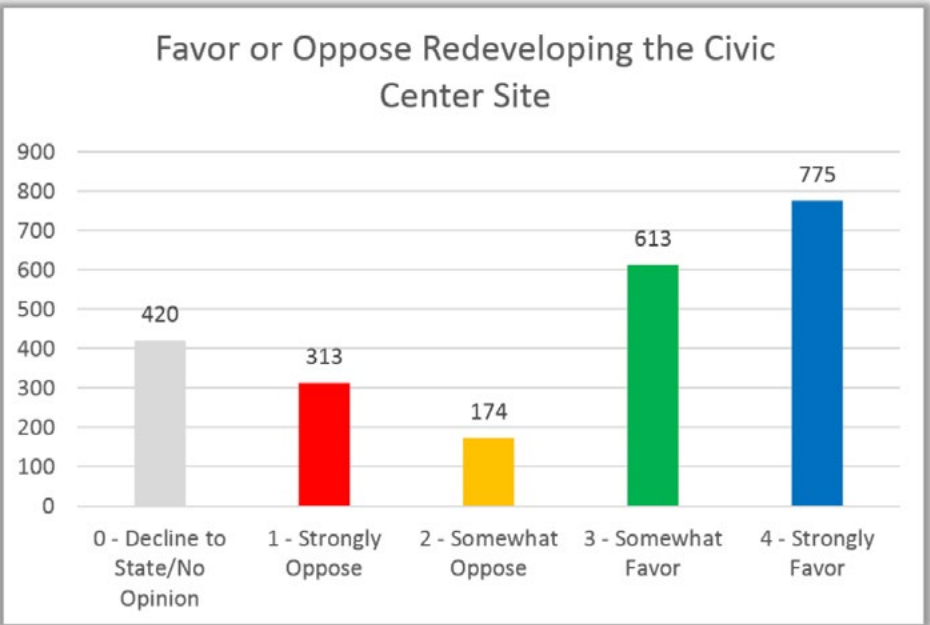

Results from a 2016 poll of what the community wanted out of the possible remodel of the Ken Dyda Civic Center

SITE ANALYSIS | Wildfire + Landslide Hazards

Fire Severity Zones

The site is in a very high fire severity zone. The design needs to be conscious of firescaping and using the landscape to minimize damage during a fire event.

Landslide Zones

The site is not in a landslide zone and is about a 10 minute drive from the well known Portuguese Bend Landslide Area.

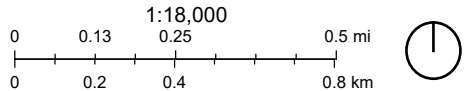
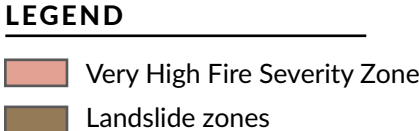

SITE ANALYSIS | Palos Verdes Blue Butterfly Ranges

The ranges of 2 species of the 4 endangered Blue Butterflies along the Peninsula's coast. The Palos Verdes blue (*Glaucopsyche lygdamus palosverdesensis*) is a small endangered butterfly native to the Palos Verdes Peninsula. As its distribution has been proven to be limited to one single site, it has one of the best claims to being the world's rarest butterfly.

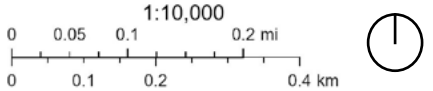
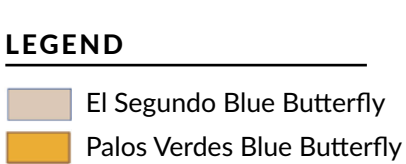
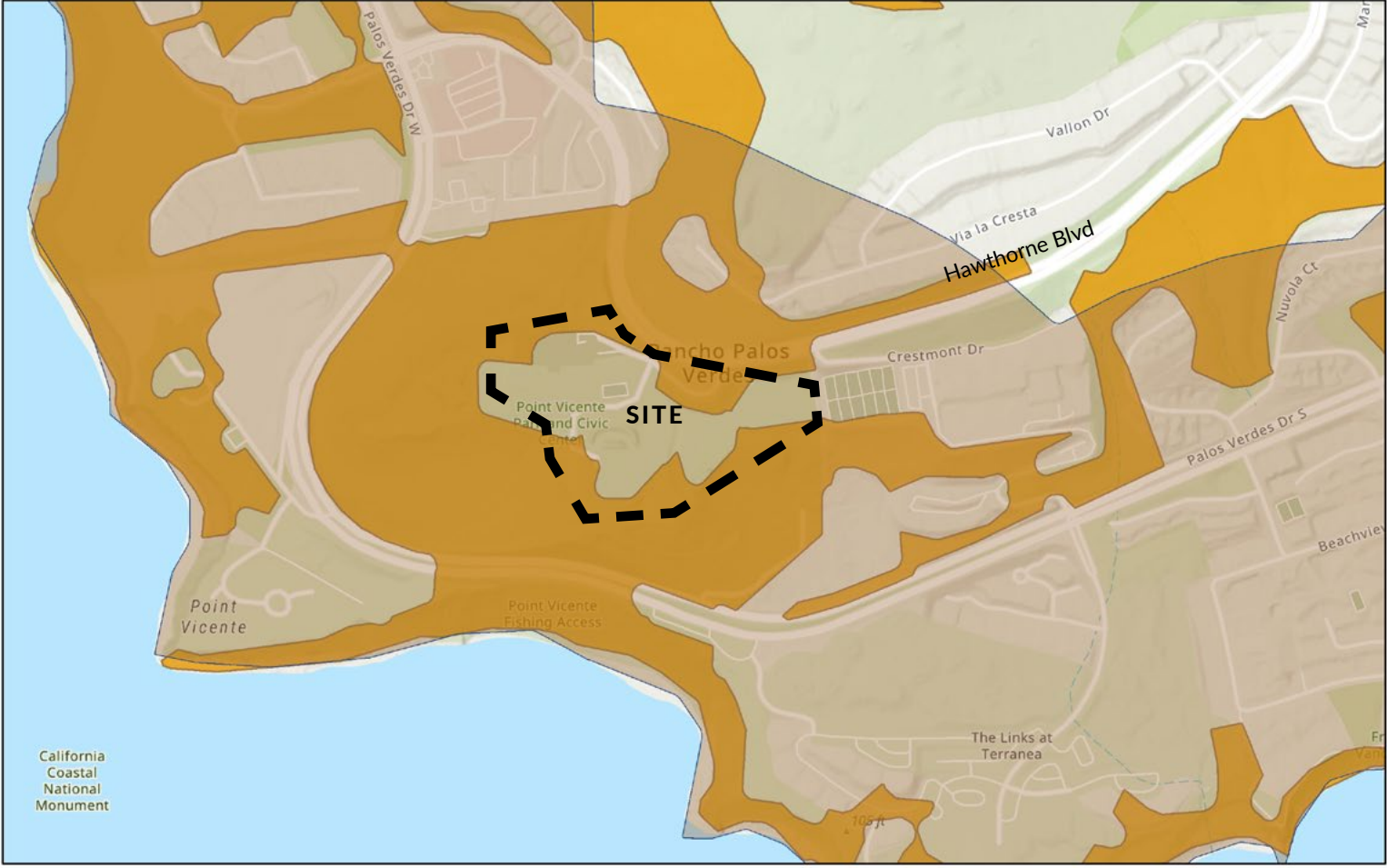

SITE ANALYSIS | Topography

The topography of the site is quite varied. The northern end is higher and it gradually slopes down to the southern end. The entry is at the highest point which makes the site difficult to see from the road. Just outside of the site boundary are steep hillsides.

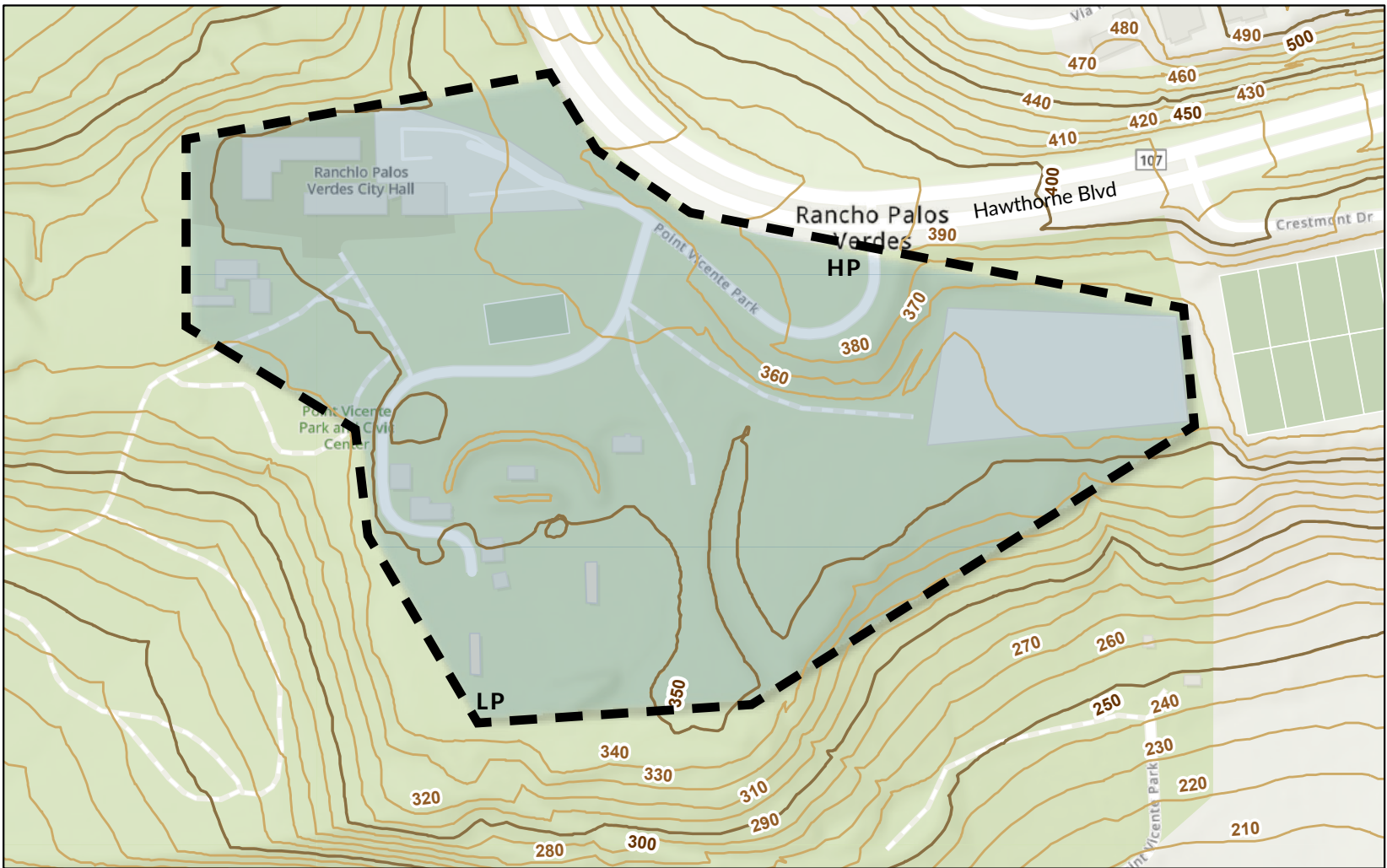

LEGEND
 — Elevation - Contours 50ft
 — Elevation - Contours 10ft

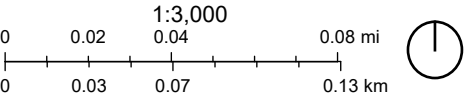

SITE ANALYSIS | Land Use / Circulation / Tree Canopy

This map shows how the site is currently used. It is clear that there is a lot of unused space and parking with disjointed amenities. The tree canopy is fairly limited leaving a lot of hot, exposed areas especially on the east side of the site.



LEGEND

Buildings/structures	Current recreation space	Vehicular Circulation	Existing Tree Canopy
Parking	Unused space	Pedestrian Circulation	
Steep Hillside	Helipad	Main Entry and Exit	

Total Square Footage:
822,179 sq ft (18.9 acres)

PRECEDENT 1

Long Beach Civic Center

The Long Beach Civic Center Master Plan revitalizes 22 acres of downtown Long Beach, creating a vibrant mixed-use district. The plan includes a new City Hall and Port Headquarters, the Billie Jean King Main Library, and the reactivation of historic Lincoln Park. It also establishes design guidelines for new residential units and commercial development, and integrates the city grid with the regional bike network, buses, and the Metro Blue Line. Made possible by a catalytic investment from Plenary Edgemoor Civic Partners, this massive undertaking was delivered through an innovative public-private partnership. Certified LEED Gold for New Development, the new Civic Center plan optimizes operations and maintenance, provides street parking, introduces plazas and promenades, and expands bike infrastructure to create a series of inviting and memorable places.

Designer: GGNLtd and Bennitt Design Group

Project type: Re-design of mixed-use district

Client: Plenary Group - Los Angeles

Former land use: Re-design of existing structures and park

Location: 333 West Ocean Boulevard, Long Beach, California 90802

Size: 22 acres

Program: New City Hall, and Port Headquarters, Billie Jean King Main Library, reactivation of historic Lincoln Park

Completion date: 2021

Sustainability: Certified LEED Gold for New Development

Key Takeaways:

- Expanded bike infrastructure
- Sustainable streetscape design
- Pedestrian pathway connections and sidewalk configurations in conjunction with density of tree planting create a sense of place.



PRECEDENT 2

Newport Beach Civic Center Park

Once a wide median strip between two vehicular thoroughfares, the site was transformed to become Newport Beach Civic Center Park – 16-acres of civic and ecological parklands fit for an active residential city. With spaces for governmental and social activities that are both functional and symbolically charged, it also lies at the very heart of the community.

More than 100 species of plants were selected for a variety of unique landscape zones, including the Desert Garden, Torrey Pine Grove, Coastal Sage Scrub Gardens, urban runoff and detention wetlands, meadows, and more. Custom-designed furniture punctuates the park, providing refinement and coherence within a wilder setting. Transplanted palms from the previous City Hall site are an example of the conservation of resources and highlight the California horticultural heritage of the city.

The park has been embraced by people, their pets, and wildlife for its vibrant and self-sustaining ecologies, horticultural diversity, art, neighborhood amenities, and educational experiences with nature.

Designer: PWP Landscape Architecture

Project Type: Civic Center redesign

Location: 100 Civic Center Dr, Newport Beach, CA 92660

Program: New City Hall, expansion of existing library, a parking garage and a new 14-acre park

Completion Date: 2013

Client: City of Newport Beach, CA

Sustainability: High ecological standards, Criteria of LEED and strict water conservation goals

Key Takeaways:

- A civic/government facility surrounded by a park that the local community uses
- Maintaining high ecological standards, water conservation goals and criteria for LEED status
- Accentuating horticultural diversity for different, unique landscape zones



PRECEDENT 3
Del Mar City Hall and Town Hall

Located on a 1.5-acre property adjacent to Camino Del Mar, the town's main thoroughfare, the Civic Center functions as a series of interconnected structures, courtyards and terraces and open spaces that follow the contours of the site, while preserving spectacular views of the Pacific Ocean. The complex includes a 3,000-square-foot Town Hall, a 9,000-square-foot City Hall, a 20,000-square-foot Town Commons, as well as parking for 140 vehicles, most of which is discretely tucked below the complex. The majority of the site is dedicated to public open space with planted gardens, active and passive courtyards, and an area for the community farmer's market. The Civic Center's design is derived from its local context: residential in scale and built using warm, natural materials, such as wood and colored concrete inspired by the sandstone bluffs below. The shape and massing of the Center take direction from other beloved buildings in the neighborhood, like St. Peters Church, for example. The horizontal low rooflines, the cupola overhang, and the use of green spaces provide an aesthetic consistency, and assure residents of Del Mar that the new center will feel distinctly of Del Mar.

Designer: Spurlock Landscape Architects, Miller Hull Partnership, LLP

Project type: Civic

Client: City of Del Mar

Location: 1050 Camino Del Mar
 Del Mar, CA

Size: 1.5 acres

Program: New City Hall and town hall, town commons and connected outdoor spaces

Completion date: 2018

Sustainability: Complex was designed for net zero operations

- Key Takeaways:
- Using local context to inspire materials and atmosphere
 - Uniting administration, recreation and identity while embracing the natural contours of the site

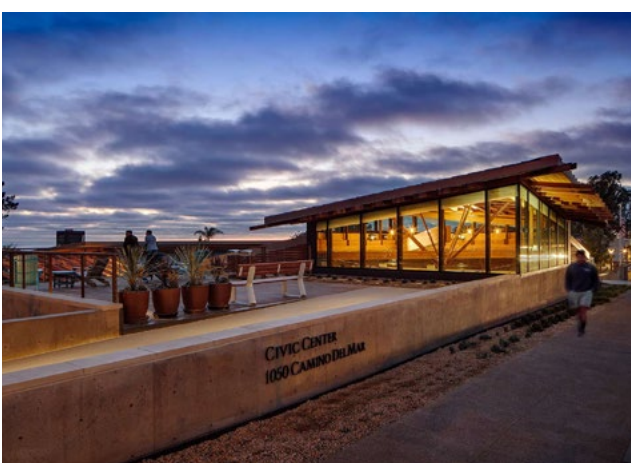

DESIGN | Concept & Metaphor



To Sea (to the Horizon)

The reimagined Ken Dyda Civic Center is conceived as a civic landscape that looks “to the horizon”—a metaphor for stewardship, resilience, and building for future generations. The design draws from the natural contours of the Palos Verdes Peninsula, creating a seamless journey from active, community-focused spaces at the north end to contemplative, nature-driven experiences at the south. With drought-tolerant native gardens, inclusive pathways, and flexible outdoor spaces, the civic center strengthens ecological health while serving as a cultural and recreational heart for Rancho Palos Verdes. Celebrating both land and sea, it frames iconic views and establishes a forward-looking model of sustainable civic design.



DESIGN | Preliminary Concept 1: Light on the Land

- Enhance Ecological Function
- Strengthen Community Bonds
- Reflect Unique Coastal Identity

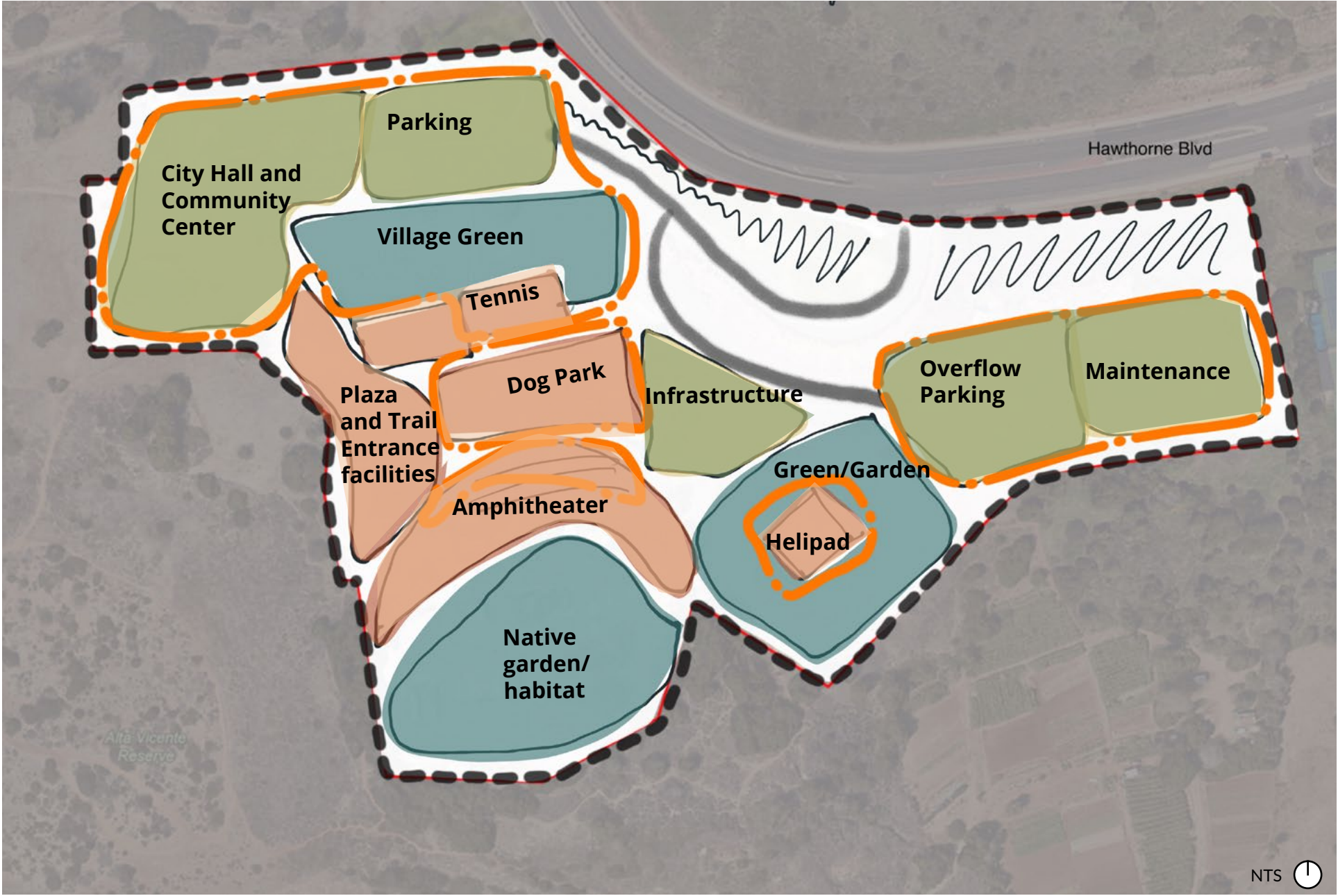

DESIGN | Preliminary Concept 1: Light on the Land

This design focuses on the adaptive reuse of existing materials and elements. Everything from the original function of site amenities to keeping and reusing materials on site or re-purposing construction materials. This environmentally sustainable way of rehabilitating a mixed used space creates the opportunity to showcase the local history while creating long lasting features for the future.

Concept Sketch

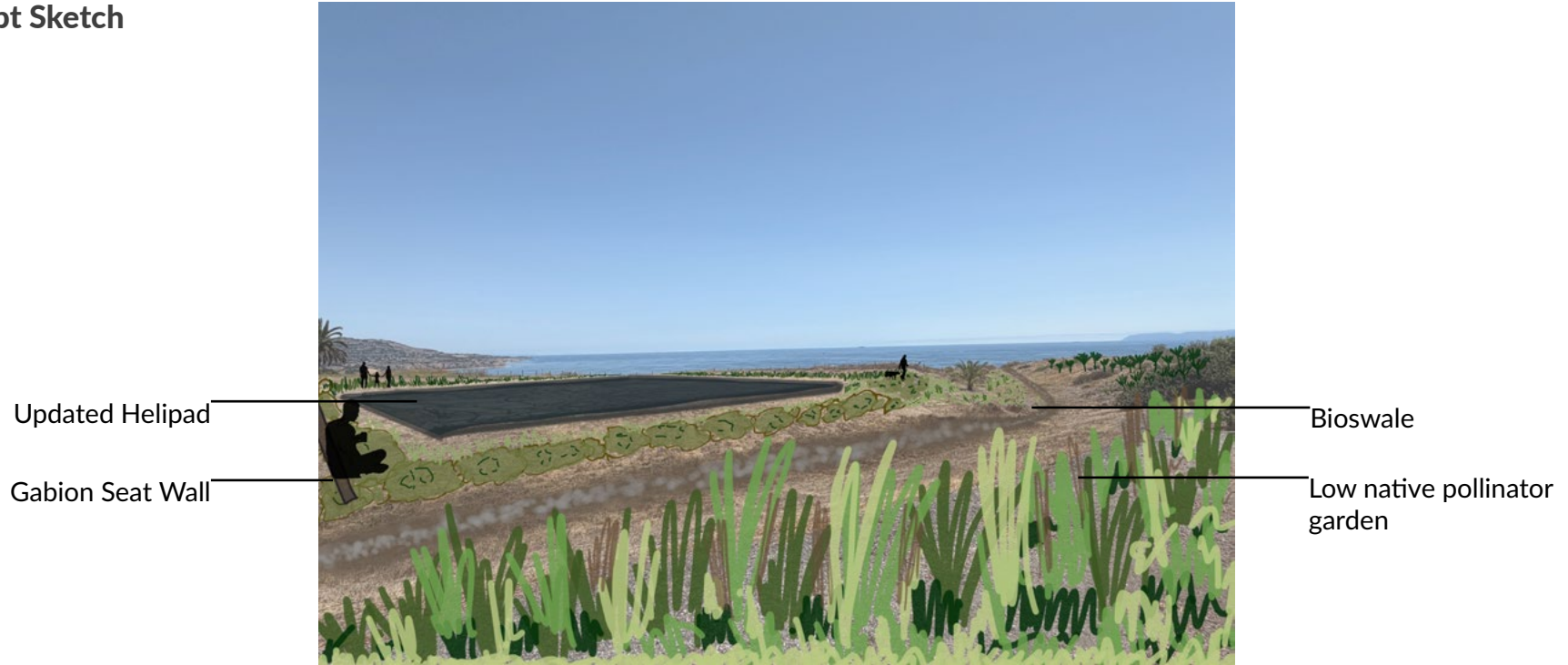

Inspiration



Reclaimed wood from a railroad Gabion walls for seating opportunities Stone slabs reused as pavers

DESIGN | Preliminary Concept 2: The Agora

- Enhance Ecological Function
- Strengthen Community Bonds
- Reflect Unique Coastal Identity

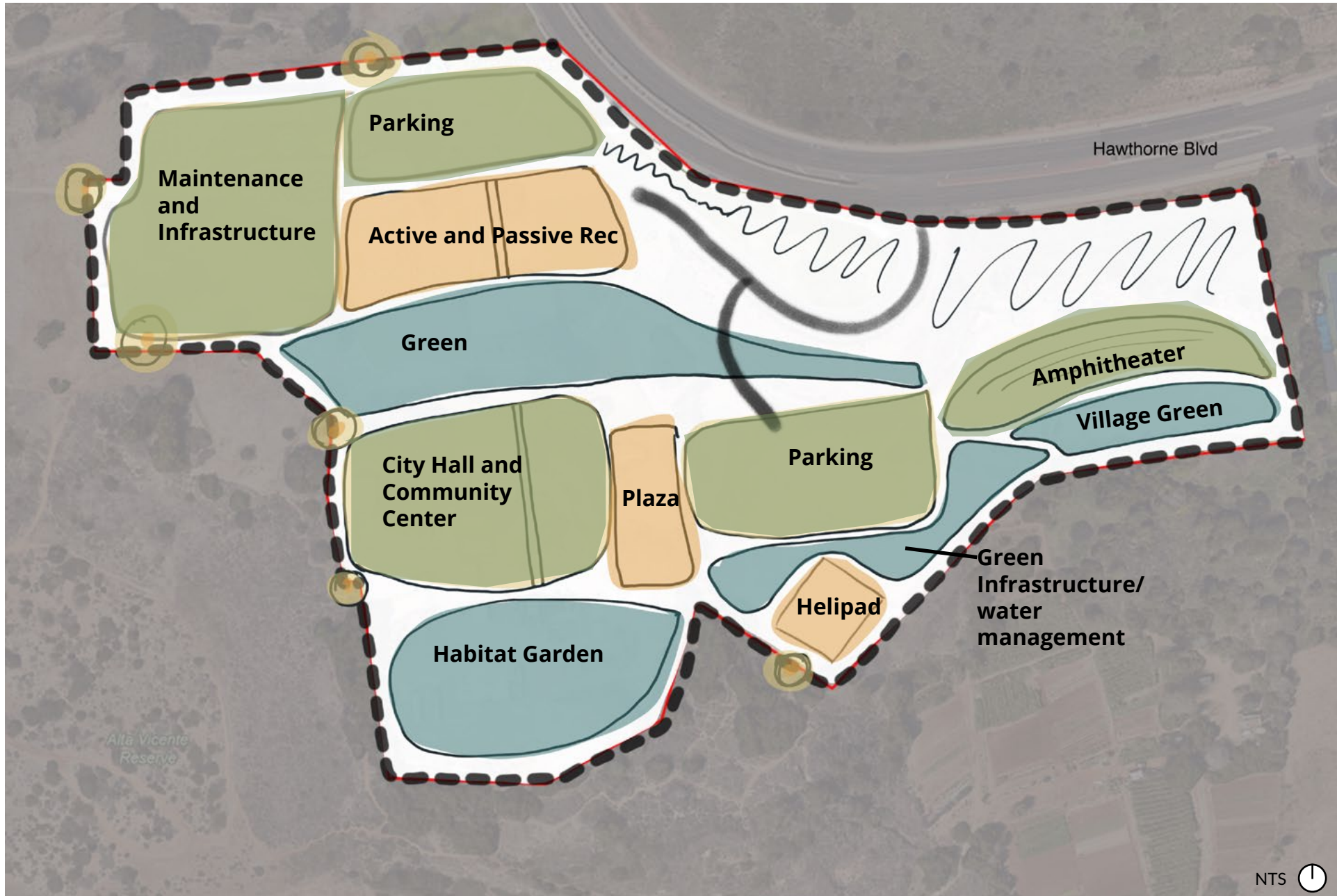

DESIGN | Preliminary Concept 2: The Agora

This design is inspired by the ancient Greek central public spaces which served as a marketplace, meeting ground, and heart of civic life. With a focus on centralized access, this design takes into consideration the main circulation to various program elements and the overall rhythm of the space. Ecology and site access were guiding this design while keeping in mind the views and horizon lines.

Concept Sketch



Inspiration



Shade structures in a plaza



Children playing on small amphitheater seating



A tourist enjoying the view

DESIGN | Preliminary Concept 3: Forest to Shoreline

- Enhance Ecological Function
- Strengthen Community Bonds
- Reflect Unique Coastal Identity



DESIGN | Preliminary Concept 3: Forest to Shoreline

Inspired by the natural contours of the Palos Verdes Peninsula, this design mimics the feeling of walking from a forested area to eventually end at the edge of the shoreline. The heavy programming is primarily at the north part of the site, and as you move south, it begins to feel more open - like when you arrive at the sea. The southern end is mostly passive recreation and lends itself to a more natural experience.

Concept Sketch



Inspiration



Space for contemplation



Open to the views



Highlighted rugged coastline

DESIGN | Final Site Plan

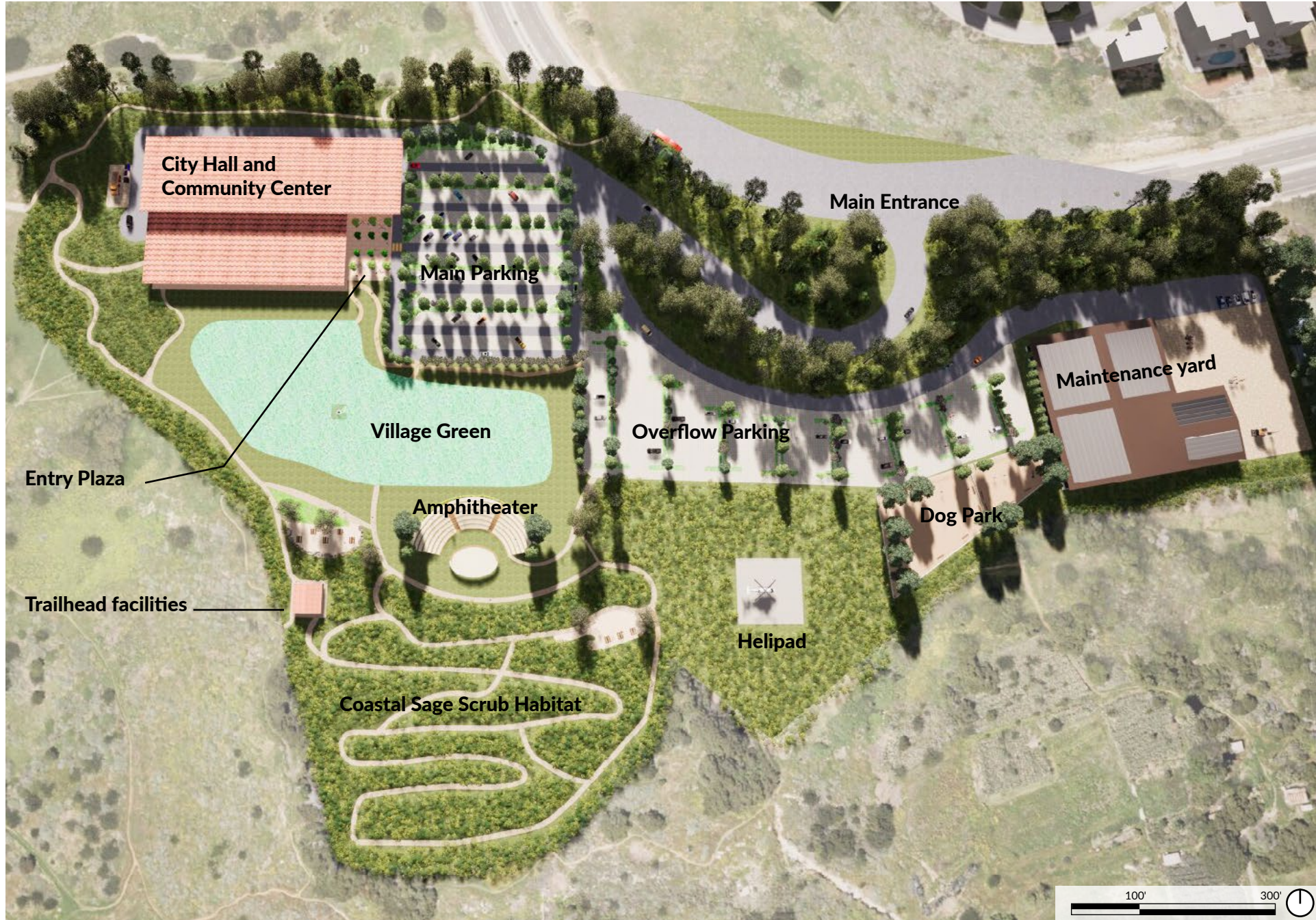

DESIGN | Civic Duties



DESIGN | Civic Duties

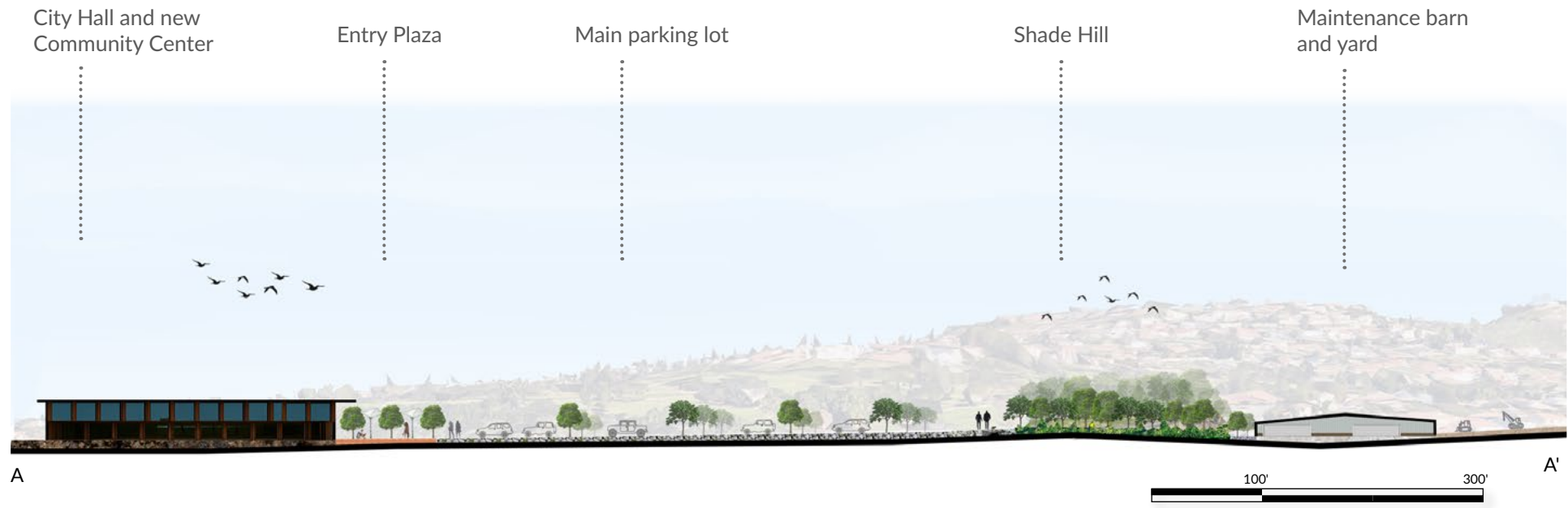

Inspiration images



Open office spaces on second floor of City Hall



City Hall design inspired by Frank Lloyd Wright

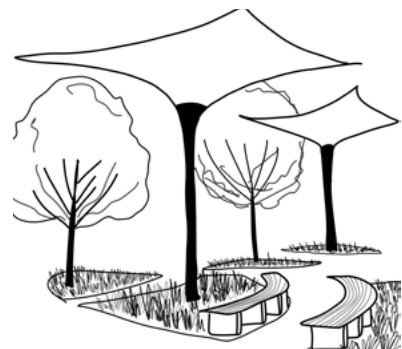

Entry plaza with shade structures



Entry signage with symbolic arch in honor of defense history

DESIGN | Civic Duties



The entry plaza serves as the main entrance to City Hall and the new Community Center. Trees, shade structures and bench seating invite visitors to stay and explore. The main programming is located at this North end of the site with opportunities for community engagement through events on the village green and the amphitheater. Views are revealed by entering the site on foot and are concealed from the parking lot by tree canopy.

DESIGN | Re-Wilding

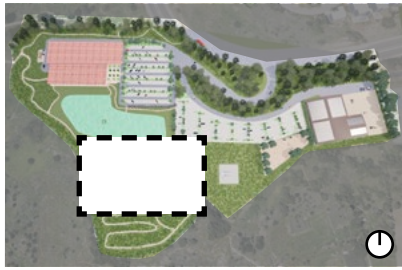
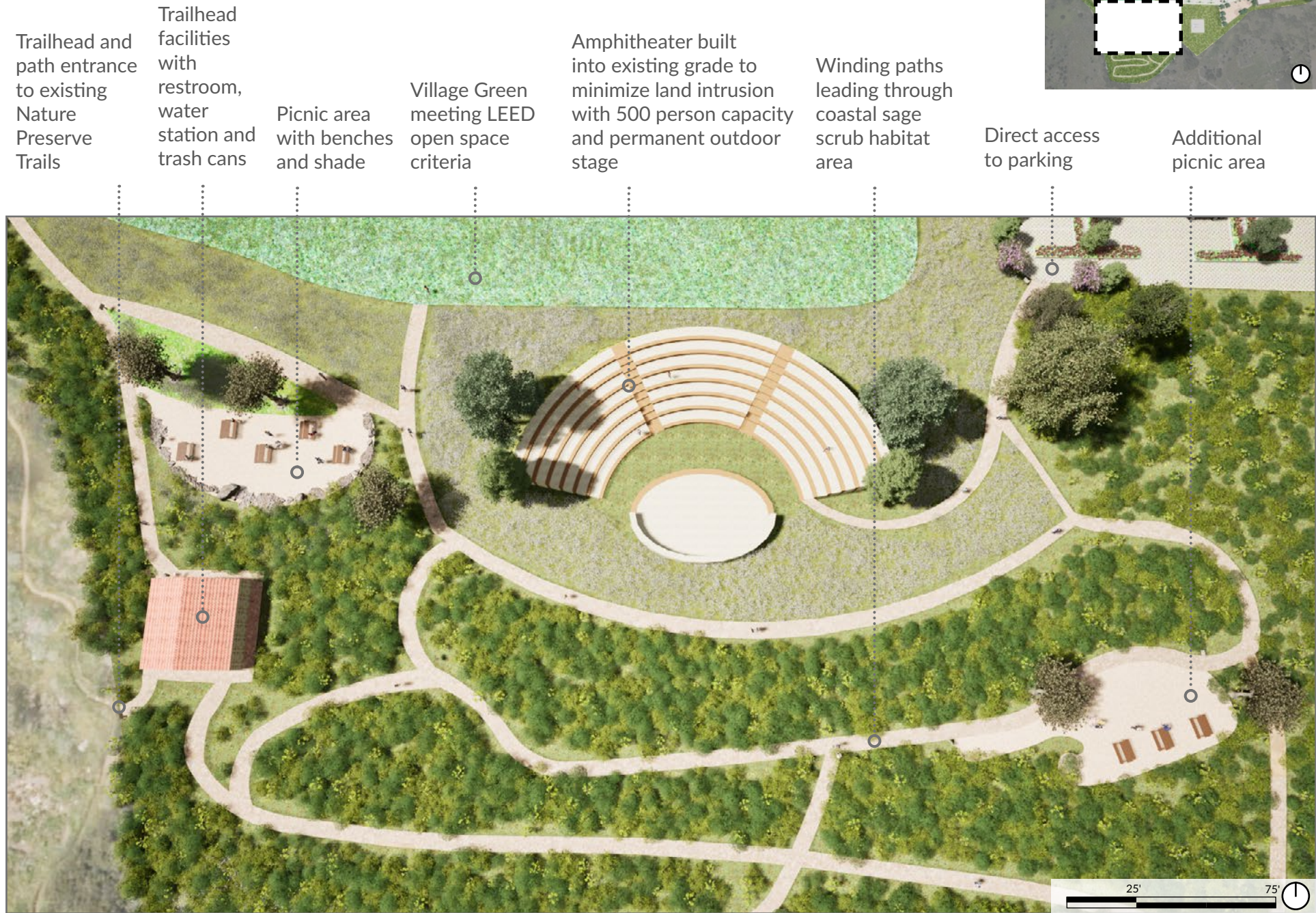

DESIGN | Re-Wilding

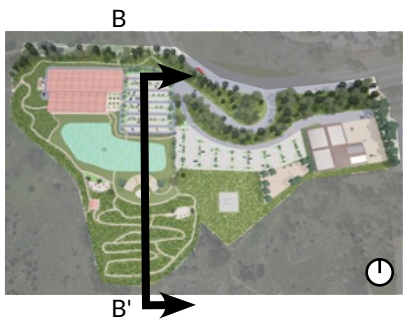
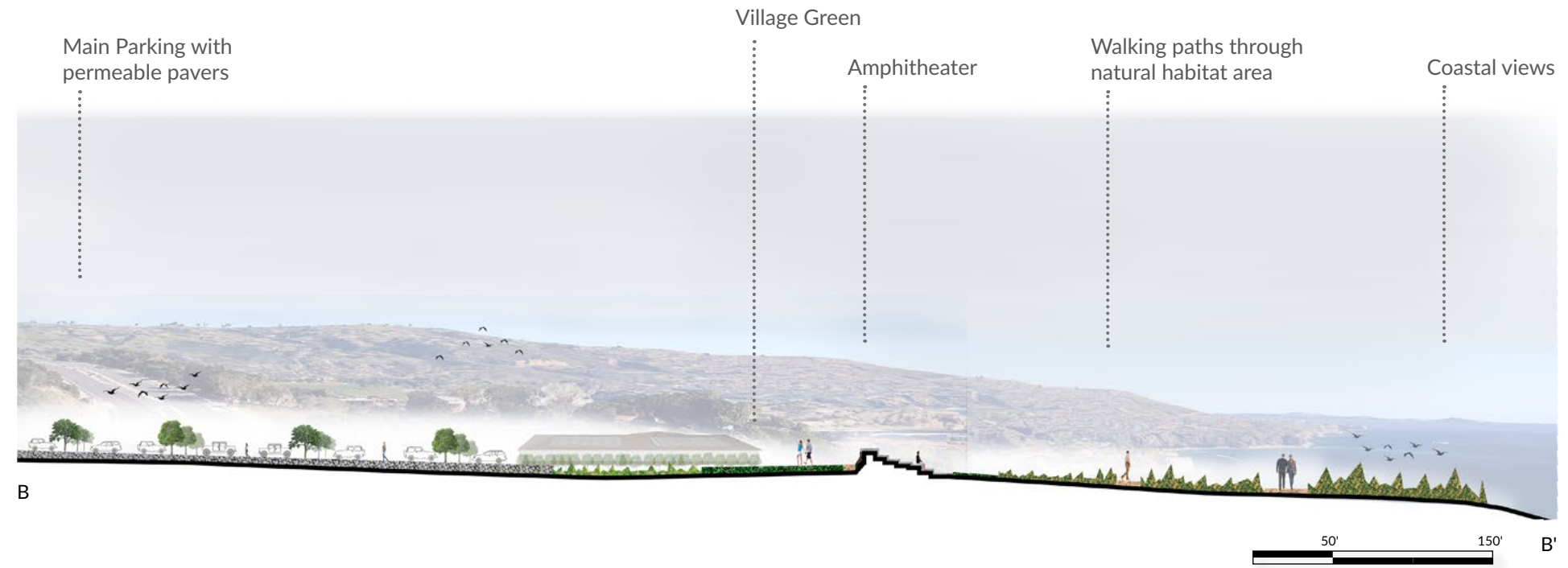

Inspiration images



Natural trails and PV blue butterfly habitat



Amphitheater



Trailhead facilities



Improved wayfinding and signage

DESIGN | Re-Wilding



The Southern part of the site leads to an increasingly natural habitat with entry to the nature preserve's existing trails and winding paths through Palos Verdes Blue Butterfly Habitat. There are opportunities for picnicking, hiking and direct access to the amphitheater and overflow parking lot.

DESIGN | Renewable Peninsula

Low growing native habitat around helipad for safety and to promote biodiversity

100' barrier around helipad for safety

Bioswales in planted parking medians

Overflow parking with permeable paving

Dog park with shade and separate areas for big and small dogs

Enhanced tree canopy, shade and wind mitigation

Maintenance barn and yard with room for facilities, solar panels and extra parking for staff



DESIGN | Renewable Peninsula

Shade hillside with Coastal Sage Scrub trees and habitat

Maintenance barn and yard with solar panels

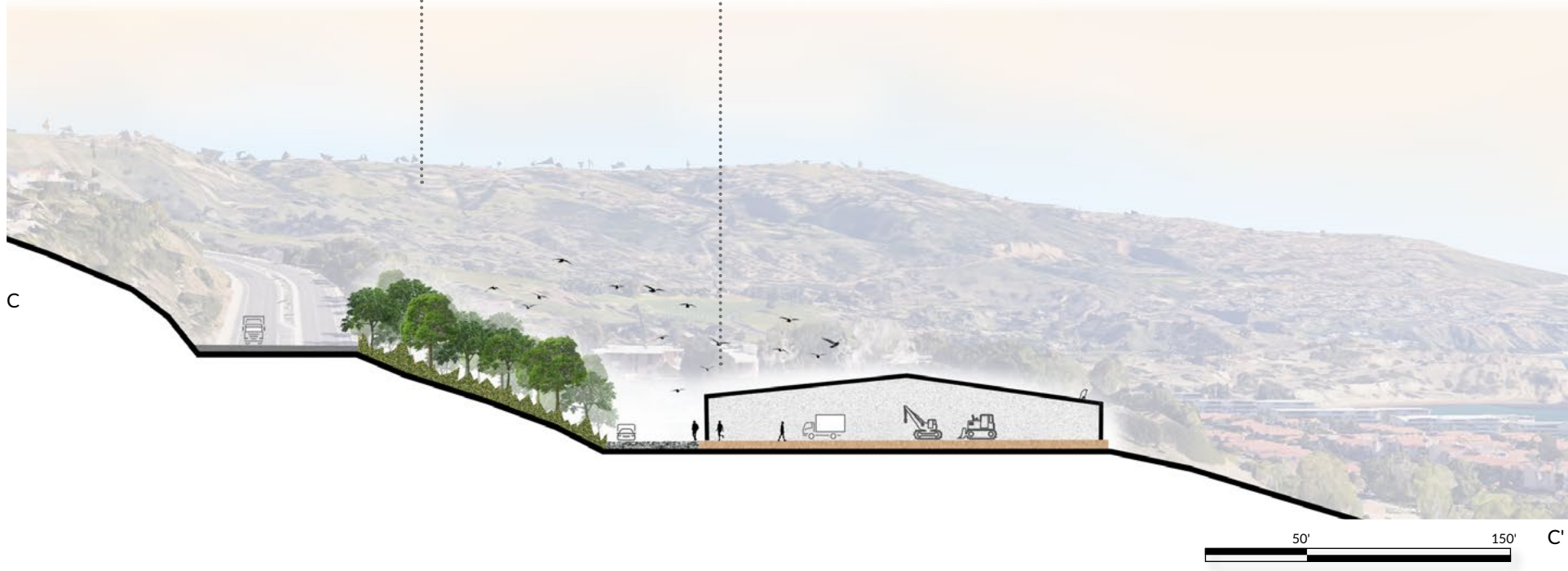

Inspiration images

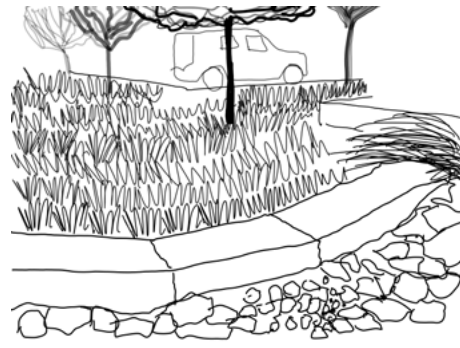

Maintenance barn and municipal yard

Bioswale in parking medians

Shaded dog park

Sustainable parking lot

DESIGN | Renewable Peninsula



The overflow parking lot serves as an opportunity for stormwater management through underground cisterns, bioswales and permeable paving. It also offers direct access for dog owners visiting the dog park. The maintenance barn and yard serves a municipal function while offering extra parking for staff and use of solar energy to power the barn and surrounding area. It can be closed off to the public with additional plant screening along the side.

DESIGN | Plant Palette

All plants were chosen for their beauty, resilience and adaptability to the Coastal Sage Scrub environment. The plants listed are fire resilient, civic-friendly and play a key habitat role by attracting pollinators. This sample plant palette keeps the ecological integrity of the site while still giving a true Palos Verdes Coastal character.

Trees



Toyon (*Heteromeles arbutifolia*)



Catalina cherry (*Prunus ilicifolia* ssp. *lyonii*)



Holly-leaf cherry (*Prunus ilicifolia* ssp. *ilicifolia*)



Coffeeberry (tree form, *Frangula californica*)



Blue elderberry (*Sambucus nigra* ssp. *caerulea*)

Large shrubs



Lemonade berry (*Rhus integrifolia*)



Sugar bush (*Rhus ovata*)



Bigberry manzanita (*Arctostaphylos glauca*)



St. Catherine's lace (*Eriogonum giganteum*)



Island bush poppy (*Dendromecon harfordii*)



Bush sunflower (*Encelia californica*)

Medium/low shrubs and groundcover



California buckwheat (*Eriogonum fasciculatum*)



White sage (*Salvia apiana*)



Purple sage (*Salvia leucophylla*)



Rattlepod ((*Astragalus trichopodus*))



Verbena (*Verbena lilacina* 'De La Mina')



Seaside daisy (*Erigeron glaucus*)

DESIGN | Outcomes + Achievements

Enhance Ecological Function

1

A total of 21,291 sq ft of solar energy harvested **saving 1.16 million KWH per year.**

87,263 sq ft of impermeable parking paving was **replaced with 100,975 sq ft of permeable paving**

3,463 sq ft of stormwater capture bioswales

5.6 acres of new coastal habitat restoration and wild pollinator haven for the Palos Verdes Blue Butterfly

Strengthen Community Bonds

2

22,659 sq ft of new community indoor space added.

City Hall municipal building offices and space **increased by 100%**

RPV City revenue possibilities include:

- Coastal cafe
- New event spaces
- Amphitheater
- 3,000 sq ft of leasable office space

Reflect the Unique Coastal Identity of Rancho Palos Verdes

3

New vehicular circulation and drop off

3 new pedestrian trail entrances

5 acres of ADA accessible space

Meaningful signage and historical program elements throughout trails

Design was positioned for **engagement and maximizing coastal views**

CITATIONS

Books

Design with Nature

by Ian McHarg

A Pattern Language

by Christopher Alexander, Murray Silverstein, and Sara Ishikawa

Planting: A New Perspective

by Piet Oudolf and Noel Kingsbury

The Outdoor Guide to the Palos Verdes Peninsula

by Brad and Kristine Denton

How to Study Public Life

by Jan Gehl and Birgitte Svarre

Digital Manuals and Documents

LID Low Impact Development, a Design Manual for Urban Areas

<https://www.casqa.org/wp-content/uploads/2022/12/socallid-manual-final-040910.pdf>

<https://olmsted.org/the-seven-ss-of-olmsted-design/>

<https://www.architecturaldigest.com/gallery/frederick-law-olmsted-best-designs>

Image Citations

PHOTOS AND IMAGES BY CATHERINE EISENBERG UNLESS OTHERWISE NOTED

Title pg: Google Earth Image

Pg. 2: <https://www.rpvca.gov/facilities/facility/details/Grandview-Park-8>

Pg. 6: <https://maureenmegowan.com/south-bay-history/history-of-rancho-palos-verdes/>
<https://www.palosverdespulse.com/blog/2020/8/9/vanderlip-estate>
<https://www.dailybreeze.com/2021/10/14/rancho-palos-verdes-erects-monument-honoring-tongva-people/>
https://en.wikipedia.org/wiki/Rancho_San_Pedro
<https://www.oursouthbay.com/remembering-the-ishibashi-family-agricultural-in-palos-verdes/>

Pg. 7: <https://www.rpvca.gov/1415/History-of-Rancho-Palos-Verdes>
https://en.wikipedia.org/wiki/Rancho_Palos_Verdes,_California
<https://maureenmegowan.com/south-bay-history/palos-verdes-secrets-and-little-known-facts/>
<https://laist.com/shows/take-two/this-old-missile-site-might-have-saved-la-during-the-cold-war>

Pg. 8: Google Maps

Pg. 9: <https://www.arcgis.com/index.html>

Pg. 10,11: Google Maps

Pg. 12: <https://olmsted.org/sites/palos-verdes-estates/>
<https://www.newsfromme.com/articles-such/the-big-w/>
<https://www.dailybreeze.com/2016/08/20/explosions-gunfire-coming-to-point-vicente-for-christopher-nolan-war-film-dunkirk/>
<https://www.latimes.com/lifestyle/story/2023-12-19/wayfarers-chapel-historic-landmark-status>
https://en.wikipedia.org/wiki/Wayfarers_Chapel

Pg. 18: <https://www.fws.gov/media/female-palos-verdes-blue-butterfly>
<https://www.shutterstock.com/image-photo/group-people-holding-hand-together-park-604504784>
https://en.wikipedia.org/wiki/Point_Vicente_Lighthouse

Pg. 19: <https://sandiegogreg.blogspot.com/2017/06/coastal-sage-scrub-and-california.html>
<https://www.ioes.ucla.edu/article/even-in-southern-california-wildfire-frequency-is-likely-to-increase-by-end-of-century/>
<https://www.wilburellis.com/corporate-social-responsibility/environmental-stewardship/>

Pg. 20: <https://limobelinwo.com/en/biophilic-design-in-offices/>
<https://admarble.com/projects-archive/wissahickon-valley-park-wayfinding-and-signage/>
<https://landscapearchitecturemagazine.org/2019/01/31/open-office/>

Pg. 21: https://en.wikipedia.org/wiki/Palos_Verdes_Public_Library_and_Art_Gallery
<https://www.trailaccessproject.org/>
<https://ggwash.org/view/90421/dc-has-the-most-drinking-fountains-per-capita-in-the-us-but-the-bar-is-low>

Pg. 22: https://en.wikipedia.org/wiki/Frederick_Law_Olmsted
<https://www.amazon.com/Pattern-Language-Buildings-Construction-Environmental/dp/0195019199>

Pg. 23: <https://www.amazon.com/Design-Nature-Ian-L-McHarg/dp/047111460X>
LID Low Impact Development, a Design Manual for Urban Areas

Pg. 24: <https://www.archdaily.com/985534/biophilic-offices-landscape-and-the-working-environment>
<https://venturefull.com/post/terranea-discovery-trail-beach-hike-in-rancho-palos-verdes/>
<https://www.terranealife.com/rediscovering-palos-verdes-blue-butterfly>

Pg. 26-28: <https://www.arcgis.com/index.html>

Pg. 32: <https://www.som.com/projects/long-beach-civic-center-master-plan/>

Pg. 33: <https://www.pwpla.com/projects/newport-beach-city-hall-and-park>
<https://www.som.com/projects/long-beach-city-hall-and-port-headquarters/>

Pg. 34: <https://millerhull.com/project/del-mar-civic-center/>

Pg. 37: <https://www.twpinc.com/blog/9-wire-mesh-gabion-design-ideas-for-commercial-spaces.html>
<https://homeadore.com/2025/09/07/wood-water-and-stone-reclaimed-timber-grounds-a-courtyard-retreat/>
<https://www.backyardboss.net/stepping-stone-garden-path-ideas/>

Pg. 39: <https://architizer.com/blog/inspiration/collections/throwing-shade-architectural-sun-blocks/>
<https://www.earthscapeplay.com/pilgrim-woods-natural-amphitheatre-wood/>
<https://racheloffduty.com/blog/guide-to-los-angeles-best-kept-secret-palos-verdes-california/>

Pg. 41: <https://biofilico.com/news/5-best-examples-sustainable-office-interior-biophilic-design>
<https://www.nps.gov/chis/learn/nature/coastal-sage-scrub.htm>

Pg. 44: AI generated Images
https://krownlab.com/solution/creative-office/?srsltid=AfmBOorNtmTnwIM8a9r--EwFlkmTULh-F3a3uOrsilLeOnBi2cQ2uk_E

Pg. 47: <https://www.latimes.com/travel/list/best-hikes-trails-los-angeles>
<https://www.dreyfussblackford.com/press-release/landscape-architecture-magazine-feature-theater-revival-robert-roystons-1967-quarry-amphitheater-has-been-carefully-rebuilt-in-all-its-modernist-glory-by-lydia-lee/>

Pg. 50: AI generated image
<https://landarch1.com/eco-friendly-parking-lots-environmental-impacts/>
<https://loganandjohnson.com/projects/barndominim>

Pg. 52: Calscape.org
<https://www.gardenia.net/>
<https://www.laspilitas.com/>
<https://www.treepeople.org/wp-content/uploads/2021/02/TreePeoples-LA-City-Approved-Street-Tree-List.pdf>

