



Enter to the site through a grove of trees on the sculpture garden



Site enclosed by galvanized metal trellis - Entrance through gates



Open roof at the center of the ceiling



Site is used as a plaza to purchase tickets and enter the theaters







Site has no specific uses during day time and is often used for privacy





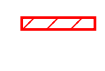
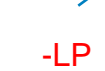

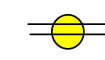
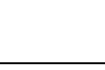
Site is used as a plaza to purchase tickets and enter the theaters

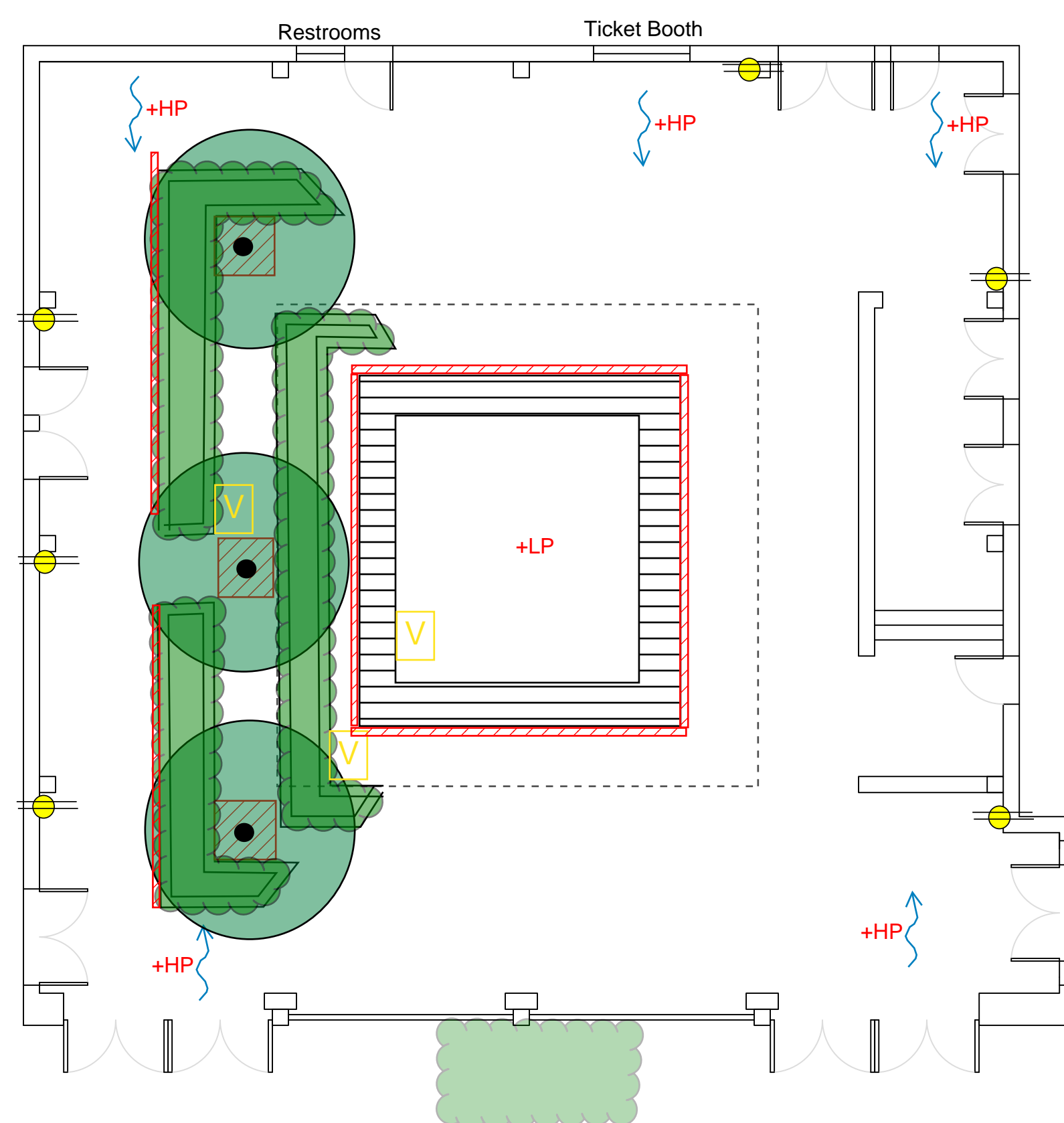
BUILT ELEMENTS

-  Existing trees in ground
-  Existing shrubs on raised planters
-  Drainage
-  Slope
-  Low point
-  High point
-  High point
-  Electrical Outlet



NATURAL ELEMENTS

-  Sun Path - Winter
-  Sun Path - Summer
-  Prevailing winds
-  Entrance
-  Pedestrian circulation

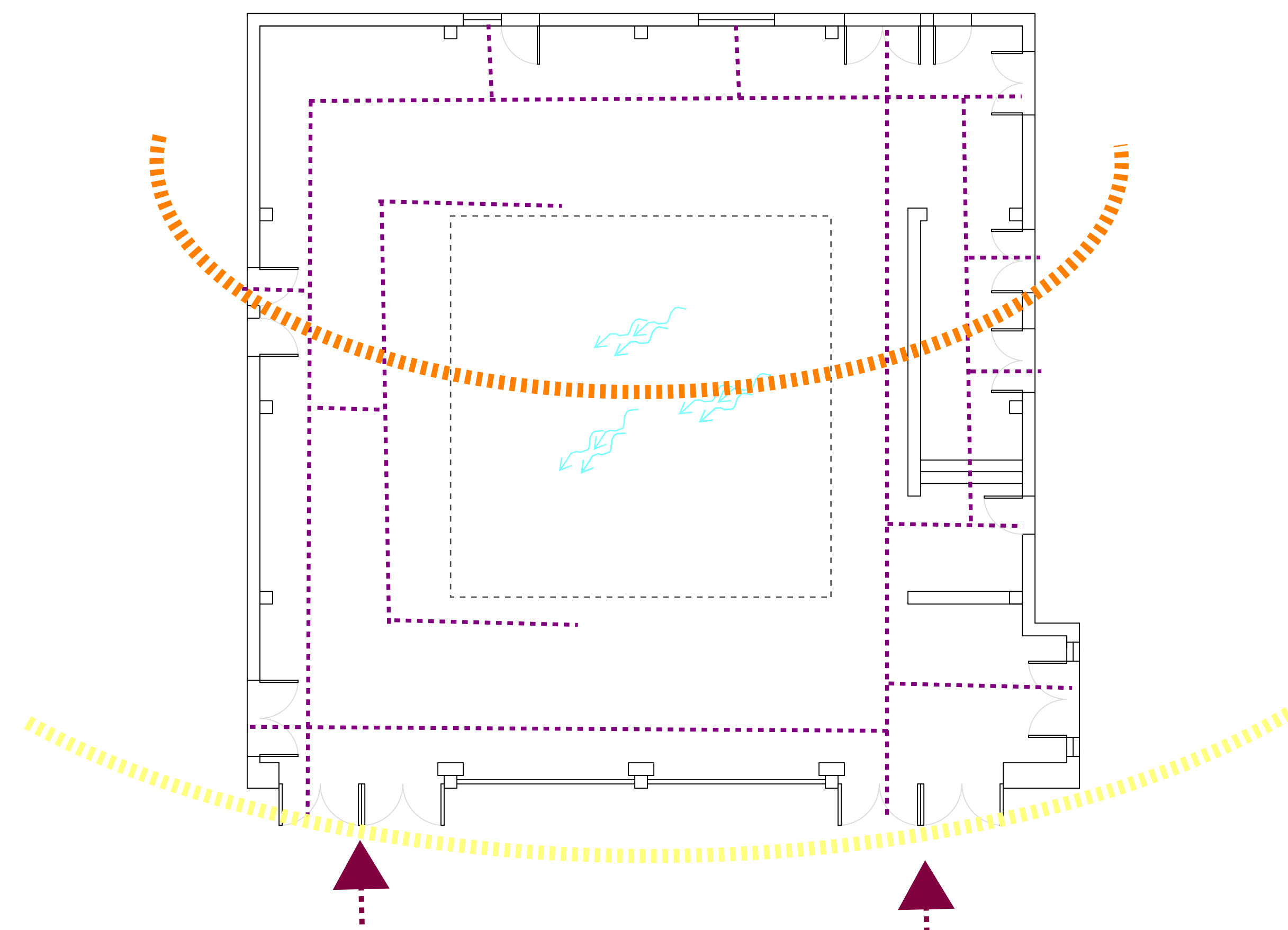

STUDENT NAME:
Roger Vasquez

COURSE:
Landscape Design I:
Site Design Basics

INSTRUCTOR:
Steven Chavez, PLA.

SITE NAME AND ADDRESS:
Courtyard of Theaters at
UCLA Macgowan Hall
School of Theater, Film and Television
245 Charles E. Young Dr. E,
Los Angeles, CA 90095

DRAWING TITLE:
Site Inventory

AERIAL IMAGE:



DRAWING NOTES:

- Enter to the site through a grove of trees on the sculpture garden.
- Site enclosed by galvanized metal trellis - Entrance through gates
- Open roof at the center of the ceiling
- Site is used as a plaza to purchase tickets and enter the theaters
- Site has no specific uses during day time and is often used for privacy
- Site is used as a plaza to purchase tickets and enter the theaters

NORTH ARROW:

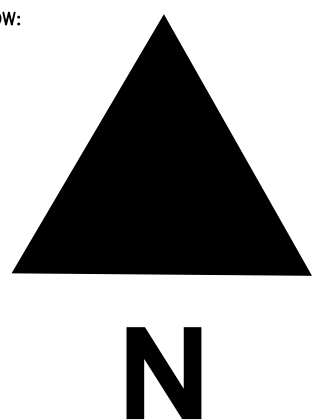

SCALE BAR:

DRAWING SCALE:
1/8" = 1'-0"

SHEET NUMBER:

SHEET NUMBER IN SET:



SITE CONSTRAINTS

- A- Difficulty to spot the site (Large trellis mimics large empty wall)
- B- Low attraction to the site (Site is not inviting)
- C- Space and size (Big empty cube with large intimidating walls)
- D- Low usable spaces
- E- Low direct sunlight
- F- Aesthetics and context
- G- Community and Stakeholder input
- H- Safety and security

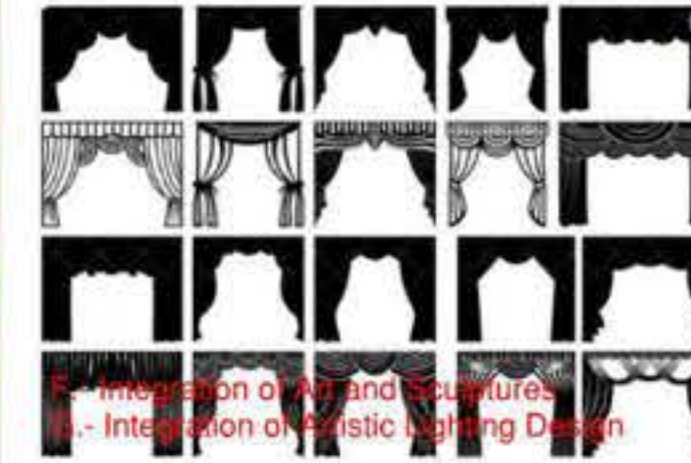
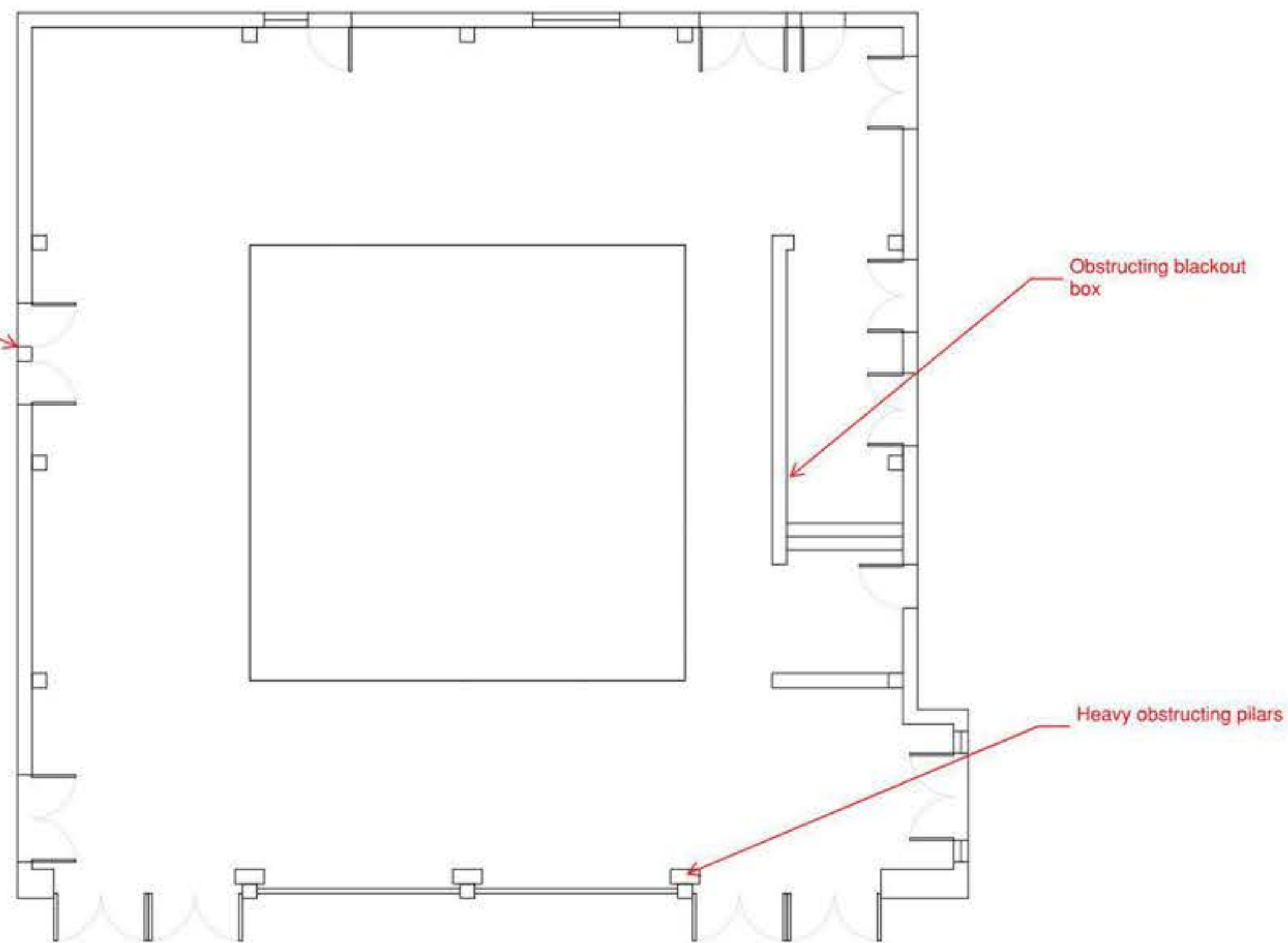

SITE Opportunities

- A.- Create an inviting front
- B.- Create more usable space
- C.- Drainage and water management
- D.- Privacy spaces and noise reduction
- E.- Aesthetics and Context
- F.- Environmental Impact and awareness
- G.- Greenery and Landscaping
- H.- Integration of Art and Sculptures
- I.- Integration of Artistic Lighting Design
- J.- Integration of water feature
- K.- Seating Options
- L.- Cultural and Historical Significance
- M.- Interactivity and Engagement
- N.- Multi-Functional Spaces
- O.- Accessibility
- P.- Sustainability
- Q.- Cafe or Refreshment Area

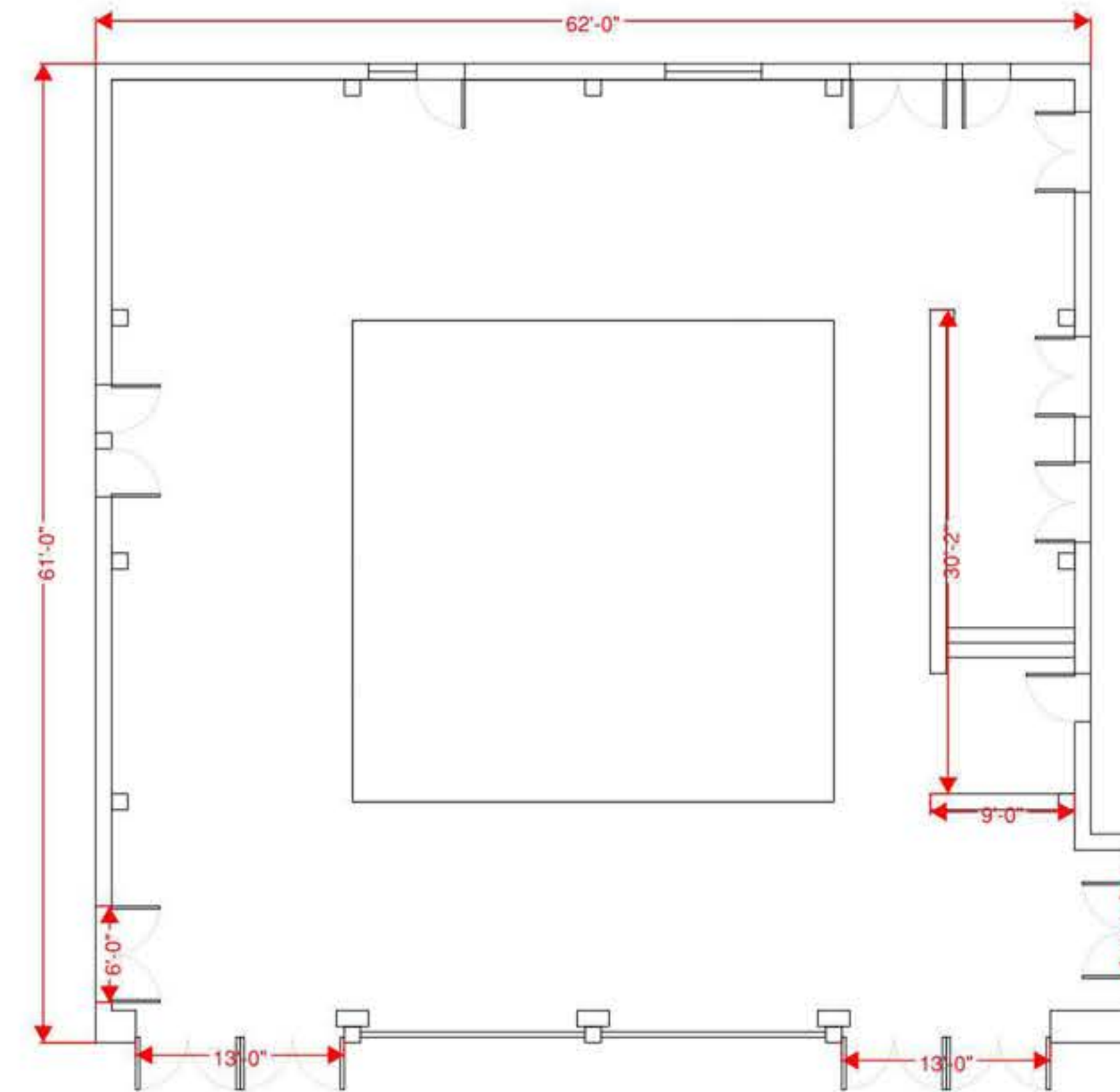

STUDENT NAME:
Roger Vasquez

COURSE:
Landscape Design I:
Site Design Basics

INSTRUCTOR:
Steven Chavez, PLA.

SITE NAME AND ADDRESS:
Courtyard of Theaters at
UCLA Macgowan Hall
School of Theater, Film and Television
245 Charles E. Young Dr E,
Los Angeles, CA 90095

DRAWING TITLE:
Site Analysis



DRAWING NOTES:

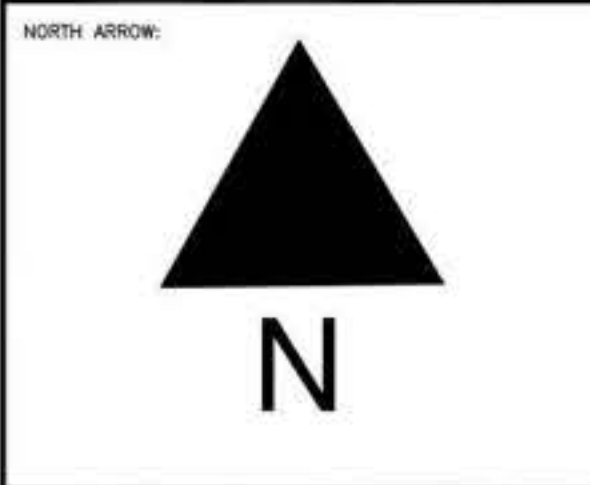

DRAWING SCALE:
1/8" = 1'-0"

SHEET NUMBER:
L-2

SHEET NUMBER IN SET:
2 of 5

Concept 1

Courtyard of Theaters Renovation

This concept enhances the courtyard while maintaining original layout by removing tripping hazards on the existing hardscapes. The new hardscape layout reflects from existing pillars creating a unifying effect. Added water feature and proposed art on walls mitigate eco effect. Proposed trees mitigate wind gust and allow in natural light. Increase usable spaces by adding movable furniture.

Concept 2

Sunken infinity water feature courtyard

Creates a dramatic entrance to the theaters, creates soothing seating areas in sunken garden using a theater stage layout. Tall trees mitigate eco and wind gust.

Concept 3

Simplicity, modesty, plainness, minimum aesthetic

Concept proposes to open the courtyard by removing the metal panels and ceiling. Adding comfortable sitting benches around the planter and cascade water feature. Black out box is transformed into a exit tunnel with a water cascade

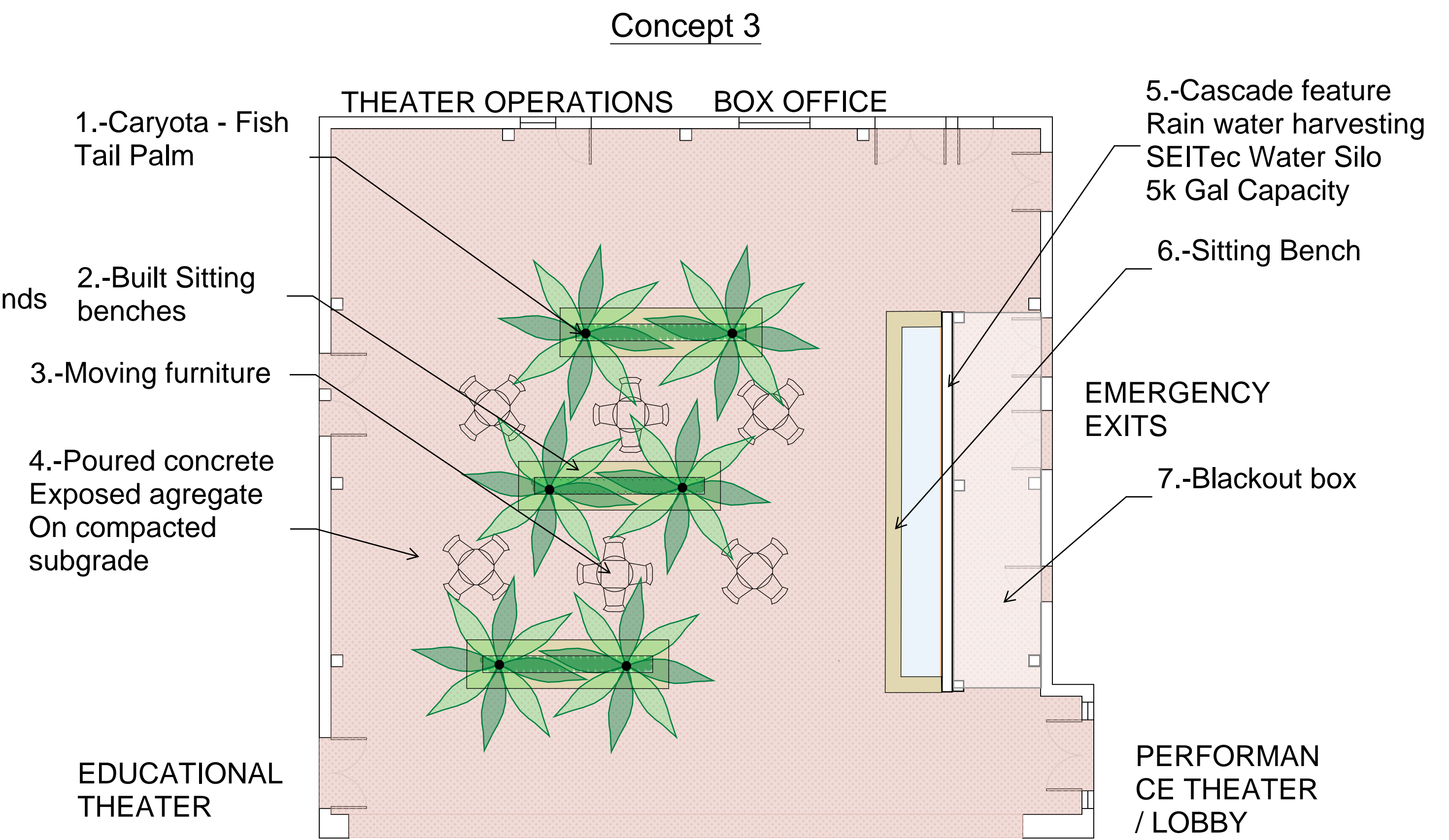
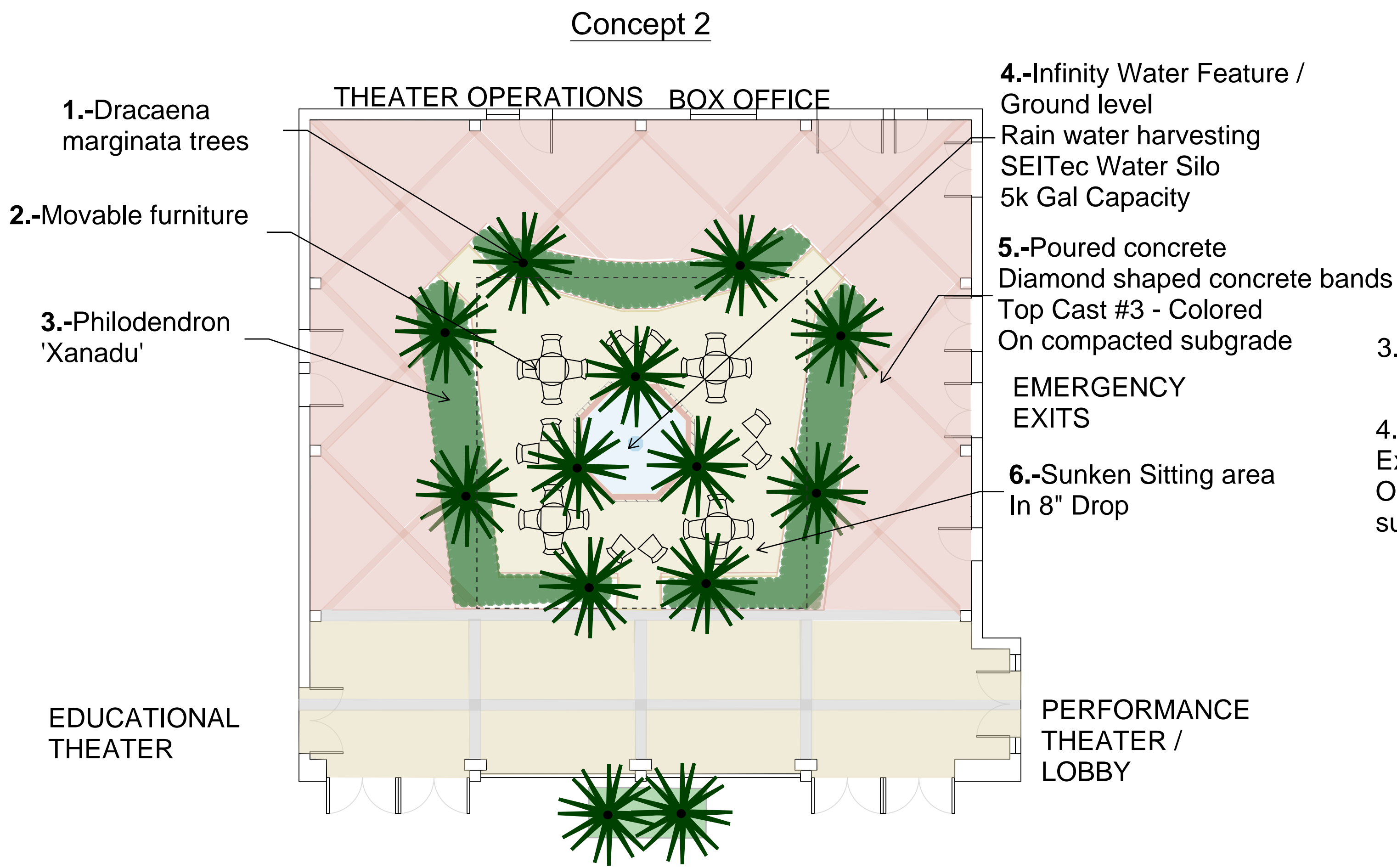
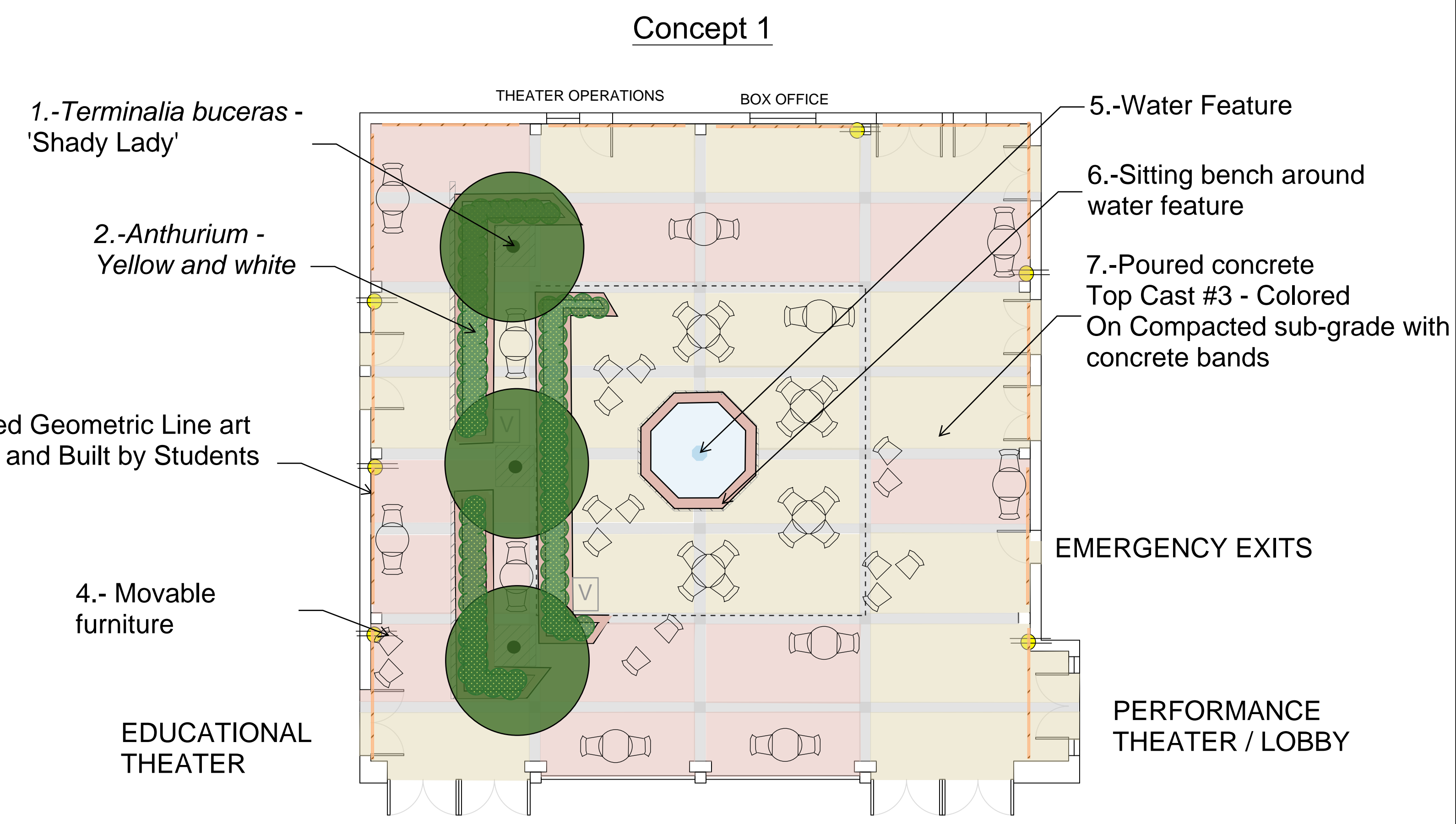

STUDENT NAME:
Roger Vasquez

COURSE:
Landscape Design I:
Site Design Basics

INSTRUCTOR:
Steven Chavez, PLA.

SITE NAME AND ADDRESS:
Courtyard of Theaters at
UCLA Macgowan Hall
School of Theater, Film and Television
245 Charles E. Young Dr E,
Los Angeles, CA 90095

DRAWING TITLE:
Design Concepts

AERIAL IMAGE:

DRAWING NOTES:

NORTH ARROW:

SCALE BAR:
0 4 8 16

DRAWING SCALE:
1/8" = 1'-0"

SHEET NUMBER:
L-3

SHEET NUMBER IN SET:
3 of 5

ENSEMBLE OASIS: THE THEATRICAL COURTYARD

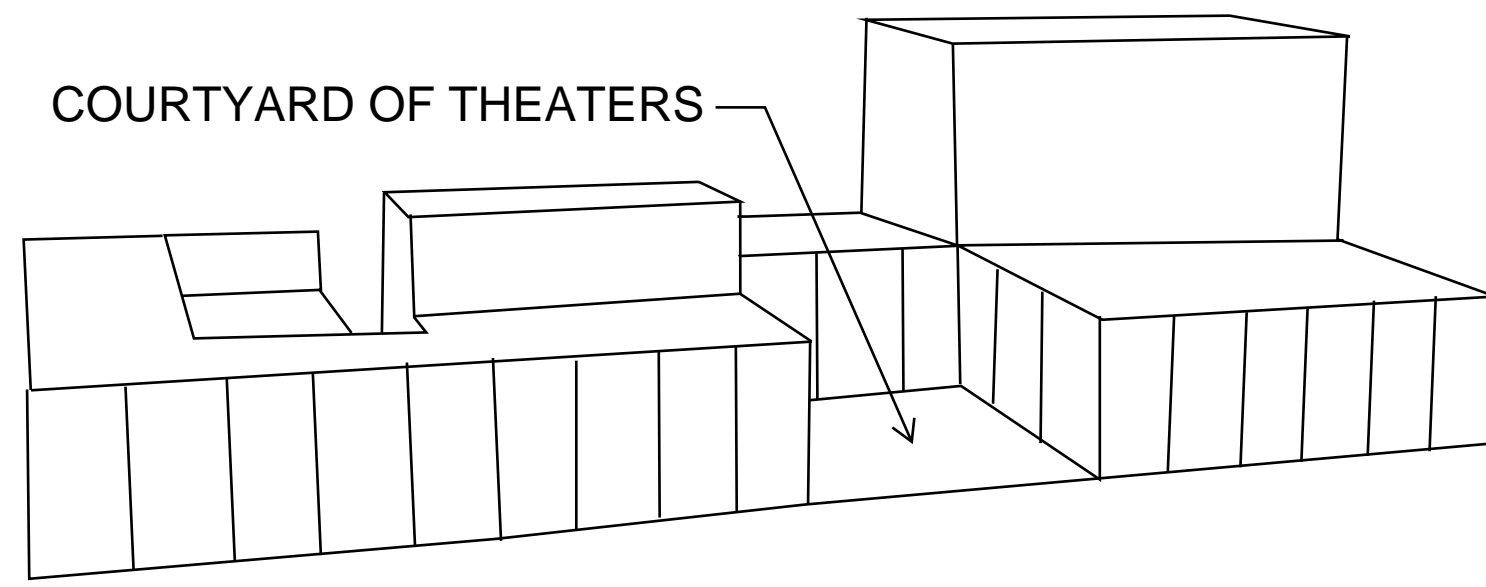

STUDENT NAME:
Roger Vasquez

COURSE:
Landscape Design I:
Site Design Basics

INSTRUCTOR:
Steven Chavez, PLA.

SITE NAME AND ADDRESS:
Courtyard of Theaters at
UCLA Macgowan Hall
School of Theater, Film and Television
245 Charles E. Young Dr E,
Los Angeles, CA 90095

DRAWING TITLE:
Final Concept Drawing



DESIGN STATEMENT

The landscape architecture design for the courtyard of theaters at UCLA aims to create a dynamic and flexible environment that complements the artistic and intellectual pursuits of the performing arts. It focuses on integrating nature, art, and community, emphasizing elements such as drought-tolerant plantings, flexible performance spaces, cultural narratives, sensory experiences, and community connectivity.

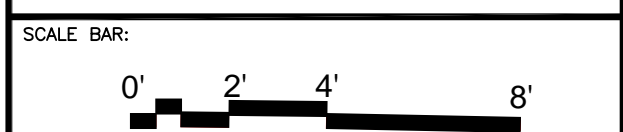

DRAWING SCALE:
1/4" = 1'-0"

SHEET NUMBER:
L-4

SHEET NUMBER IN SET:
4 of 5

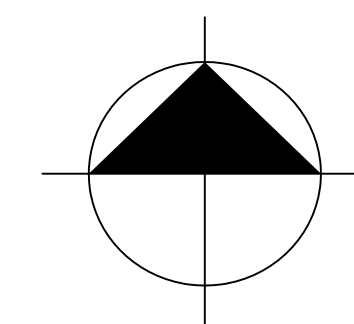

SECTION LINES:

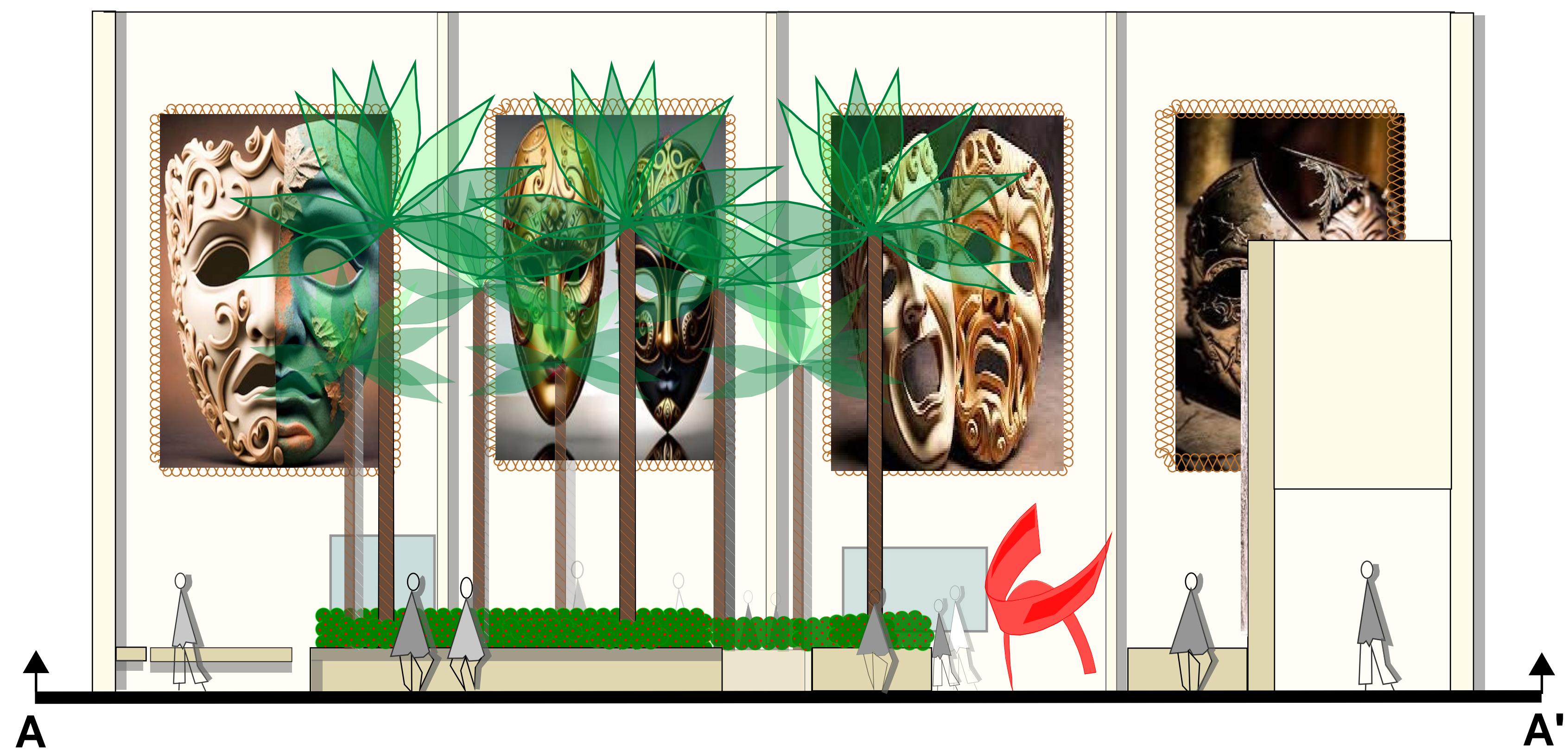
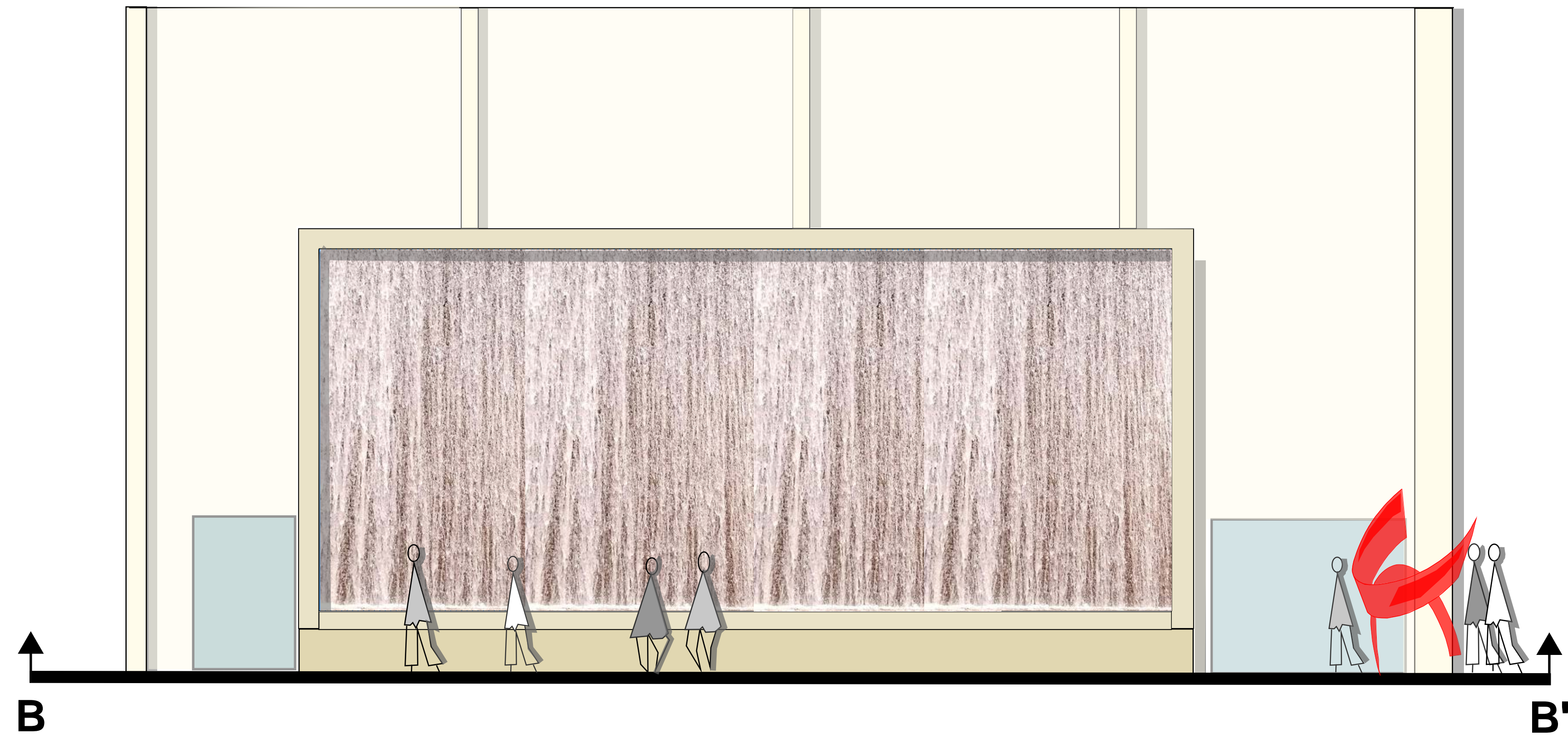

PERSPECTIVE DRAWING:

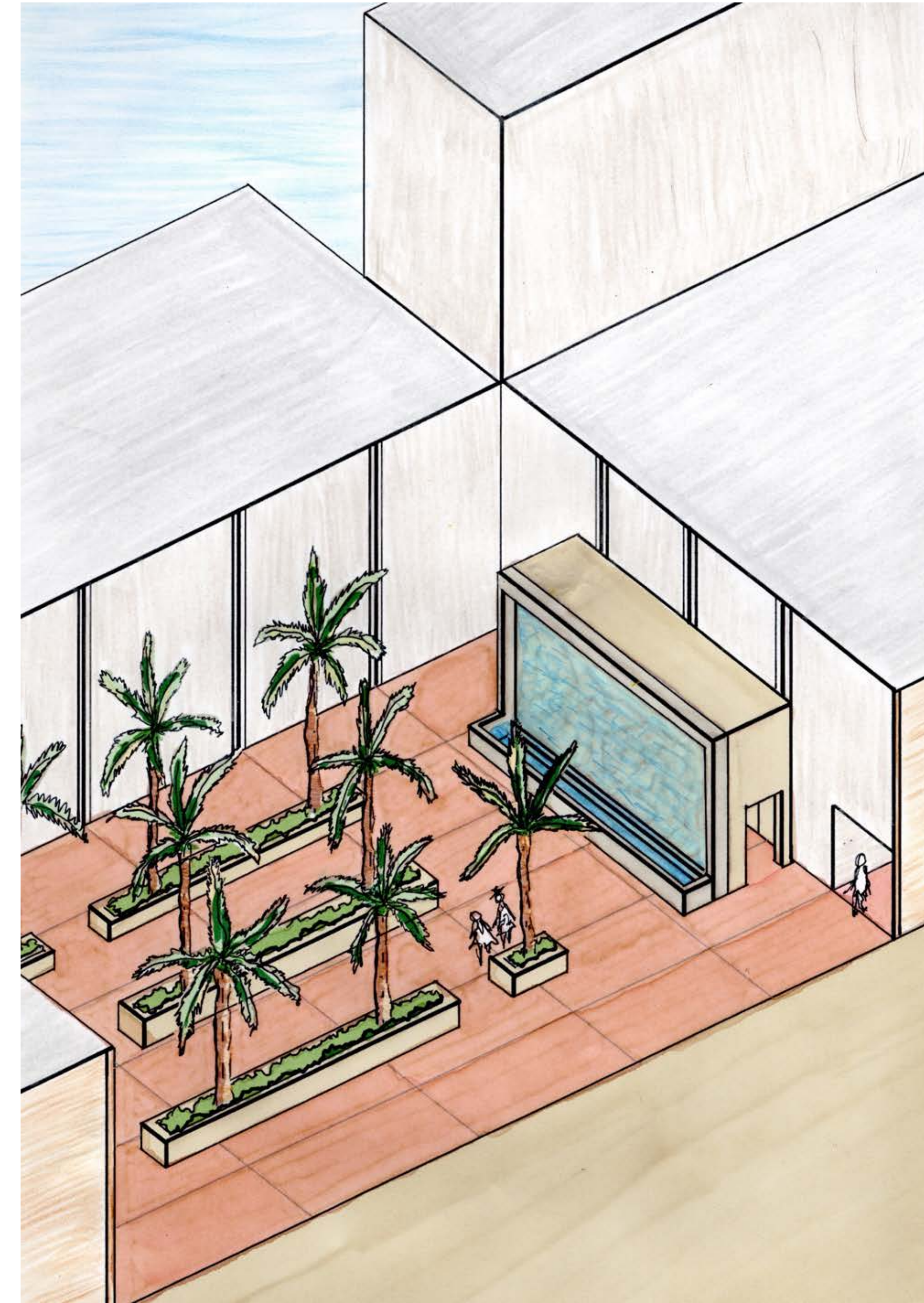

SECTION KEY MAP:

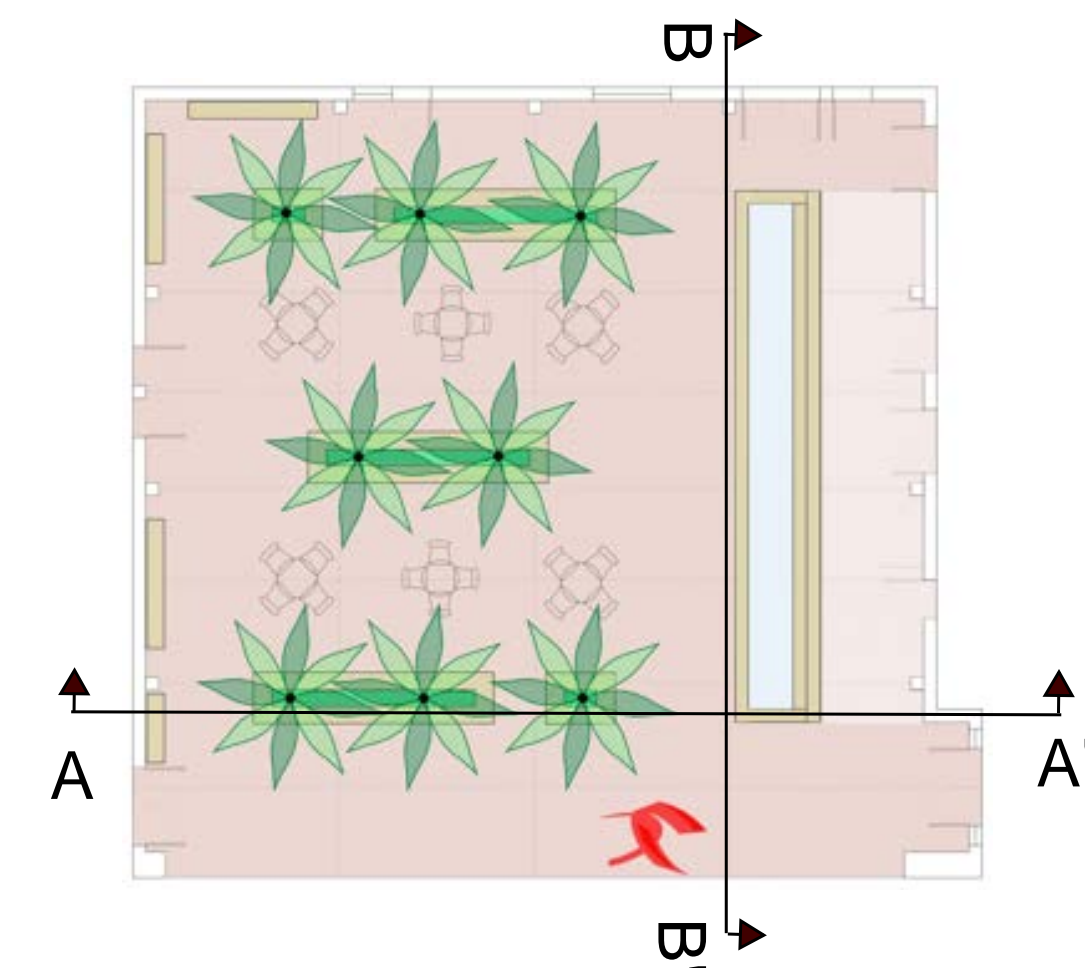

STUDENT NAME: Roger Vasquez	
COURSE: Landscape Design I: Site Design Basics	
INSTRUCTOR: Steven Chavez, PLA.	
SITE NAME AND ADDRESS: Courtyard of Theaters at UCLA Macgowan Hall School of Theater, Film and Television 245 Charles E. Young Dr E, Los Angeles, CA 90095	
DRAWING TITLE: Section Lines	
AERIAL IMAGE: 	
DESIGN STATEMENT The landscape architecture design for the courtyard of theaters at UCLA aims to create a dynamic and flexible environment that complements the artistic and intellectual pursuits of the performing arts. It focuses on integrating nature, art, and community, emphasizing elements such as drought-tolerant plantings, flexible performance spaces, cultural narratives, sensory experiences, and community connectivity.	
SCALE BAR: 	
DRAWING SCALE: 1/4" = 1'-0"	
SHEET NUMBER: L-5	SHEET NUMBER IN SET: 5 of 5

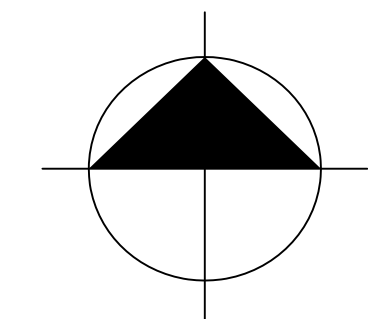

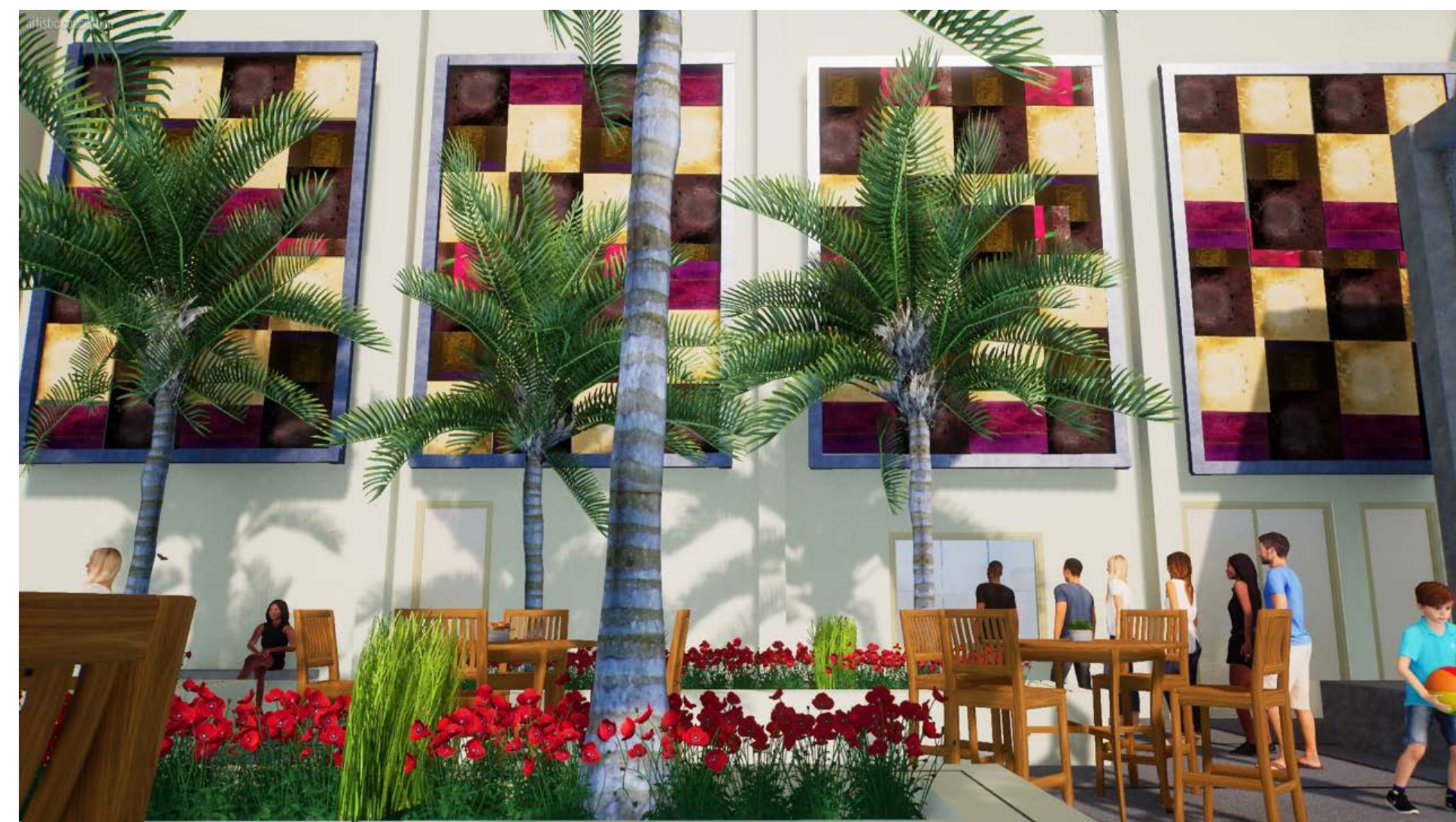

STUDENT NAME: Roger Vasquez	
COURSE: Landscape Design I: Site Design Basics	
INSTRUCTOR: Steven Chavez, PLA.	
SITE NAME AND ADDRESS: Courtyard of Theaters at UCLA Macgowan Hall School of Theater, Film and Television 245 Charles E. Young Dr E, Los Angeles, CA 90095	
DRAWING TITLE: Section Lines	
AERIAL IMAGE: 	
DESIGN STATEMENT The landscape architecture design for the courtyard of theaters at UCLA aims to create a dynamic and flexible environment that complements the artistic and intellectual pursuits of the performing arts. It focuses on integrating nature, art, and community, emphasizing elements such as drought-tolerant plantings, flexible performance spaces, cultural narratives, sensory experiences, and community connectivity.	
SCALE BAR:	
DRAWING SCALE: NTS	
SHEET NUMBER: M-1	SHEET NUMBER IN SET: 5 of 5