

INSTRUCTOR: PAMELA BRIEF
LANDSCAPE DESIGN: ARCH-X 472.5



UCLA ENTRY: REIMAGINED
LE CONTE AVE AND WESTWOOD BLVD
LOS ANGELES, CALIFORNIA



AIMEE KIRBY

UCLA ENTRY REIMAGINED: SITE ANALYSIS AND AREA USE PLAN

SITE ANALYSIS

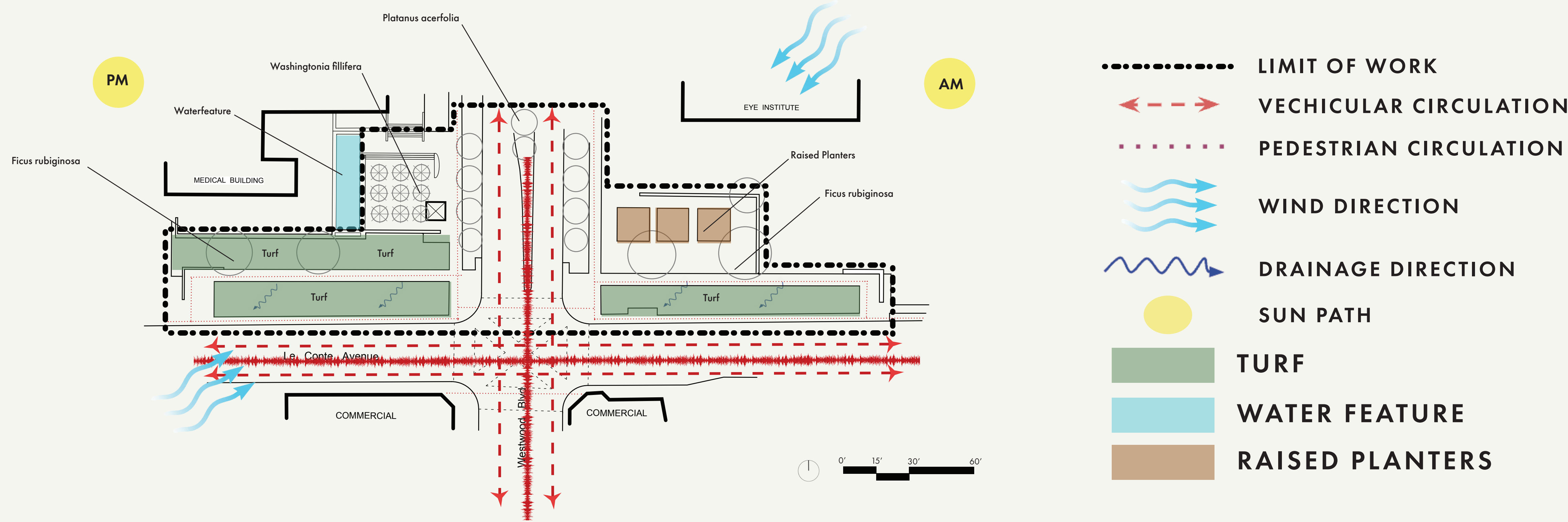

DESIGN DESCRIPTION

Currently, the UCLA south entry to campus lacks a sense of identity as well as green space and respite. This design aims to bring both the main entrance of campus. This area will become a memorable connection space between campus and bustling Westwood Blvd.

The corner of Le Conte and Westwood Blvd is flanked by two large native and Mediterranean inspired planting beds which have two large *Olea europea* whose under story is softened with *Muhlenbergia dubia*, *Salvia clevelandii*, and *Phlomis fruticosa*. This color story subtly references the school colors of UCLA. Continuing north up Westwood Blvd a long row of *Olea europea* with *Carex praeegracilis* flowing below. The parkway median tells a soft color story blue, purple and soft wheat with *Ceanothus Concha*, *Salvia Clevelandii* and *Muhlenbergia dubia*.

The large east and west turf beds and now large undulating meadow swatches, which creation a clear sense of direction and identity, which is beautiful from both the street and sidewalk. Soft yellow, *Muhlenbergia dubia* blows in the breeze, *Elymus condensatus* 'Canyon Prince' makes up the garden bed edges. *Erigoneum giganteum* and *Phlomis fruticosa* are paired for the textural and blue and yellow color scheme. Repetition and large monoplanting are the main theme and pattern through out this planting.

The existing *Ficus ribiginosa* is now complimented with *Carpenteria californica*, *Woodardia frimbiata*, *Baccharis pilularis* for an woody and soft appeal.

North of the *Ficus ribiginosa* is the dry gawe with *Parkinsona florida* x *Desert Museum*, *Agave americana*, *Elymus condensatus* "Canyon Prince". The *Washingtonia fillifera* are retained for the native appeal. *Arcostaphylos* 'Howard McMinn' and *Muhlenbergia dubia* make a lovely punction point to the existing water feature.

Altogether, all these elements make a beautiful drought tolerant entryway with a sense of identity, a clear connection to campus and an overall sustainable mission.

AREA USE STUDY

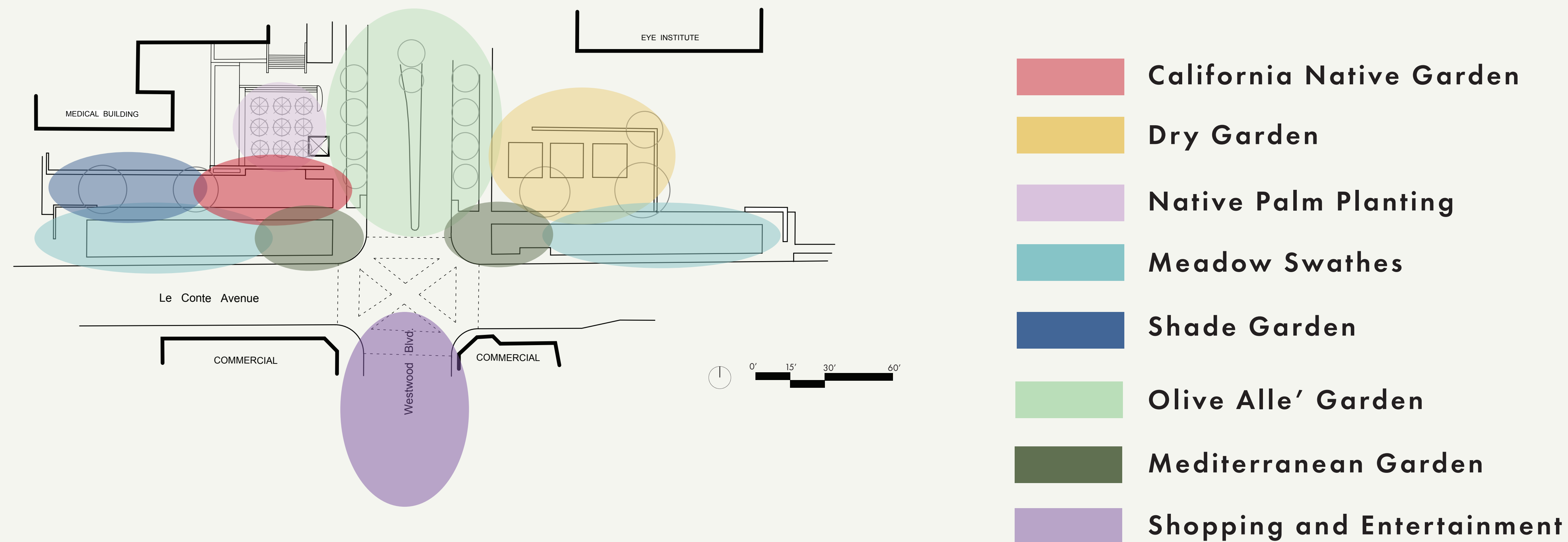

SITE PROFILE

SUNSET ZONE: 22

SOIL: SANDY LOAM



UCLA ENTRY RE-IMAGINED : PLANTING PLAN

SITE PLAN



INSPIRATION



PLANT PALETTE INFORMATION

* - CALIFORNIA NATIVE

TREES

SHRUBS

GRASS

		LATIN NAME	COMMON NAME	HEIGHT / WIDTH	WUCOLS	ETO	SOIL	BLOOM
T	1	<i>Baccharis pilularis</i> *	Coyote Brush	H: < 1 W: Spreading	Low/Med, SWR	< 10 %	Well Drained	N/A
G	2	<i>Carex praegracilis</i> *	California Field Sedge	H: < 1 W: Spreading	Low, SWR	< 10 %	Well Drained	Brown / Spring
T	3	<i>Carpenteria californica</i> *	Bush Anemone	H: 6'-8' W: 3'-5'	Low, SWR	< 10 %	Well Drained	White / Spring-Summer
S	4	<i>Ceanothus concha</i> *	Concha ceanonthus	H: 6'-8' W: 6'-12'	Low, SWR	< 10 %	Well Drained	Dark Blue / Spring
G	5	<i>Elymus condensatus</i> "Canyon Prince" *	Canyon Prince Grass	H: 2' - 3' W: Spreading	Low, SWR	< 10 %	Well Drained	Wheat / Summer
S	6	<i>Erigoneum giganteum</i> *	St. Catherines Lace	H: 4' - 8' W: 6'-8'	Low, SWR	< 10 %	Well Drained	Pink / Spring - Fall
T	7	<i>Ficus ribiginosa</i>	Rusty Fig	H: 40' - 50' W: 20' - 40'	Low, SWR	< 10 %	Well Drained	White / Summer
T	8	<i>Jacaranda mimosifolia</i>	Fern Tree	H: 25'-40' W: 20' - 30'	Low, SWR	< 10 %	Well Drained	Blue / Summer
G	9	<i>Muhlenbergia dubia</i> *	Pine Muhly	H: 2'-3' W: Clumping	Low, SWR	< 10 %	Well Drained	Tan / Summer - Fall
T	10	<i>Olea europea</i> 'Monher'	California Buckwheat	H: 1'-3' W: 4'-5'	Low, SWR	< 10 %	Well Drained	Pinkish White / Summer
T	11	<i>Palo Verde Desert Museum</i>	Desert Museum Palo Verde	H: 15'-20' W: 15'-20'	Low, SWR	< 10 %	Well Drained	Yellow / Spring - Summer
S	12	<i>Phlomis fruticosa</i>	Jerusalem Sage	H: 3'-4' - W: 3'-4'	Low, SWR	< 10 %	Well Drained	Yellow / Spring - Summer
T	13	<i>Quercus agrifolia</i> *	Coast Live Oak	H: 40' - 60' W: 40' - 50'	Low, SWR	< 10 %	Well Drained	N/A
S	14	<i>Romenya coulteri</i> *	Matilija Poppy	H: 3'-5' W: 6'-8'	Low, SWR	< 10 %	Well Drained	White/ Spring - Summer
S	15	<i>Salvia clevelandi</i> *	Cleveland Sage	H: 4'-5' W: 4'-5'	Low, SWR	< 10 %	Well Drained	Lavender / Spring - Summer
S	16	<i>Salvia yangii</i> *	Russian Sage	H: 3'-4' W: 2'-3'	Low, SWR	< 10 %	Well Drained	Lavender / Summer - Fall
S	17	<i>Santolina chamaecyparissus</i>	Gray Lavender Cotton	H: 1'-2' W: 3'-4'	Low, SWR	< 10 %	Well Drained	Yellow / Spring - Summer
T	18	<i>Washingtonia Fillifera</i> *	California Fan Palm	H: 49' - 66' W: 10' - 15'	Low, SWR	< 10 %	Well Drained	White / Spring - Winter
S	19	<i>Woodwardia frimbata</i> *	Giant Chain Fern	H: 4'-5' W: 4'-5'	Low, SWR	< 10 %	Well Drained	N/A
	20	<i>Arcostaphylos</i> 'Howard McMinn'	Manzanita	H: 6'-10' W: 6'-12'	Low, SWR	< 10 %	Well Drained	Light Pink / Winter - Spring
	21	<i>Agave americana</i>	American Century Plant	H: 8'-10' W: 8'-10'	Low, SWR	< 10 %	Well Drained	White / Summer

INSPIRATION



UCLA ENTRY REIMAGINED : PLANT PALETTE

TREES



Parkinsonia florida x Desert Museum



Ficus ribiginosa



Quercus agrifolia *



Olea europea 'Monher'



Jacaranda mimosifolia



Washingtonia Fillifera *

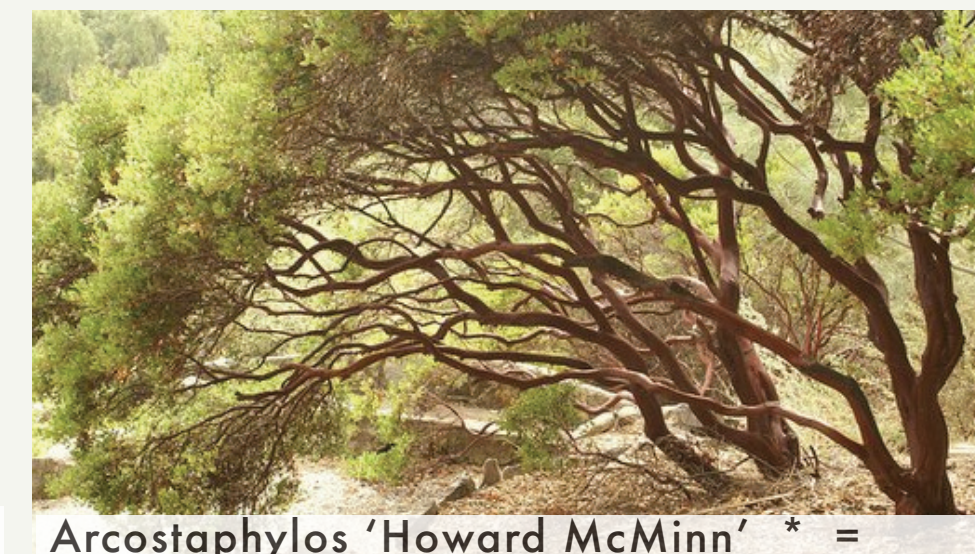

Arcostaphylos 'Howard McMinn' * =

GRASSES



Muhlenbergia dubia *



Elymus condensatus 'Canyon Prince' *



Carex praegracilis *

SHRUBS



Baccharis pilularis 'Pigeon Point' *



Carpenteria californica *



Erigoneum giganteum *



Ceanothus concha *



Phlomis fruticosa



Romenya coulteri *



Salvia yangii



Salvia clevelandil *



Agave americana *



Santolina chamaecyparissus



Woodardia frimbata *

UCLA ENTRY REIMAGINED

LE CONTE AVE AND WESTWOOD BLVD

LOS ANGELES, CALIFORNIA

AIMEE KIRBY