



TONGVA PARK

CASE STUDY

HEATHER WU
DESIGN GRAPHICS 3
INSTRUCTOR - LAURA RAZO
WINTER 2022

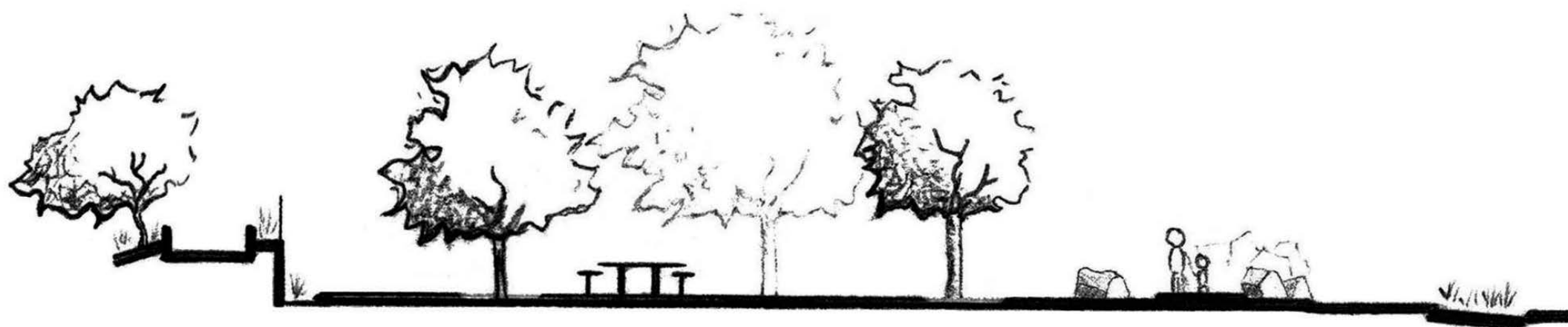

TABLE OF CONTENTS

INTRODUCTION.....04

CONTEXT.....06

SITE ANALYSIS.....08

CONCEPT.....11

SITE PLAN.....12

ENLARGEMENT & SECTION...16

PERSPECTIVES.....18

PLANT MATERIALS.....20

FIXTURES.....22

BIO & ACKNOWLEDGMENTS..24





ABOUT THIS BOOKLET

THIS BOOKLET IS A CULMINATION OF MY WORK FROM THE DESIGN GRAPHICS COURSES (DG) AT UCLA EXTENSION'S LANDSCAPE ARCHITECTURE PROGRAM. THROUGHOUT THE 3 COURSES, I LEARNED TO GRAPHICALLY COMMUNICATE AND BREAK DOWN THE DESIGN PROCESS OF TONGVA PARK, LOCATED IN SANTA MONICA, CA.

WE DEVELOPED OUR SKILLS TO GRAPHICALLY COMMUNICATE THE DESIGN OF TONGVA PARK IN DG1. WE LEARNED LINE WEIGHTS, DRAFTING LETTERS, PERSPECTIVES, SECTIONS, AND SCALE. WE LEARNED HOW TO BREAK DOWN THE DESIGN PROCESS OF TONGVA PARK IN DG2 BY QUESTIONING THE "BIG IDEA" BEHIND THE PARK AND HONING IN OUR OBSERVATION SKILLS BY PRODUCING SITE ANALYSIS AND SITE INVENTORY. WE LEARNED TO WORK WITH PEN AND COLOR, WHICH ENHANCED OUR ABILITY TO GRAPHICALLY COMMUNICATE. MY BIGGEST TAKEAWAY FROM DG2 WAS THAT EVERY DETAIL OF A SPACE IS A DECISION SOMEONE HAD TO MAKE, FROM WHERE THE SCORE-MARKS ARE IN CONCRETE PATHS TO THE DEPTH BOULDERS ARE BURIED. IN DG3, WE LEARNED TO ENHANCE AND RENDER OUR GRAPHICS DIGITALLY. EACH ASSIGNMENT WE HAVE WORKED ON HAS HELPED US DEVELOP OUR OWN GRAPHIC STYLE AND WILL HELP US EXPRESS AND UNDERSTAND CONCEPTS AND DESIGNS IN THE FUTURE.



THE DESIGN OF THE PARK WAS INSPIRED BY THE ARROYO WASH LANDSCAPE, WHICH WAS THE LANDSCAPE OF THE SITE MANY YEARS AGO. THE PARK NAME CELEBRATES THE CULTURES OF THE INDIGENOUS TONGVA PEOPLE WHO HAVE LIVED IN THIS REGION FOR THOUSANDS OF YEARS. THEY WERE DEEPLY CONNECTED TO THE ORIGINAL ARROYOS, NATIVE LANDSCAPES, AND THE "BREATH OF THE OCEAN" THAT ARE SYMBOLICALLY REPRESENTED IN THE PARK.



INTRODUCTION



IMAGE COURTESY TO SANTAMONICA.GOV

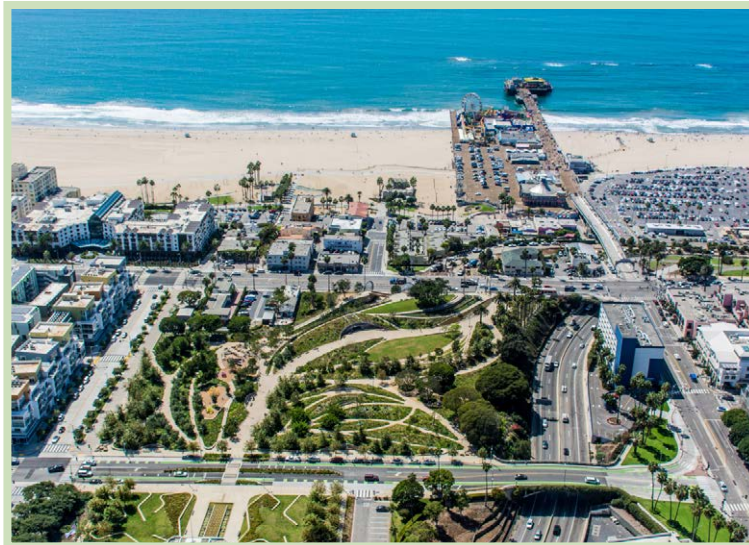
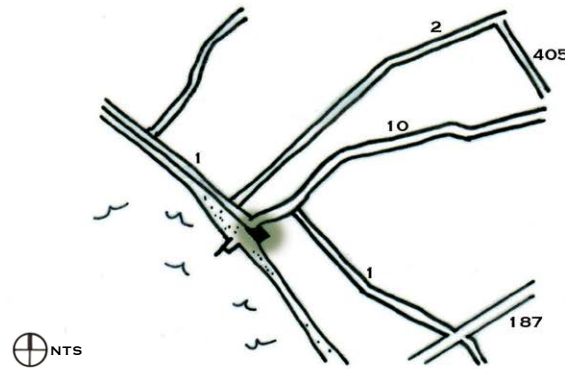
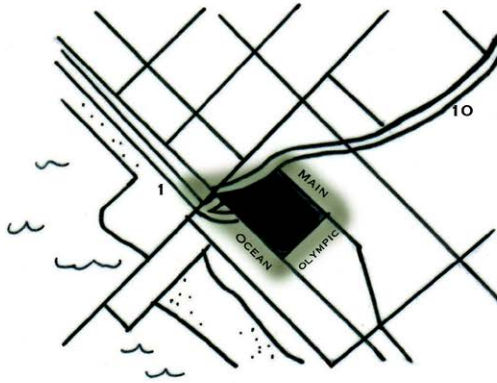

IMAGE COURTESY TO STEVE PROEHL

TONGVA PARK IS A 6-ACRE URBAN OASIS THAT OPENED IN 2013. IT WAS PREVIOUSLY A FLAT ASPHALT PARKING LOT. TONGVA PARK, ALONG WITH KEN GENSER SQUARE (THE SPACE DIRECTLY IN FRONT OF CITY HALL), WERE TO BRIDGE THE GAP BETWEEN CITY HALL AND SANTA MONICA PIER. TONGVA PARK IS THE “LIVING ROOM” OF CITY HALL.

THE PARK WAS DESIGNED BY JAMES CORNER FIELD OPERATIONS, THE SAME DESIGNER OF THE HIGH LINE IN NEW YORK CITY. JAMES CORNER DESCRIBES THE PROJECT AS “CREATING A NEW HEART FOR SANTA MONICA—A NEW DESTINATION AND GATHERING PLACE OF GREAT SOCIAL, ECOLOGICAL, AND SYMBOLIC VALUE.” THE PARK IS DIVIDED INTO 4 MAIN SECTIONS: OBSERVATION HILL, DISCOVERY HILL, GARDEN HILL, AND GATHERING HILL. THE SPACE PROVIDES A RANGE OF USES THAT BENEFIT THE WELLBEING OF THE COMMUNITY MEMBERS AND VISITORS OF ALL AGES.







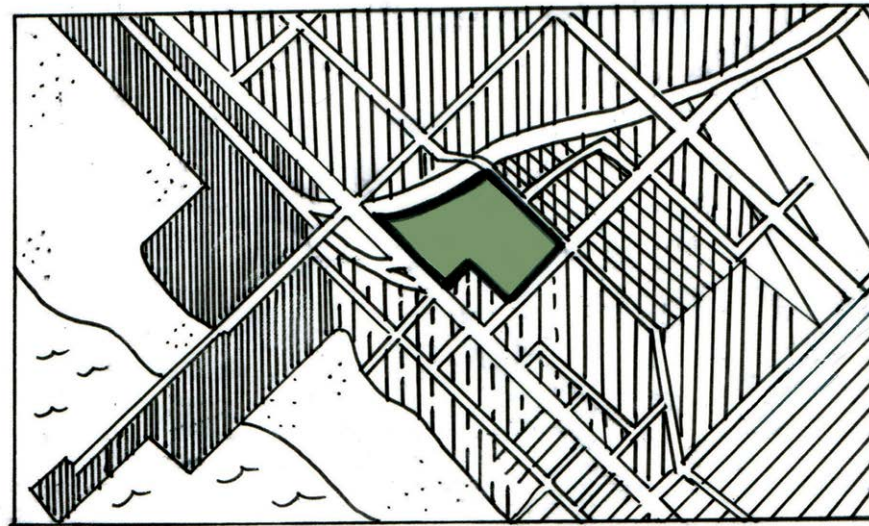

LOCATED AT 1615 OCEAN AVE, SANTA MONICA, CA
90401 - IN BETWEEN CITY HALL, THE 10 FREEWAY,
AND SANTA MONICA BEACH

SITE LOCATION



⊕ NTS

	SITE		MULTI-USE
	BEACH		RECREATIONAL
	COMMERCIAL		SCHOOL
	CIVIC CENTER		

TONGVA PARK IS SITUATED IN A VERY UNIQUE LOCATION, ATTRACTING ALL WALKS OF LIFE, AND IS SURROUNDED BY RESIDENTIAL COMPLEXES, SCHOOLS, BUSINESSES, GOVERNMENT FACILITIES, EXPO LINE, AND SANTA MONICA PIER.

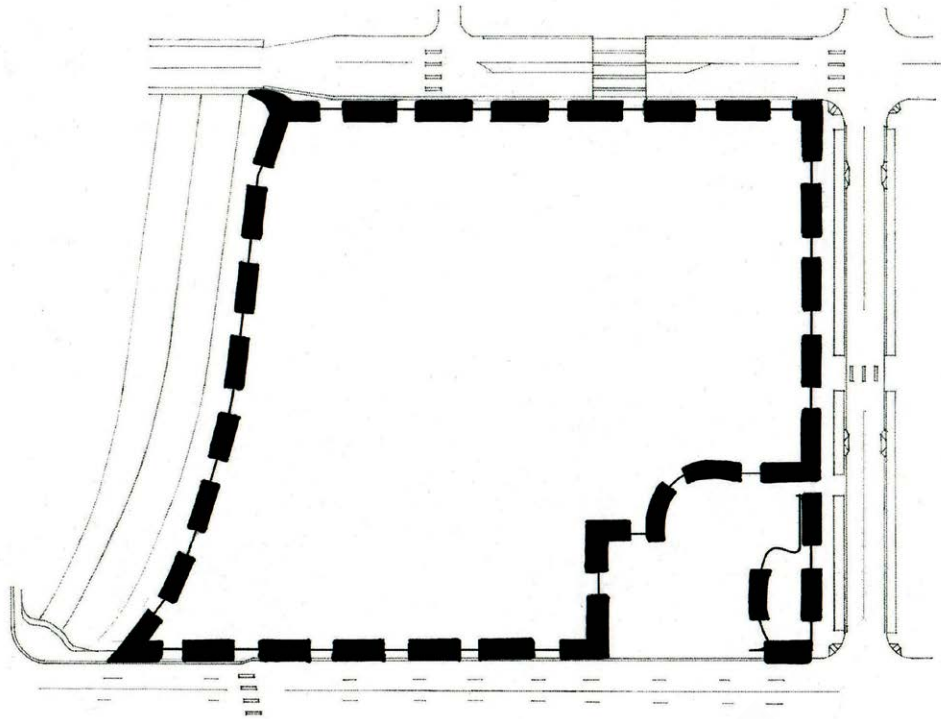

CONTEXT DIAGRAM

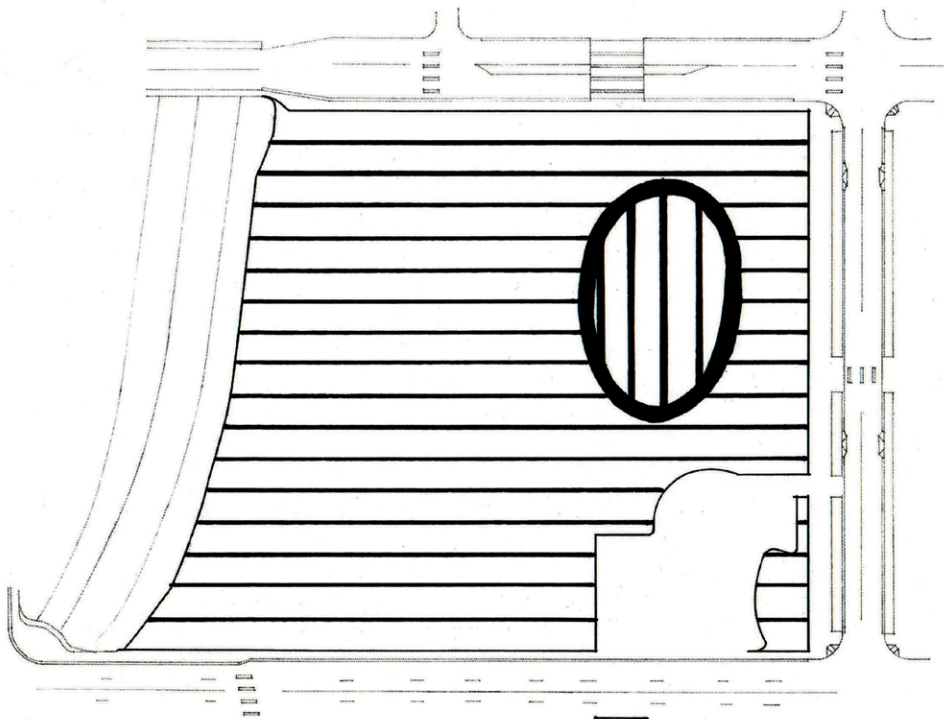

LIMIT OF WORK



RECREATION

-  ACTIVE
-  PASSIVE

SITE ANALYSIS

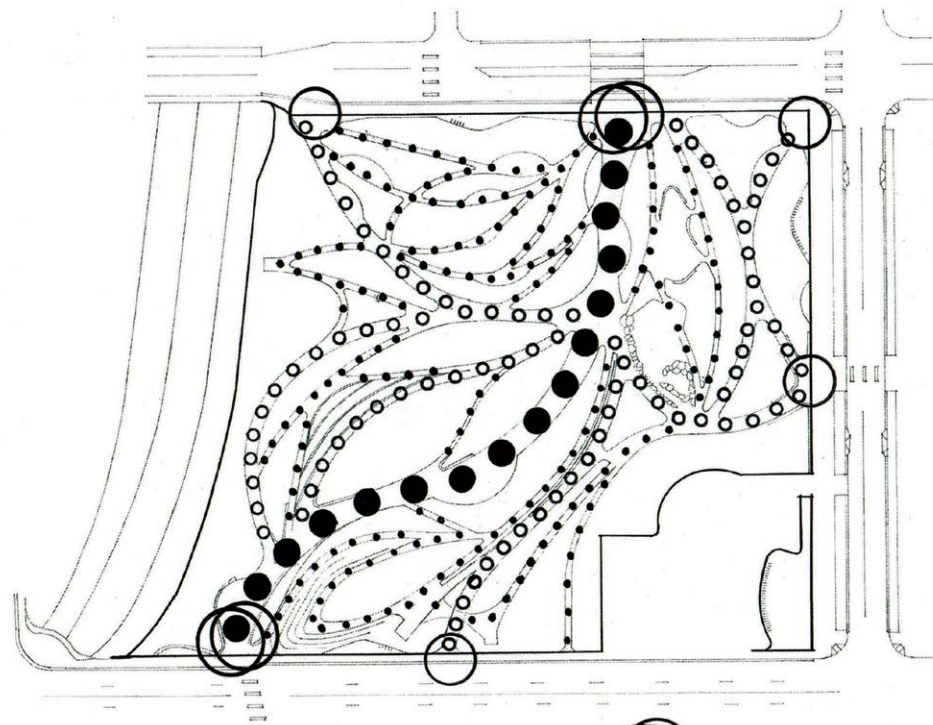

**PEDESTRIAN CIRCULATION
& ACCESS POINTS**

● PRIMARY
○ SECONDARY
• TERTIARY

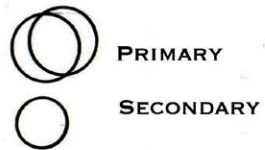

PRIMARY
SECONDARY

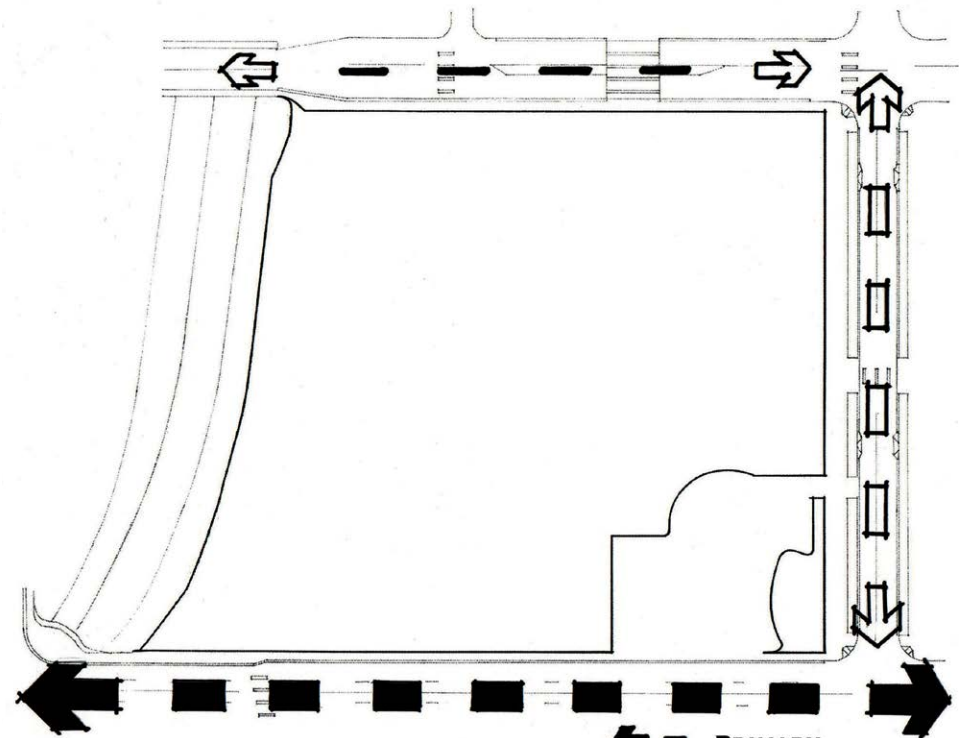

VEHICULAR CIRCULATION

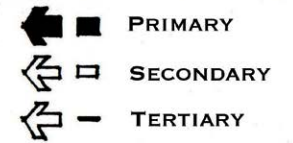

PRIMARY
SECONDARY
TERTIARY

SITE ANALYSIS

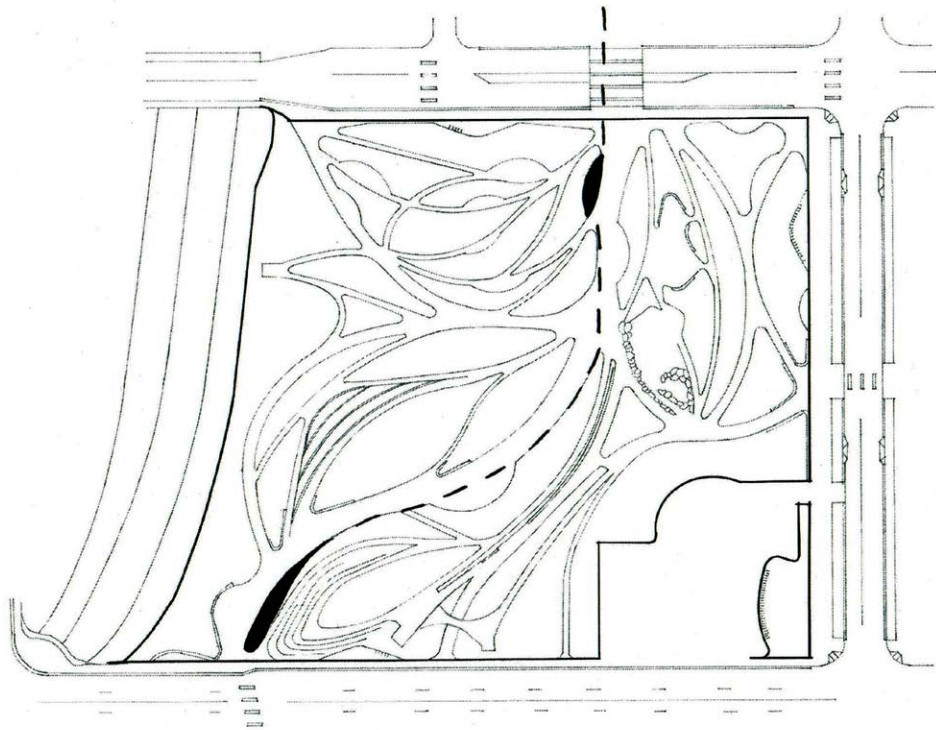

WATER FEATURE



**TREE CANOPY &
EDIBLE SPECIES**

● EDIBLE SPECIES

SITE ANALYSIS

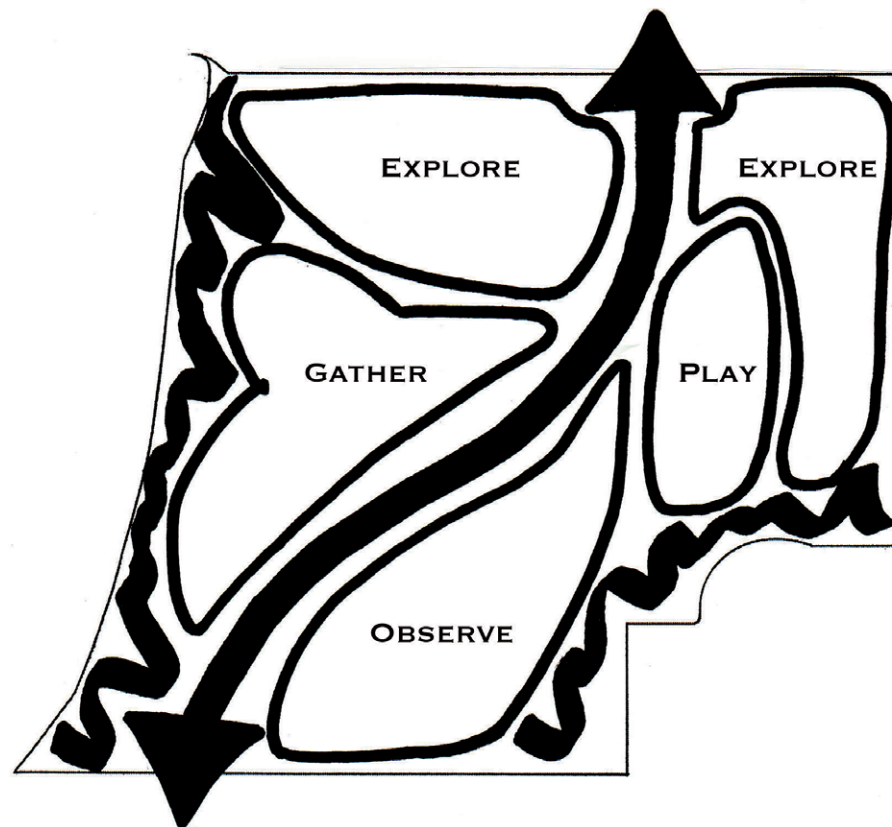

CONCEPT DIAGRAM

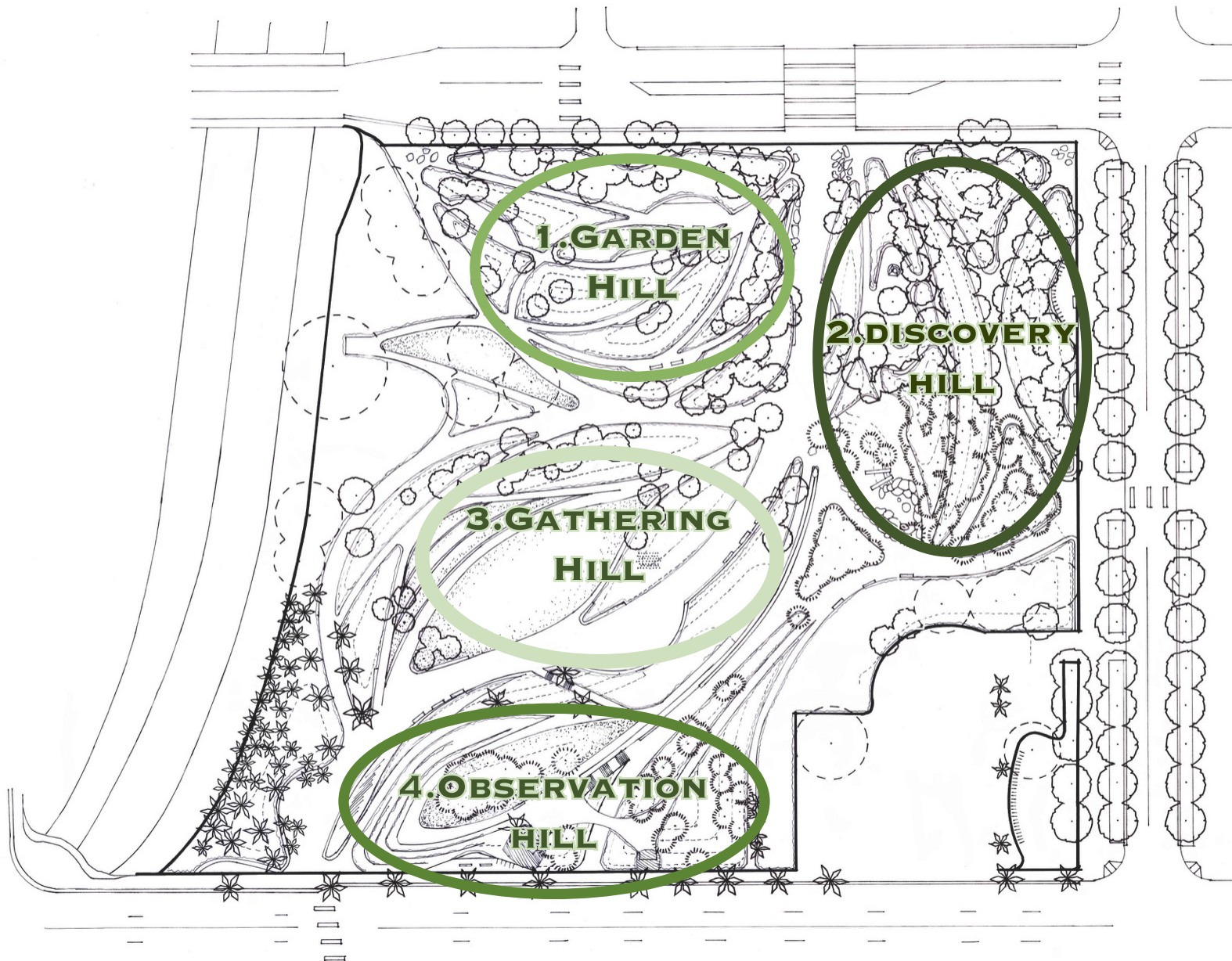

SITE PLAN - FOUR SECTIONS

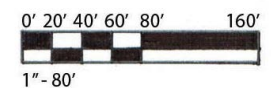

1.

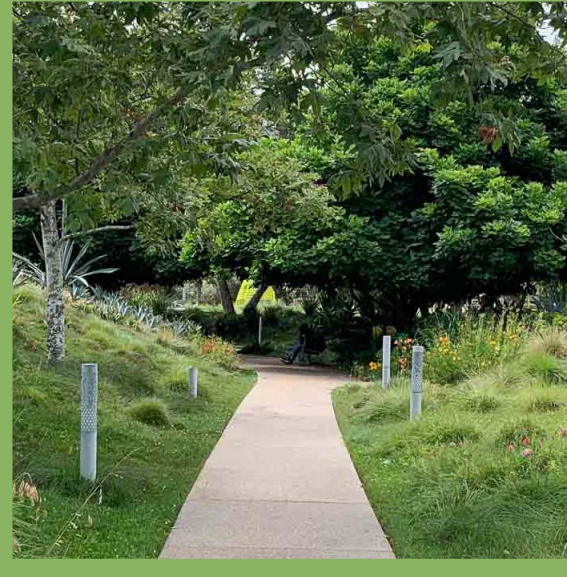

2.

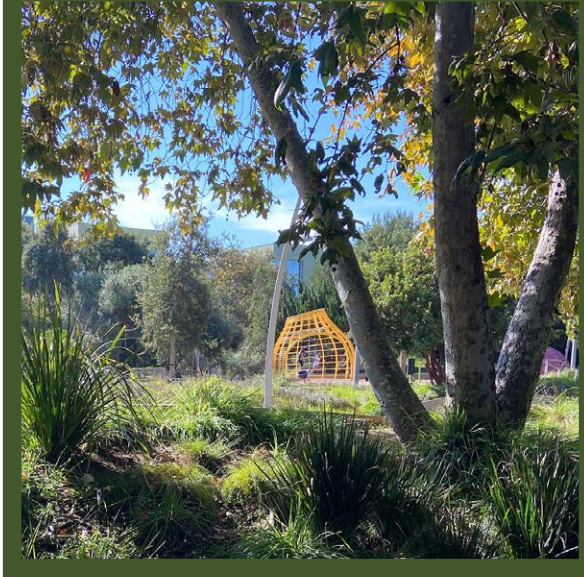

3.



4.



* SEE SITE PLAN FOR PHOTO LOCATIONS

FOUR SECTIONS - GALLERY

1. PICNIC AREA

2. AMPHITHEATER

3. RESTROOMS

4. OVERLOOK

5. WATER FEATURE

6. BIKE RACKS

7. TOT LOT



SITE PLAN

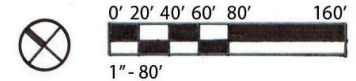

1.

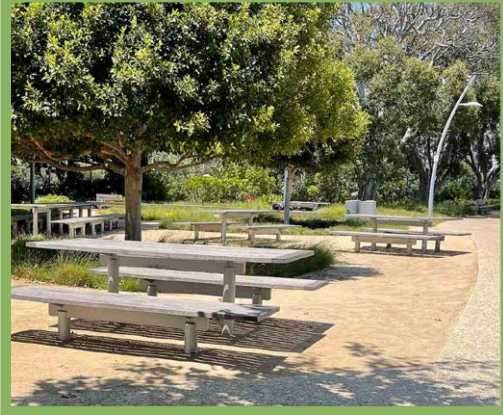

2.

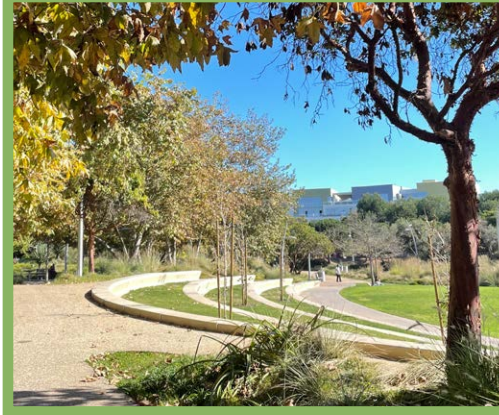

3.



4.



5.



IMAGE COURTESY OF JAMES CORNER FIELD OPERATIONS

6.

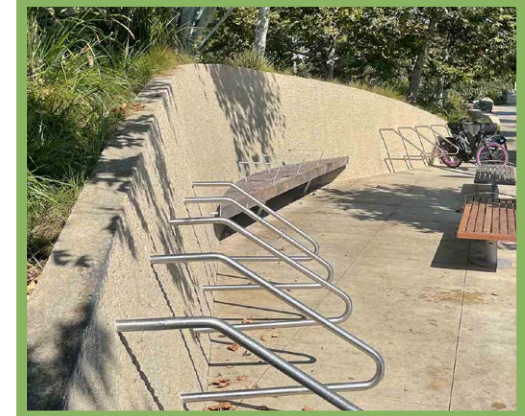

7.



* SEE SITE PLAN FOR PHOTO LOCATIONS

FEATURES FOUND AT TONGVA PARK PROVIDE SOMETHING FOR EVERYONE: PLACES TO EXPLORE, PLAY, PONDER, RELAX, RECONNECT, AND REFRESH.

SITE PLAN - GALLERY





A

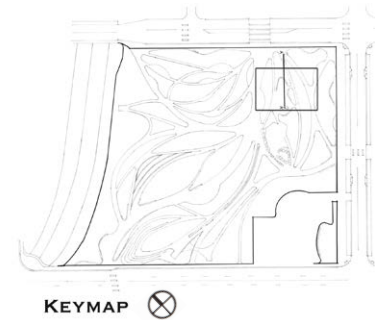

ENLARGEMENT AND SECTION



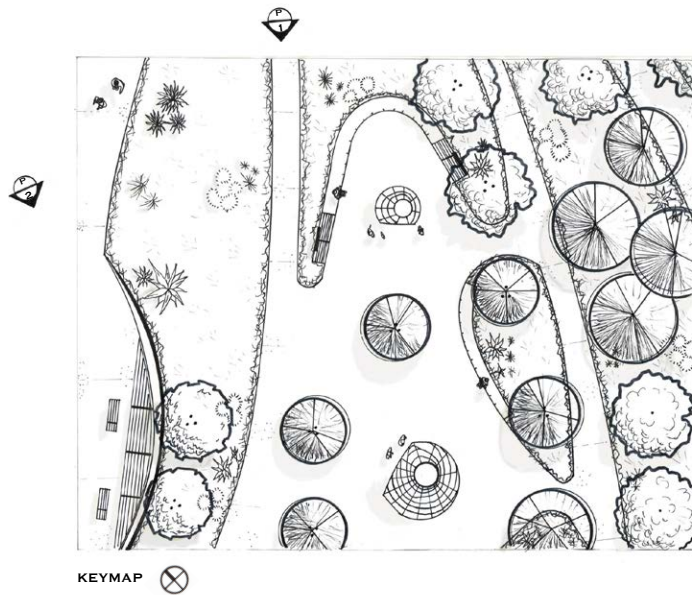

LEFT

P1 - PATHWAY INTO TOT
LOT AREA FROM CITY
HALL

RIGHT

P2 - BENCH ON MAIN
PATH THROUGH PARK
HALL

PERSPECTIVES



SUCCULENTS & CACTI



AGAVE ATTENUATA - FOXTAIL AGAVE



ALOE MARLOTHII - MOUNTAIN ALOE



ALOE PLICATILIS - FAN ALOE



ALOE SPECIOSA - TILT HEAD ALOE



AGAVE AMERICANA - CENTURY PLANT



ALOE STRIATA - CORAL ALOE

PLANT MATERIAL

TREES



**PLATANUS RACEMOSA -
WESTERN SYCAMORE**



**ARBUTUS 'MARINA' -
STRAWBERRY TREE [EDIBLE FRUIT]**



PINUS TORREYANA - TORREY PINE



FICUS MICROCARPA - INDIAN LAUREL



**OLEA EUROPAEA - OLIVE TREE
[EDIBLE FRUIT]**

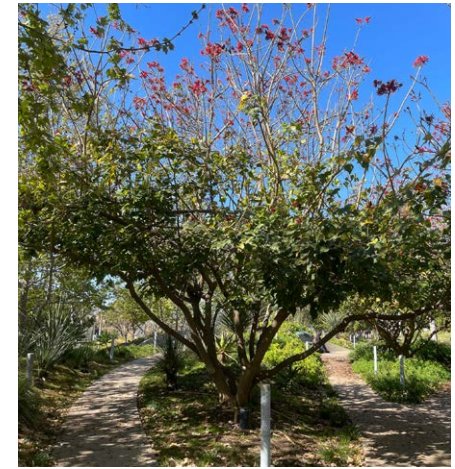

**ERYTHRINA CORALLOIDES -
NAKED CORAL TREE**

PLANT MATERIAL

SEATING



BENCH WITH BACKING



RETAINING WALL CRESCENT BENCH



FLAT BENCH



PICNIC TABLE



LONG PICNIC TABLE



RETAINING WALL BENCH

FIXTURES

LIGHTING



SMALL PATH LIGHTING FOUND IN GARDEN HILL



LAMP POST LIGHTING FOUND ON LARGE PATHS



PATH LIGHTING ON RAMP FENCING

PLAY EQUIPMENT



HUT SHAPED CLIMBING APPARATUS



ROLLER SLIDE



CLIMBING WALL AND SLIDES

FIXTURES

Bio



HEATHER WU IS A FIRST YEAR LANDSCAPE ARCHITECTURE AND HORTICULTURE STUDENT AT UCLA EXTENSION. SHE IS A NATURE LOVER AND AVID GARDENER. SHE STUDIED HOSPITALITY MANAGEMENT AND REAL ESTATE PRIOR TO RECONNECTING WITH HER LOVE OF NATURE. IN RECENT YEARS, SHE HAS BEEN FINDING WAYS TO MAKE AN IMPACT ON THE LANDSCAPE AROUND HER. SHE SPENDS HER FREE TIME VOLUNTEERING AT GARDENS AND PARKS, PLANTING NATIVE TREES, PLANTS, AND BUILDING LANDSCAPE PROJECTS. THE SENSE OF FULFILLMENT GAINED FROM HAVING A DIRECT INVOLVEMENT IN SHAPING THE LAND LEAD HER TO PURSUE THE FIELD OF LANDSCAPE ARCHITECTURE. SHE HOPES TO DESIGN SPACES THAT BRIDGE THE CONNECTION BETWEEN INDOORS AND OUTDOORS, RECONNECTING PEOPLE TO NATURE.

THANK YOU

TO THE DESIGN GRAPHICS INSTRUCTORS, DAVID SQUIRES, REBECCA SCHWANER, AND LAURA RAZO. I HAVE LEARNED SO MUCH IN THE LAST 3 QUARTERS AND PRODUCED DRAWINGS AND GRAPHICS I NEVER WOULD'VE IMAGINED I WOULD BE ABLE TO DO. THANK YOU ALL FOR YOUR PATIENCE, KNOWLEDGE AND GUIDANCE. I HOPE TO HAVE A CHANCE IN THE FUTURE TO WORK WITH YOU ALL AGAIN.

TO MY COHORT IN THE LANDSCAPE ARCHITECTURE PROGRAM, FOR THE SUPPORT, INSPIRATION, AND MOTIVATION WHEN TIMES GOT TOUGH AND ASSIGNMENTS BECAME CHALLENGING. SPECIAL THANKS TO ELIZABETH CRAMER, TRACY WOLK, MACKENZIE DOYLE, MICHAEL BIRCUMSHAW, LIZA OVAKIMYAN AND LEOPOLDO RAMIREZ FOR SHARING YOUR PHOTOS AND KEEPING EACH OTHER ON TRACK. I APPRECIATE YOU ALL.

TO MY FRIENDS AND FAMILY, FOR SUPPORTING ME THROUGH THIS CAREER CHANGE.

TO JAMES CORNER FIELD OPERATIONS AND THE CITY OF SANTA MONICA FOR CREATING SUCH AN INTERESTING SPACE.

RESOURCES:

[HTTP://TONGVAPARK.SMGOV.NET](http://tongvapark.smgov.net)

[HTTPS://INHABITAT.COM/HIGH-LINE-PARK-DESIGNER-COMPLETES-NEW-TONGVA-PARK-IN-SANTA-MONICA/](https://inhabitat.com/high-line-park-designer-completes-new-tongva-park-in-santa-monica/)

[HTTPS://WWW.ARCHPAPER.COM/2019/11/TONGVA-PARK-FEATURE/](https://www.archpaper.com/2019/11/tongva-park-feature/)

GOOGLE IMAGES



TRAIN YOUR
MIND TO
SEE THE
GOOD IN
EVERYTHING

- PAUL WALKER