



TRACY WOLK

DESIGN GRAPHICS 3 ARCH-X 472.4F

WINTER 2022 LAURA RAZO, INSTRUCTOR





# Table of Contents

05	ABOUT THIS BOOKLET
07	SITE CONTEXT
11	ANALYSIS
15	CONCEPT
16	ILLUSTRATIVE PLAN
17	ENLARGEMENT/SECTION
19	PERSPECTIVES
22	GALLERY
28	ACKNOWLEDGEMENTS
29	BIOGRAPHY







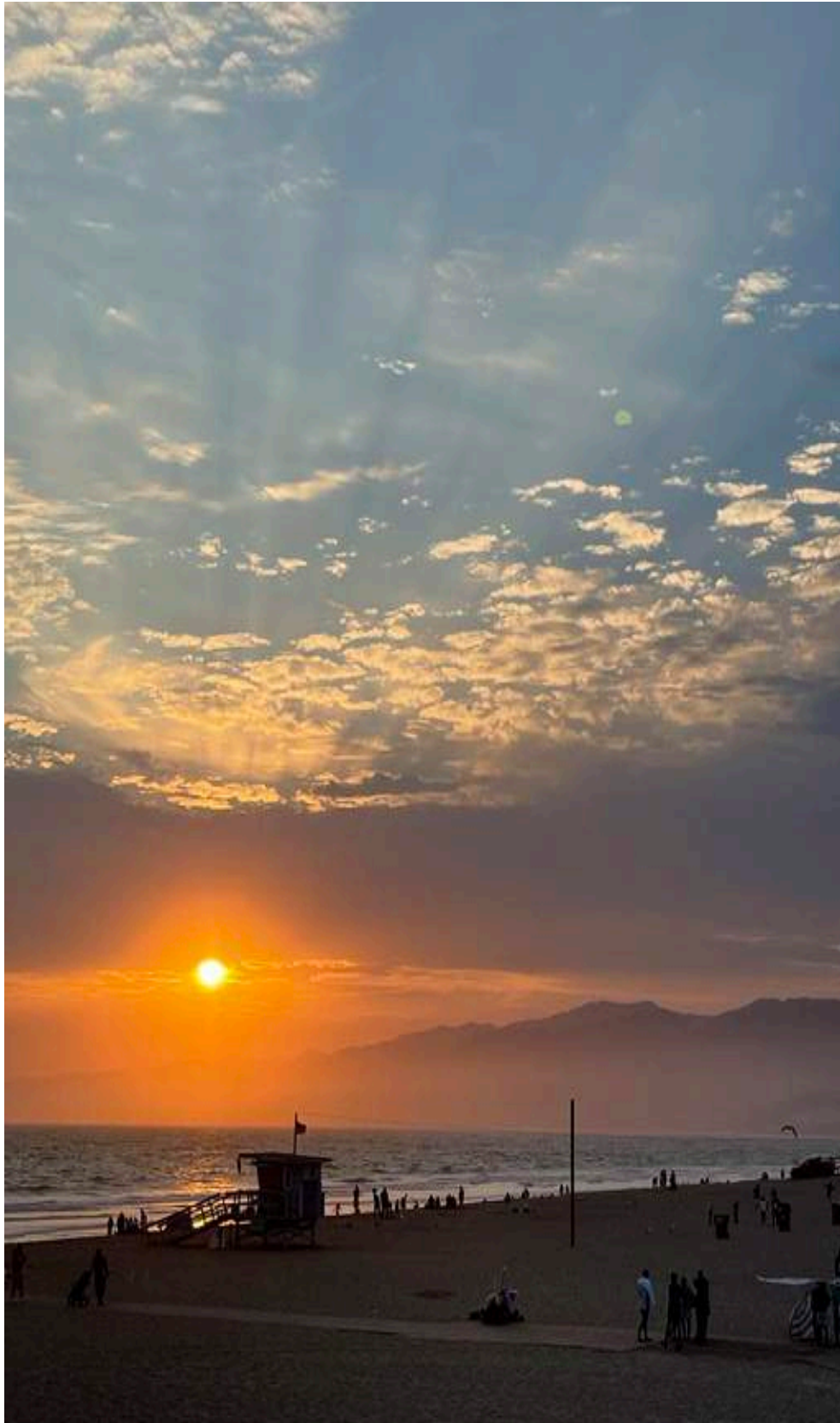

PHOTO LICENSED THROUGH GETTY IMAGES

# ABOUT THIS BOOKLET

This project is a culmination of the first three quarters of design graphics and communications within the UCLA X Landscape Architecture program. We specifically utilized the backdrop of **TONGVA PARK** to both practice hand graphics, learn site analysis and concept development. Each class built onto the next.

Starting with DG1 I learned to express myself through drafting one quadrant of Tongva Park. Learned to use proper line weight to express hierarchy and change of material, we focused on the practice of cutting and drawing a section, learning to map topography in our quadrants, learned the necessary skills to successfully draw perspectives.

In DG2 we looked at the park as a broader whole. I learned to analyse how spaces are used and accessed by the visitors. We discussed design intent and I learned to look closely at every detail, focusing on the choices the Landscape Architects who designed Tongva Park made.

If DG1 taught us to crawl, DG2 taught us to walk. DG 3 solidified my graphic voice. I learned to transform the hand graphics I produced into a digital format (this booklet), how to render in photoshop, how to present our work going forward. The tools I've learned are invaluable and I am so grateful to have gone through this growth.



# MAKE SLOW SPACES IN URBAN JUNGLES–

JENNY B. OSULDSSEN  
OSLO, NORWAY

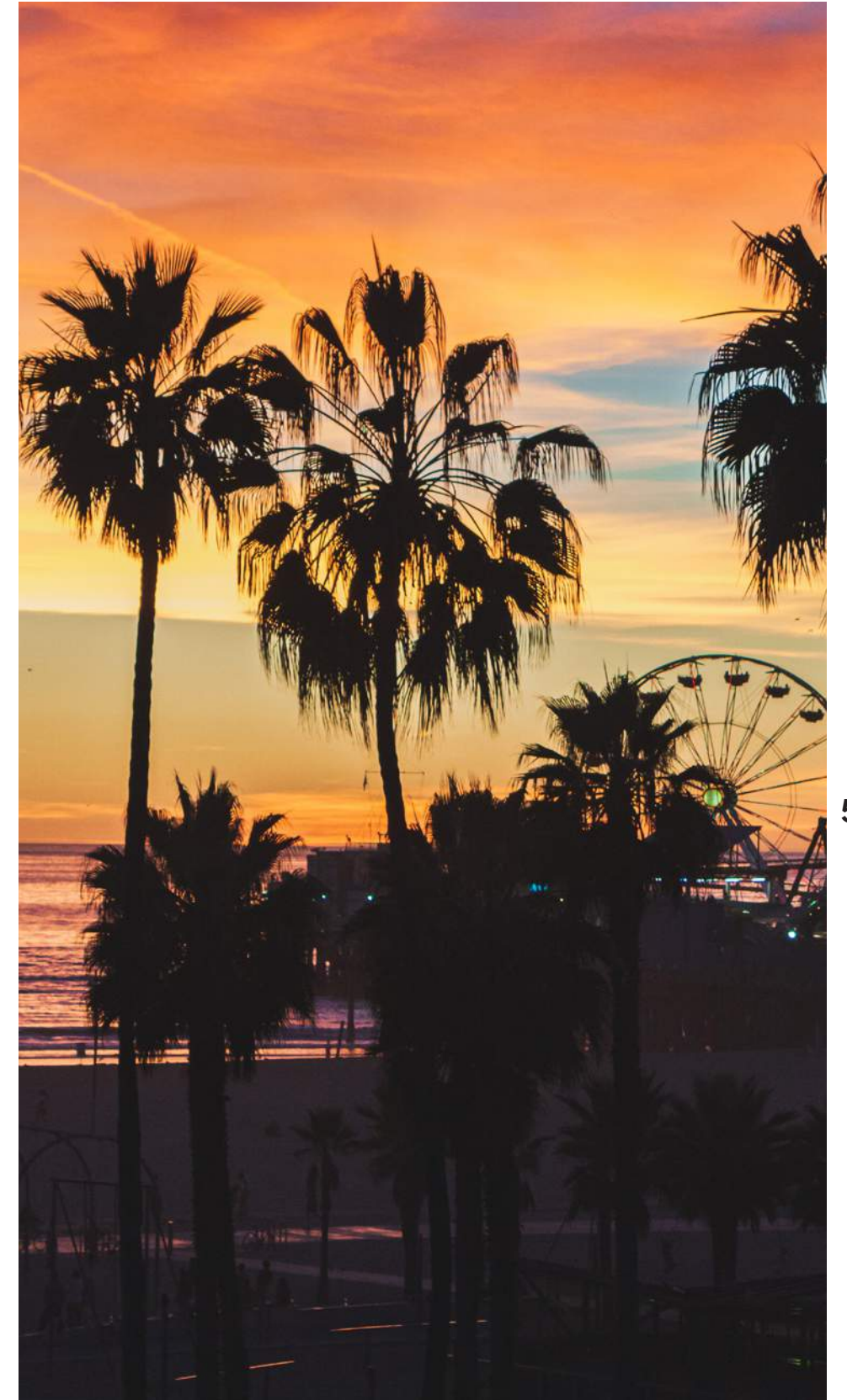
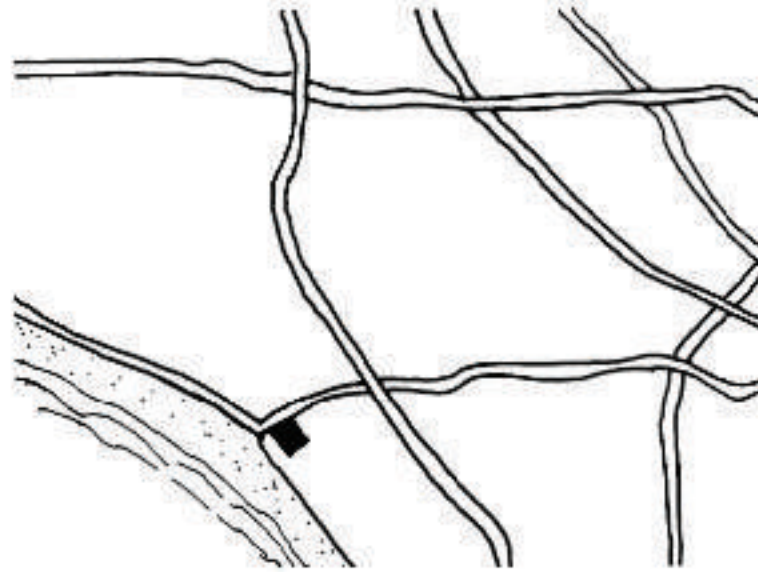
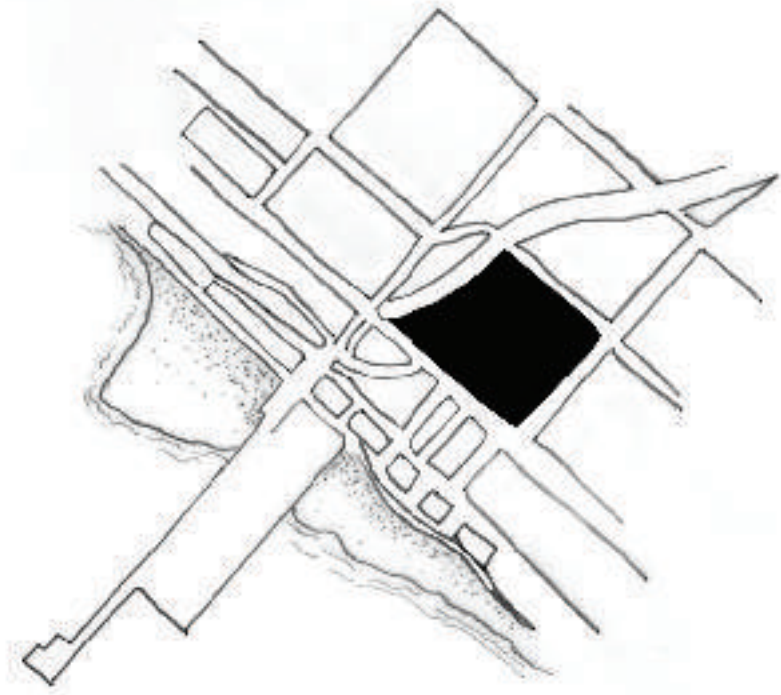

PHOTO LICENSED THROUGH GETTY IMAGES





NTS



**TONGVA PARK**, built in 2013, is situated in sunny Santa Monica, California. Sandwiched between city hall and the ocean it is hard to believe that this 6 acre park with dramatic topography that includes rolling meadow covered hills and winding paths was not so long ago a parking lot. Designed by the team at James Corner Field Operations whose brief was “to construct a park and “garden walk.” Tongva Park’s design was shaped by community participation and successfully transformed the urban environment into a garden oasis. Pathways within the park emerge from city hall and extend west towards Ocean Avenue they were designed to harken back to the Southern California arroyo washes that dotted this landscape long ago. The park provides a space for its visitors to gather together or enjoy quiet contemplation.

6

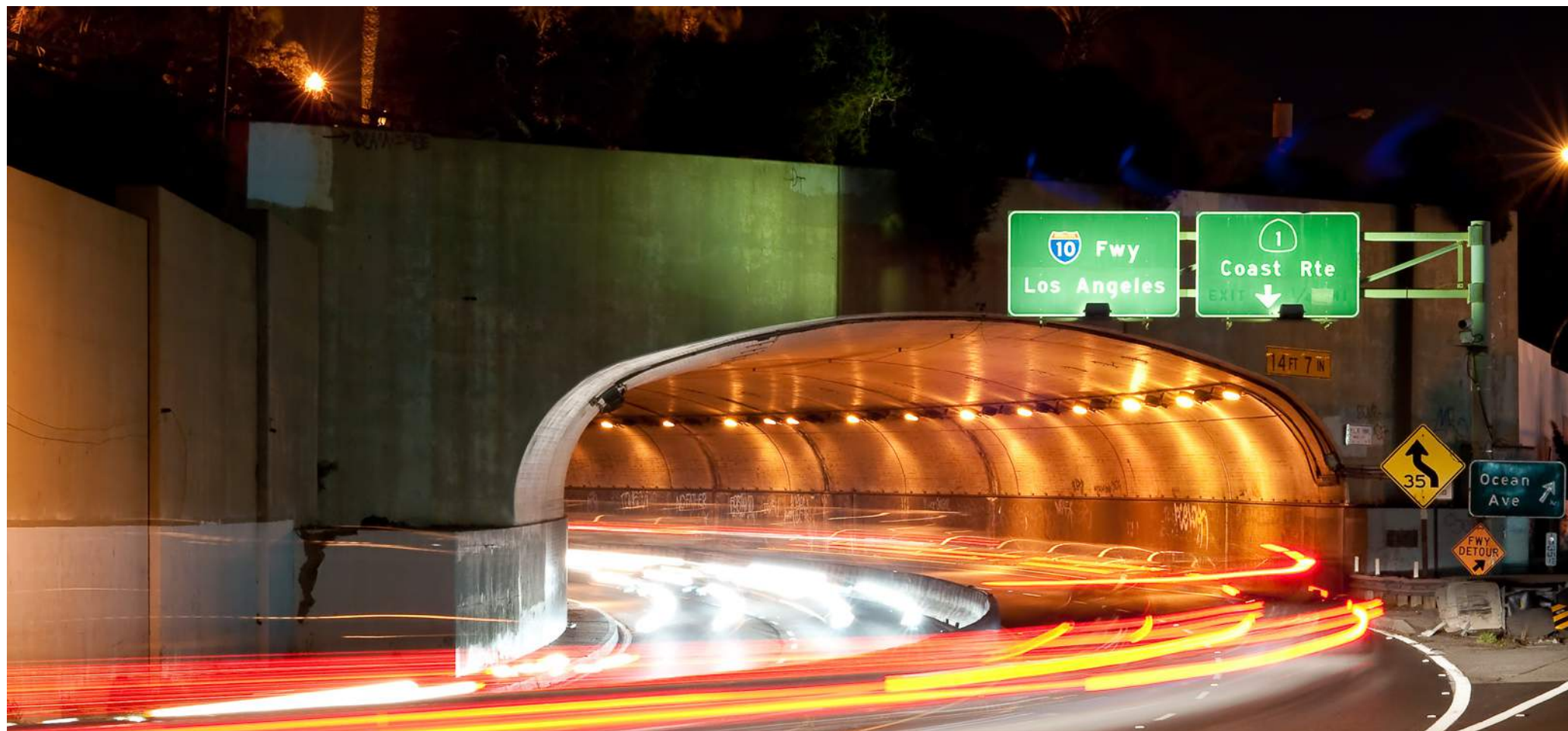
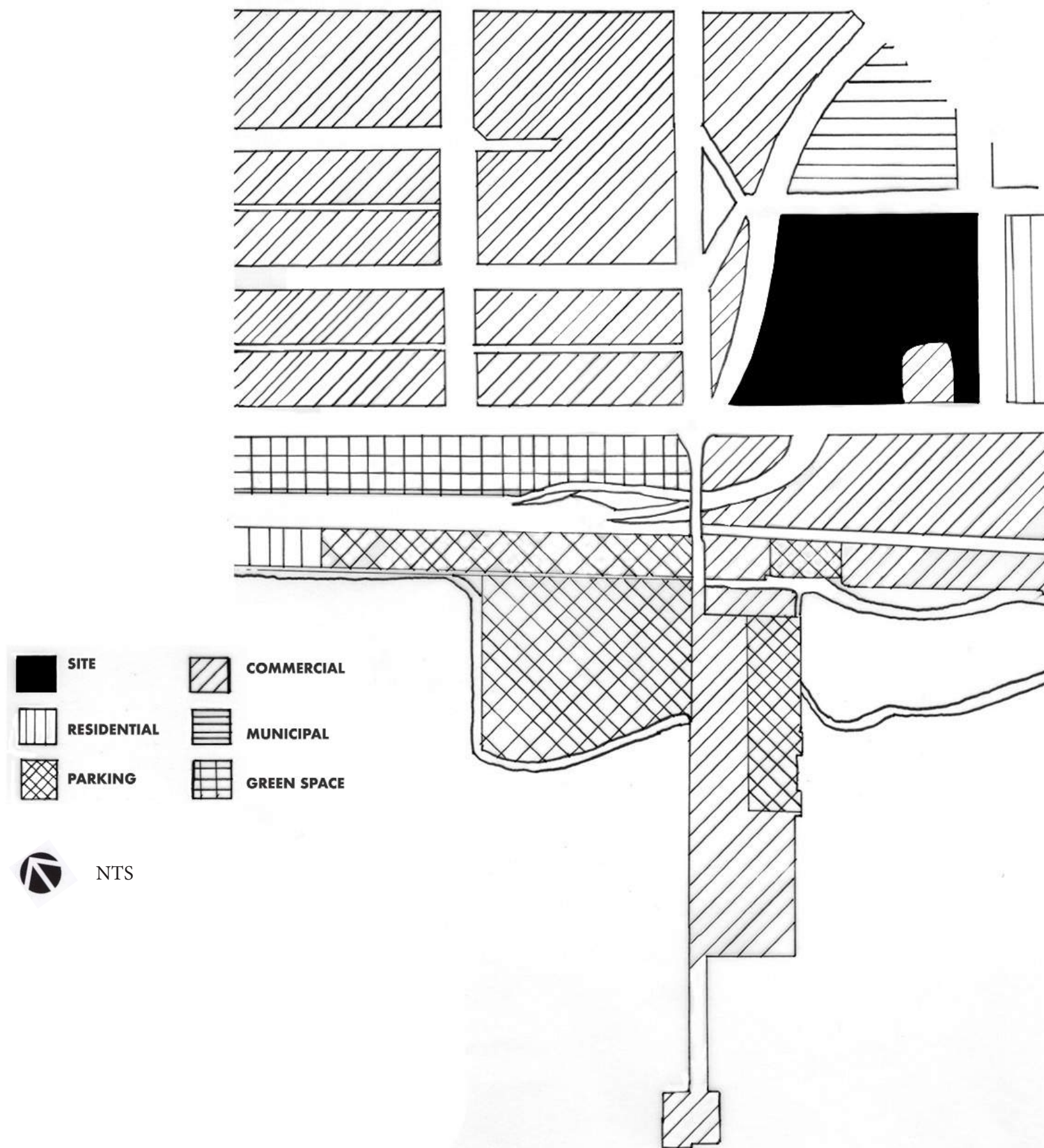

PHOTO CREDIT: PHOTOGRAPHY PERSPECTIVES LICENSED THROUGH ISTOCK PHOTOS

**SITE CONTEXT  
LOCATION MAPS**





PHOTOS COURTESY OF VISITCALIFORNIA.COM

# SITE CONTEXT CONTEXT DIAGRAM





**SITE ANALYSIS**  
**VEHICULAR CIRCULATION**





**TONGVA PARK** incorporated several beloved trees that were already on the site into the arroyo inspired plan. “Morty” the Morton Bay Fig tree was preserved and moved into a buffer zone that helps dampen the noise of the Santa Monica (10) freeway just below it. This project carefully balances environmental and cultural conditions into a complex large scale meadow garden in a public space, intentionally and magically insulated from the busy streets and surrounding freeway.



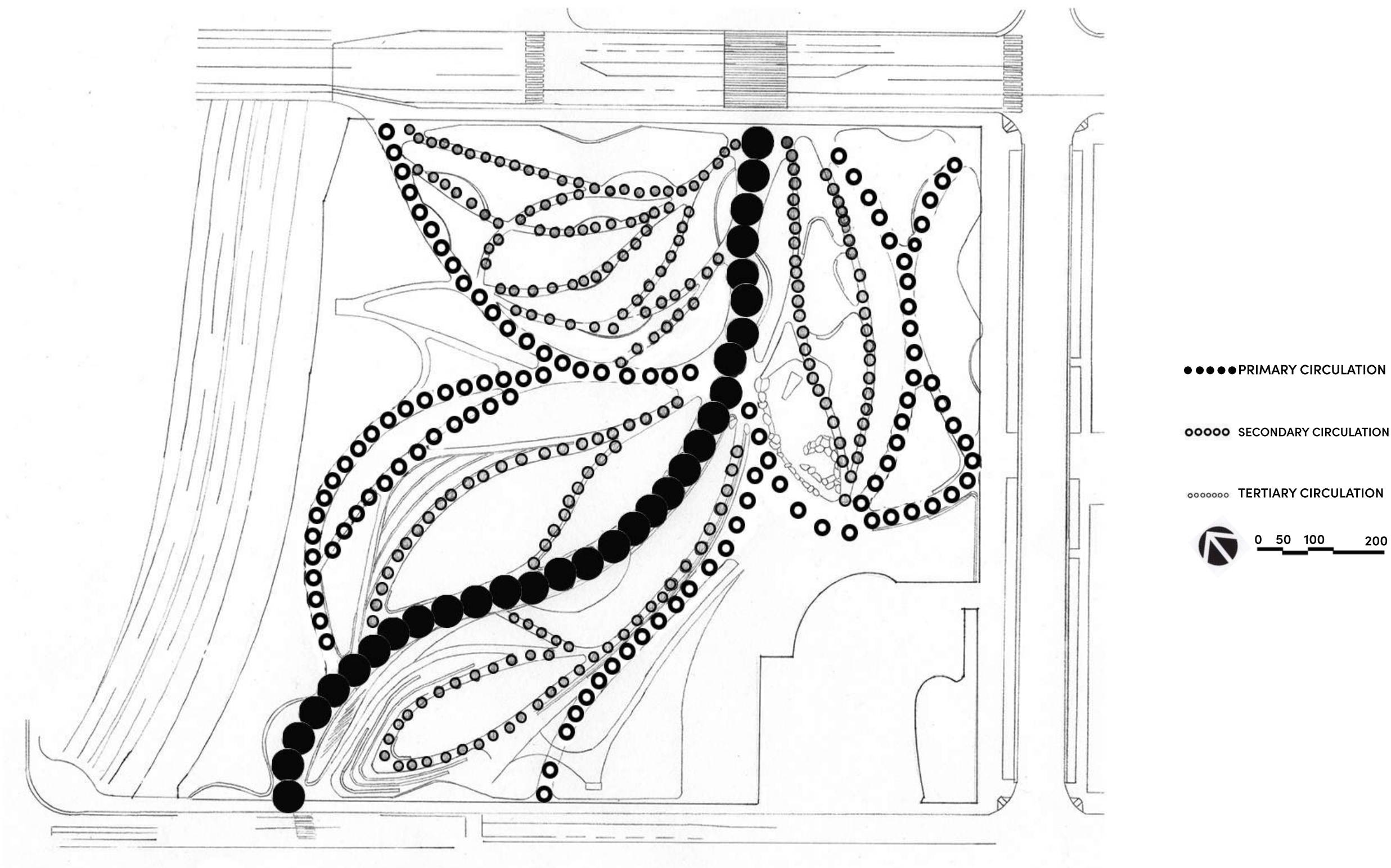

**SITE ANALYSIS**  
**PEDESTRIAN CIRCULATION**



**TONGVA PARK's** shaded paths are defined by locally sourced tumbled aggregates, larger aggregate lets visitors know they are on primary pathways, smaller aggregate tells visitors they are on a secondary, smaller path- a tributary if you will. Each path was inspired by the washes and ravines that once occupied this site. Creating a fluid and organic system that moves you through this idyllic urban park.







**TONGVA PARK** is divided into four main sections. **Observation Hill**, **Discovery Hill**, **Garden Hill**, and **Gathering Hill**. Each calibrates for different primary use and experience:

① **Observation Hill** offers impressive views of the ocean and neighborhood. Overlooks fabricated from plasma cut steel create a contemporary and striking park edge.



② **Discovery Hill** is a place children can play and explore. The playground includes a music wall, splash zone, hill side slides, and structures for imaginary play and climbing. Discovery Hill also boasts more trees than any other section of the park. It combines native sycamores, oaks, olives, and pines to provide much needed relief from Santa Monica's perfect weather.



③ **Garden Hill** is defined by its California native plant palette and peaceful alcove seating.

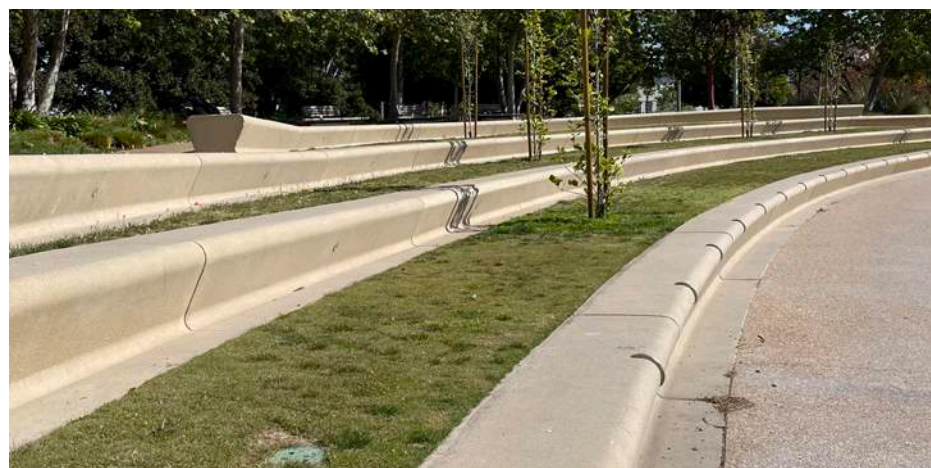

④ **Gathering Hill** has a large lawn with terraced seating for a perfect picnic spot, nighttime jazz concerts, or other programming. This section was specifically designed to bring the community together.

**CONCEPT**



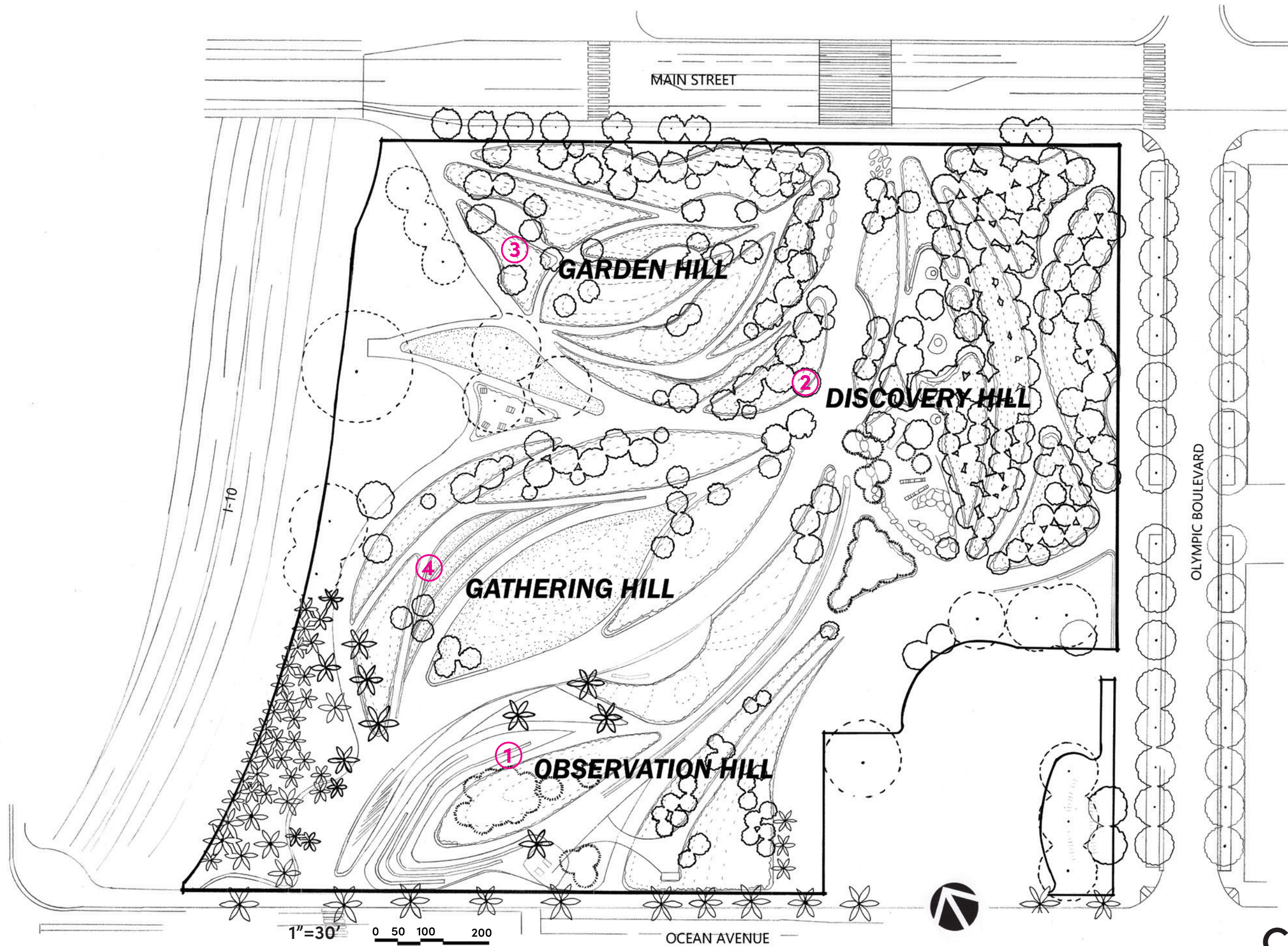



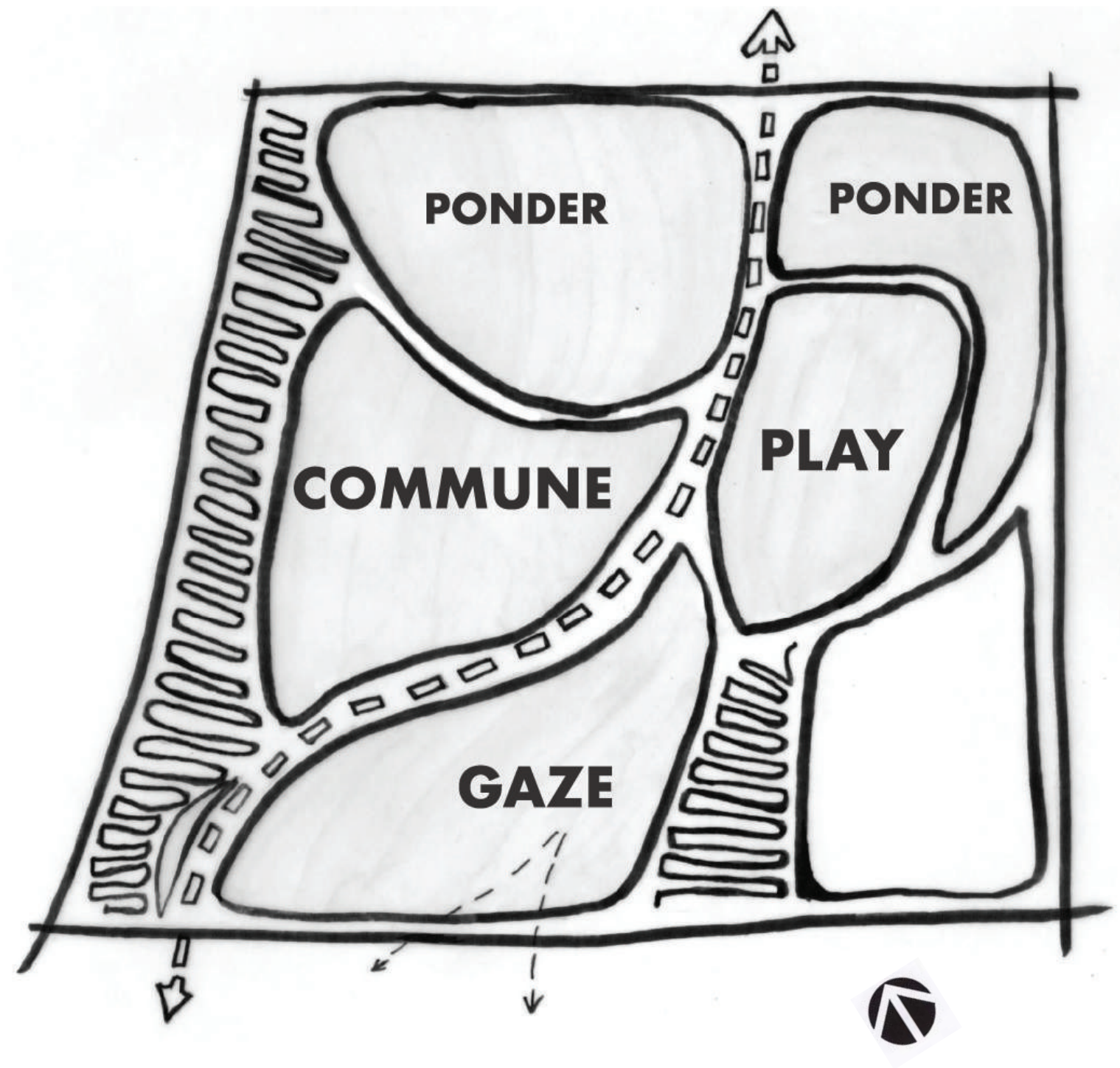

CONCEPT  
DIAGRAM





**TONGVA PARK** transforms the urban fabric of Santa Monica. Active, innovative, and resource conscious this park connects the pedestrian corridor linking Santa Monica City Hall to the surrounding commercial areas with multiple different entrances. Much more than a pass through the park contains picnic tables, water features, a playground, and ample seating to linger a while.



- 1 Picnic Area
- 2 Water Feature
- 3 Bike Rack
- 4 Tot Lot
- 5 Overlook
- 6 Restrooms
- 7 Sculpture



ILLUSTRATIVE  
PLAN



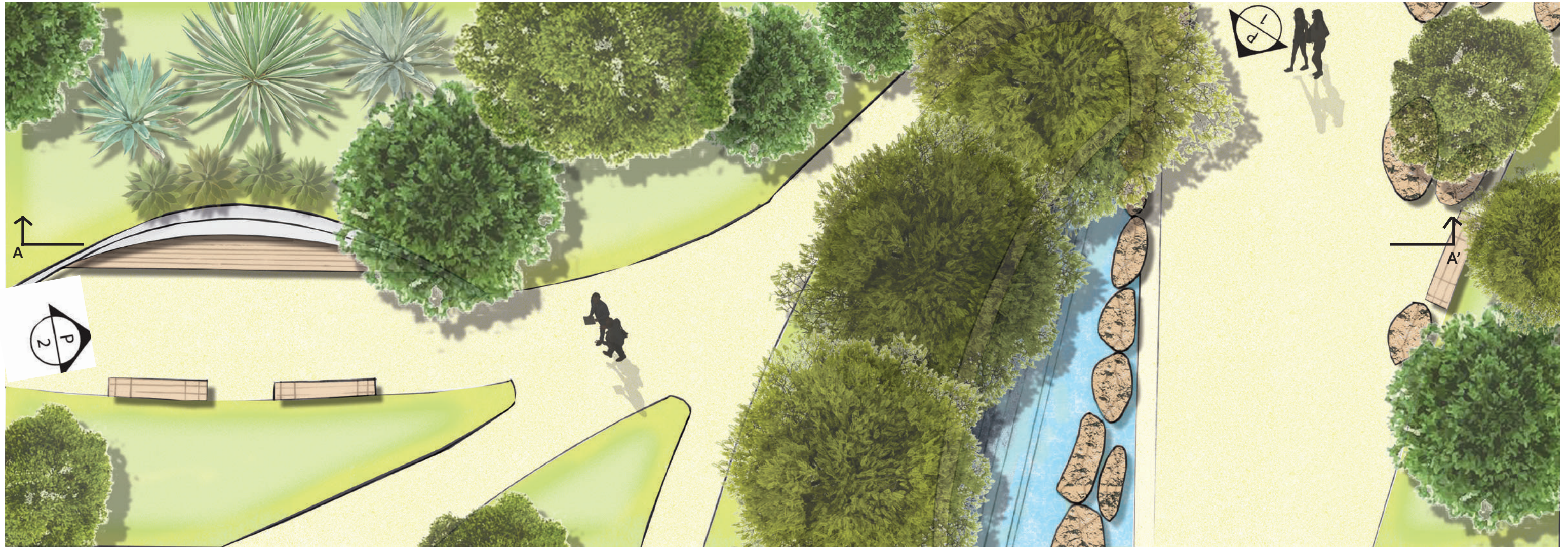

1/8"=1' 0 50 100 200

# ENLARGEMENT





KEY MAP

**SECTION  
ELEVATION**



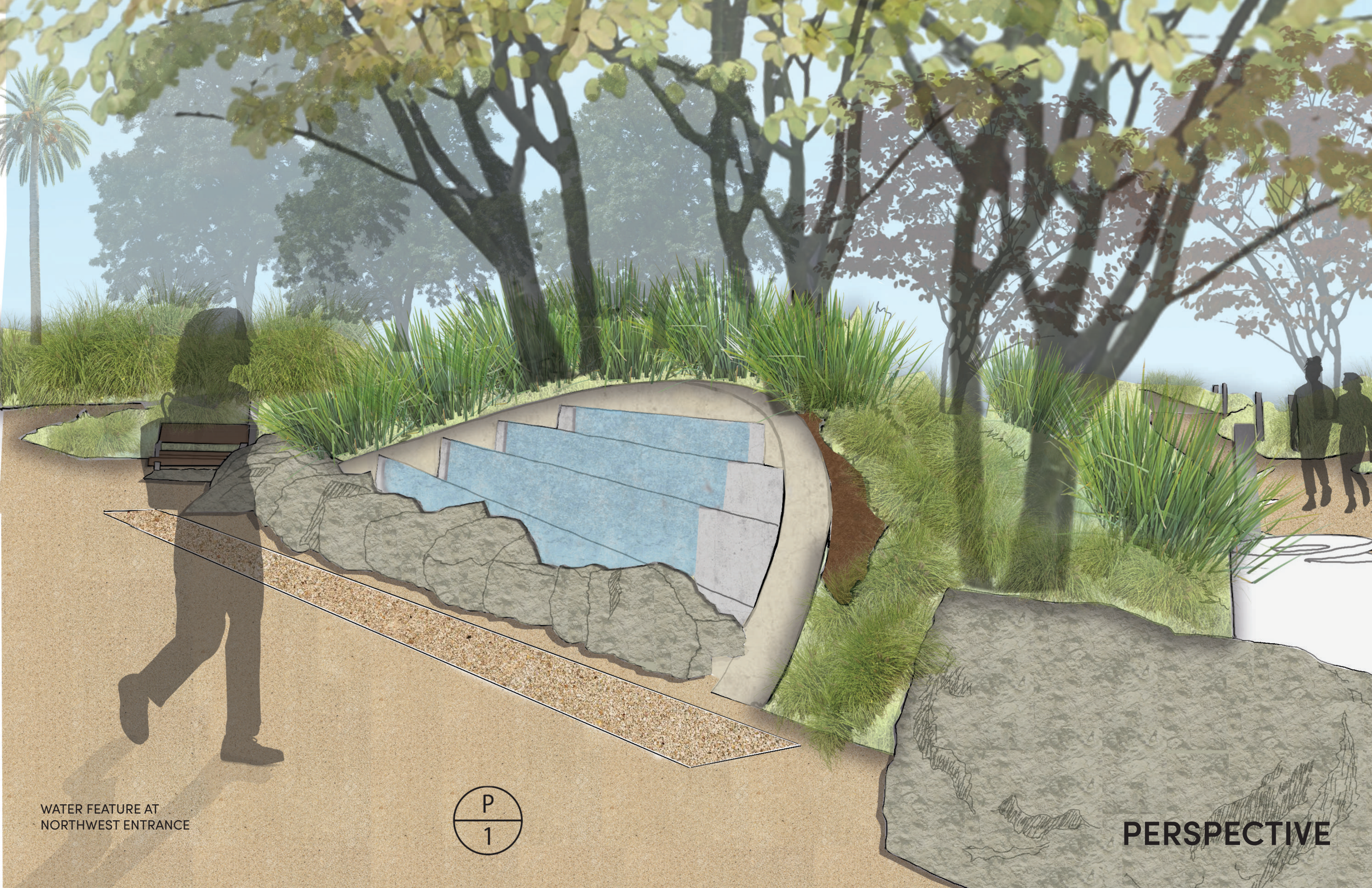

WATER FEATURE AT  
NORTHWEST ENTRANCE



PERSPECTIVE



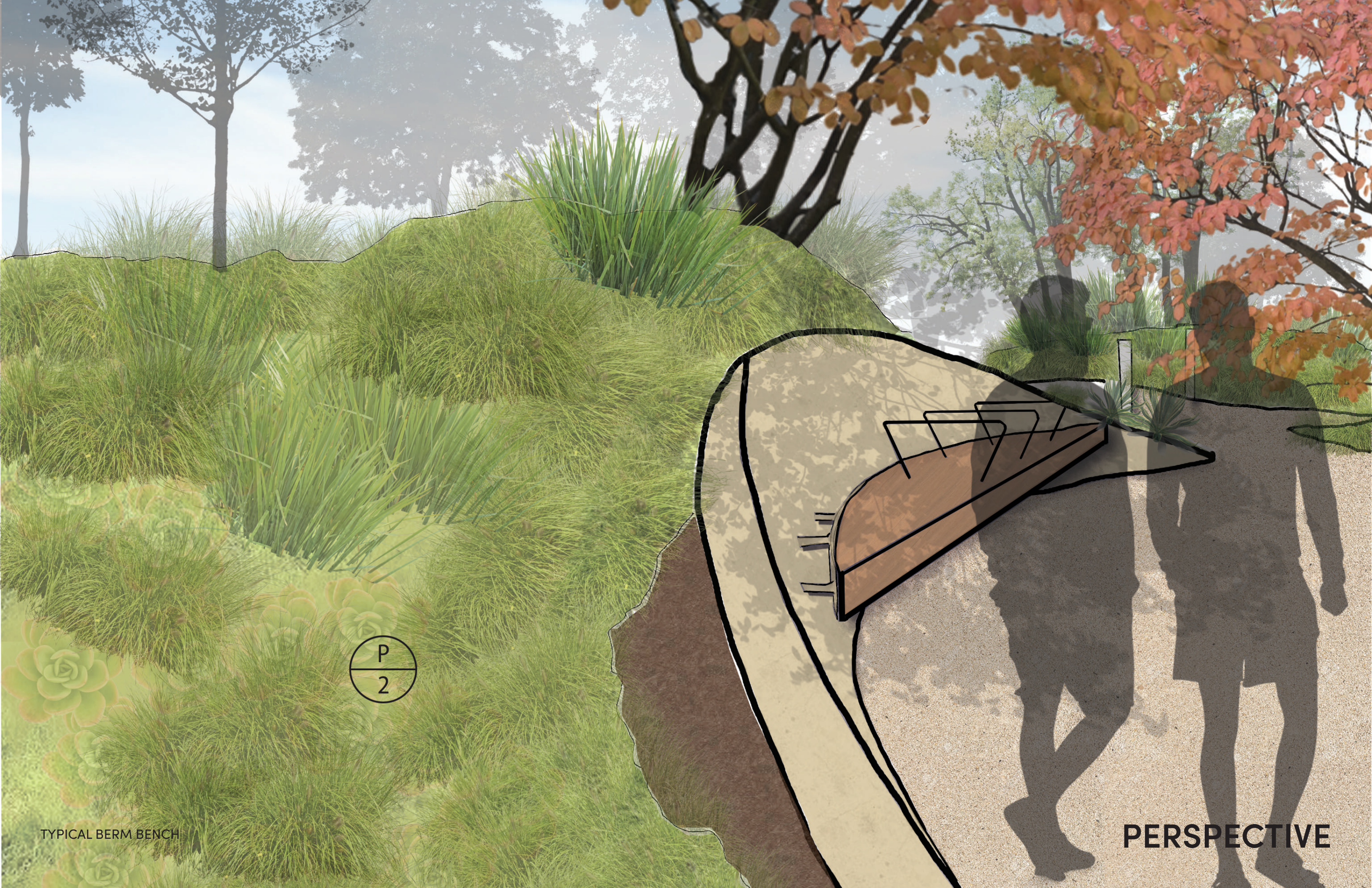

P  
2

TYPICAL BERM BENCH

PERSPECTIVE





RAMP/ WALKWAY LEADING TO  
OCEAN BLVD OVERLOOK



PERSPECTIVE





Bob Perry, FASLA was the key horticultural consultant of **TONGVA PARK**. Featuring a native an locally appropriate sustainable planting schematic that changes subtly with the seasons. The stunning ombinations of succulents and grasses creates a landscape of spikes mixed with soft, finely textured undulating mounds. Adding texture and kinetics to the ground plane.

## GALLERY PLANT MATERIALS









Cast in place concret walls and alcoves are a major part of **TONGVA PARK'S** design.

As well as the majority of paving within the park that is comprised of locally sourced tumbled aggregate.

Additionally, California gold boulders act as bollards throughout the park. Bringing a texture and color rooted in California's geology.

## GALLERY HARDSCAPE





25

**GALLERY  
HARDSCAPE**





**Tongva Park** at night is softly illuminated by highly efficient LED and HID Luminaires. Designed to be sensitive to the nearby residential units and preserving the views to the ocean it still provides a safe and comfortable environment to visitors from dusk till dawn. Designed by HIB Lighting Design , Inc. the 306,000 square foot parks lighting design meets both local and California energy codes.

**GALLERY  
LIGHTING**



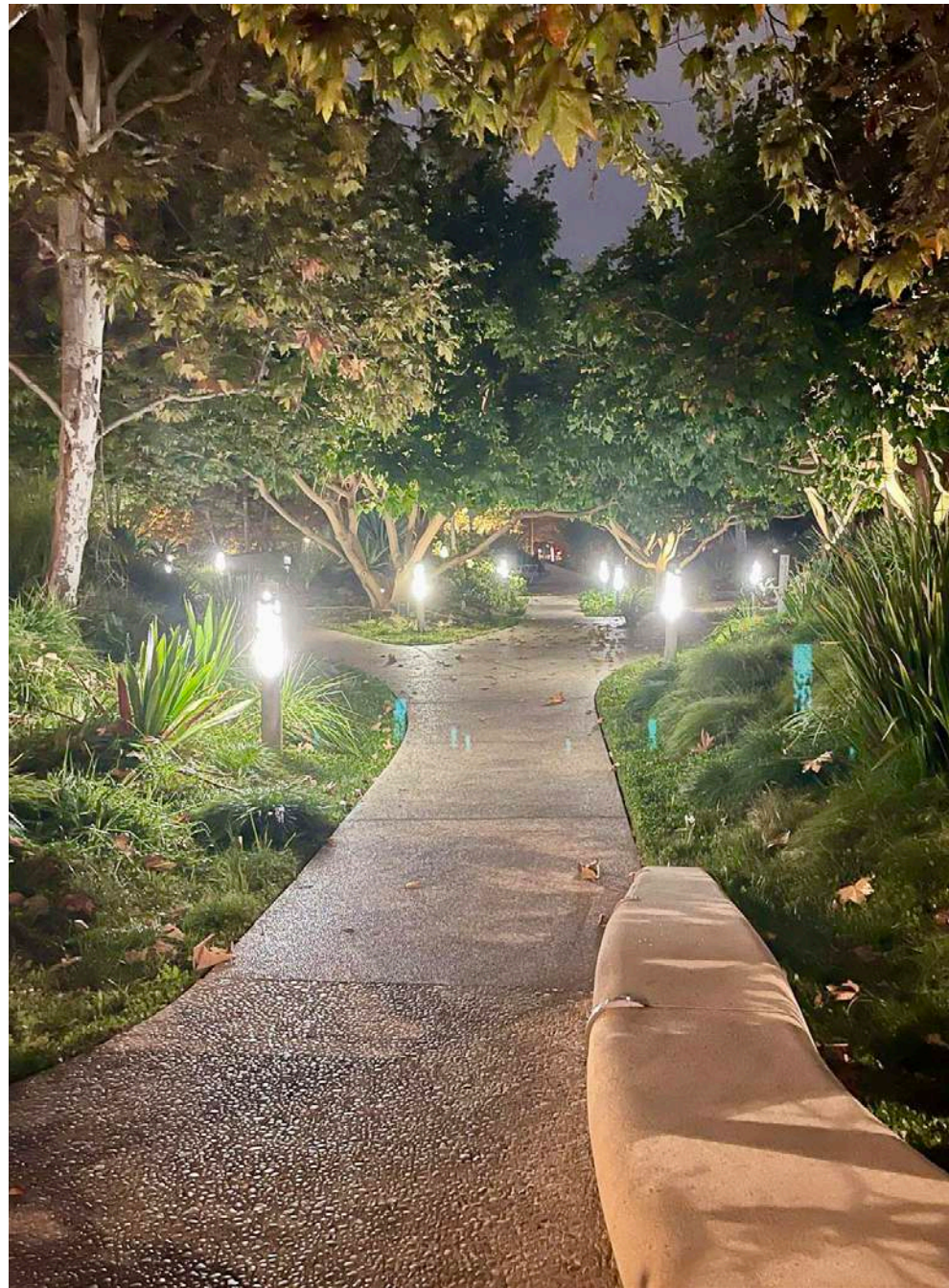

PHOTOS COURTESY OF MICHAEL BIRCUMSHAW

## GALLERY LIGHTING





## ACKNOWLEDGEMENTS

Thank you to the Design Graphics instructors at UCLA  
LandArch- David Squires, Rebecca Schwaner, and Laura Razo. You all possess the patience of Job, are fonts of knowledge, and generous of spirit and time.

To my cohort. Thank you for making me laugh and providing so much support. Knowing we are all in this boat together is so helpful.

Thank you to James Corner Field Operations for creating such a varied and dynamic public space.

Huge thank you to my daughter, Ivy. I am sorry I rarely make dinner anymore. Who knew Annie's Vegan Mac and Cheese would turn out to be the going back to school hero in all of this?

Resources;  
[tongvapark.smgov.net](http://tongvapark.smgov.net)  
[archpaper.com](http://archpaper.com)  
[latimes.com](http://latimes.com)





## TRACY WOLK

Personal trainer, future Landscape Architect, single mother, voracious reader and dilettante doomsday prepper, Tracy lives with her inimitable daughter Ivy and her adorable but mischievous dog Clover in Los Angeles.

Ms. Wolk is tackling the challenges of full time school and full time parenthood with a wicked sense of humor and an indomitable spirit.