



DESIGN GRAPHICS 3

# TONGVA PARK

By: Robert Hancock





TODAY, ONE FINDS THE CENTER OF CITY OR TOWN ONLY BY THE INCREASING HEIGHT OF BUILDINGS, THE INCREASING CLAMOR OF LIGHTS AND SIGNS, AND THE INCREASING CONGESTION OF TRAFFIC. WE STILL BUILD TEMPLES AND PALACES AND MANY OTHER SPLENDID STRUCTURES, BUT THEY ARE LOST IN THE MODERN URBAN JUNGLE.

GARRETT ECKBO, THE LANDSCAPES WE SEE



# Introduction



---

This full graphic package is supported with digital renderings, sections, and elevations that demonstrate the knowledge and drawing techniques learned in my first year of UCLA's Landscape Architectural Program.

All work products presented in this booklet was developed from Tongva Park, a real site located in Santa Monica.

- Robert Hancock

---

# TABLE OF CONTENTS

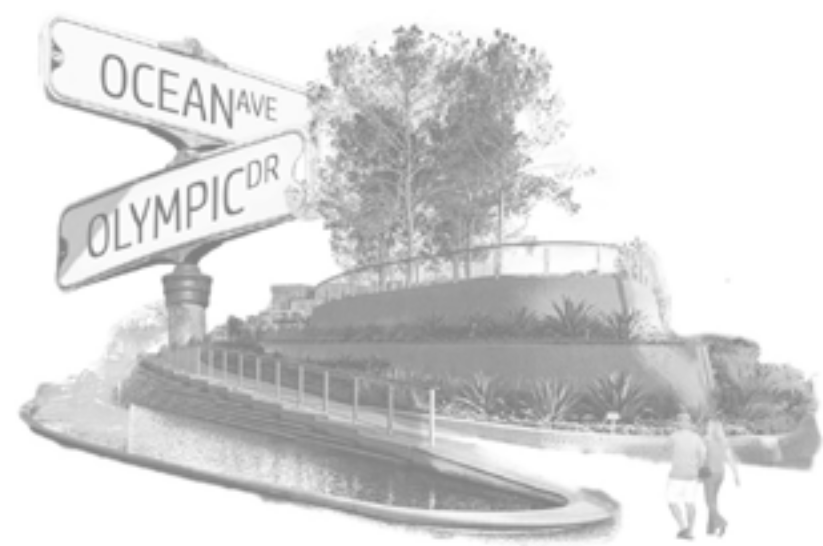

LOCATION	5
SITE CONDITIONS	6
CONCEPT DIAGRAM	8



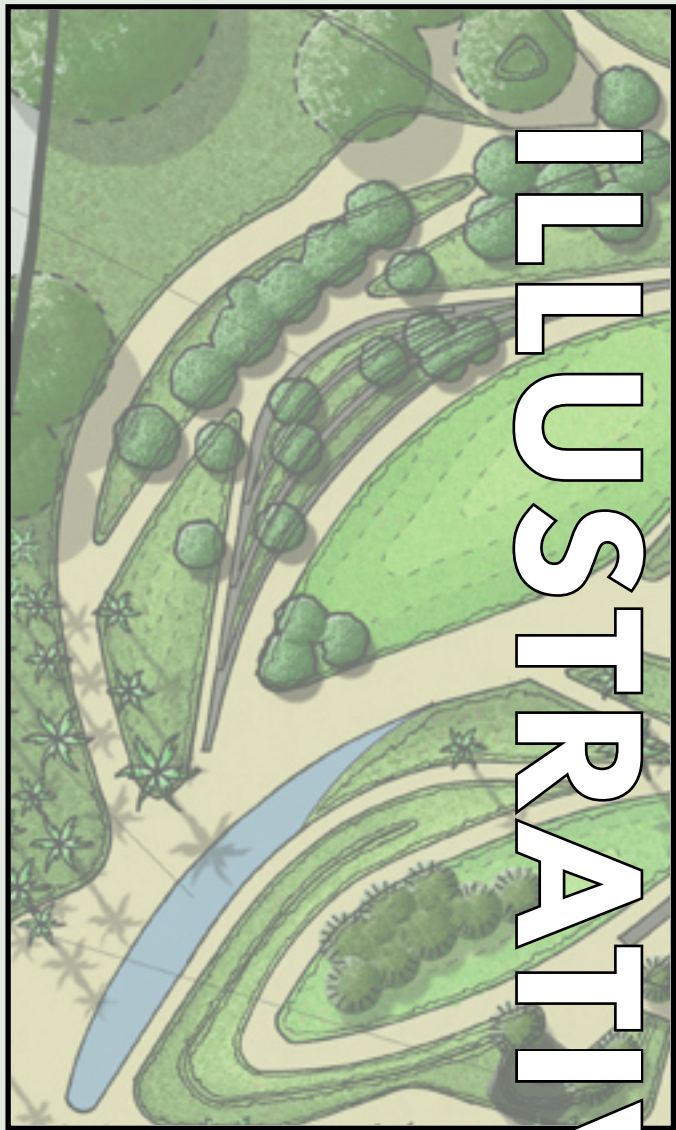

# ILLUSTRATIVE

RENDERED PLAN 10

SUPPORTED  
GRAPHICS 11- 12

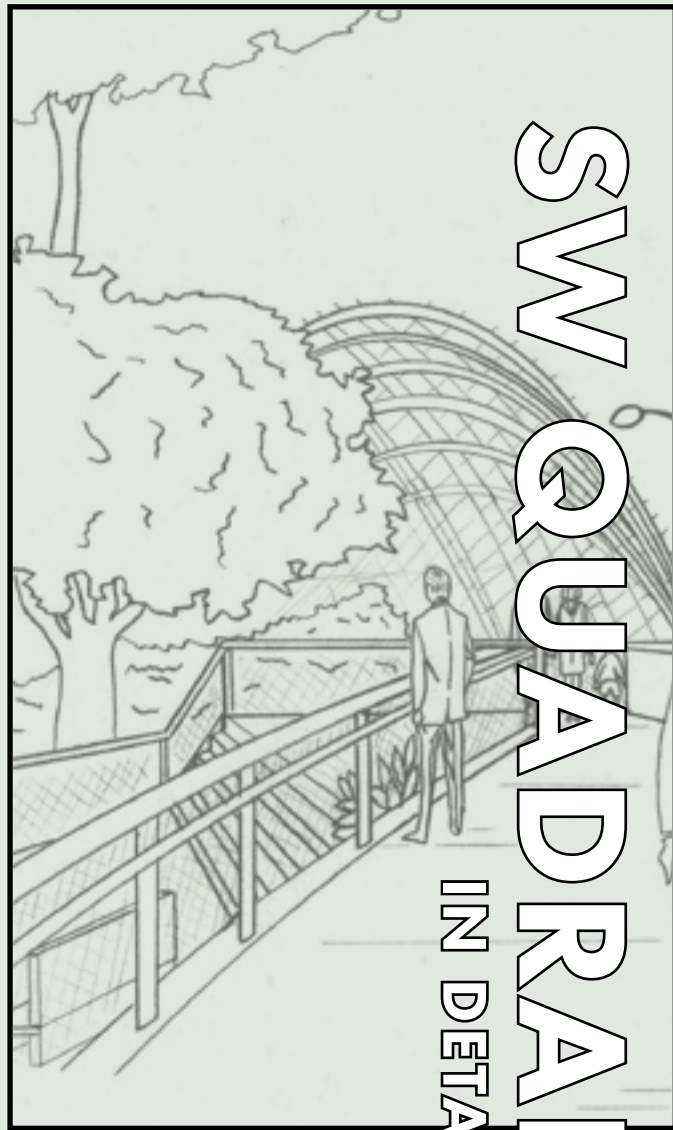

# SW QUADRANT IN DETAIL

SW SITE PLAN 14

PLANTING PALETTE 17-18

IMAGE GALLERY 20

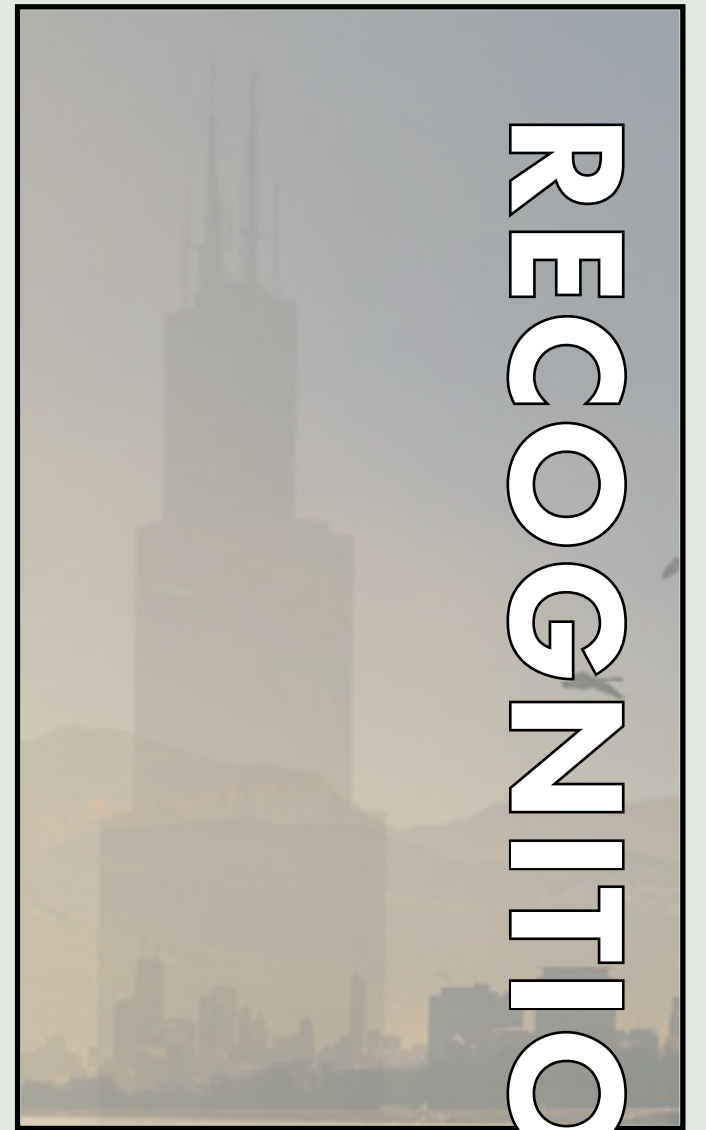

# RECOGNITION

ABOUT THE AUTHOR 22

REFERENCES 23



# LOCATION

VICINITY MAP

LOCATION MAP

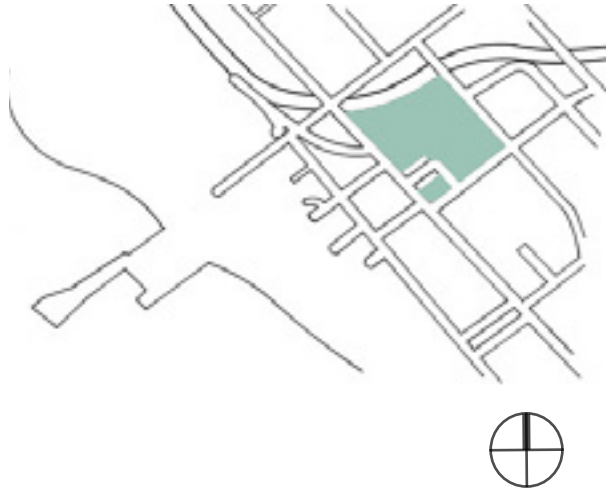

CONTEXT MAP

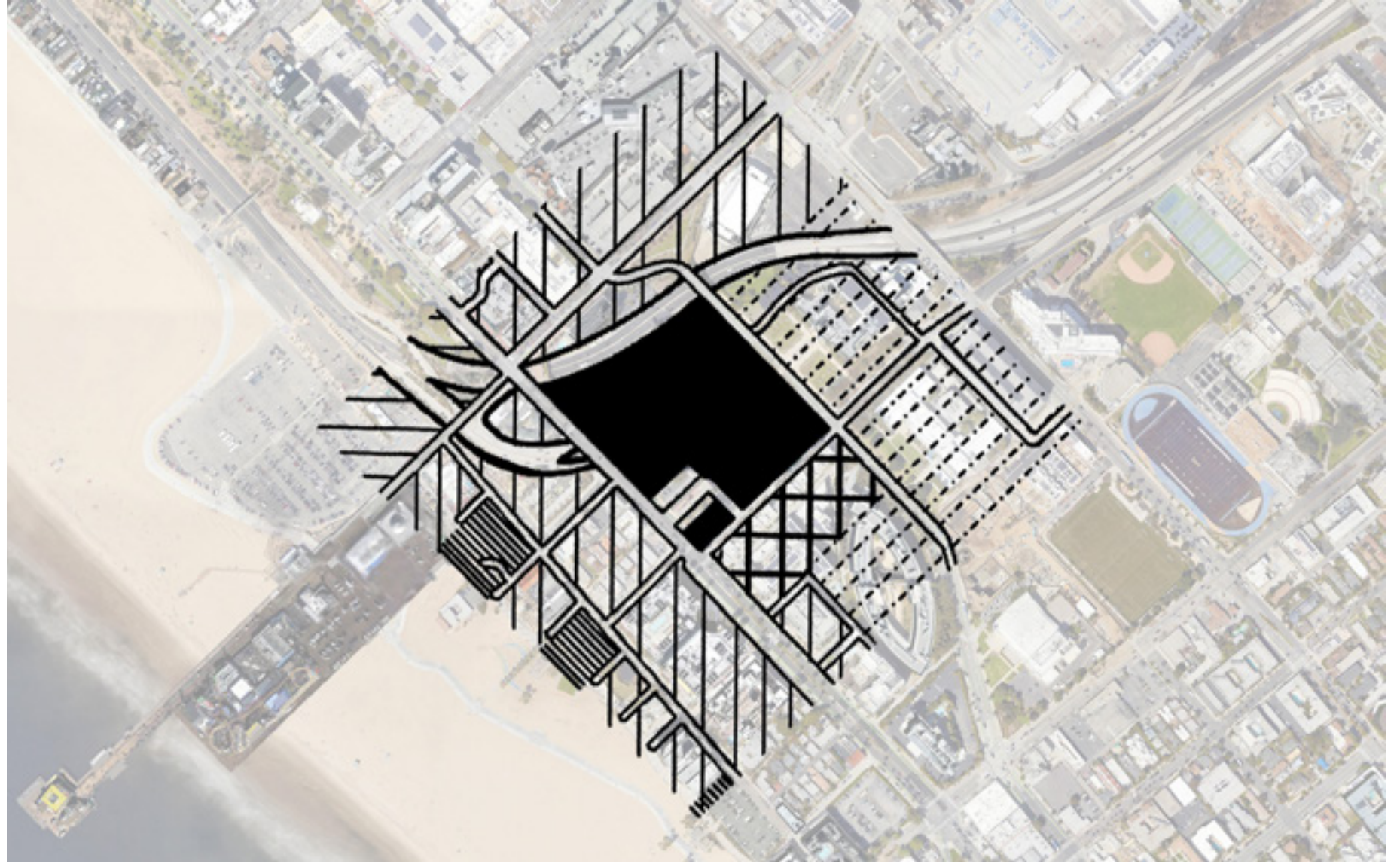

LEGEND

COMMERCIAL

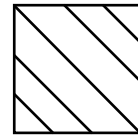

RESIDENTIAL

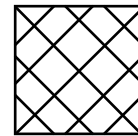

PARKING

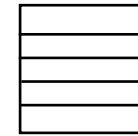

MUNICIPAL

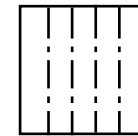

PUBLIC

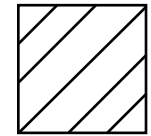

Situated on 7.4 acres between City Hall, the Interstate-10 freeway, and Santa Monica's iconic palm tree lined Ocean Avenue, Tongva Park + Ken Genser Square have transformed a derelict and flat parking lot into lush landscape of rolling hills, swales, Mediterranean meadow gardens, and active urban spaces.



OCEAN ENTRANCE



OLYMPIC ENTRANCE

PRIMARY

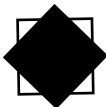

SECONDARY

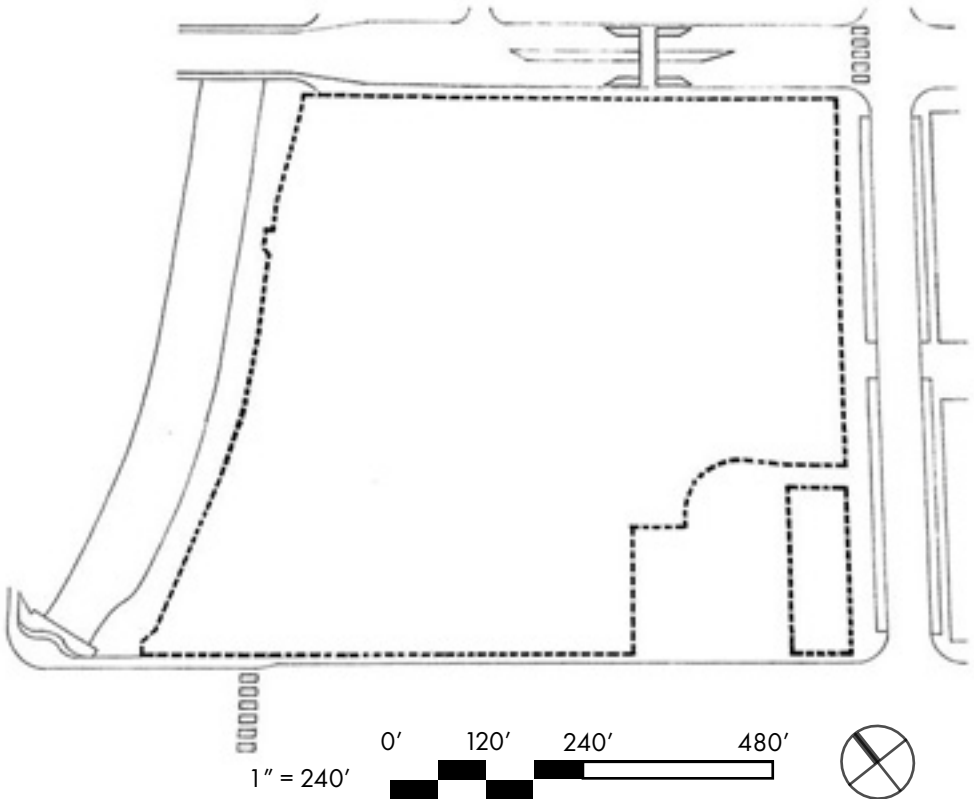
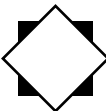

LIMIT OF WORK

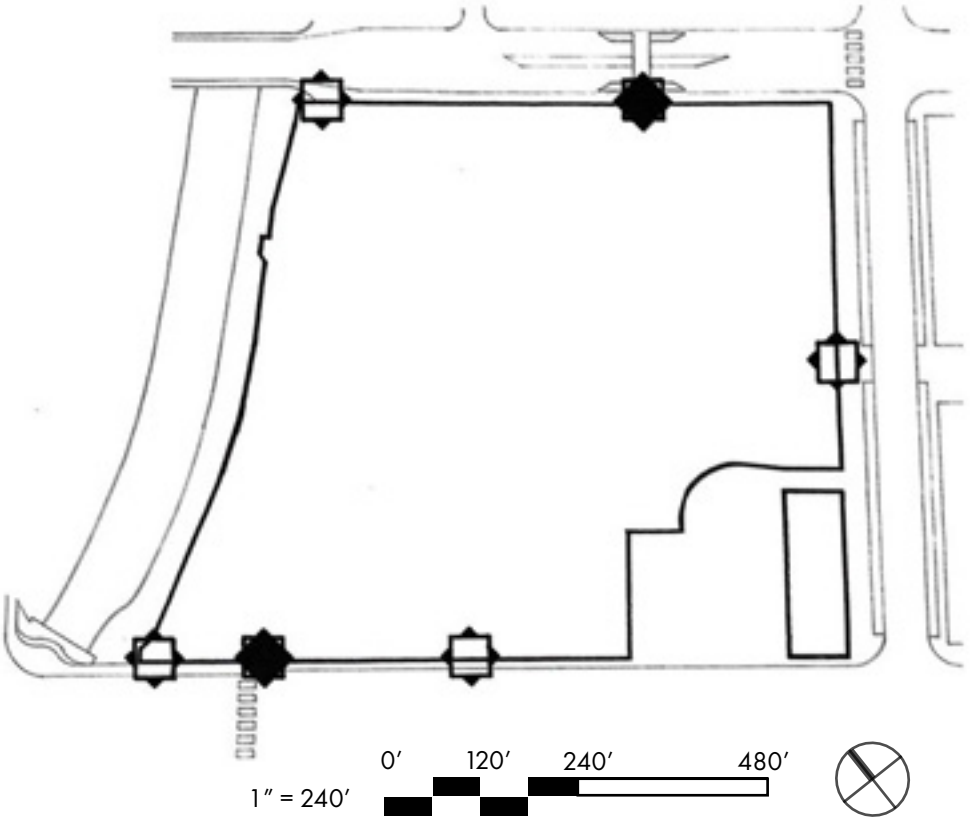

ACCESS POINTS



# SITE CONDITIONS

## PAVING MATERIALS

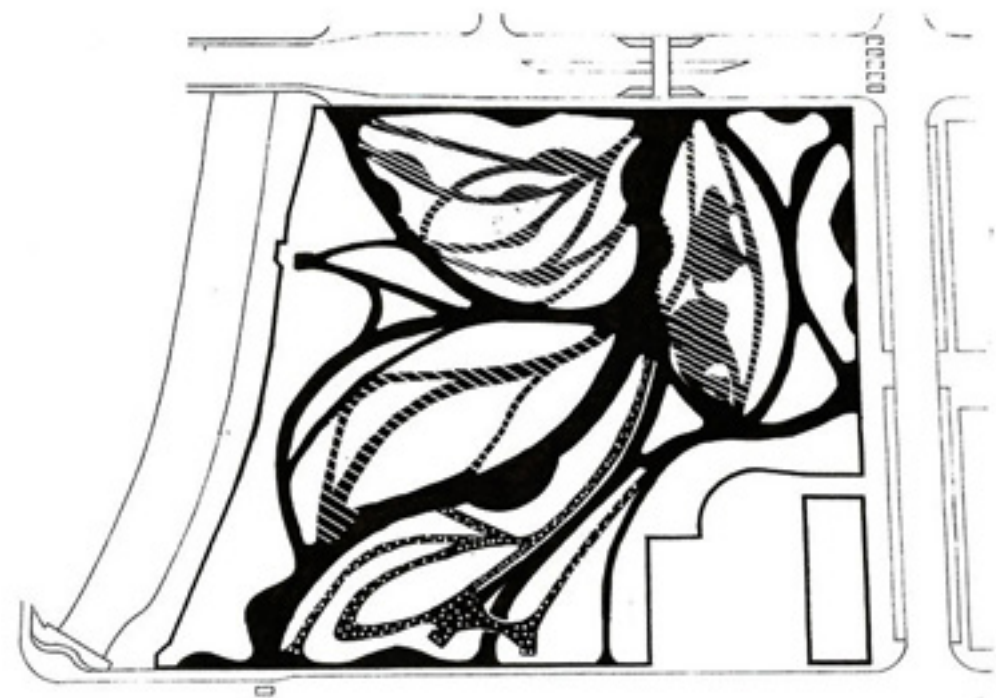

SMOOTH CONCRETE



LARGE AGGREGATE

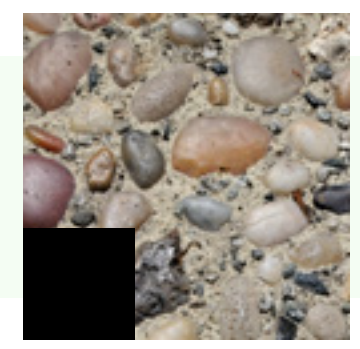

SMALL AGGREGATE



## CIRCULATION

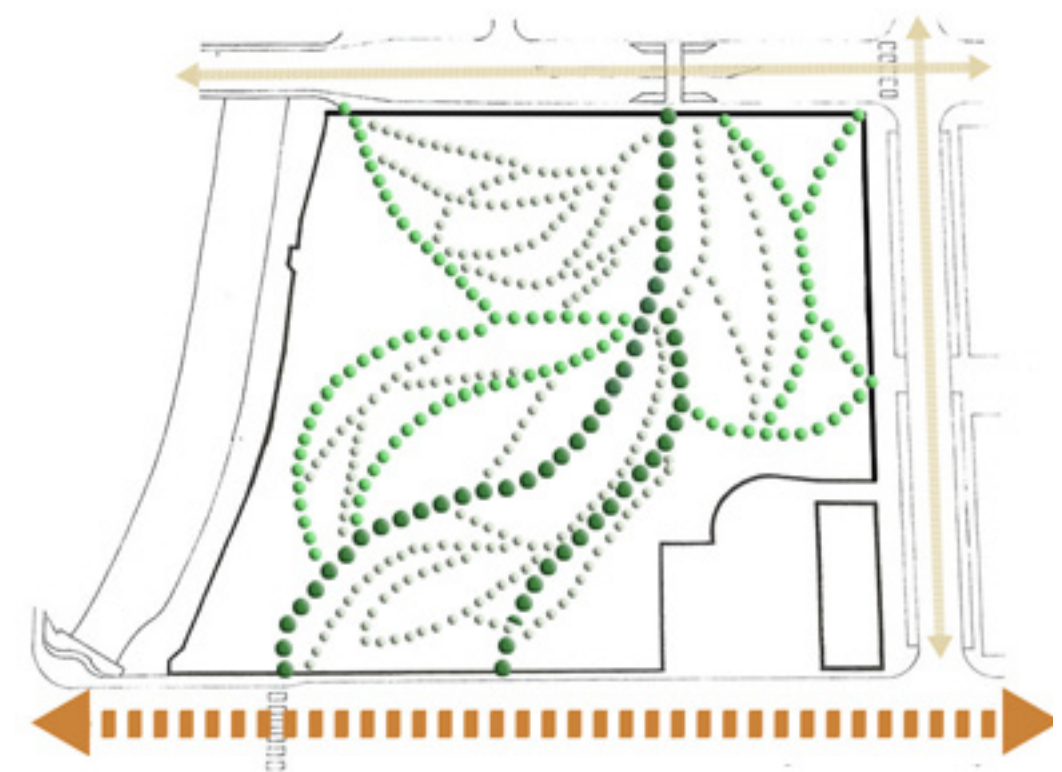

### PEDESTRIAN

- PRIMARY
- SECONDARY
- TERTIARY

### VEHICLE

- PRIMARY
- SECONDARY

## GATHERING HILL PATHWAYS



## OCEAN AVE.





# CONCEPT DIAGRAM

TREE CANOPY



CONCEPT DIAGRAM

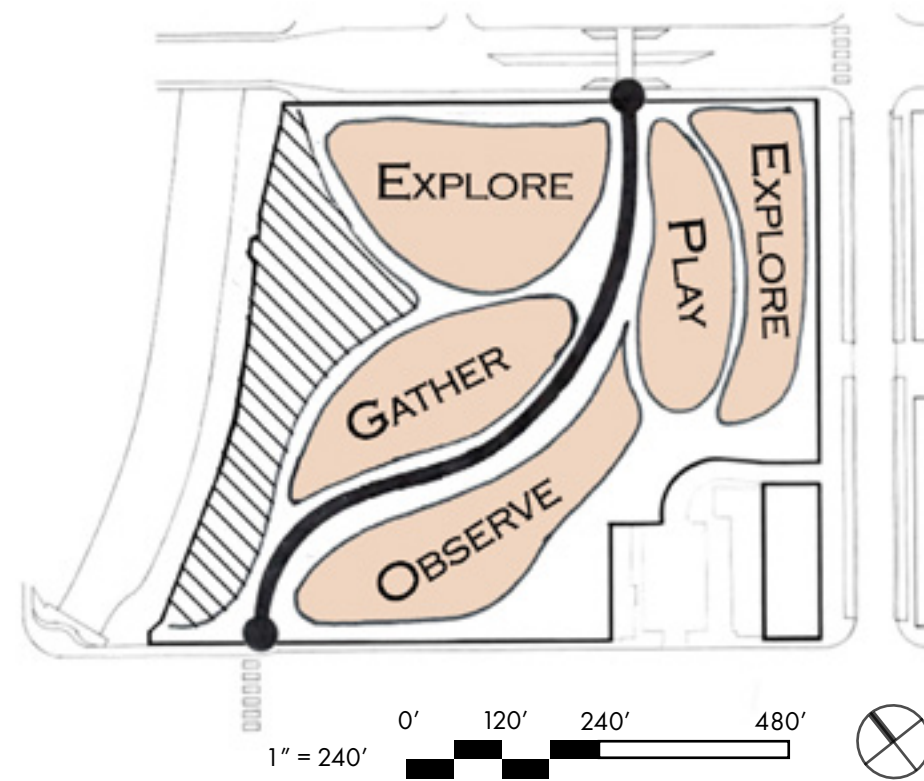

FICUS GROVE

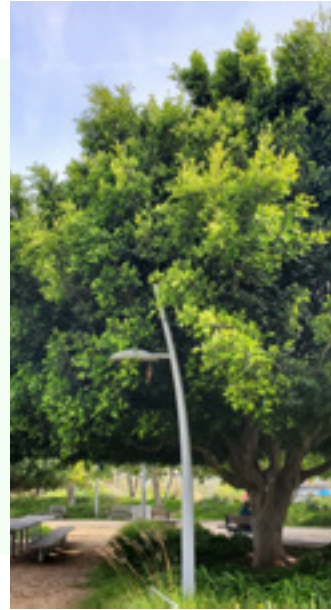

PALMS

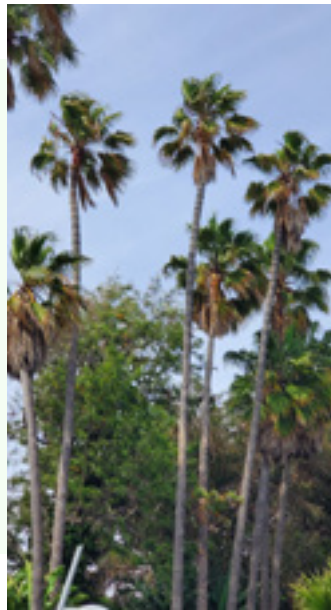

PINE



OBSERVE

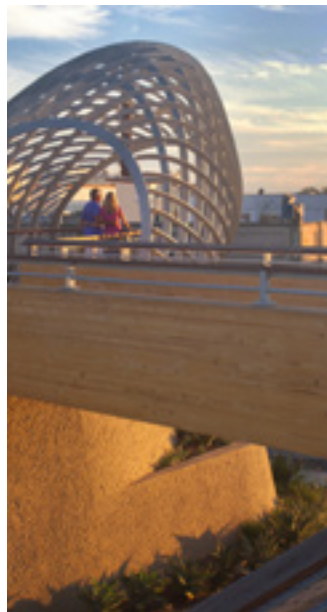

GATHER



PLAY



EXPLORE





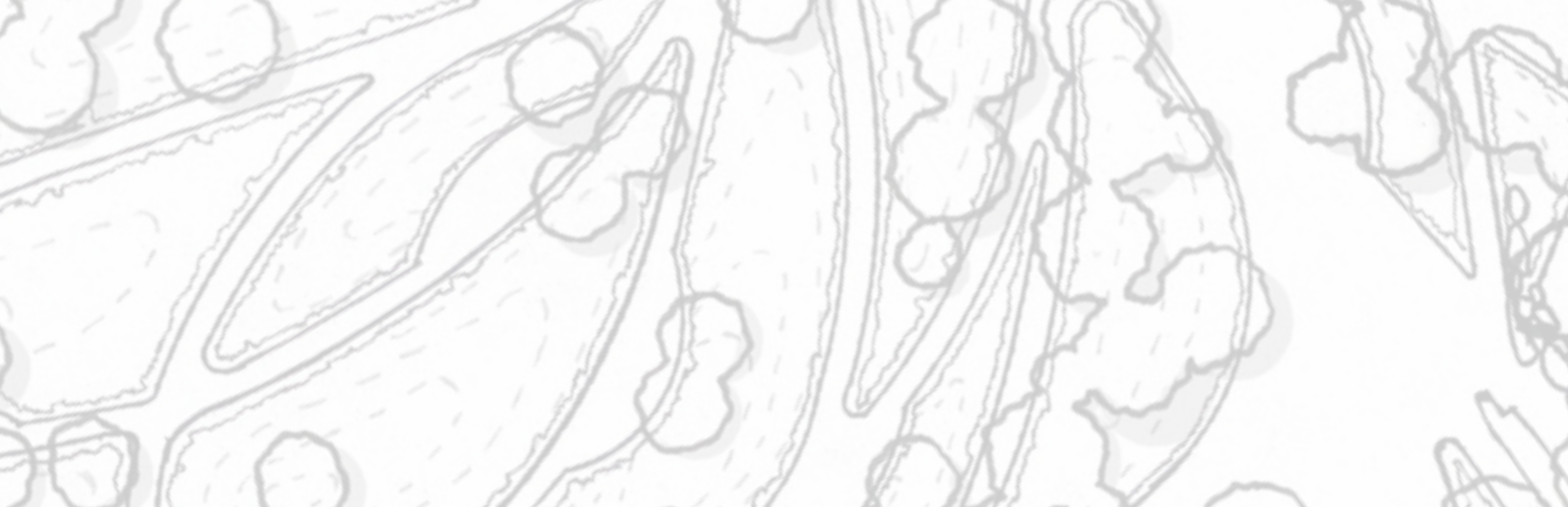







# PERSPECTIVES

GARDEN HILL PATH

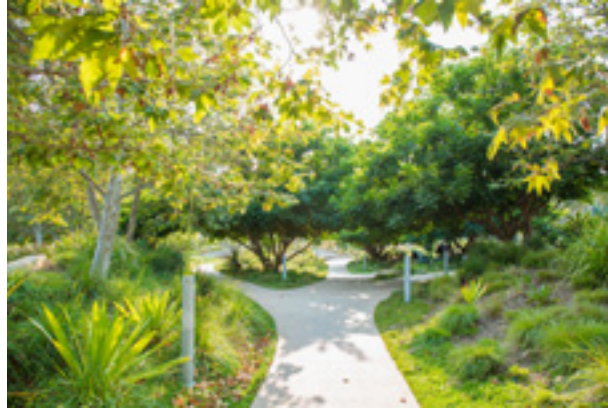

GARDEN HILL SEATING



NE VIEW OF FOUNTAIN



SW VIEW IN GARDEN HILL



P  
3

SE VIEW SEATING AREA



P  
2

NE VIEW OF FOUNTAIN



P  
1

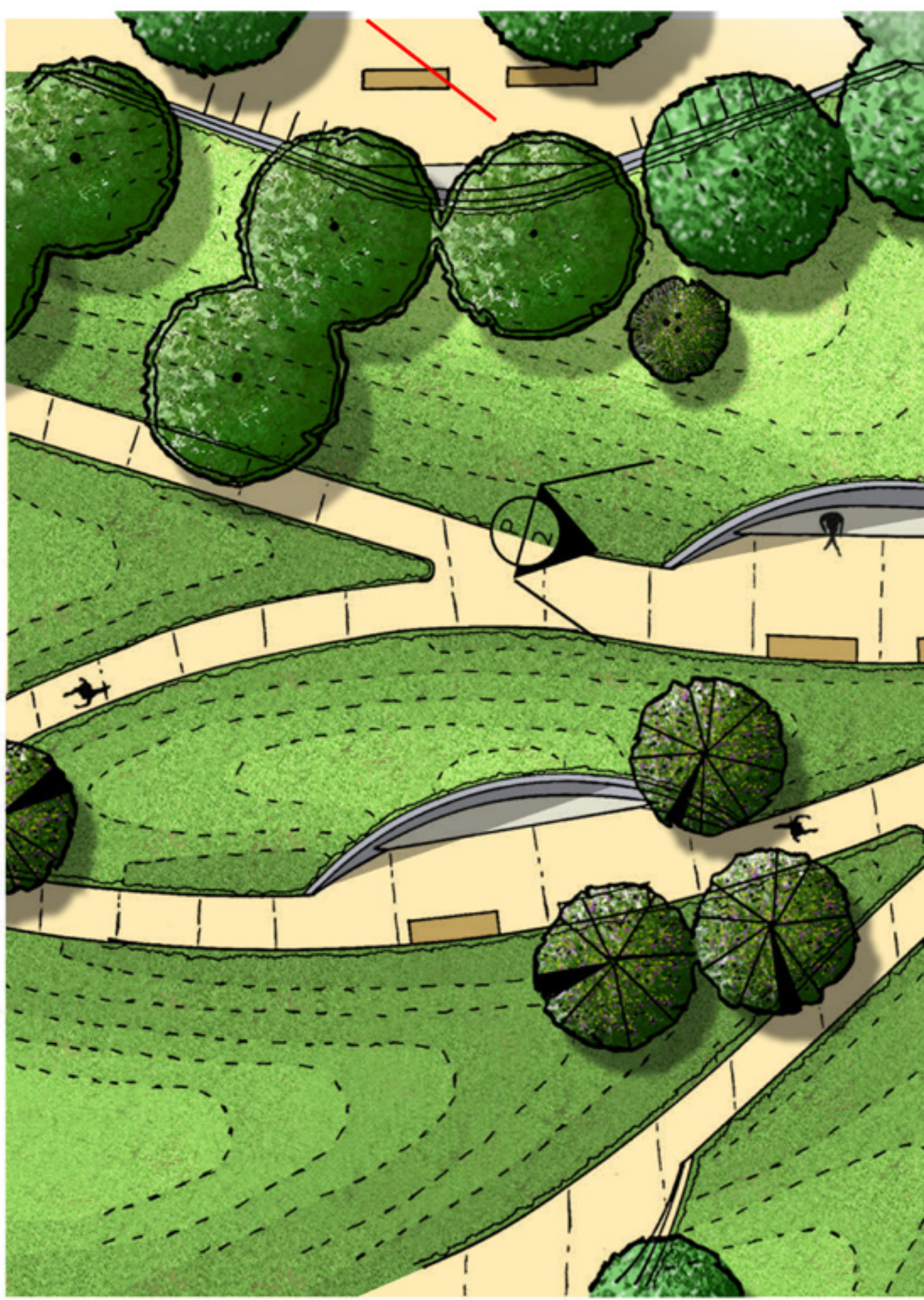



SECTION ELEVATION



KEY MAP

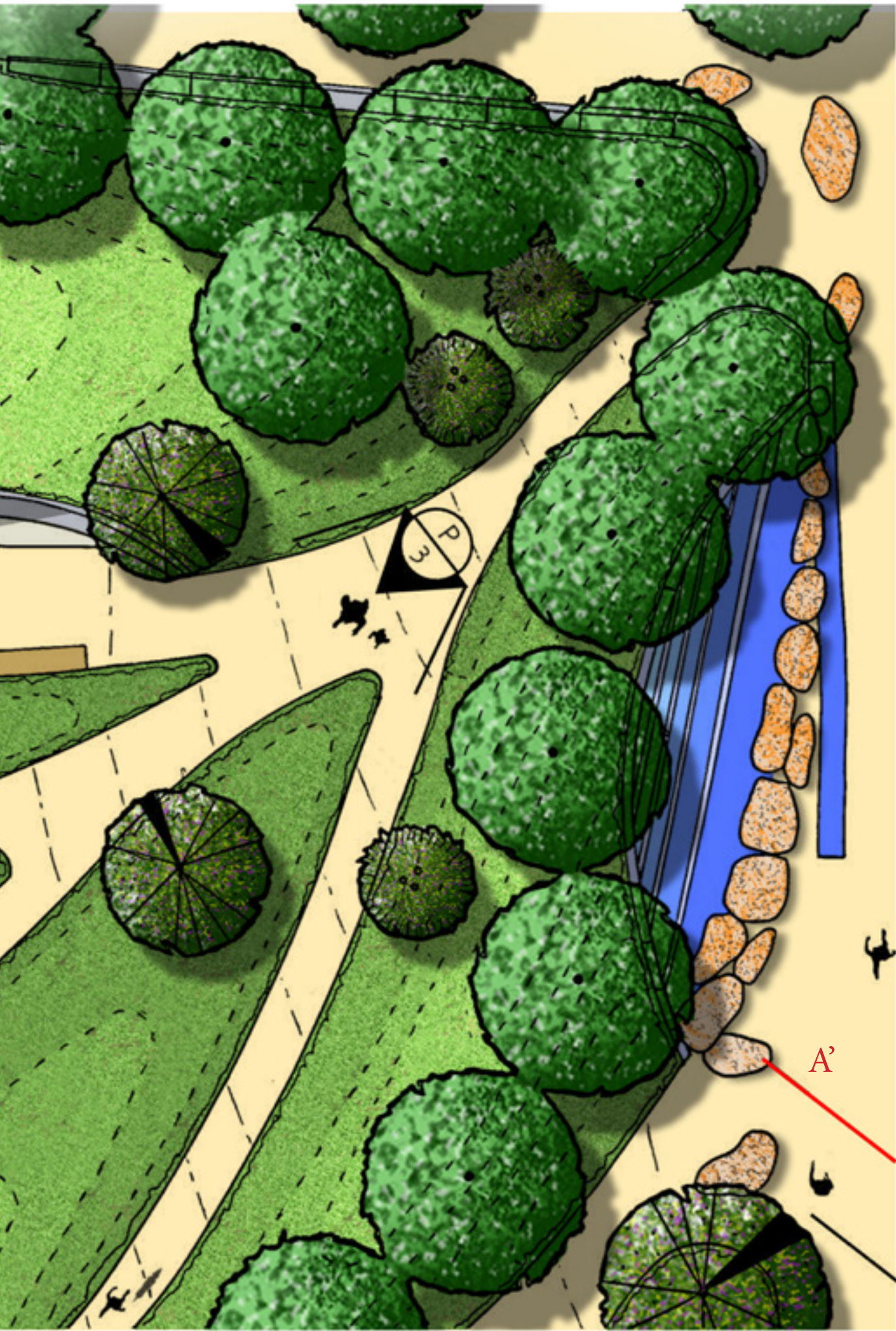
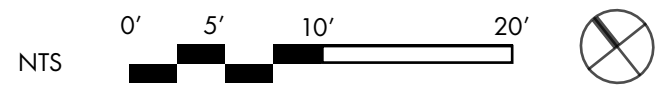







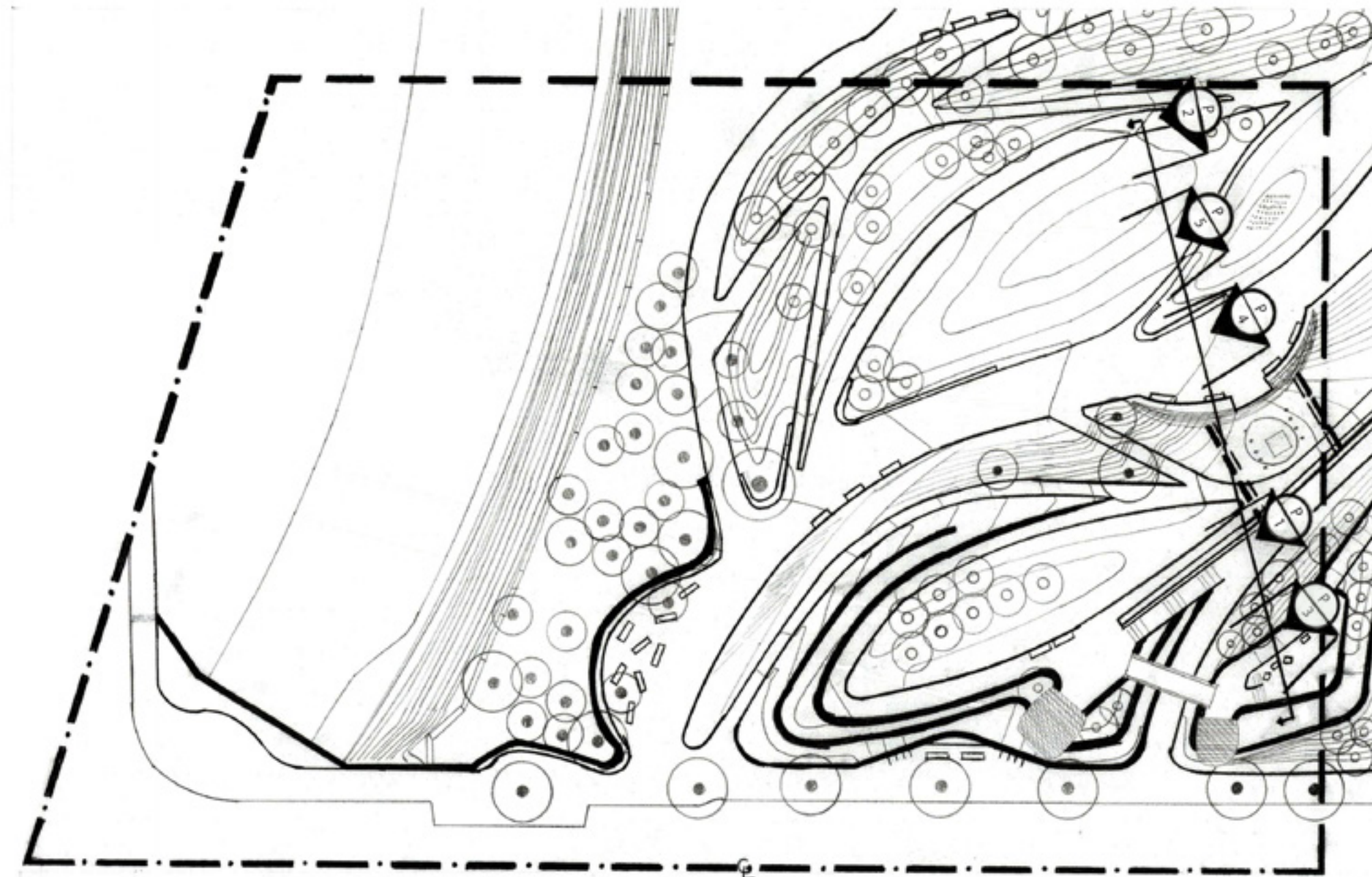

- STUDY BOUNDARY
- MATCH LINE
- PEDESTRIAN CIRCULATION
- VEHICLE CIRCULATION
- BUILDING

- TREE
- PALM TREE
- CONTOUR LINE = 1'

1" = 60'

0' 30' 60' 120'



AMPHITHEATER



PLAY AREA VIEW



RESTROOM AREA



OVERHEAD BRIDGE



# PERSPECTIVE



OCEAN AVE. OVERLOOK



SECTION ELEVATION

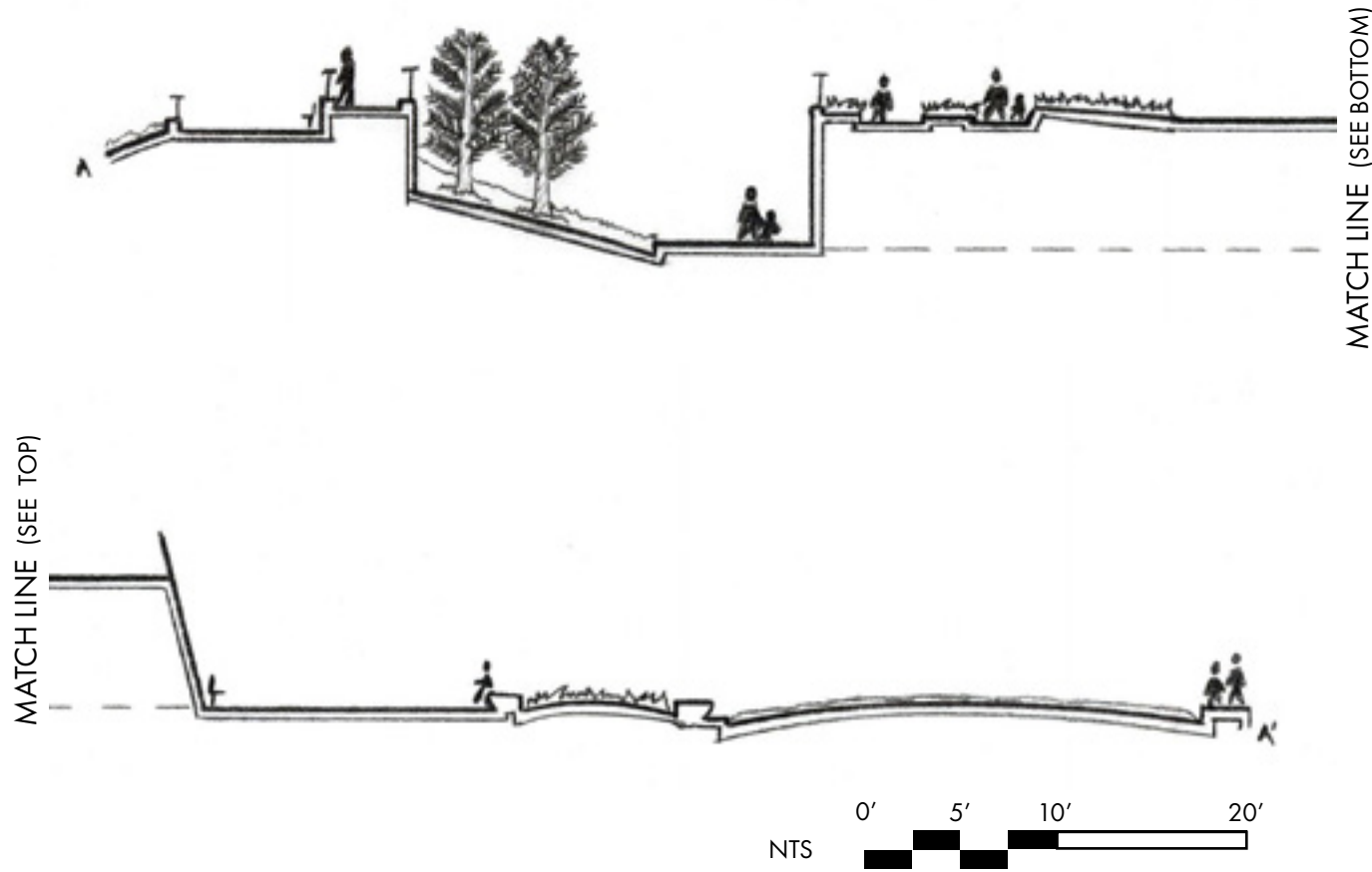

KEY MAP

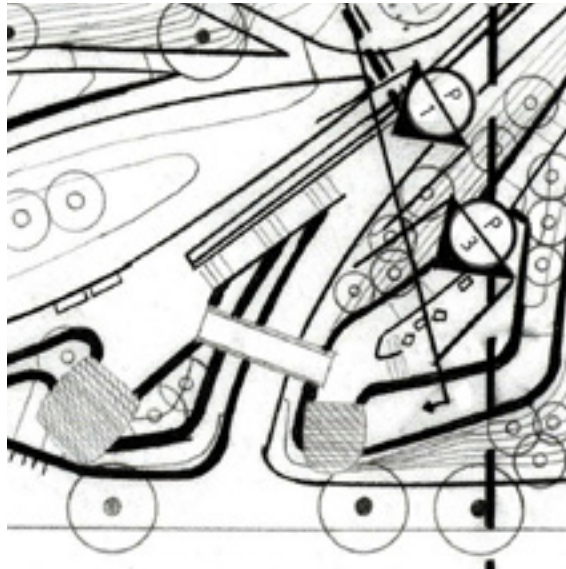



Observation Hill offers the best views of the ocean and neighboring vicinity culminating in two distinctive shell-like overlooks that frame iconic views and vistas of Santa Monica and the ocean. It reaches a height of 18', creating a dramatic platform from which to take in views of the ocean and pier. It dually serves to buffer noise from Ocean Avenue, creating an amazingly quire park interior.

The overlooks fabricated from plasma cut plates create a contemporary and striking park edge. They act as beacons for the park, enticing passersby to enter the site.

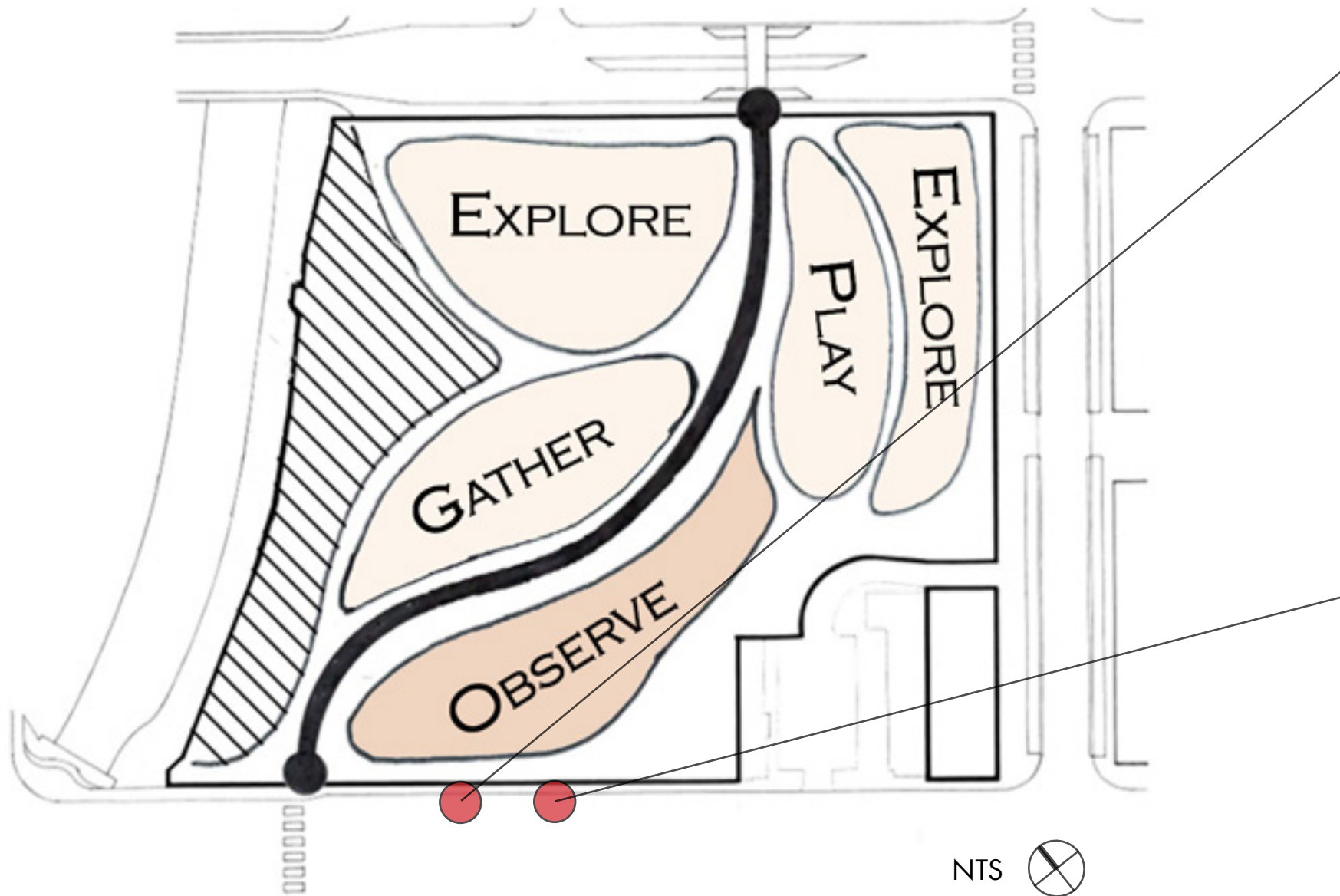

PIER OVERLOOK



OCEAN OVERLOOK



PALM AND CYAD MIX



MEADOW HIGHLIGHTS



PERIMETER MIX



DRY MEADOW

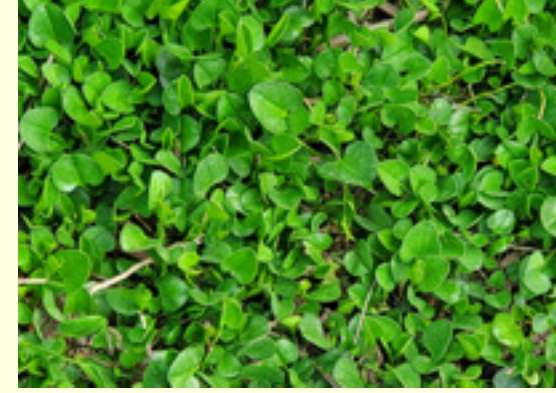



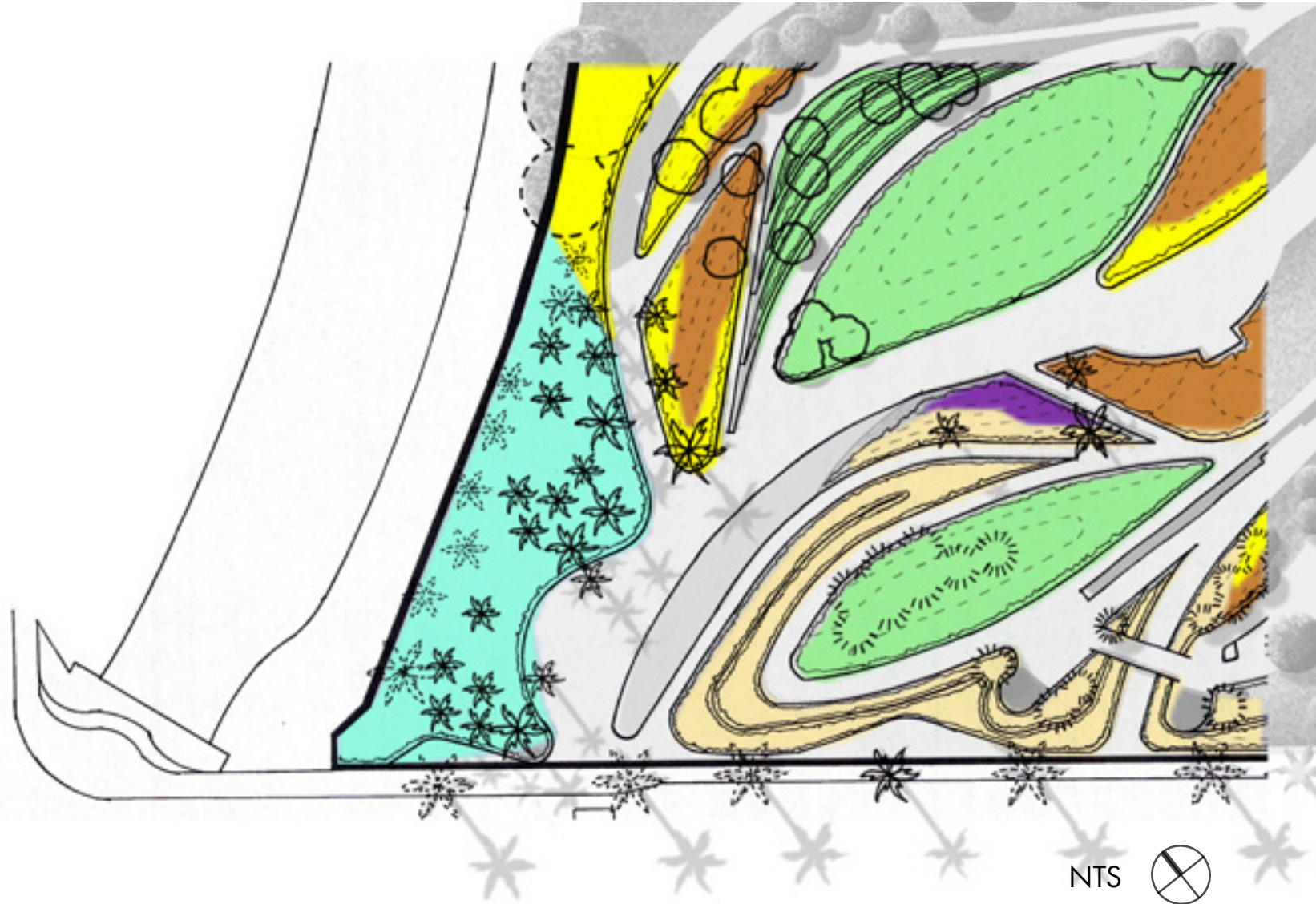

Over three hundred carefully selected new trees, thousands of new plants, and hundreds of California native and appropriately adapted species are part of the ambitious planting scheme.

As such, it is one of the first large-scale contemporary urban projects to highlight California native plants as significant horticultural features, and was a trailblazer for climate-appropriate water use in the public realm.

TURF GRASS

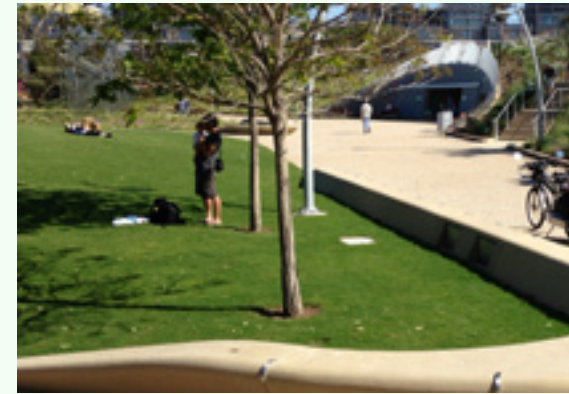

FEATURE GARDEN





# FEATURES / AMENITIES

RESTROOMS



OCEAN AVE ENTRANCE



WEATHER VANE



WATER FEATURE







The design brief for this project was 'to construct a park and "garden walk" that reflected the identity of the city and created a destination and gathering place of great social, ecological, and symbolic value.' Shaped by extensive community participation, the design of this project creates a contemporary, sustainable, and transformative urban landscape that redefines the center of Santa Monica, establishes a system of linked central parks, re-knits the city fabric through strong linkages to Downtown, the adjacent neighborhoods, the Santa Monica State Beach, Palisades Park, and the Main Street commercial area, and mitigates the barrier created by the Santa Monica Freeway.









**Robert Hancock** is a first year student in UCLA's Landscape Architecture program. A graduate from University of Illinois - Chicago, with a Bachelors in Finance, Robert has been working as a marketing consultant in the automotive industry for the past thirteen years, eleven of them while residing in the greater Los Angeles area.

He spends his free time producing music, playing board games, and attending live music events as much as possible.

With his extensive experience managing client relationships, he hopes that at the end of this program, he will have acquired the tools needed to transition into a more fulfilling career in Landscape Design.





- Aerial Shot of Tongva Park, <https://www.santamonica.gov/places/parks/tongva-park>, page 2
- Tongva Park and Ken Genser Square, Text excerpts, [www.asla.org/2018awards/455654-Tongva\\_Park\\_And\\_Ken\\_Genser](http://www.asla.org/2018awards/455654-Tongva_Park_And_Ken_Genser), Page, 16, 18, 20.
- Gathering Hill, Photo Credit: Angie Smith, page 8
- Observation Hill, Photo Credit: Tim Street Porter, page 13
- Public Restroom, Photo Credit: Tim Street Porter, page 19
- Tongva at Night, Photo Credit: Tim Street Porter, page 21





*"A NATION THAT DESTROYS ITS SOILS DESTROYS ITSELF. FORESTS ARE THE LUNGS OF OUR LAND, PURIFYING THE AIR AND GIVING FRESH STRENGTH TO OUR PEOPLE."*

*FRANKLIN D. ROOSEVELT*

