

# MARCH FIELD AIR MUSEUM - A DESTINATION FOR THE FUTURE

## UCLA EXTENSION LANDSCAPE DESIGN STUDIO 7

### LILIA PHARAZYN

#### project statement

design a conceptual master plan for the march field air museum. the site has a rich history and impressive collection of aircrafts and aviation related artifacts, however the current site design detracts from the visitor experience. this project will use landscape architecture to as a tool to strengthen site identity and enhance the user experience.

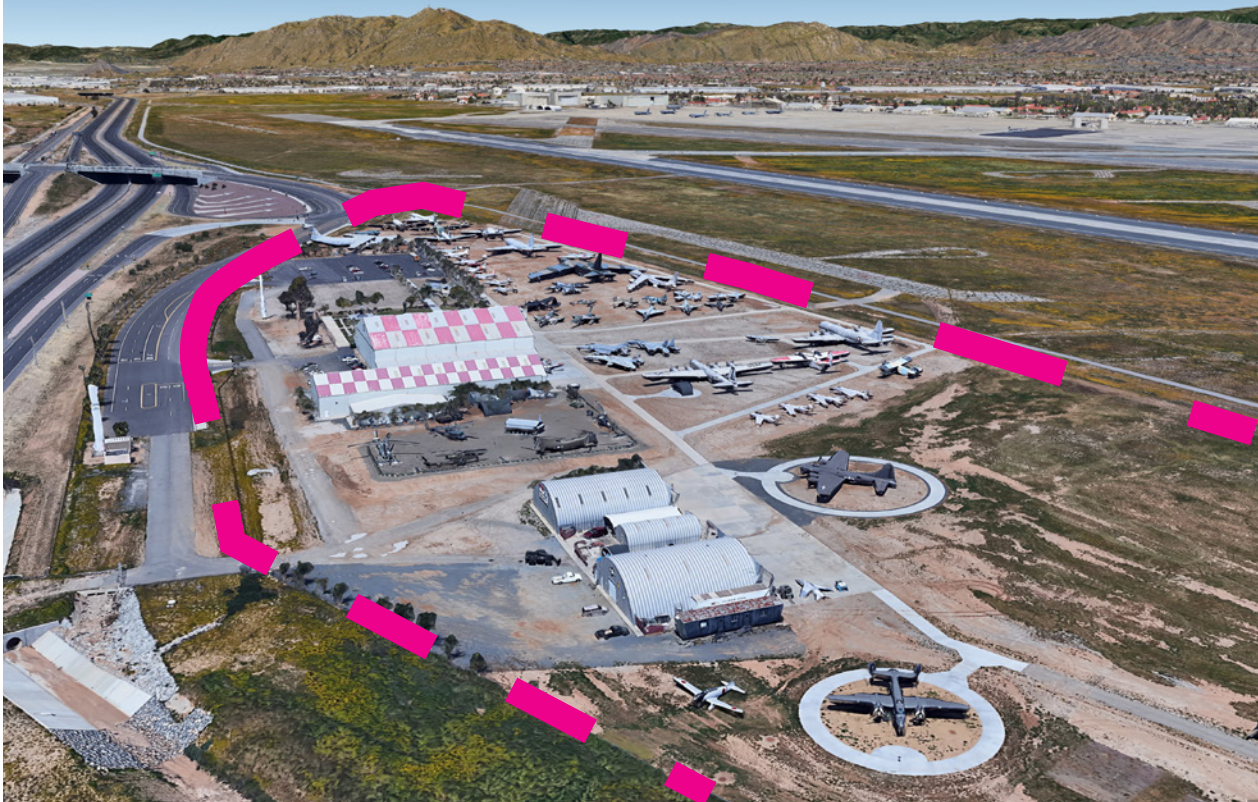

#### goals

- create a **memorable entrance** and first impression
- **reimagine the memorial garden** and increase it's usability
- **enhance the experience** for visitors while viewing the airplanes **on the field**
- develop a **network of connectivity** that takes into account the different modes used on site (pedestrian, car, tram, plane)
- increase museum awareness and **attendance levels**

#### program

- **create an entry** to the museum that reflects the site's identity
- update and **expand courtyard and memorial garden**
- improve **layout** in outdoor exhibit area
- enhance visitor experience by providing **shade** and **gardens**
- create two **firebase** exhibits
- increase the museum's visibility **from the freeway and street**
- design **flexible gathering spaces** that can be used day-to-day for recreation and for hosting large events
- maintain the amount of **parking** and overflow parking
- utilize **low-impact development principles** and materials

#### concept development

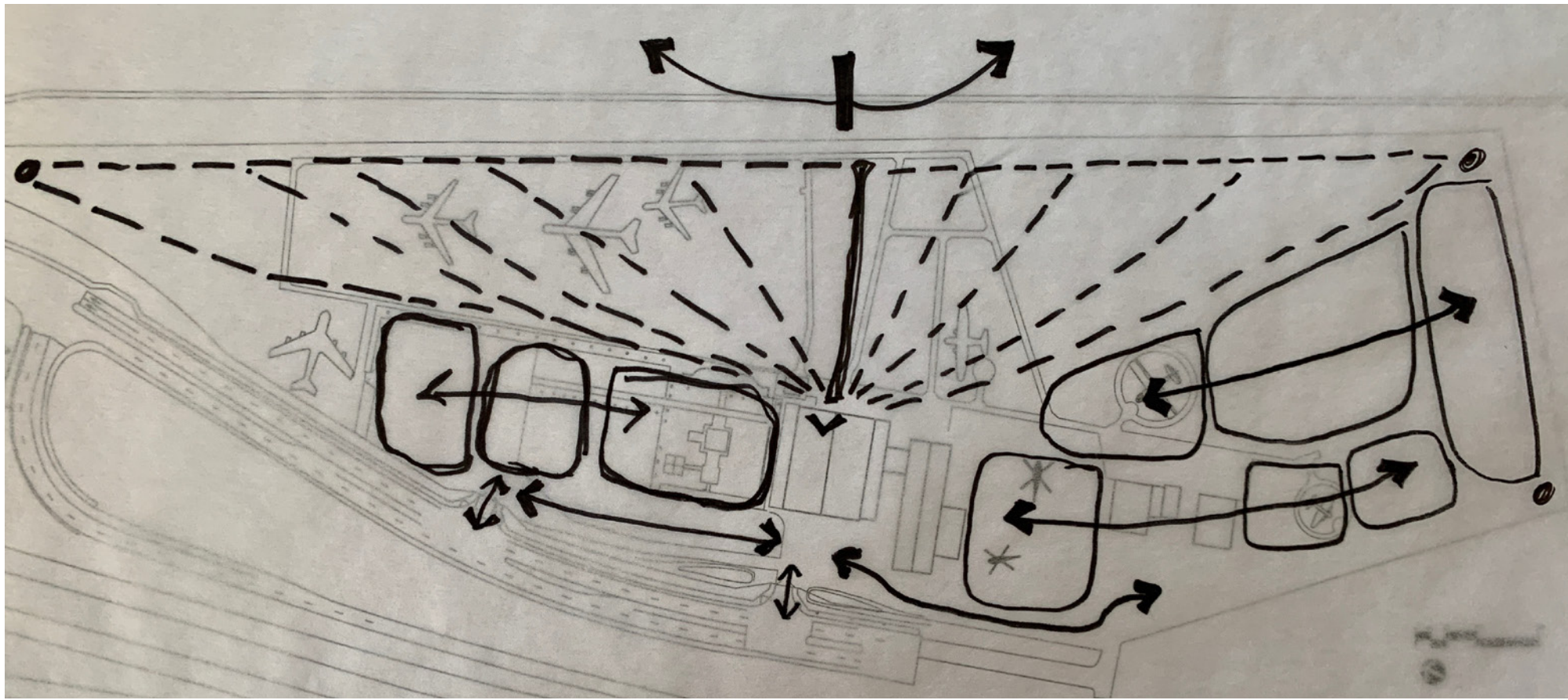
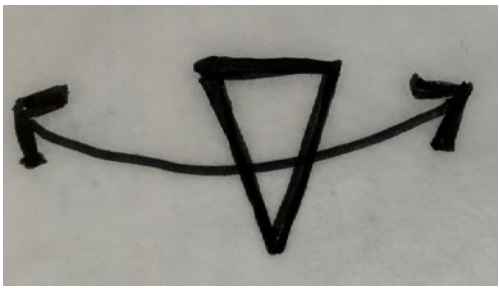

concept diagram 1

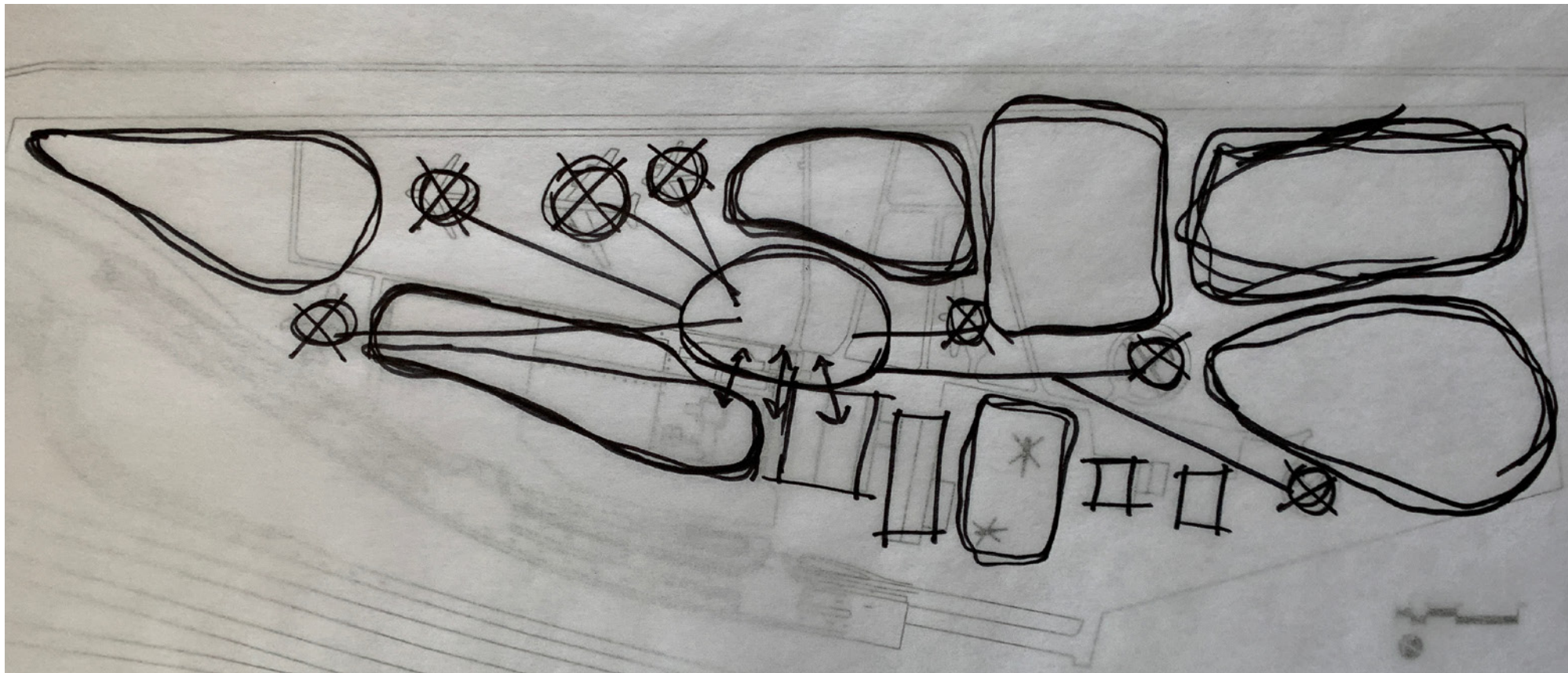
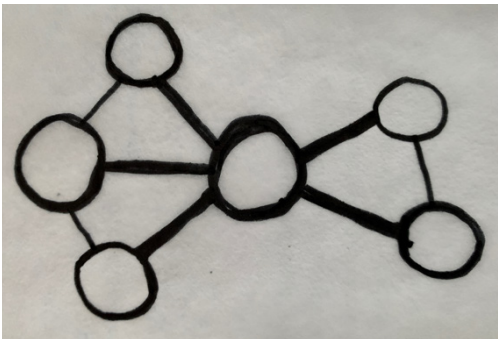

concept diagram 2

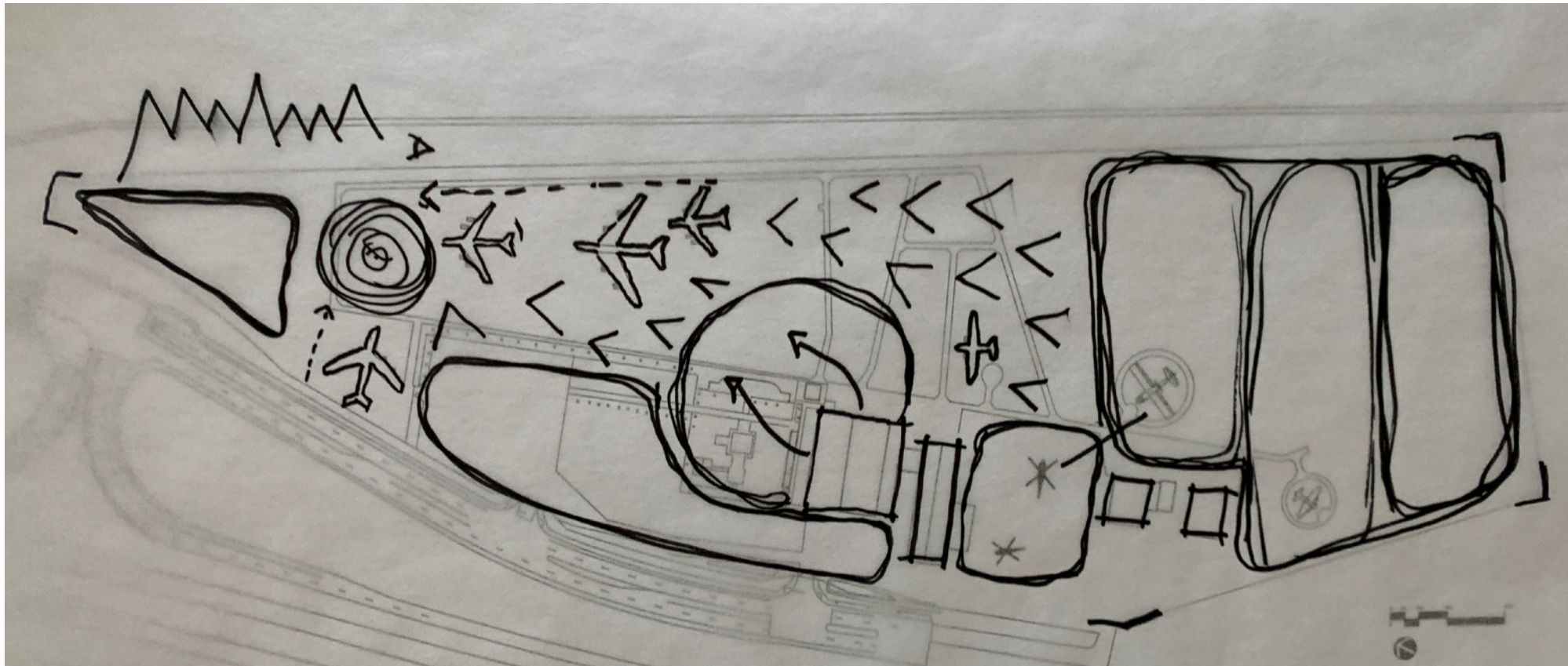
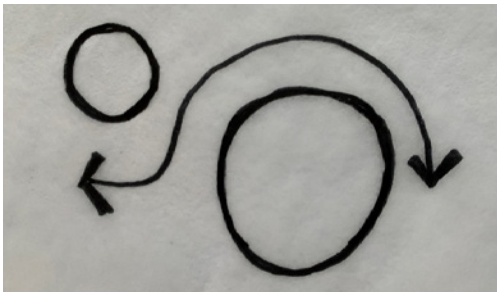

concept diagram 3

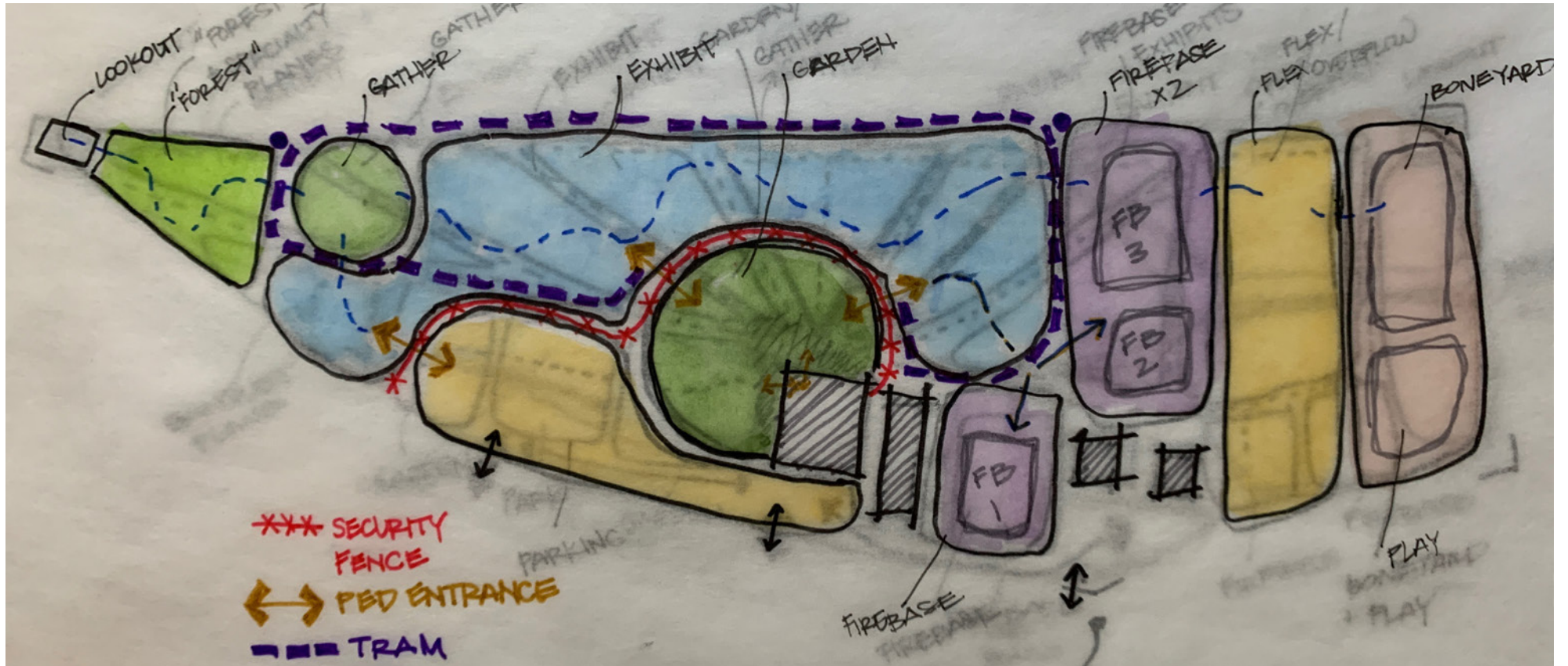
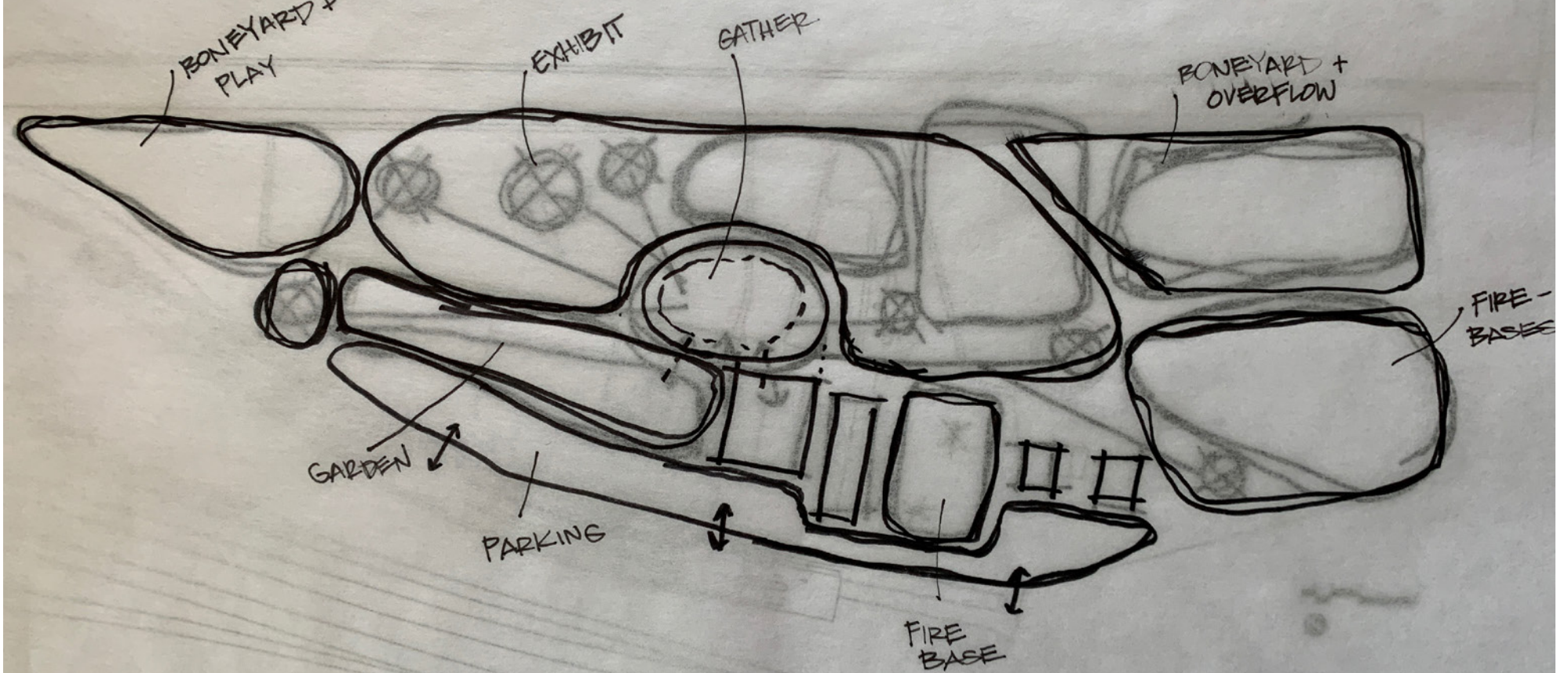
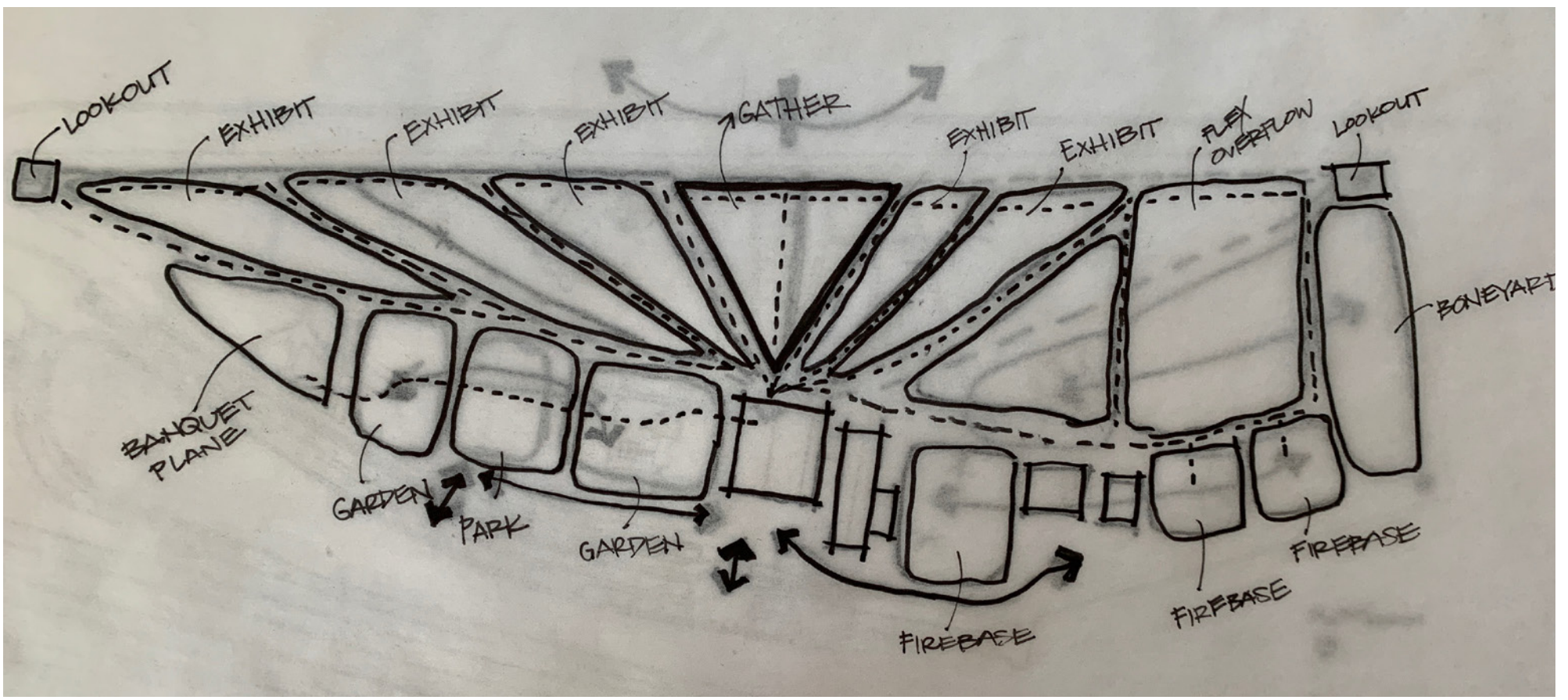



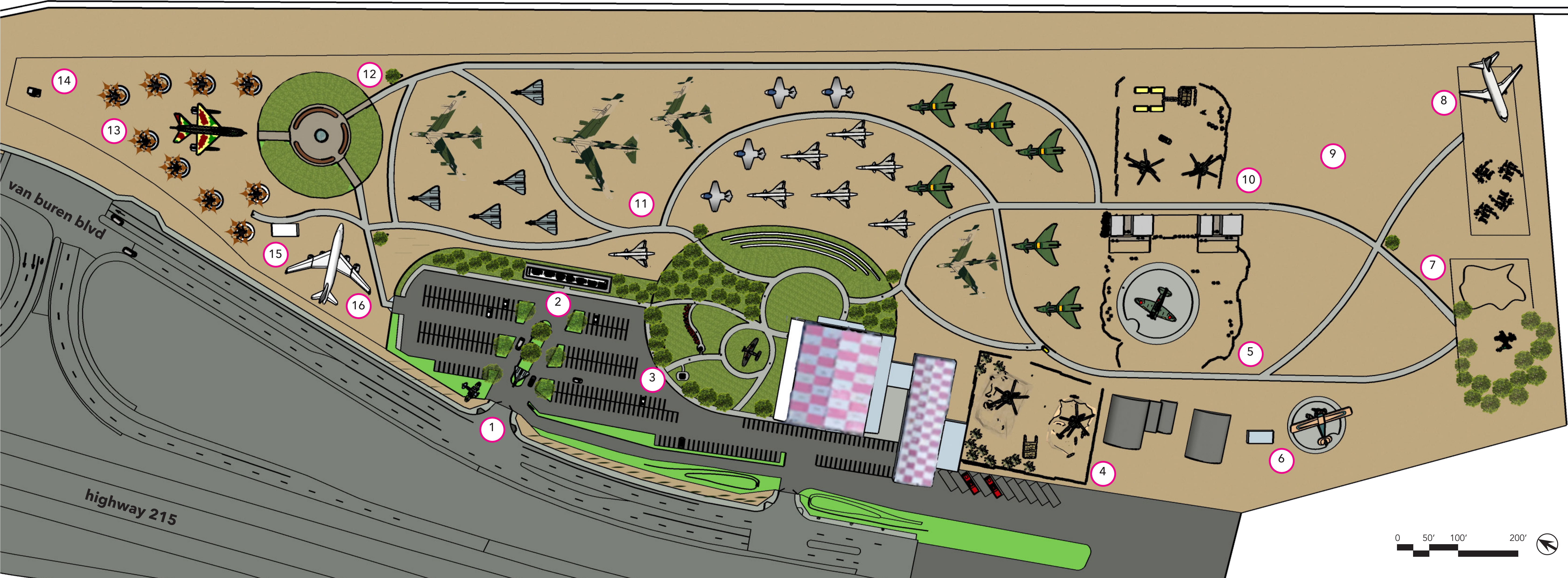

- key**

  - 1. entrance
  - 2. restaurant with rooftop deck
  - 3. courtyard
  - 4. vietnam firebase
- 5. WWII exhibit
  - 6. restrooms
  - 7. playground & sculpture garden
  - 8. boneyard
- 9. overflow parking
  - 10. iraq/afghanistan exhibit
  - 11. air field
  - 12. hap arnold memorial
- 13. mural plane in 'forest'
  - 14. lookout tower
  - 15. restroom
  - 16. c-141 banquet plane



view from van buren blvd into site (key - 13)



entrance into the parking area from van buren blvd with view of restaurant (key - 1)



view from the rooftop deck of restaurant (key - 2)



1. march field courtyard



approach from parking area into the entry courtyard. flat areas can serve as places to picnic, view air shows or for kids to run around. the DFC memorial and war dog statue on either side of the pathway give an increased prominence to these memorials, and the low-

water landscaped mounds add color and texture to the experience. additionally, the mounding in the courtyard creates a sense of journey to the main hangar while also shielding some of the noise from the highway.

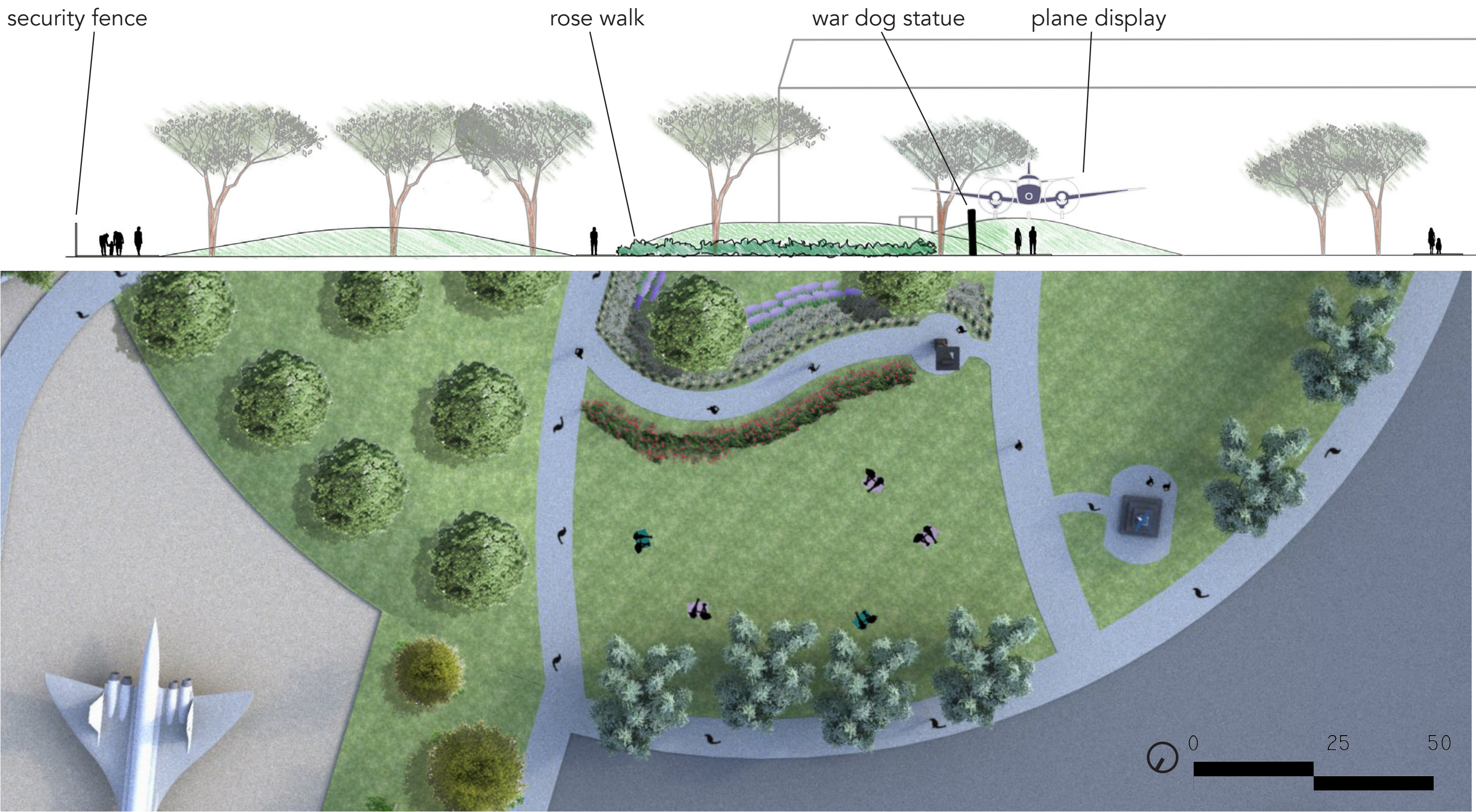

2. courtyard amphitheater



the amphitheater consists of three rows of tiered seating facing the airfield. visitors can sit here to take in the view of the aircrafts. there is enough space in between the amphitheater seating and the planes on the airfield so that if the museum wanted to set up a temporary stage to host events that is possible. between the amphitheater area and the hangar is a flat open space that serves as an extension of the hangar and could

be programmed according to the museum's needs. for example, in the plan view tables and catering stations are set out for an event, but even during regular days this is a good area to put out some movable seating for visitors because it is a shady area of the site due to the orientation of the hangar in the space.

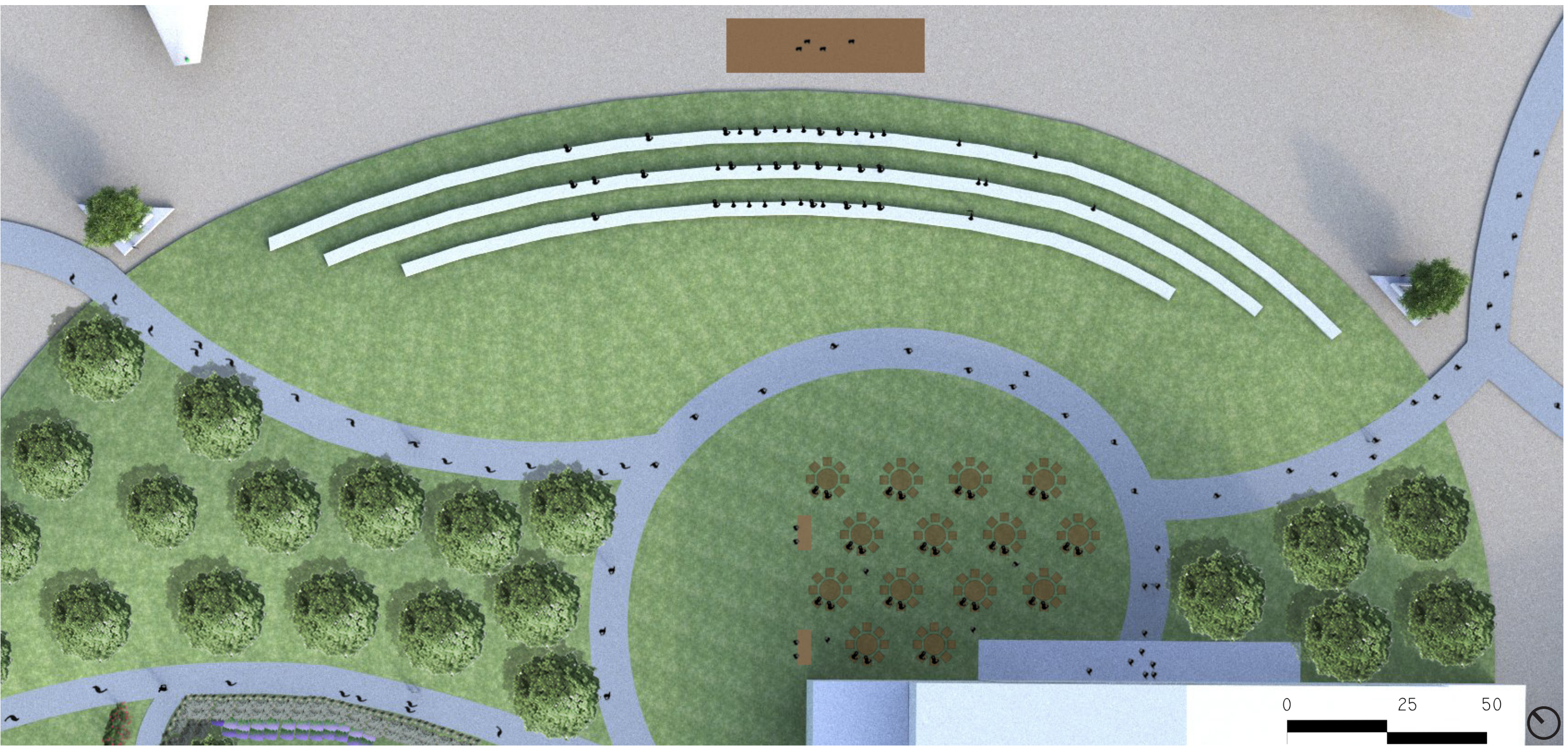

key for enlargements

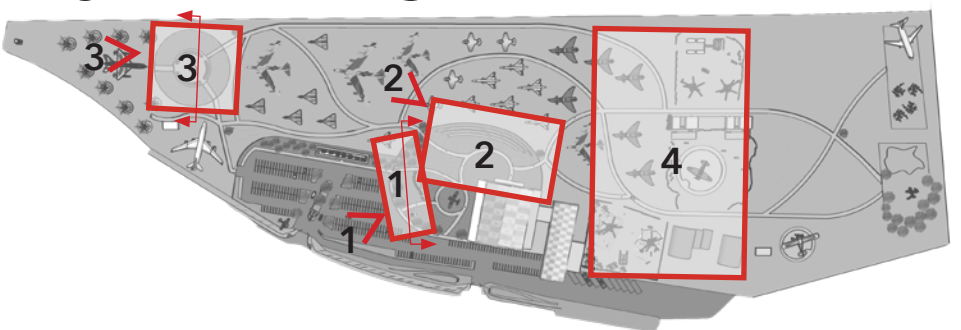



3. hap arnold memorial garden

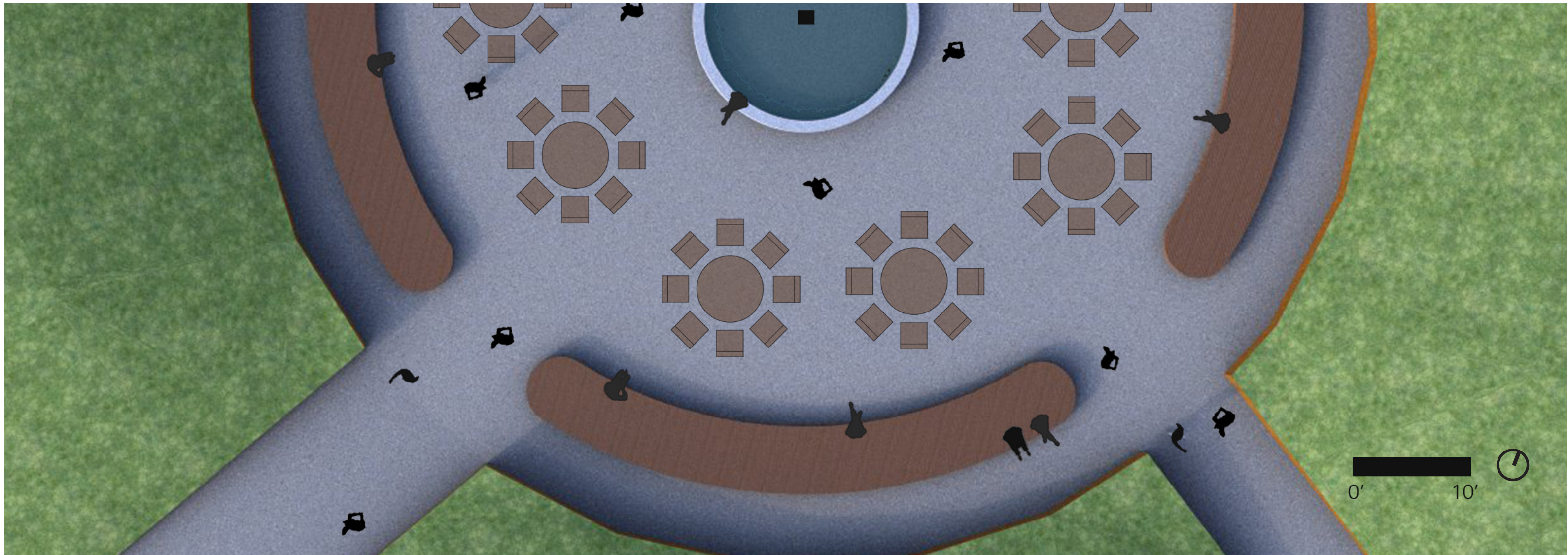
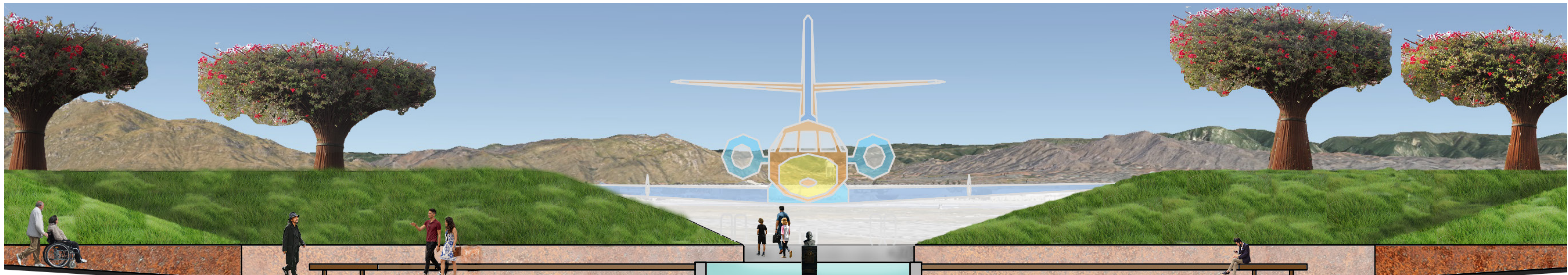
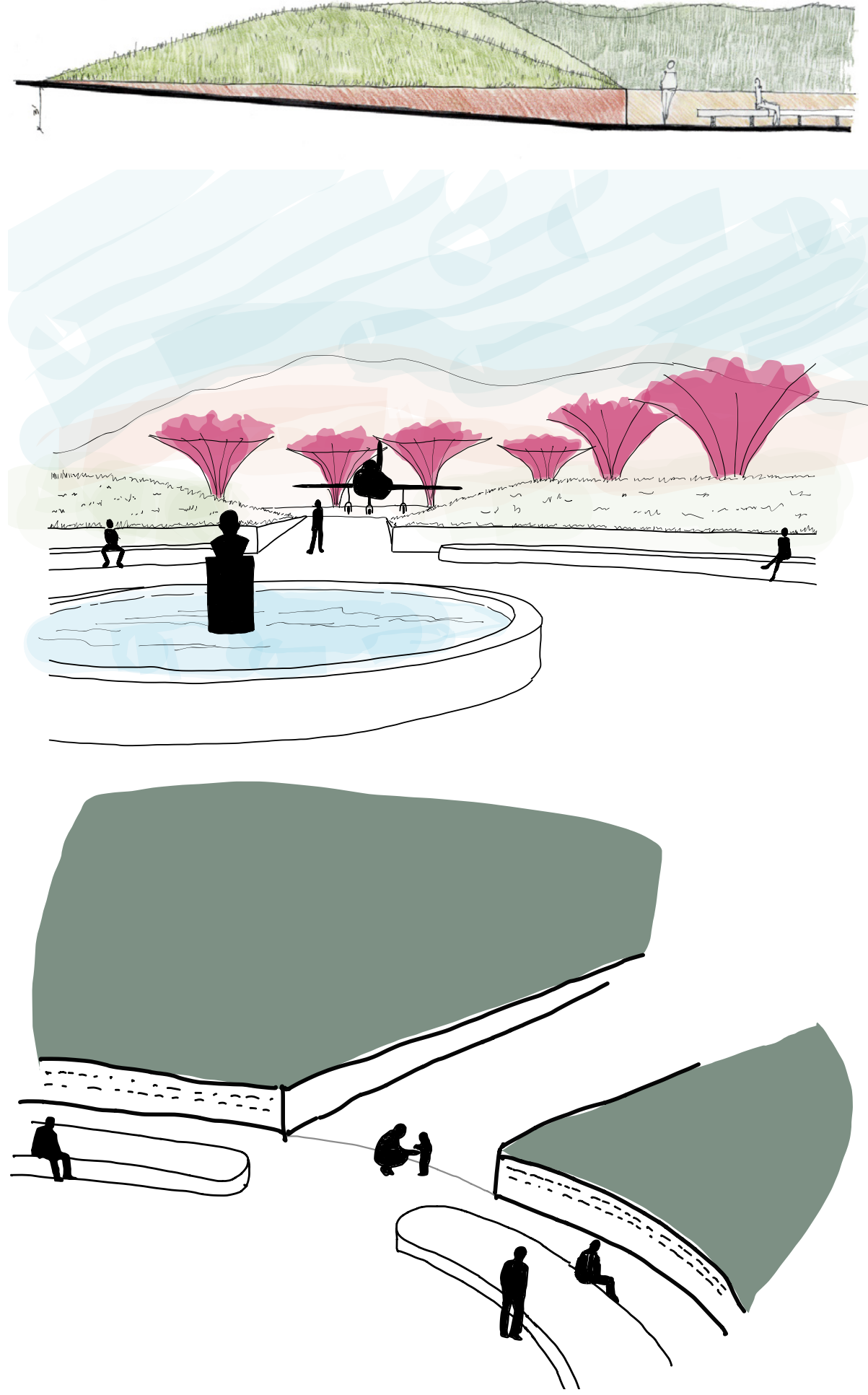

the sunken memorial (3' below the airfield elevation) is a place of enclosure and reflection. the central fountain houses the hap arnold bust and the walls of the grass slopes are inscribed with dedications from donors. the openness of the space creates flexibility and could easily host events for the museum or be rented out.

4. firebase exhibits

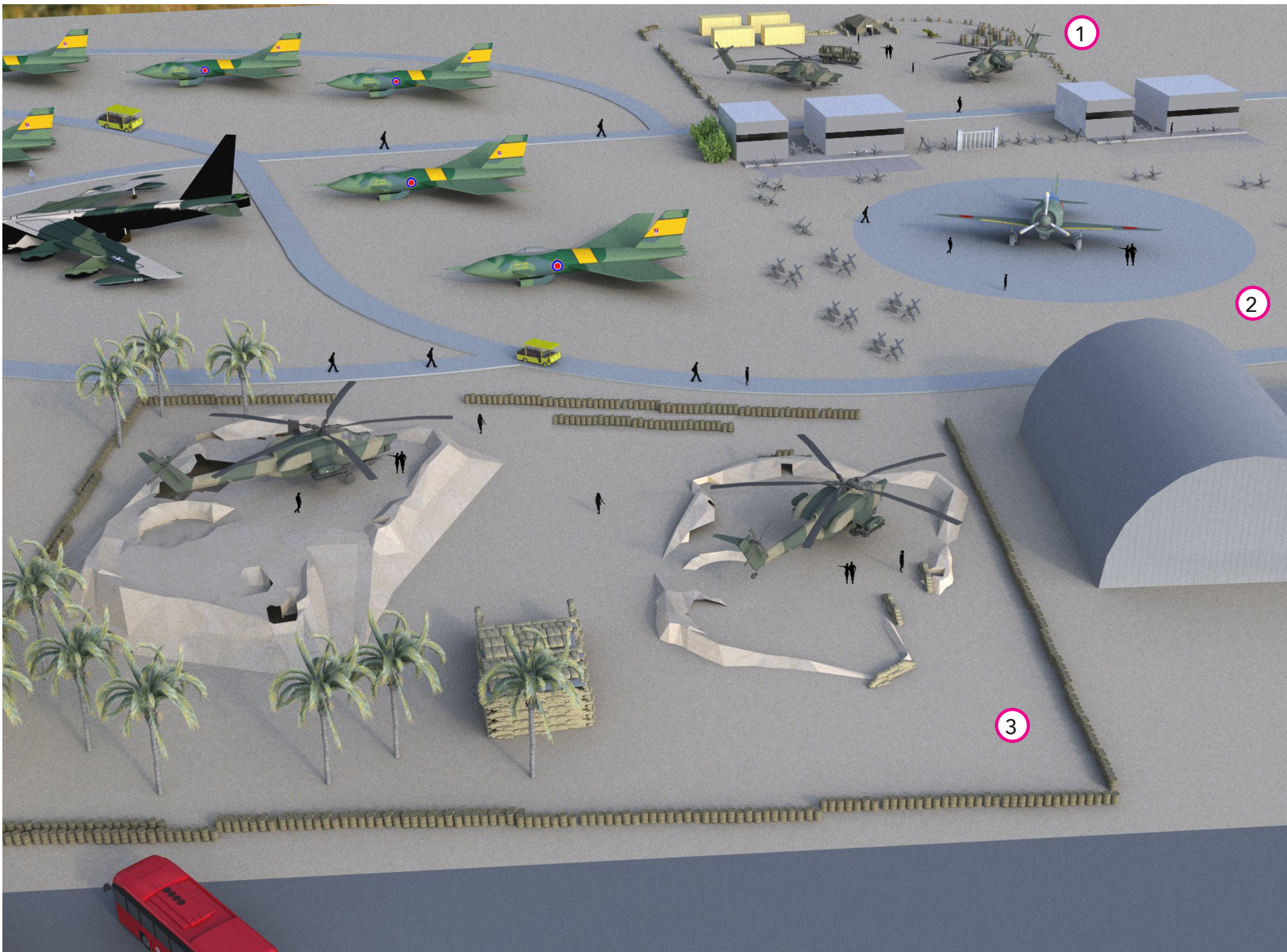

- 1. iraq/ afghanistan firebase - conex containers and tent fortified with sandbags & hesco barriers
- 2. WWII exhibit - bunkers and plane with reventment
- 3. vietnam fire base - helicopters on mounded earth

