



MARCH FIELD AIR MUSEUM RIVERSIDE, CA

MALIA PASELK

LD7 | SPRING 2020



CONTENTS

1		PROJECT OBJECTIVE & GOALS
2		SITE INTRODUCTION
7		CASE STUDIES/PRECEDENTS
14		SITE ANALYSIS
18		CONCEPT DEVELOPMENT
22		ENLARGEMENTS



PROJECT OBJECTIVE & GOALS

OBJECTIVE

- DEVELOP SOLUTIONS FOR SITE PLANNING AND PROGRAM CHALLENGES FOR THE MARCH FIELD AIR MUSEUM
- CREATE A MASTER PLAN FOR MUSEUM TO HELP IN GUIDING FUTURE DEVELOPMENT

GOALS

- ATTRACT AND ENGAGE VISITORS OF ALL AGES
- PROVIDE INTERACTIVE EXHIBITS
- CREATE VERSATILE OUTDOOR SPACES SUITABLE FOR DAILY VISITORS AND LARGE EVENTS



SITE INTRODUCTION

REGIONAL

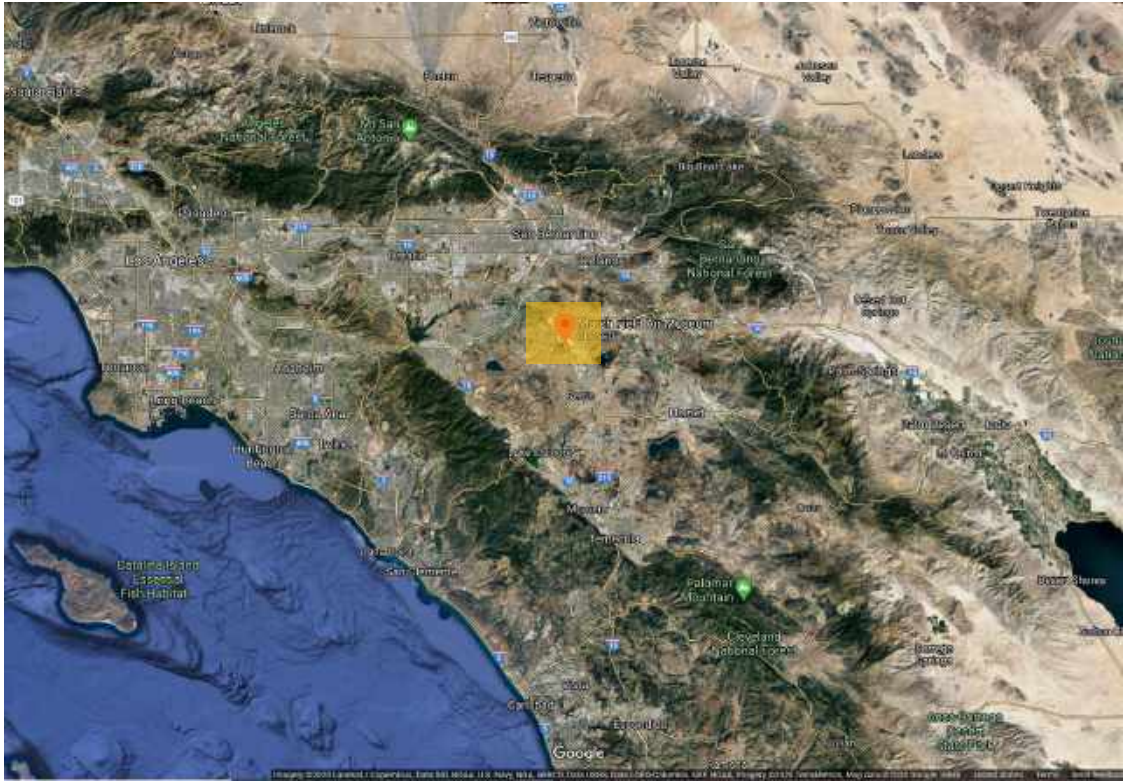

- LOCATED NEAR MORENO VALLEY AND RIVERSIDE, CA
- ADJACENT TO MARCH AIR RESERVE BASE AND INTERSTATE 215
- ABOUT 65 MILES EAST OF LOS ANGELES AND 90 MILES NORTH OF SAN DIEGO

CONTEXT



VICINITY



1918

- ESTABLISHED AS ALESSANDRO FLYING TRAINING FIELD
- LATER RENAMED MARCH FIELD, IN HONOR OF SECOND LIEUTENANT PEYTON G. MARCH, JR. – SON OF THE THEN ARMY CHIEF OF STAFF

1927

- MARCH FIELD REOPENS

1941

- MARCH FIELD RESUMES TRAINING OPERATIONS AFTER ATTACK ON PEARL HARBOR
- BOB HOPE'S FIRST USO SHOW

1949

- MARCH FIELD BECAME PART OF THE NEW STRATEGIC AIR COMMAND
- PLANES AND CREW BROKE ALTITUDE AND DISTANCE RECORDS

1923

- MARCH FIELD CLOSES

1931

- MARCH FIELD TRANSITIONS FROM TRAINING BASE TO OPERATIONAL BASE

1942

- JACK BENNY RADIO SHOW BROADCASTS FROM MARCH FIELD

1979

- LT. GENERAL JAMES P. MULLINS, 15TH AIR FORCE COMMANDER, DELIVERED ADDRESS AT DEDICATION CEREMONY FOR NEW MARCH AIR FORCE BASE MUSEUM

MAY

1980

- NON-PROFIT MARCH FIELD MUSEUM FOUNDATION ESTABLISHED

1993

- MUSEUM RECEIVED SUPPORT FROM THE MARCH AIR MUSEUM FOUNDATION
- MOVED TO CURRENT LOCATION

1999

- MUSEUM'S OFFICIAL NAME CHANGED TO MARCH FIELD AIR MUSEUM

MARCH
1980

- OFFICIALLY RECOGNIZED AS AN AIR FORCE FACILITY

NOVEMBER
1980

- OUTDOOR AIRCRAFT PARK OPENED TO PUBLIC

1996

- MARCH AIR FORCE BASE DESIGNATED MARCH AIR RESERVE BASE
- MUSEUM MANAGEMENT AND OPERATION TURNED OVER TO MARCH AIR MUSEUM FOUNDATION





MUSEUM SIGNAGE TO DRAW IN VISITORS FROM I-215



MAIN ENTRANCE PATH FROM VISITOR PARKING LOT



VIEW OF MEMORIAL COURTYARD FROM GEN. "HAP" ARNOLD MEMORIAL – LOOKING TOWARDS I-215



VIEW OF MEMORIAL GARDEN FROM SOUTH WEST EDGE – LOOKING TOWARDS MEMORIALS AND OUTDOOR EXHIBITS



OUTDOOR AIRCRAFT EXHIBITS AND WALKING PATH



VIEW OF AIRCRAFTS THROUGH CHAIN-LINK FENCE BARRIER



PACIFIC THEATER FIRE BASE EXHIBIT



OUTDOOR EXHIBIT SPACE – WIDE OPEN, EXPOSED TO ELEMENTS





CASE STUDIES/PRECEDENTS

POLISH AVIATION MUSEUM

KRAKOW, POLAND

- OPENED IN 1964 AFTER ADJACENT AIRFIELD CLOSED
- COLLECTION CONSISTS OF OVER 200 AIRCRAFT
- CLEAR PATH THROUGH SPACE TO VIEW EACH AIRCRAFT
- DISPERSED TREES TO OFFER SHADE



GOOGLE MAPS STREET VIEW



GOOGLE MAPS



PIMA AIR & SPACE MUSEUM

TUCSON, AZ

- DEVELOPMENT BEGAN IN 1973, OPENED IN 1976
- 80 ACRES – CAN BE EXPLORED VIA A NARRATED TRAM TOUR
- MORE THAN 150 PLANES IN COLLECTION
- FOCUS ON “AEROSPACE EDUCATION THROUGH THE PRESERVATION AND PRESENTATION OF THE HISTORY OF FLIGHT”
- CLEAR LAYOUT OF AIRCRAFT
- RESTAURANT WITH OUTDOOR SEATING ALLOWS VISITORS TO REST IN SHADE WHILE STILL VIEWING THE AIRCRAFTS



GOOGLE STREET VIEW



GOOGLE MAPS



IRISH NATIONAL WAR MEMORIAL GARDENS

DUBLIN, IRELAND

- DESIGNED BY SIR EDWIN LUTYENS (1869-1944)
- COMMEMORATE THE MEMORY OF THE IRISH MEN AND WOMEN WHO DIED IN THE FIRST WORLD WAR
- USED FOR PEACEKEEPING CEREMONIES AND COMMEMORATIVE EVENTS
- POPULAR RECREATIONAL DESTINATION FOR LOCAL COMMUNITY AND INTERNATIONAL VISITORS



PHOTO CREDIT: RICHMOND BARRACKS



GOOGLE MAPS



NATIONAL MUSEUM OF USAF

DAYTON, OH

- OLDEST AND LARGEST MILITARY AVIATION MUSEUM IN THE WORLD
- ENGAGING EXHIBITS, EDUCATIONAL OUTREACH, NATIONAL HISTORY
- MUSEUM EXHIBITS ARE MOSTLY INDOOR, WITH AN OUTDOOR MEMORIAL PARK
- MEMORIAL PARK (ABOUT 8.5 ACRES) – SHADE TREES, MEANDERING PATHWAYS, QUIET SPACE FOR REFLECTION



GOOGLE MAPS STREET VIEW

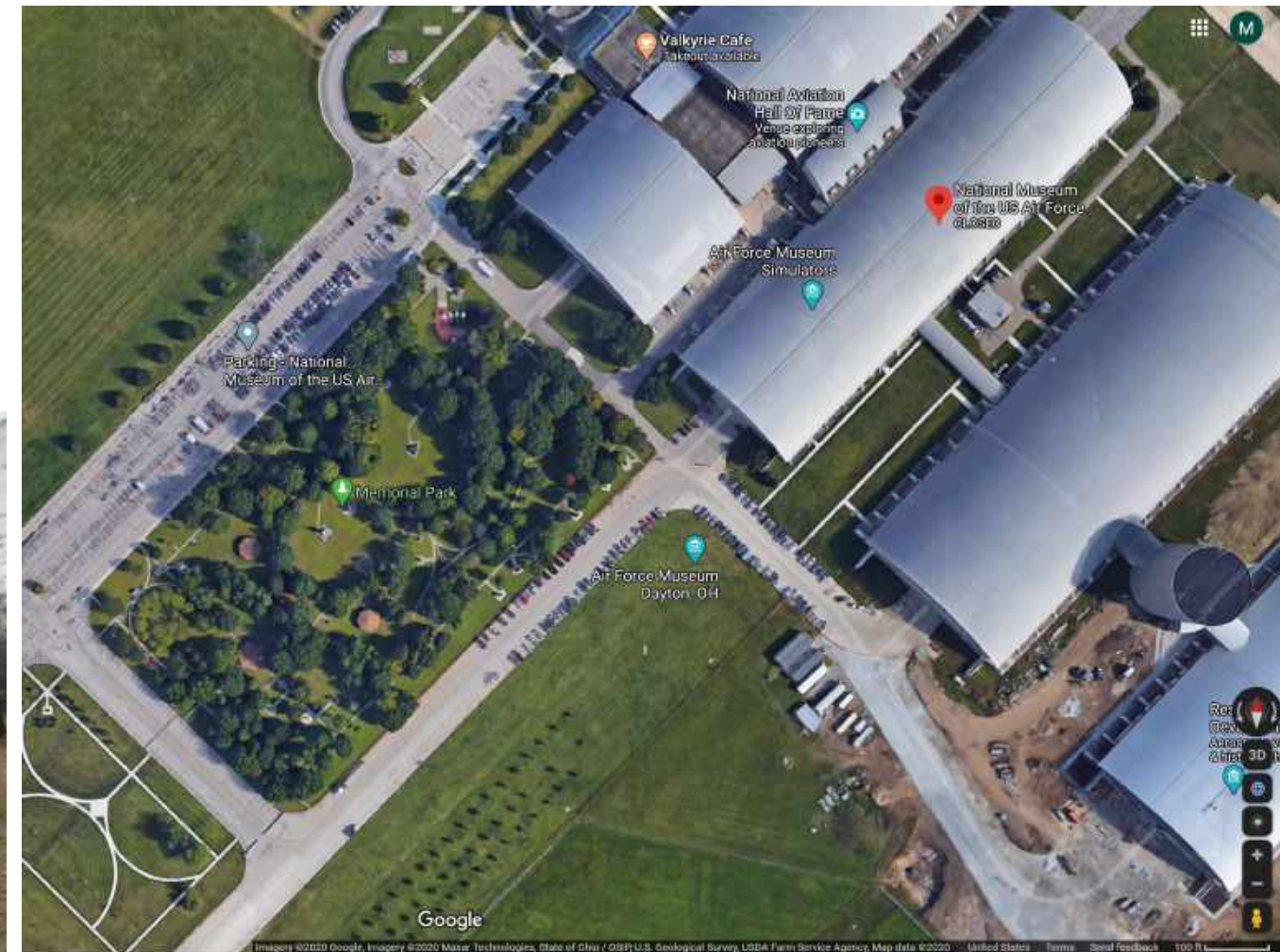

GOOGLE MAPS



VETERANS MEMORIAL GARDEN AIR SECTION

SAN DIEGO, CA

- LOCATED ON ONE-ACRE IN FRONT OF THE VETERANS MUSEUM AND MEMORIAL CENTER
- DIVIDED INTO THREE AREAS WITH A CENTRAL AMPHITHEATER: AIR, LAND, AND SEA GARDENS
- A BRONZE STATUE OF A WWII B-24 LIBERATOR IS THE CENTERPIECE OF THE AIR GARDEN, FLYING OVER A REFLECTING POOL
- WIDE LAWN AREAS, LARGE TREES AND BENCHES FOR CONTEMPLATION
- SENSE OF CONNECTIVITY – DRAWS VISITORS INTO THE SPACE



DAVID REED LANDSCAPE ARCHITECTS



GOOGLE MAPS



MEDAL OF HONOR MEMORIAL SITE

RIVERSIDE, CA

- PROXIMITY TO MARCH FIELD AIR BASE – 2 MILES
- WELCOMING – WATERFALL/FOUNTAIN
- SYMMETRICAL – SENSE OF DIRECTION AND CONNECTION
- ENGAGING – VISITORS ARE SURROUNDED BY WALLS WITH VETERAN'S NAMES
- AMPLE SEATING OFFERED BY FOUNTAIN WALL



U.S. DEPARTMENT OF VETERAN AFFAIRS



GOOGLE MAPS





SITE ANALYSIS

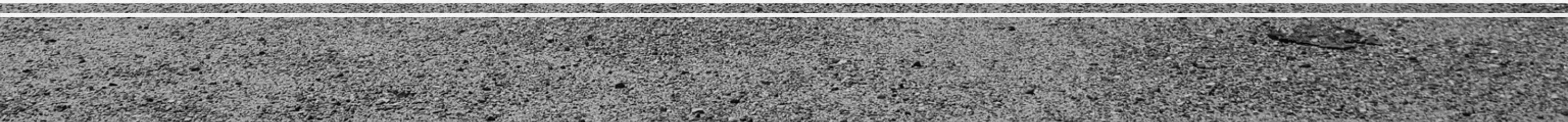

LEGEND



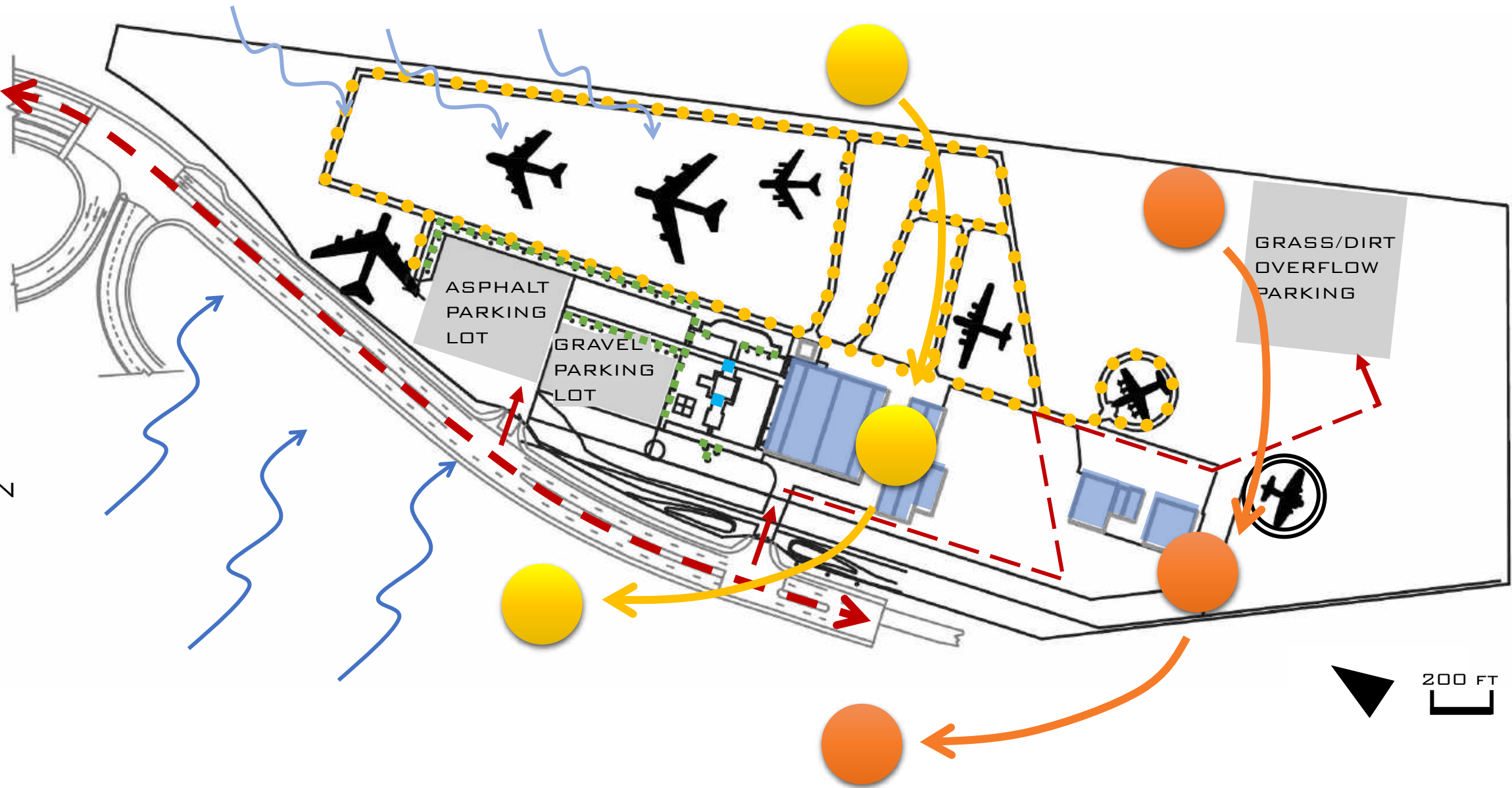

- EXISTING BUILDINGS
- EXISTING TREE COVER
- EXISTING SEATING
- PARKING LOT
- VEHICULAR CIRCULATION
- PEDESTRIAN CIRCULATION
- SOLAR PATTERN - SUMMER
- SOLAR PATTERN - WINTER
- PREVAILING WINDS
- SANTA ANA WINDS
- DO NOT MOVE



- HIGH EXPOSURE TO SUN AND WIND
 - NEED ADDITIONAL SHADE COVER AND SHELTER FROM ELEMENTS
- INSUFFICIENT PEDESTRIAN CIRCULATION THROUGHOUT SITE
- INSUFFICIENT SEATING OPTIONS THROUGHOUT SITE



LEGEND

-  DO NOT MOVE
-  EXISTING BUILDINGS TO REMAIN
-  WALL TO REMAIN
-  NOISE FROM FREEWAY
-  NOISE FROM MARCH AIR RESERVE BASE
-  NO TREES ALLOWED WITHIN OUTLINED AREA
-  ONLY TREES <40' TALL

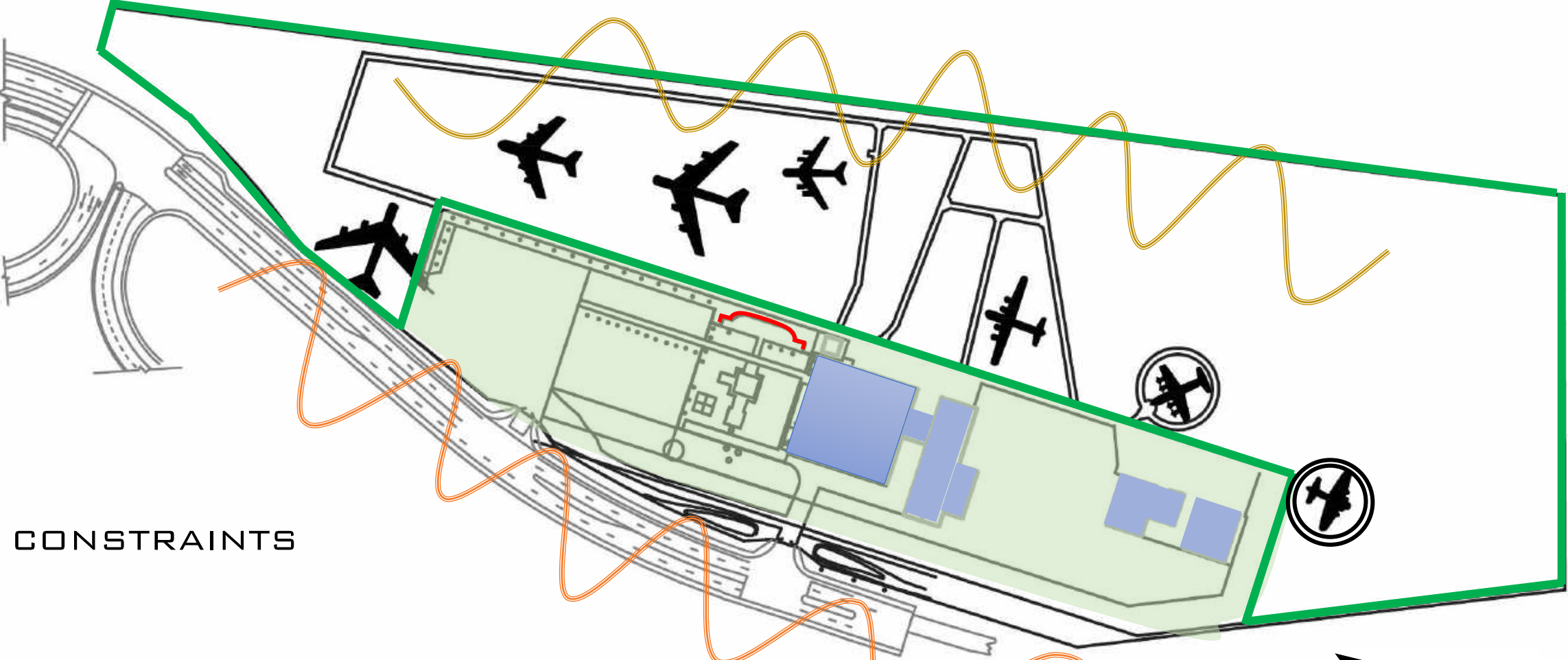

CONSTRAINTS

LEGEND

-  OPEN SPACE FOR REDESIGN
-  POTENTIAL INDOOR/OUTDOOR CONNECTION/EVENT AREA
-  POTENTIAL EVENT AREA IF OVERFLOW PARKING RELOCATED
-  MOUNTAIN VIEWS
-  VIEWS INTO SITE FROM ROAD

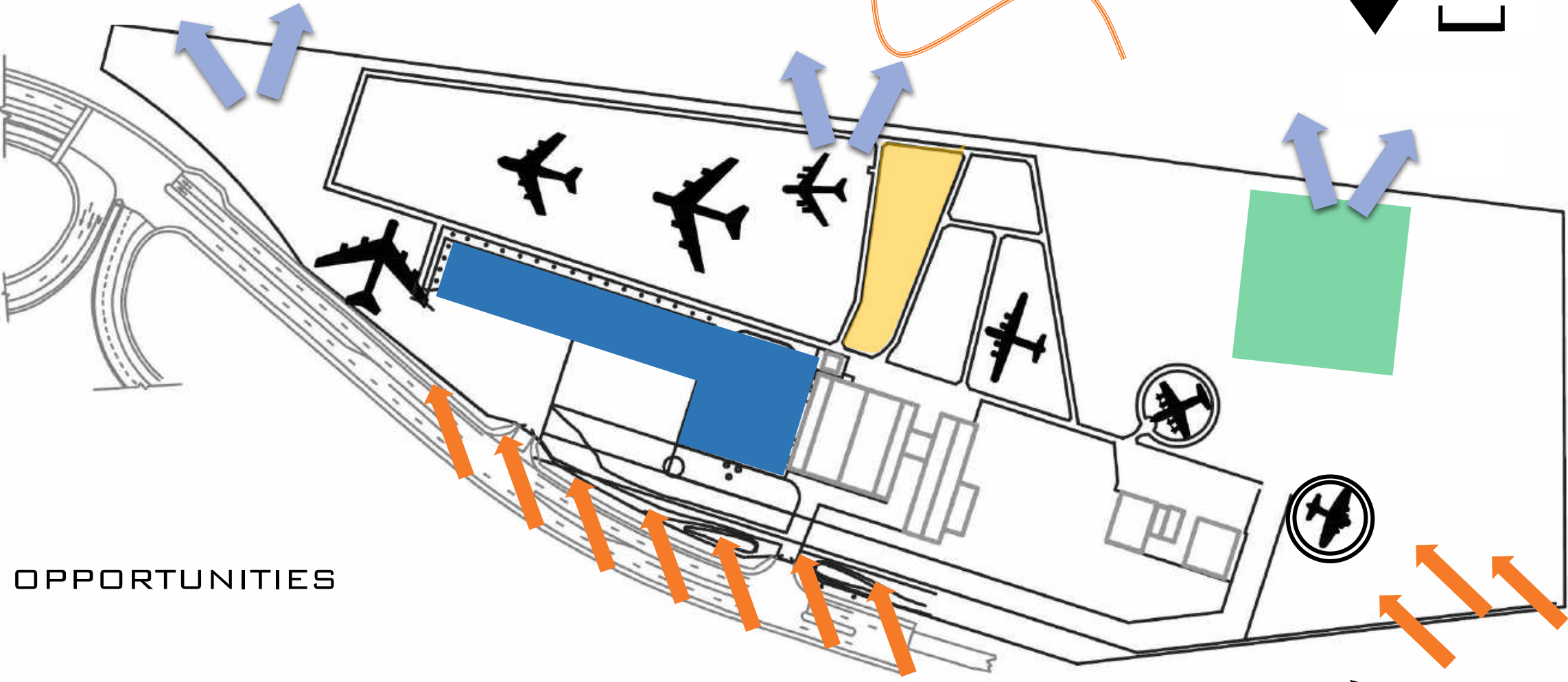

OPPORTUNITIES

- 1 BURBANK AVIATION MUSEUM
- 2 MUSEUM OF FLYING
- 3 WESTERN MUSEUM OF FLIGHT
- 4 WHITTIER MUSEUM
- 5 LYON AIR MUSEUM
- 6 PLANES OF FAME AIR MUSEUM
- 7 PALM SPRINGS AIR MUSEUM
- 8 MARCH FIELD AIR MUSEUM

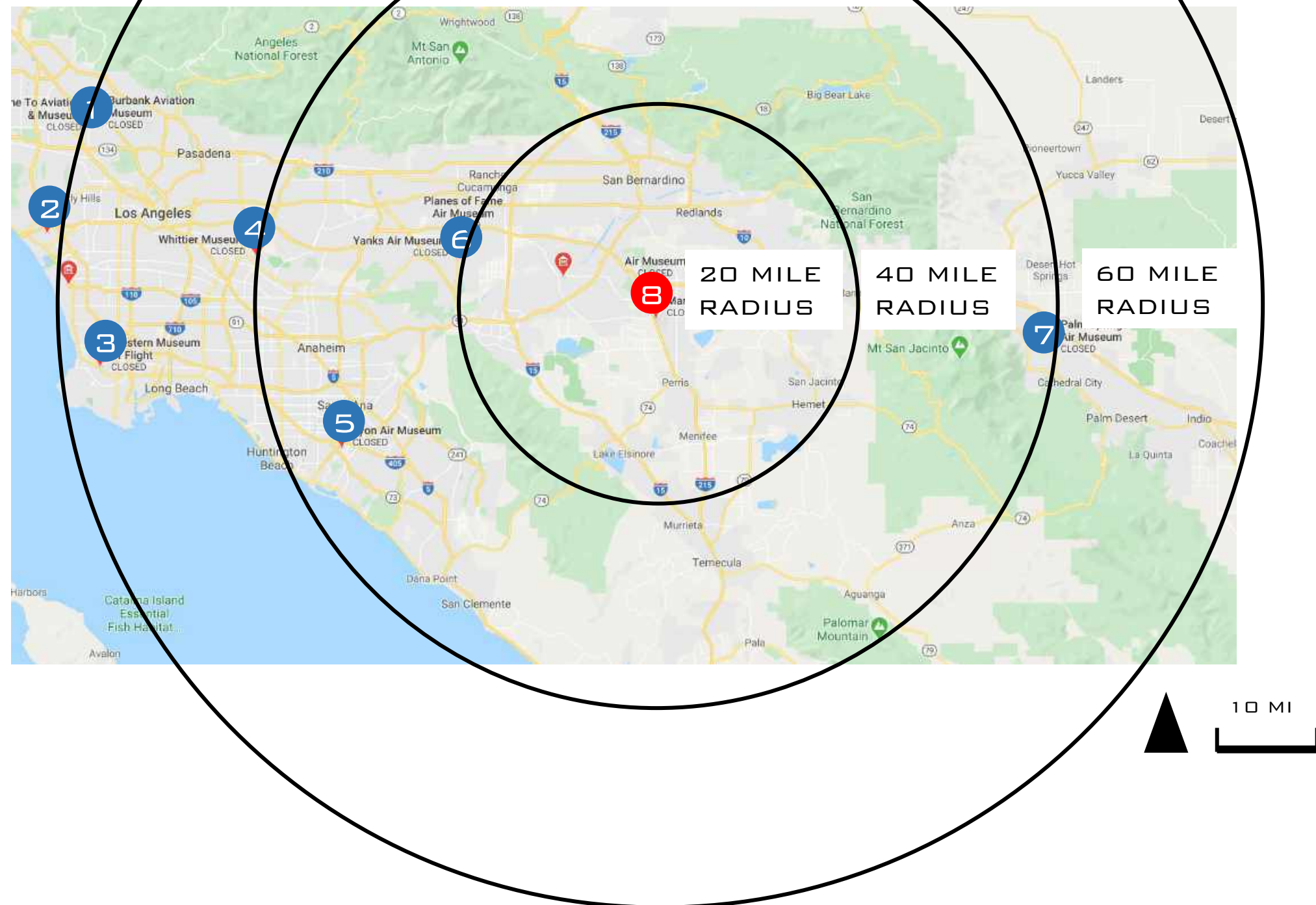



CONCEPT DEVELOPMENT

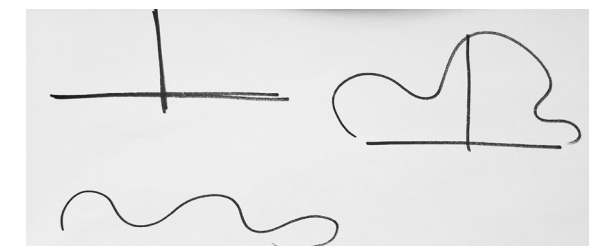
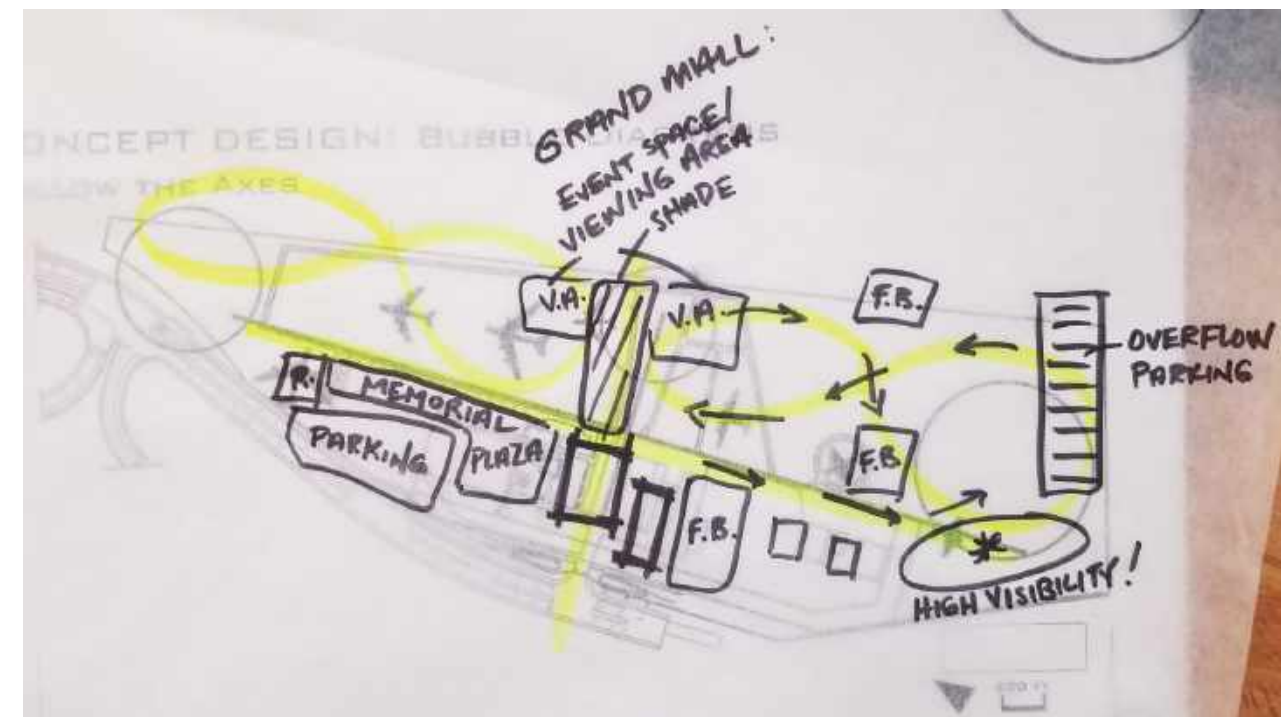
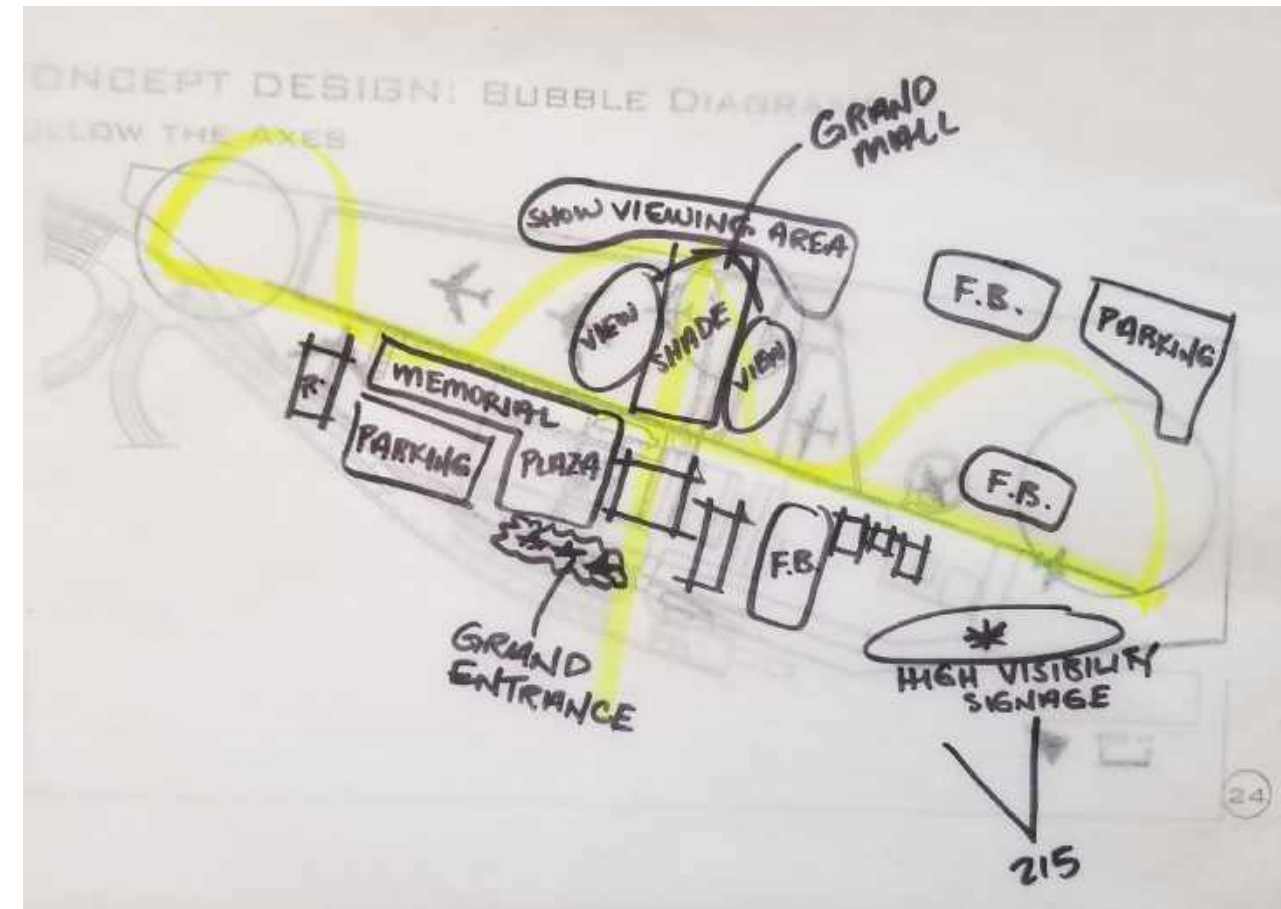
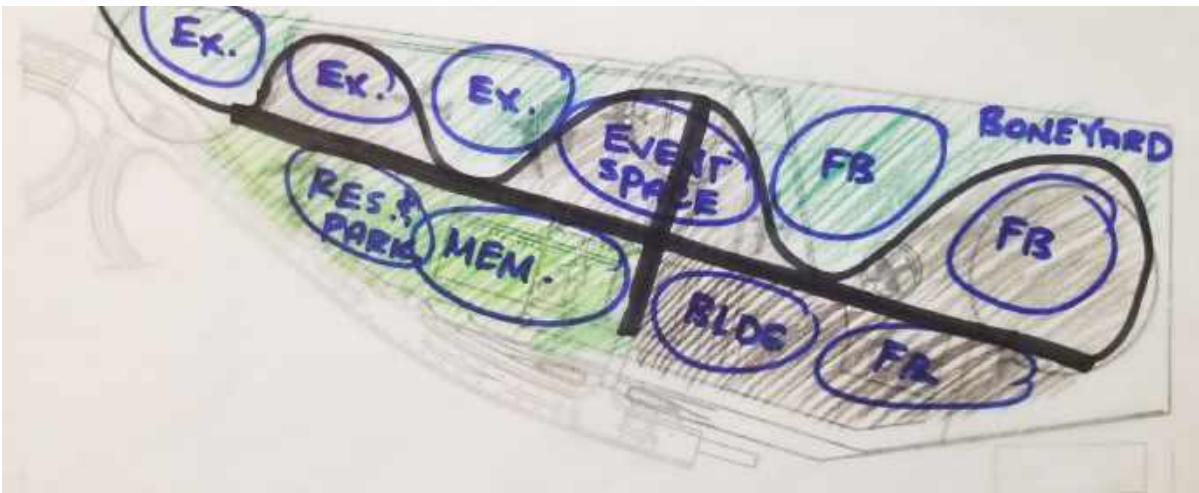
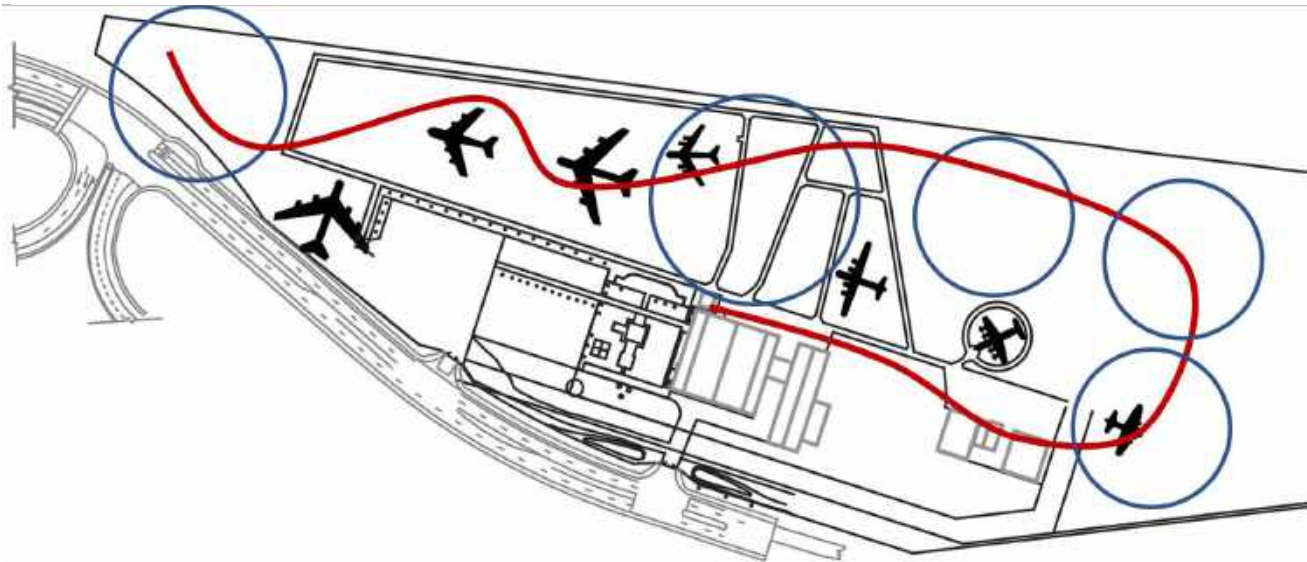
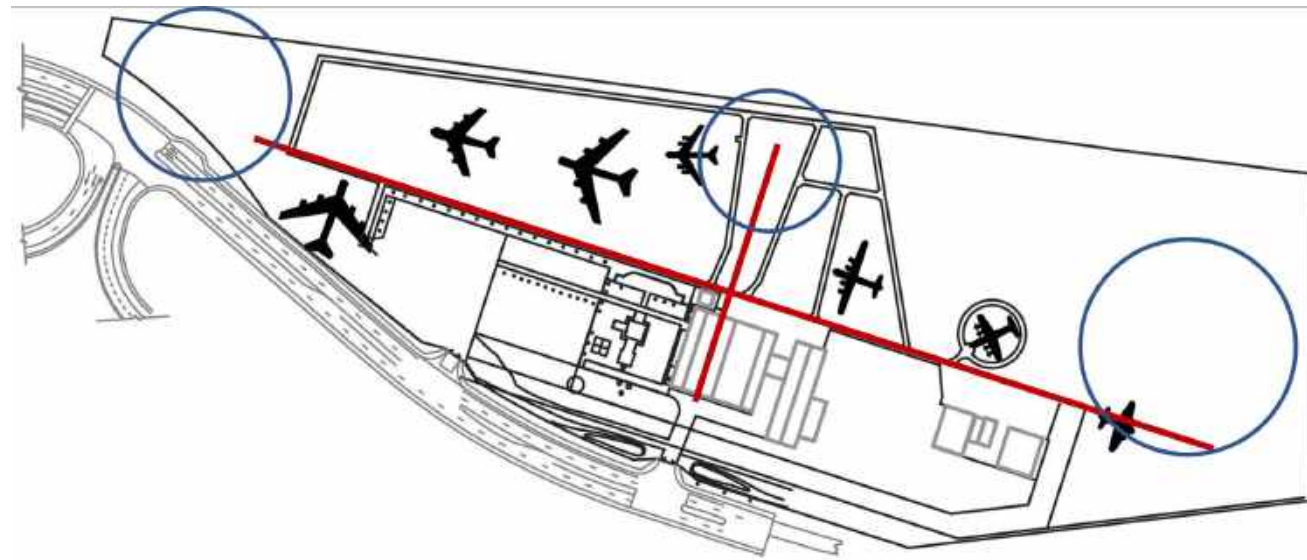

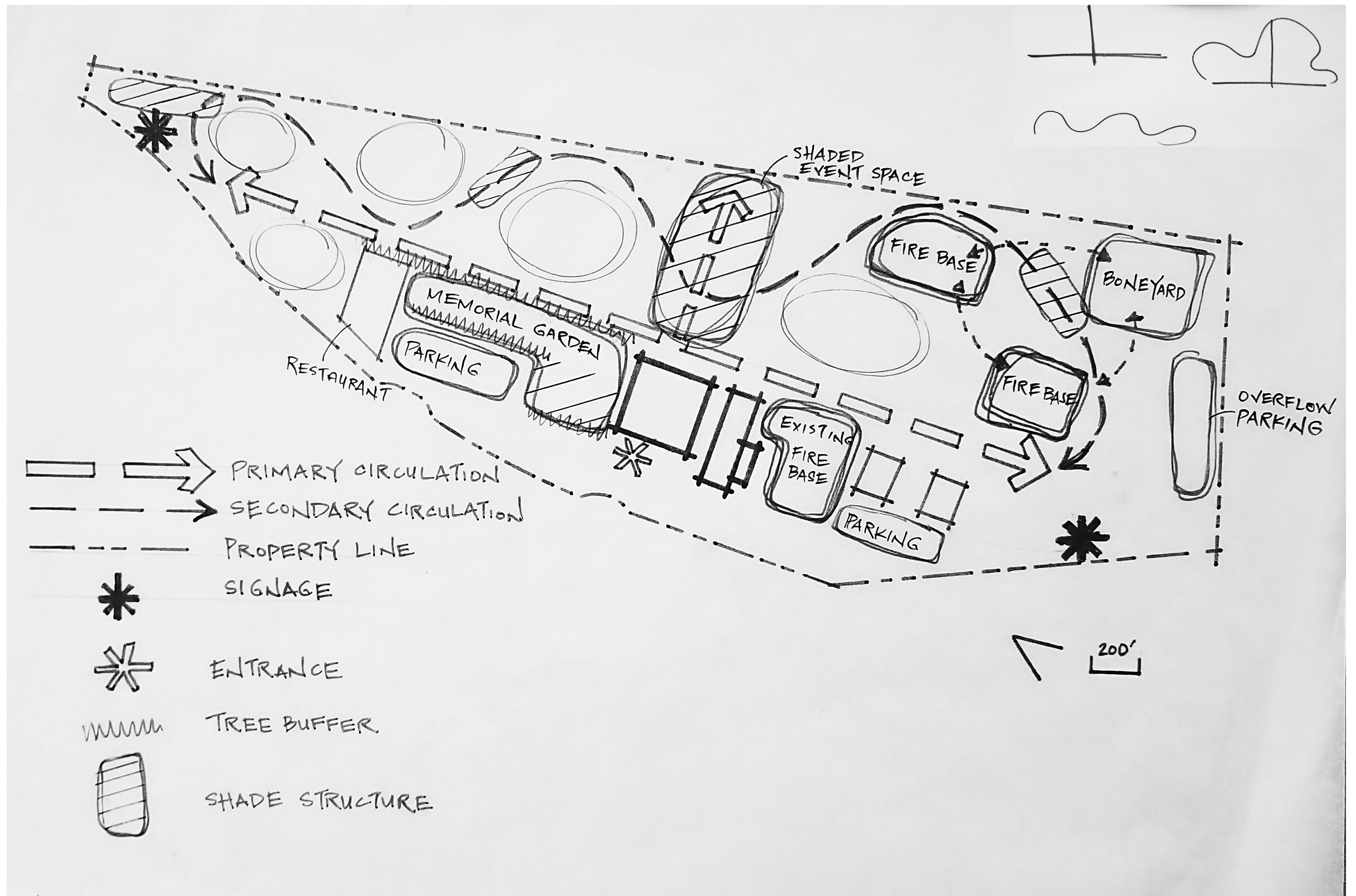

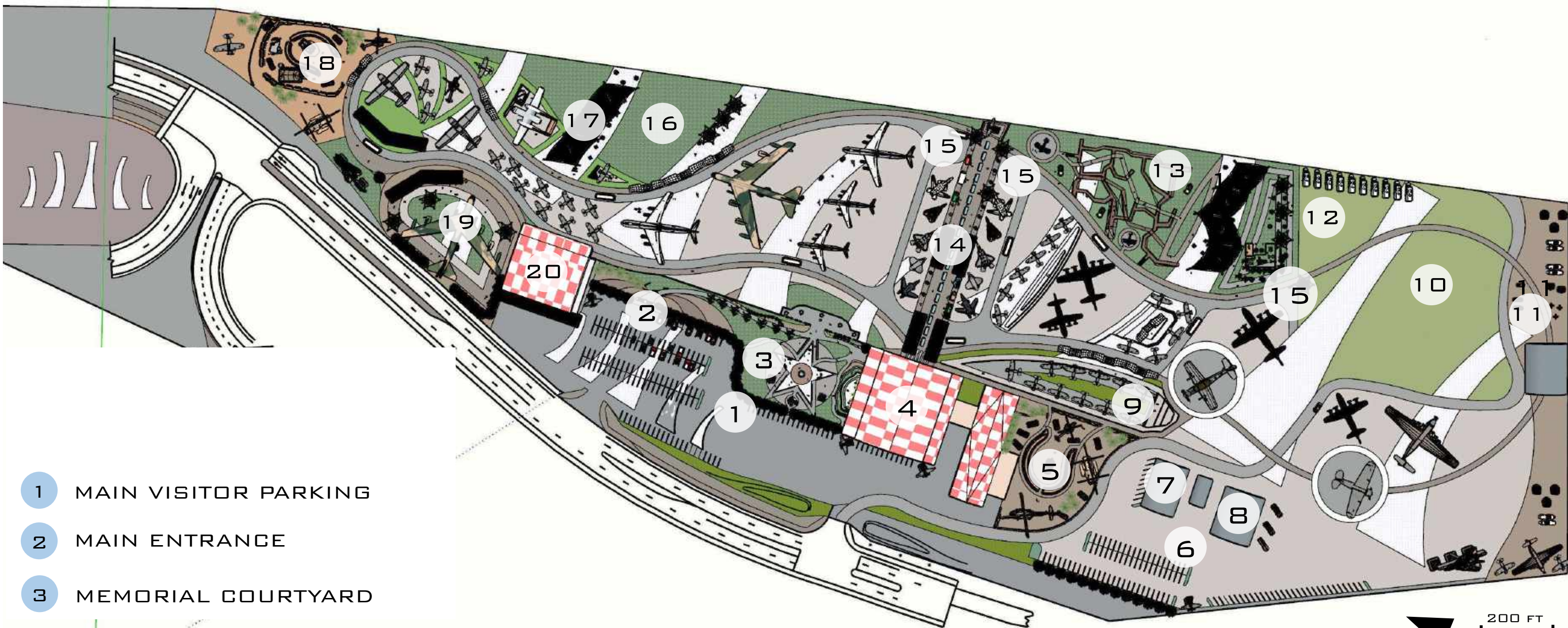

1 MAIN VISITOR PARKING

2 MAIN ENTRANCE

3 MEMORIAL COURTYARD

4 MAIN HANGAR/INTERIOR EXHIBITS

5 VIETNAM FIRE BASE

6 EMPLOYEE PARKING

7 P-38 HANGAR

8 DICK VAN RENNES
RESTORATION HANGAR

9 MEMORIAL OVERLOOK

10 OVERFLOW PARKING

11 BONEYARD

12 RV PARKING & CAMP AREA

13 WWI FIRE BASE/TRENCHES

14 RUNWAY WALK

15 TRAM PICK-UP/DROP-OFF

16 AIR SHOW VIEWING

17 PICNIC AREA

18 IRAQ FIRE BASE

19 C-141 EVENT SPACE

20 RUNWAY WALK



ENLARGEMENTS

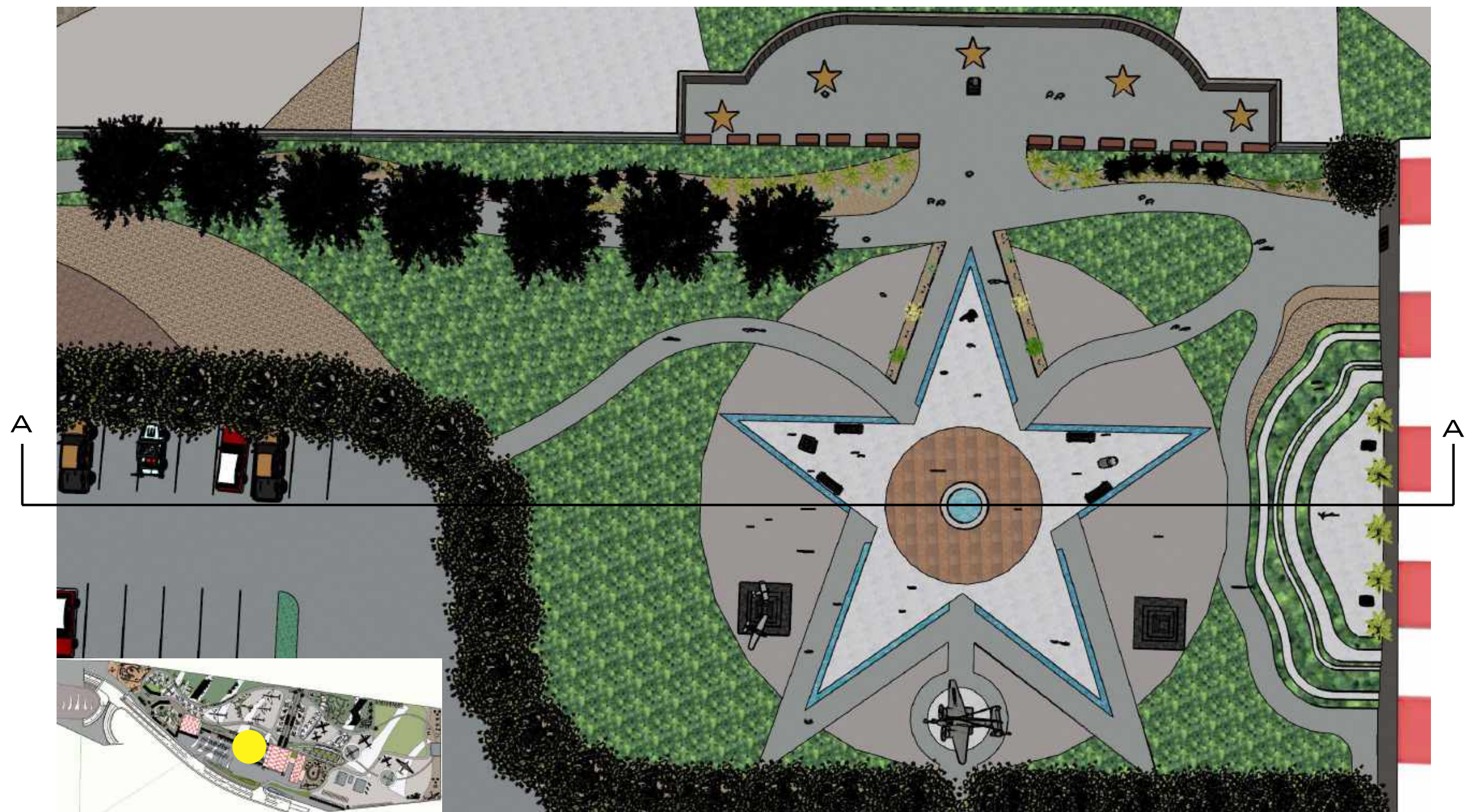
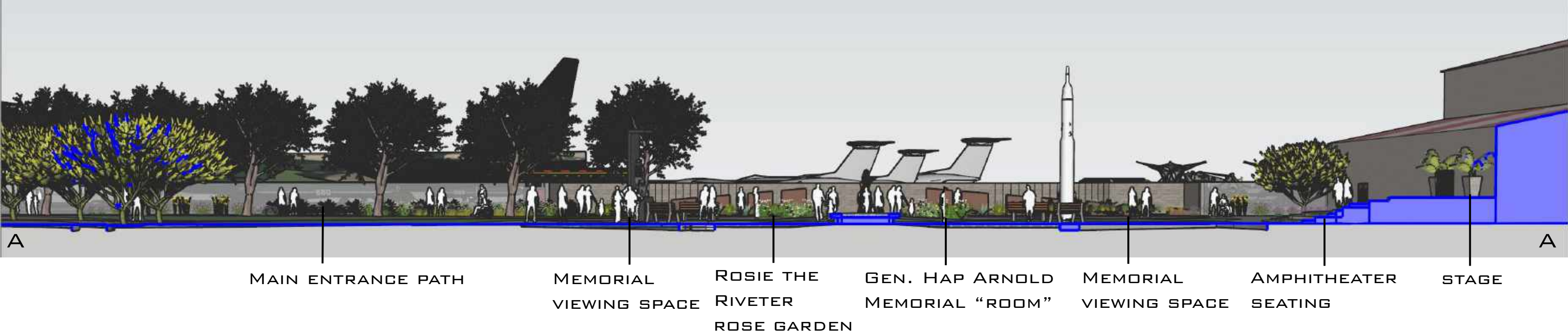

OBJECTIVES:

- VERSATILE SPACE - MONUMENT DISPLAYS, INTIMATE AREAS FOR REFLECTION, AND TRANSITIONAL SEATING/STAGE AREA
- HONORS VETERANS WITH MONUMENTS AND INTERPRETIVE SIGNAGE
- PROVIDES A GRAND ENTRANCE INTO THE MUSEUM AND SETS THE MOOD FOR THE VISITOR'S EXPERIENCE
- PROVIDES AN ENGAGING AND EDUCATIONAL EXPERIENCE FOR VISITORS ENTERING THE MUSEUM AND FOR AFTER-HOURS VISITORS



- ENTRANCE PATH NEAREST HANGAR
 - IMMEDIATE VIEWS OF MEMORIAL DISPLAYS
- OPEN WALKING SPACE
- SHALLOW WATER CHANNEL SEPARATES PERIMETER WALKING PATHS FROM CENTRAL GATHERING SPACE
- VIEWS OF CENTRAL SEATING WALL, MONUMENTS, AND AIRCRAFTS IN THE OUTDOOR EXHIBITS

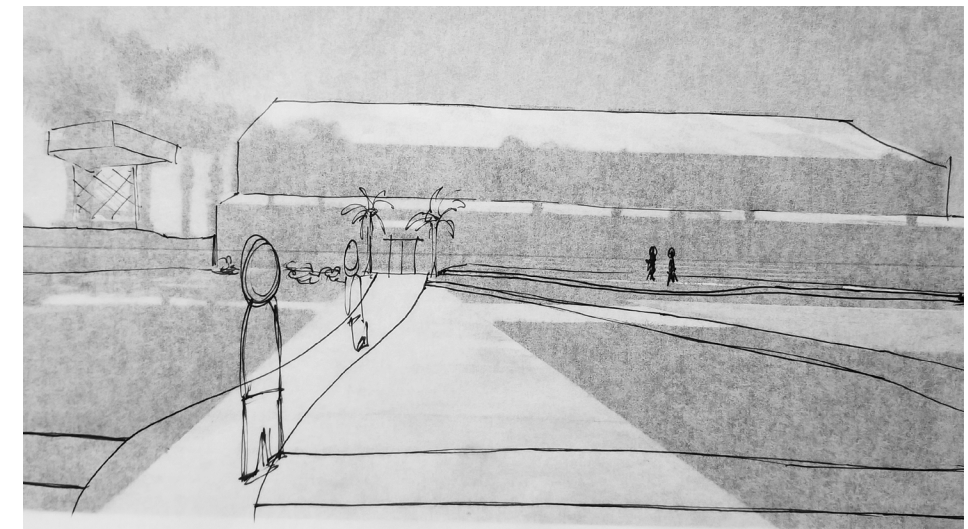
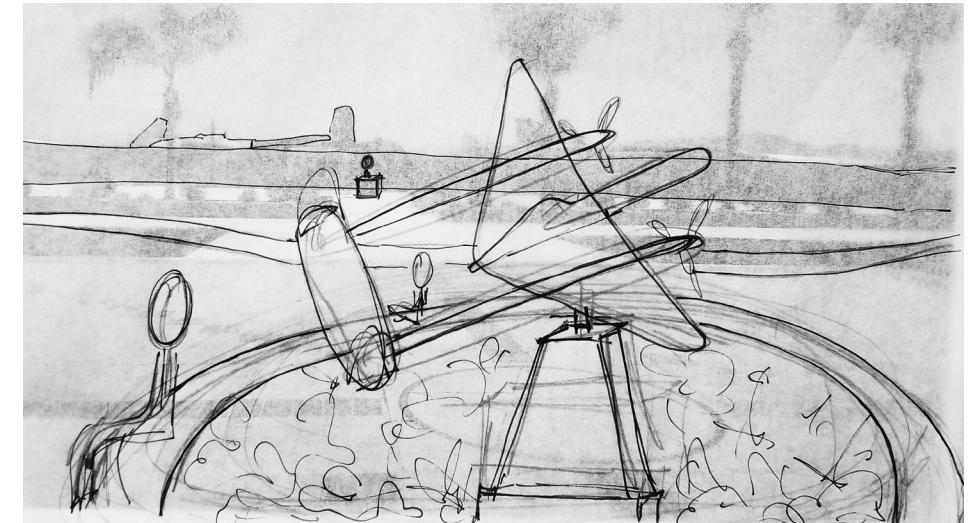

- MAIN ENTRANCE PATH
 - BORDERED BY SHADE TREES AND LOW-WATER SHRUBS
- PLEXI-GLASS WALL ALONG LENGTH OF PATH ALLOWS VIEWS OF OUTDOOR AIRCRAFT EXHIBITS WHILE SEPARATING THE SPACES SECURELY

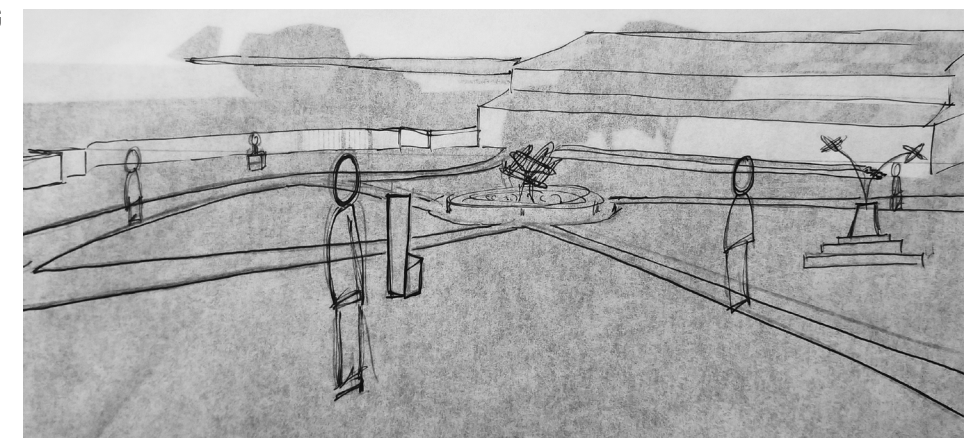

TREES



Cercidium x 'Desert Museum'
Desert Museum Palo Verde
WUCOL L



Searsia lancea
African Sumac
WUCOL L

SHRUBS



Encelia californica
Bush Sunflower
WUCOL L



Eriogonum fasciculatum
California Buckwheat
WUCOL L



Hesperaloe parviflora
Red Yucca
WUCOL L



Rosa sp.
Assorted Roses
WUCOL M



Salvia mellifera
Black Sage
WUCOL L

SUCCULENTS



Agave attenuate
Foxtail Agave
WUCOL VL



Agave desmettiana
Smooth-leaf Agave
WUCOL VL

GRASSES



Aristida purpurea
Purple Three Awn
WUCOL VL



Muhlenbergia rigens
Deer Grass
WUCOL M

GROUNDCOVER



Agrostis pallens
Native Bentgrass
WUCOL L



Lippia nodiflora
Kurapia
WUCOL VL



VIEW FROM THE GENERAL "HAP" ARNOLD MEMORIAL



ROSIE THE RIVETER MEMORIAL ROSES AND STATUE



MEMORIAL COURTYARD FROM AMPHITHEATER SEATING

- MEMORIALS
- OPEN SPACE FOR EVENTS AND CLEAR VIEWS OF MEMORIALS
- RESTAURANT IN THE DISTANCE BEYOND PALO VERDE TREES



MEMORIAL COURTYARD FROM MAIN ENTRANCE PATH

- MEMORIALS
- AMPHITHEATER SEATING AND STAGE
- MAIN PARKING LOT BEYOND PALO VERDE TREES

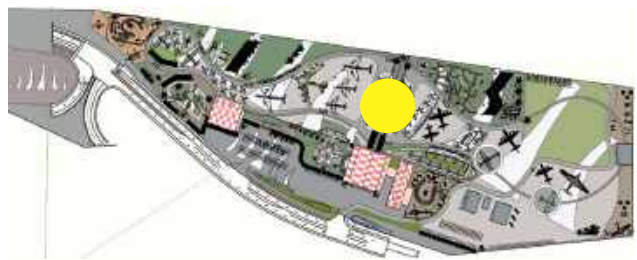
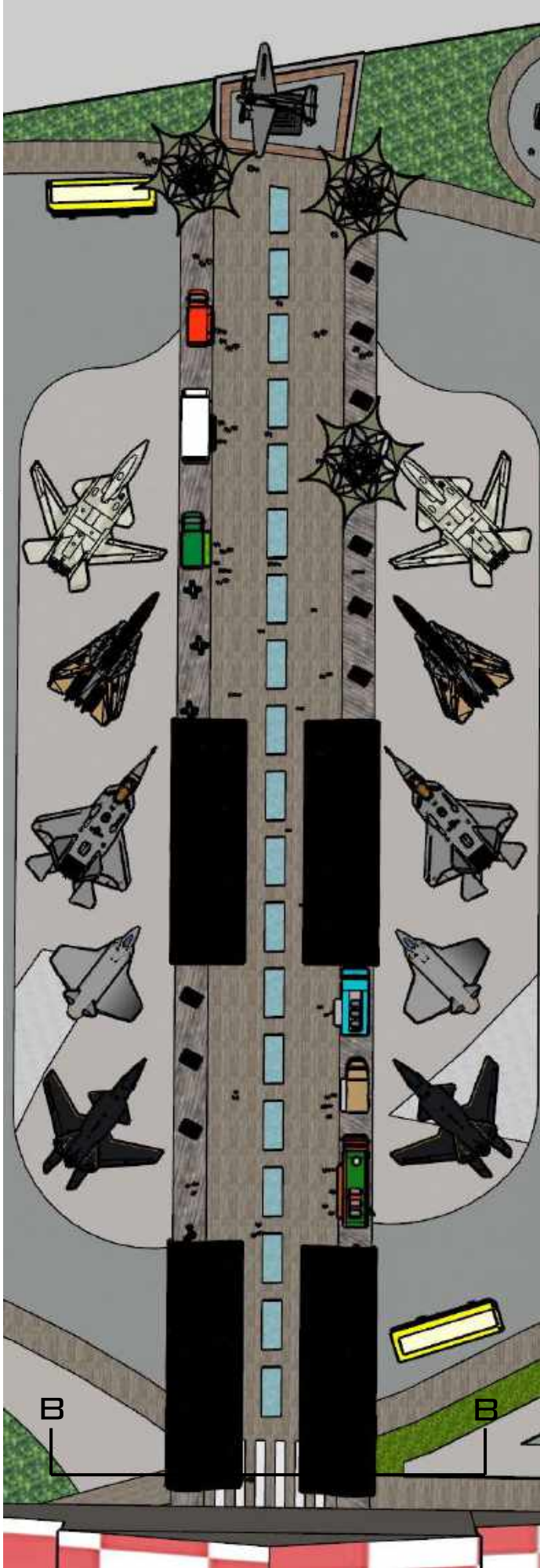
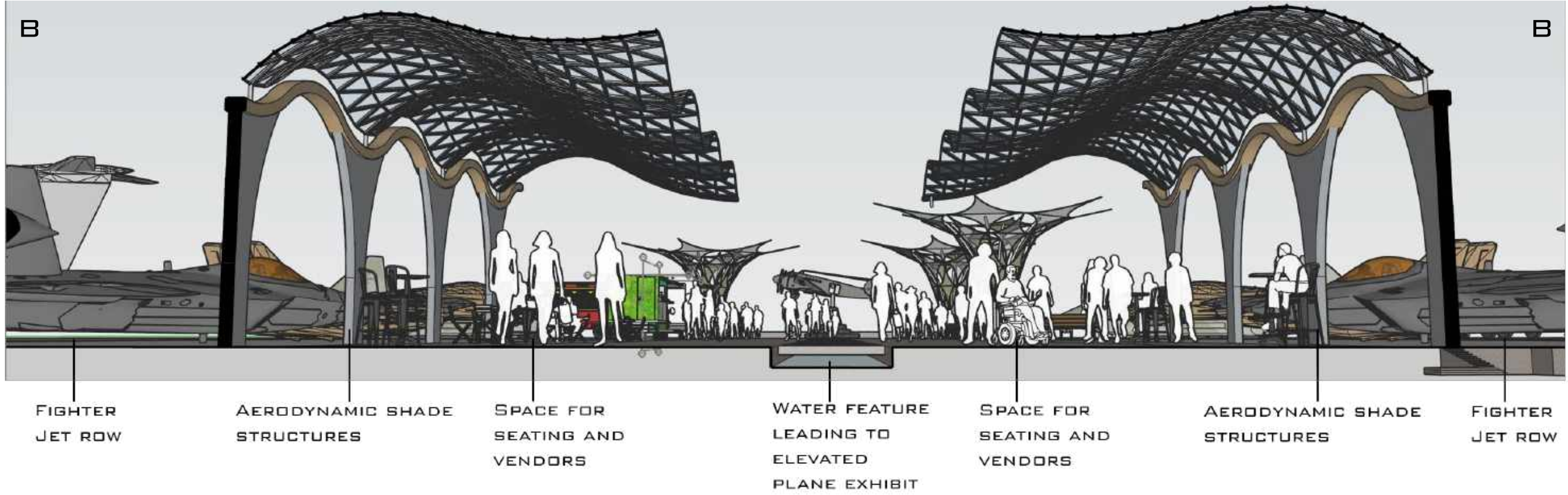

OBJECTIVES:

- GRAND SPACE WITH VIEWS DOWN A “RUNWAY” TO THE MARCH AIR RESERVE BASE AND ELEVATED AIRPLANE EXHIBIT
- LARGE AERODYNAMIC STRUCTURES PROVIDE SHADE AND SHELTER FROM WIND
- VERSATILE FOR LARGE EVENTS AND DAY-TO-DAY VISITORS – AVAILABLE SPACE FOR FOOD TRUCKS/VENDORS, SHADED SEATING
- TILE “WATER” FEATURE HELPS TO COOL DOWN AND BREAK UP THE SPACE, WHILE CREATING THE OVERALL LOOK OF A RUNWAY



- AERODYNAMIC SHADE STRUCTURES
 - LARGE ENOUGH TO SHADE ENTIRE RUNWAY WALK – SEATING SPACE AND WALKING SPACE
- VIEW OF ELEVATED AIRCRAFT DISPLAY



- LARGE OPEN SPACE BROKEN UP BY SHALLOW WATER CHANNEL
- AMPLE SPACE FOR VENDORS/FOOD TRUCKS, SEATING, AND WALKING
- CLEAR VIEW OF ELEVATED AIRCRAFT DISPLAY

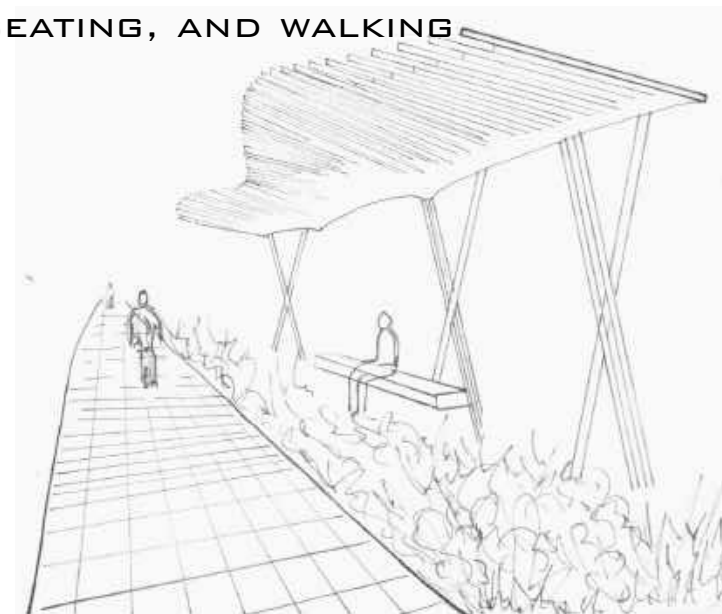

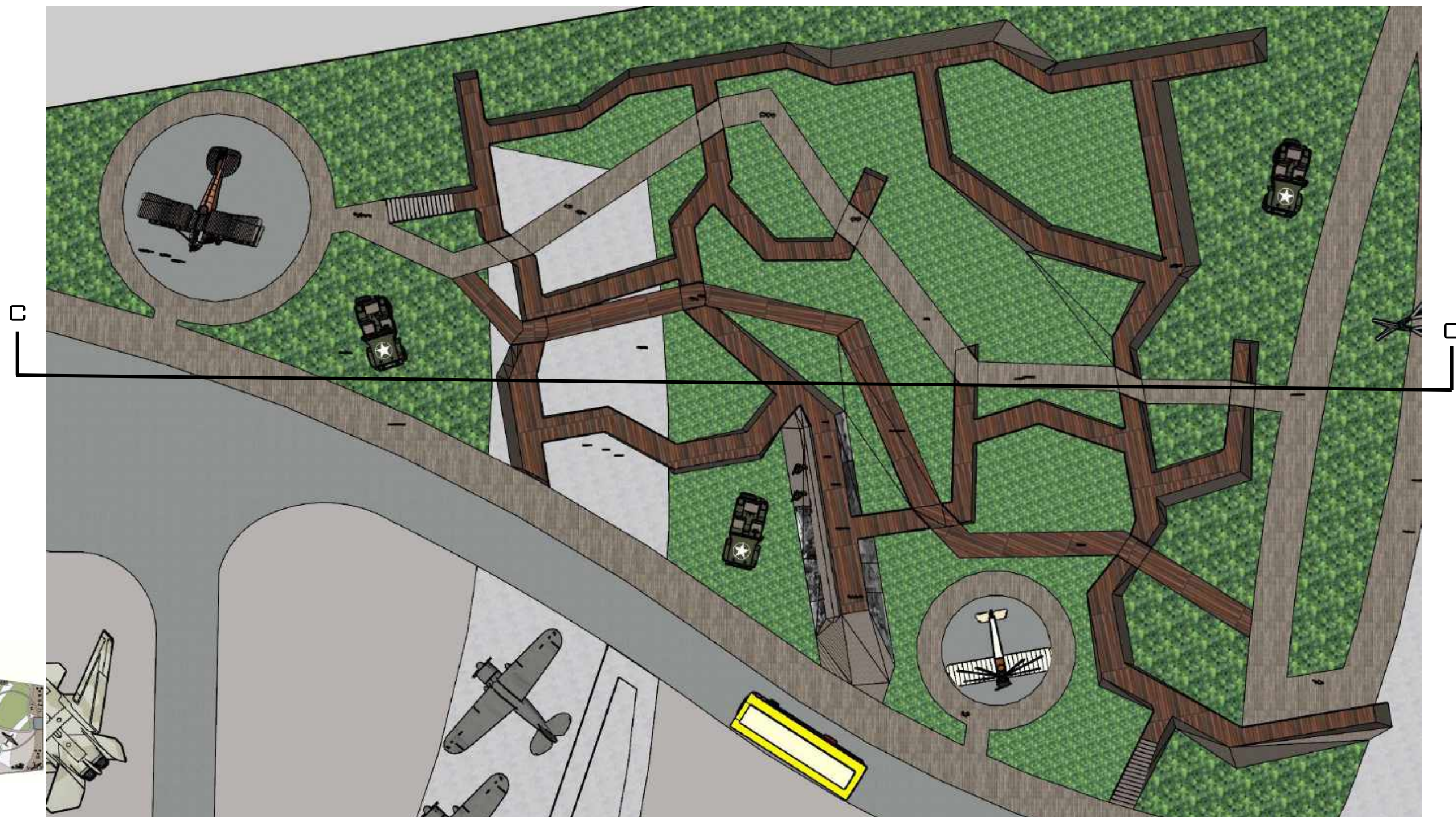
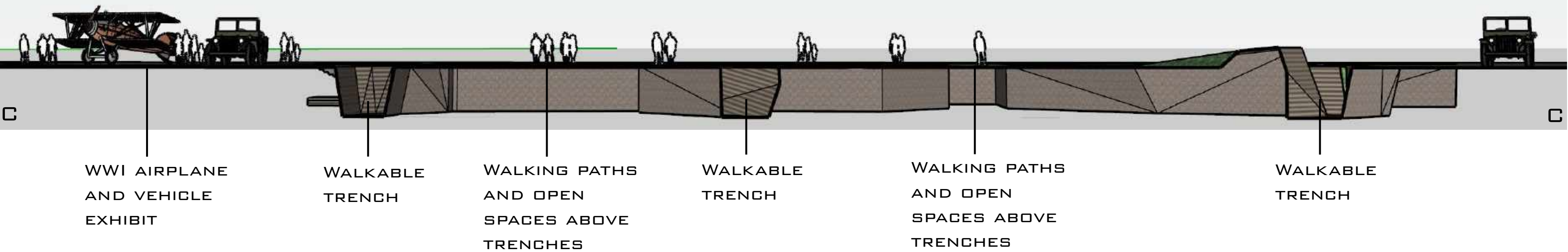

OBJECTIVES:

- HONORS VETERANS OF WWI AND EDUCATES VISITORS ABOUT LIFE IN THE TRENCHES
- HELP TO CAPTIVATE VISITORS AND SET THEM IN THE TIME AND PLACE OF WWI
 - PHOTOS OF LIFE IN THE TRENCHES COVER THE WALLS
- PROVIDES AN ENGAGING AND EDUCATIONAL EXPERIENCE FOR VISITORS

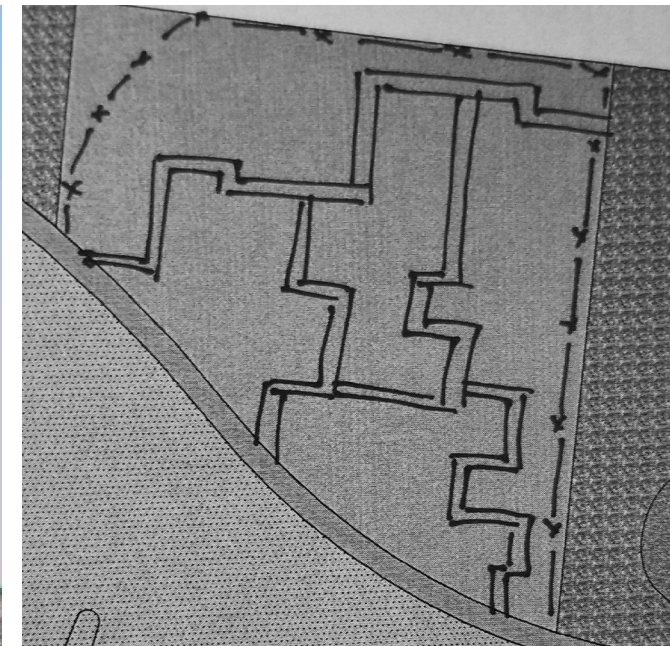

WALKWAYS MADE OF PAVERS AND WOOD PLANKS ALLOW VISITORS TO VIEW TRENCHES FROM ABOVE



WWI TRENCH EXPERIENCE WITH EARTHEN AND REINFORCED
WALLS DISPLAYING ACTUAL WWI TRENCH WARFARE PHOTOS

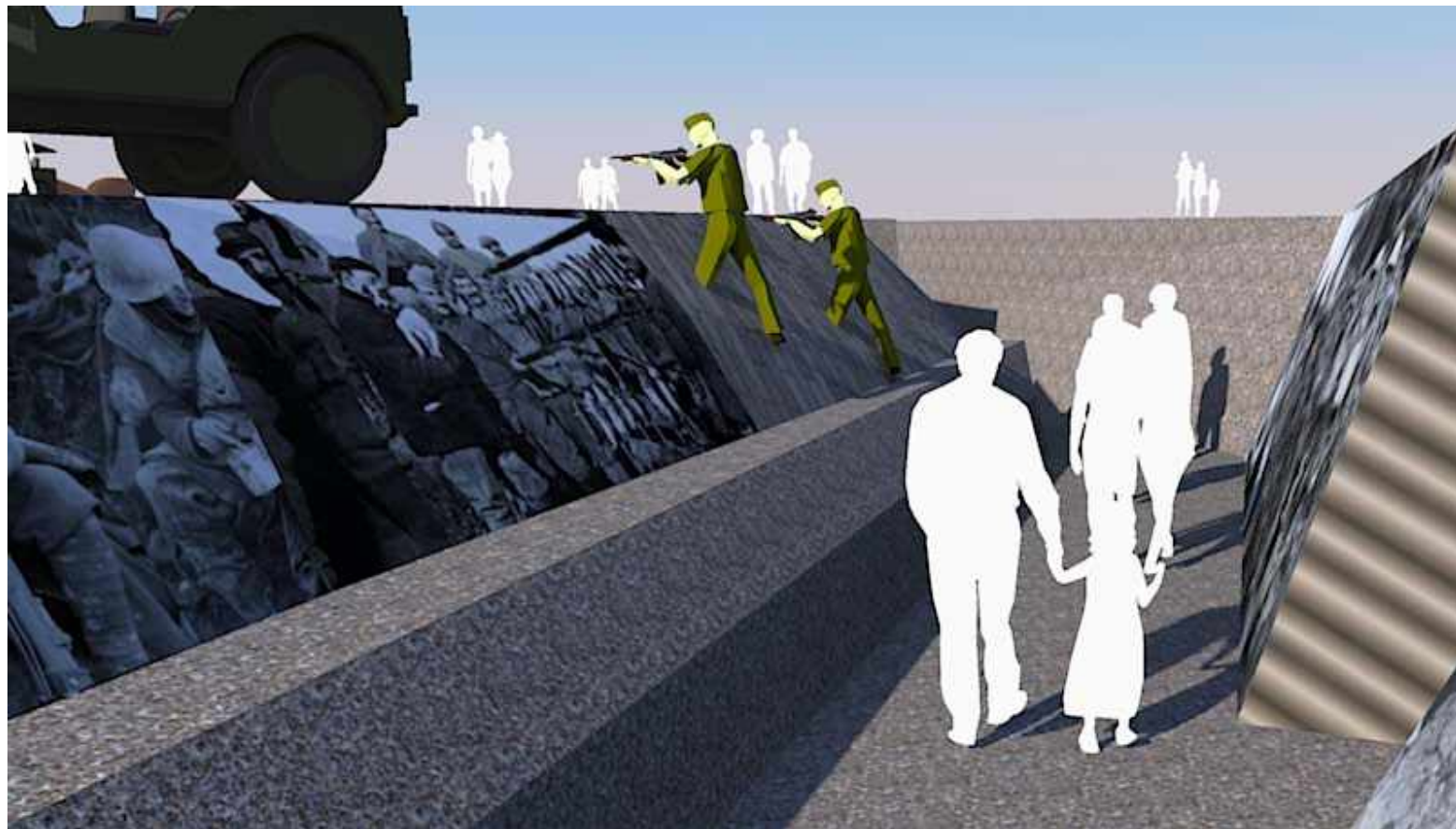
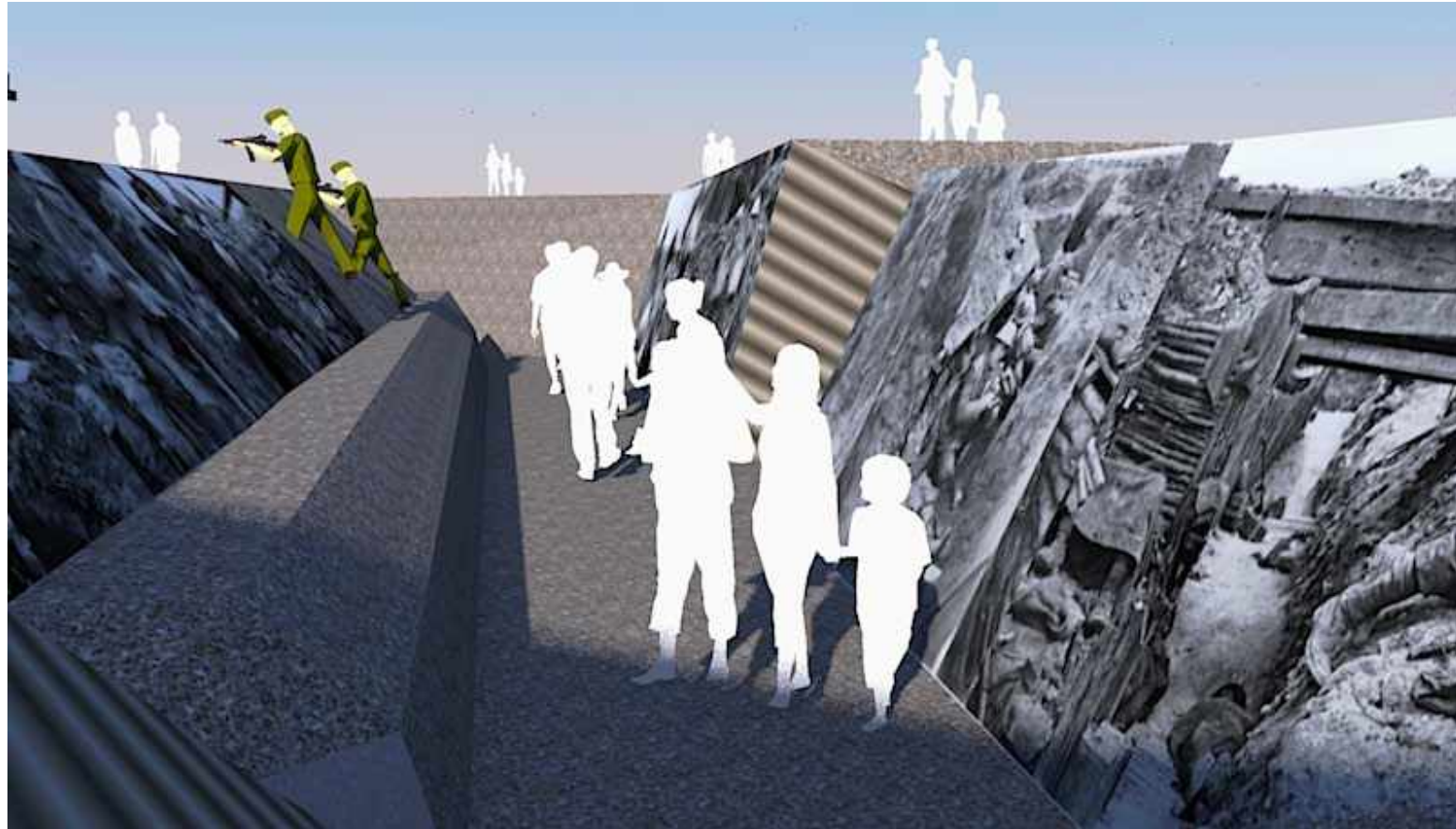

PHOTOS USED ON TRENCH WALLS



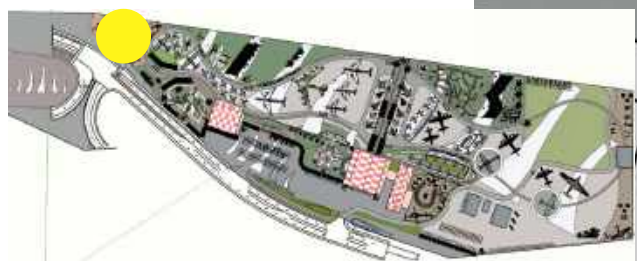
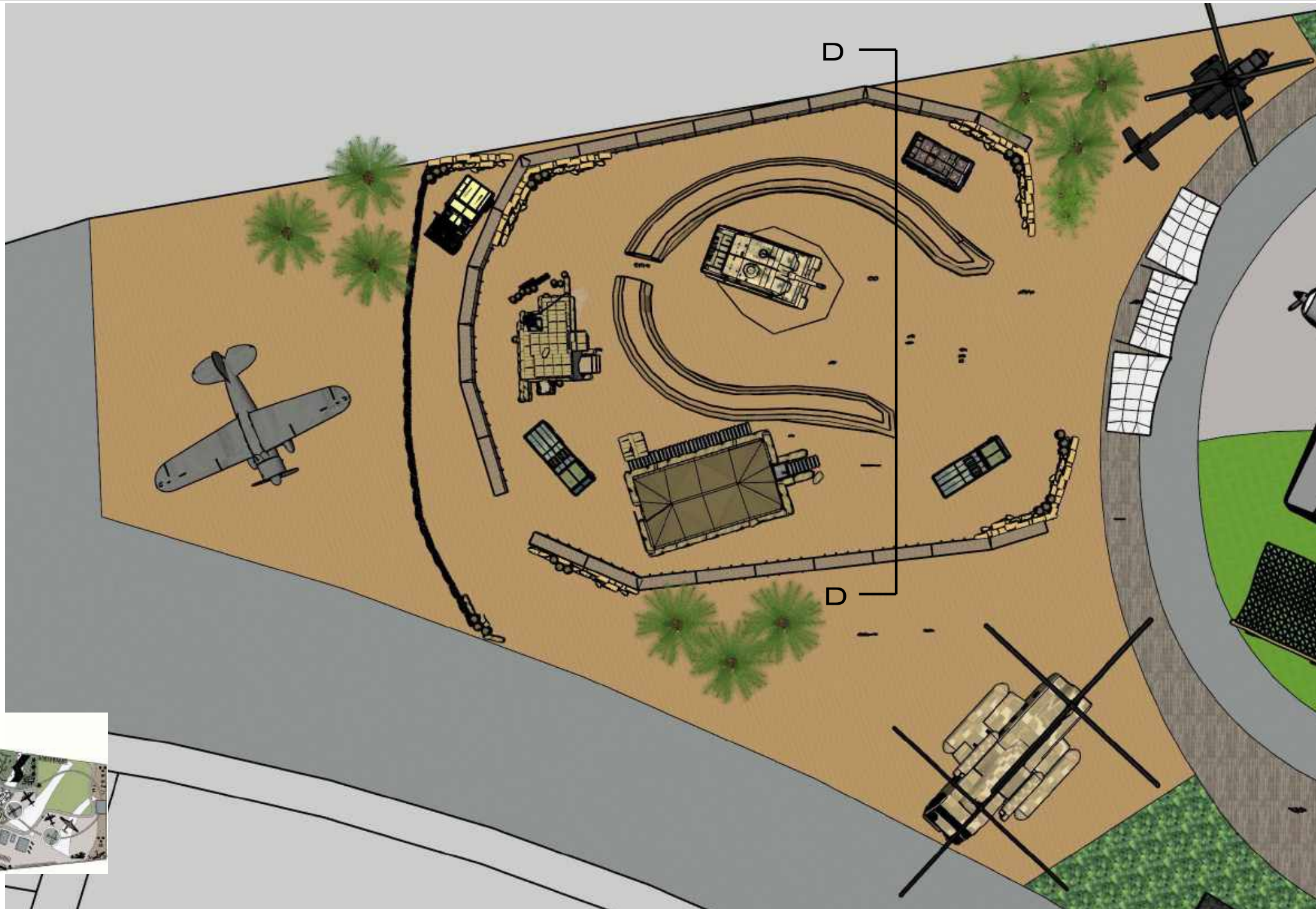
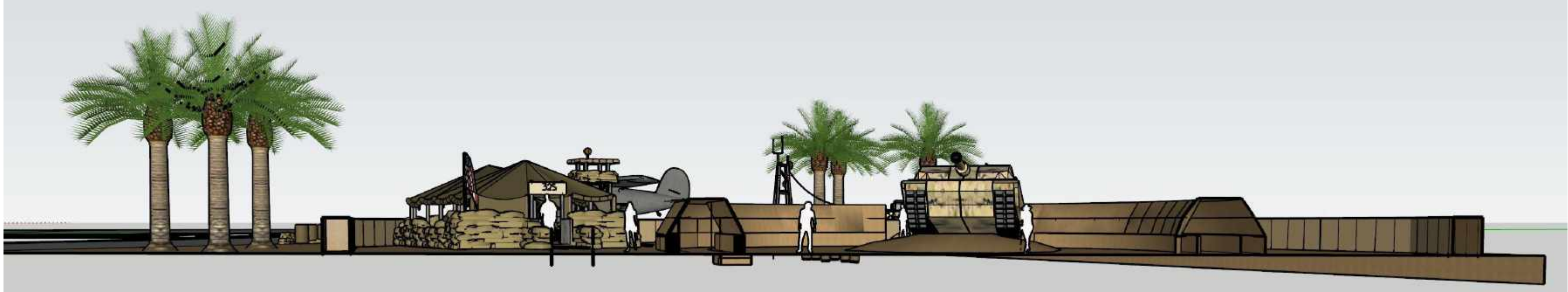

OBJECTIVES:

- HONORS VETERANS OF IRAQ WAR AND ILLUSTRATES TO VISITORS WHAT A FIRE BASE IN IRAQ MAY HAVE LOOKED AND FELT LIKE
- PROVIDES EXHIBITS OF WHAT MIGHT BE FOUND IN AN IRAQ FIRE BASE
- PROVIDES AN ENGAGING AND EDUCATIONAL EXPERIENCE FOR VISITORS



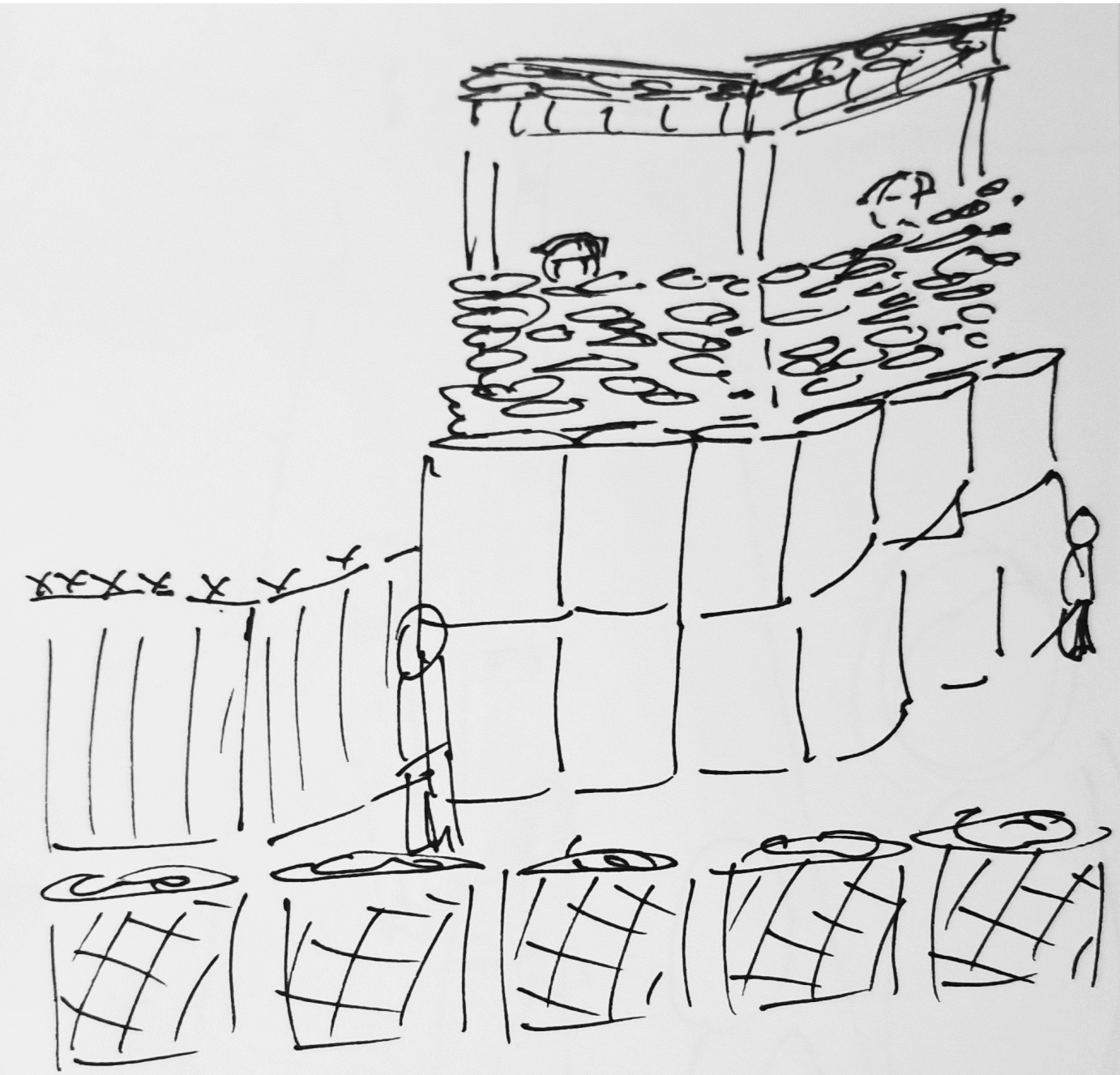

TREES



Phoenix dactylifera
Date Palm
WUCOL L











C-141 EVENT SPACE

- SHADE STRUCTURES
- VERSATILE SEATING AREA
- OPEN VIEWING OF C-141 AIRCRAFT



SOUTH-END CAMP

- PROXIMITY TO RV PARKING AND EXHIBITS
- PICNIC AREA – WITH AND WITHOUT SHADE
- CHILDREN’S PLAY AREA



NEW SIGNAGE - VISIBLE FROM 215 AND INVITING

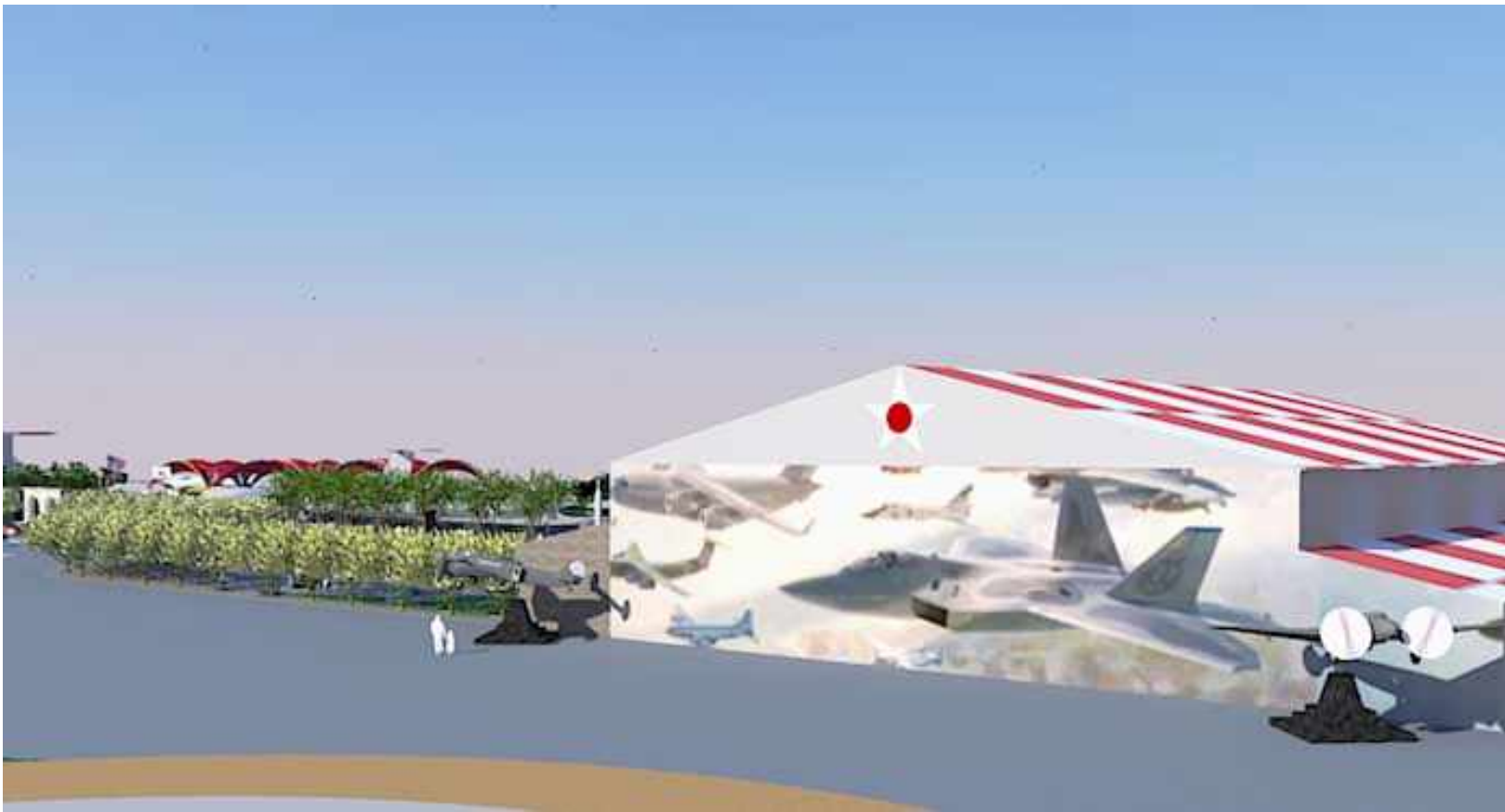

NEW ARTWORK ON MAIN HANGAR AT ENTRANCE TO MUSEUM



VIEW LOOKING NORTH FROM RESTAURANT DECK



VIEW LOOKING SOUTH FROM RESTAURANT DECK





THANK YOU!