

IRRIGATION LEGEND:

IRRIGATION LEGEND

SYM.	MANUFACTURER	MODEL	DESCRIPTION	RADIUS	G.P.M.	P.S.I.
⊙	RAINBIRD	1804-SAM-PRS-R-VAN14-90	POP-UP-SPRAY HEAD	10'	0.32	45
⊙	RAINBIRD	1804-SAM-PRS-R-VAN14-180	POP-UP-SPRAY HEAD	10'	0.63	45
⊙	RAINBIRD	1804-SAM-PRS-R-VAN14-210	POP-UP-SPRAY HEAD	10'	0.73	45
⊙	RAINBIRD	1804-SAM-PRS-R-VAN14-360	POP-UP-SPRAY HEAD	10'	1.27	45
⊙	RAINBIRD	1804-SAM-PRS-5000-MPR-25-Q	ROTOR	25'	1.00	45
⊙	RAINBIRD	1804-SAM-PRS-5000-MPR-25-T	ROTOR	25'	1.38	45
⊙	RAINBIRD	1804-SAM-PRS-5000-MPR-25-H	ROTOR	25'	1.98	45
⊙	RAINBIRD	1804-SAM-PRS-5000-MPR-25-F	ROTOR	25'	3.82	45
⊙	RAINBIRD	1812-SAM-PRS-5000-MPR-25-Q	ROTOR	25'	1.00	45
⊙	RAINBIRD	1812-SAM-PRS-5000-MPR-25-T	ROTOR	25'	1.38	45
⊙	RAINBIRD	1812-SAM-PRS-5000-MPR-25-H	ROTOR	25'	1.98	45
⊙	RAINBIRD	1812-SAM-PRS-5000-MPR-25-F	ROTOR	25'	3.82	45
⊙	RAINBIRD	1804-SAM-PRS-5000-MPR-30-F	ROTOR	30'	1.40	45
⊙	RAINBIRD	1804-SAM-PRS-5000-MPR-30-Q	ROTOR	30'	1.85	45
⊙	RAINBIRD	1804-SAM-PRS-5000-MPR-30-T	ROTOR	30'	2.96	45
⊙	RAINBIRD	1804-SAM-PRS-5000-MPR-30-H	ROTOR	30'	5.78	45
○	RAINBIRD	1401	FULL CIRCLE BUBBLER		FLOOD	0.25 45

EQUIPMENT	MODEL	DESCRIPTION
⊙		1-1/2" WATER METER - EXISTING
⊙	FEBCO 825Y	2" REDUCED PRESSURE BACKFLOW DEVICE w/ WYE STRAINER 60-MESH AND STAINLESS STEEL STRONGBOX ENCLOSURE
⊙	FEBCO 825YA	3/4" REDUCED PRESSURE BACKFLOW DEVICE w/ STAINLESS STEEL STRONGBOX ENCLOSURE
⊙	WILKENS 500 SERIES	2" PRESSURE REGULATOR
⊙	CALSENSE FM-1.0B	1" FLOW SENSOR
⊙	SUPERIOR 3200-200-RW	2" MASTER VALVE, NORMALLY CLOSED
⊙	NIBCO T-585	LINE-SIZE FULL PORT BRONZE BALL VALVE
⊙	RAINBIRD EFB-CP-PRS-D	REMOTE CONTROL GLOBE VALVE, SIZE AS SHOWN. ADD PRESSURE REGULATOR AS NEEDED
⊙	NETAFIM LVET1GH2	1" GLOBE SERIES 80 VALVE WITH STANDARD 24VAC. ADD PRESSURE REGULATOR AS NEEDED.
⊙	RAINBIRD 44 DLRC	1" QUICK COUPLER POTABLE w/ 2 KEYS 44s-DK
⊙	NETAFIM TLSOV	MANUAL FLUSH VALVE FOR DRIP SYSTEM
⊙	CALSENSE ET3000	CALSENSE 24 STATION STAINLESS STEEL PEDESTAL MOUNTED CONTROLLER ASSEMBLY #ET2000e-48-LR-M-RR-e-SSDR
⊙	NETAFIM 65ARIA100	1" GUARDIAN MPT AIR/VACUUM RELIEF AIR VENT
---	APPROVED SCH. 40 PVC	MAINLINE, SIZE AS SHOWN, MIN. COVER 24"
---	APPROVED SCH. 40 PVC	POTABLE LINE, SIZE AS SHOWN, MIN. COVER 24"
---	APPROVED SCH. 40 PVC	LATERAL LINE, SIZE AS SHOWN, MIN. COVER 12"
---	APPROVED SCH. 40 PVC	SLEEVES, SIZED 2X LARGER THAN PIPE TO BE INSERTED, UNLESS OTHERWISE NOTED
---	APPROVED SCH. 40 PVC	WIRE SLEEVE, SIZE AS REQUIRED, UNLESS OTHERWISE NOTED.

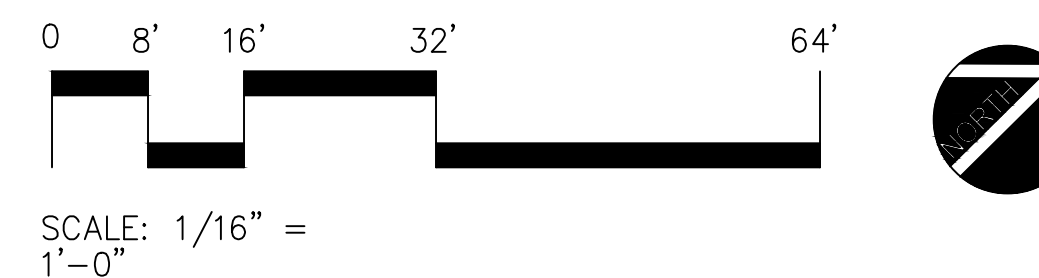
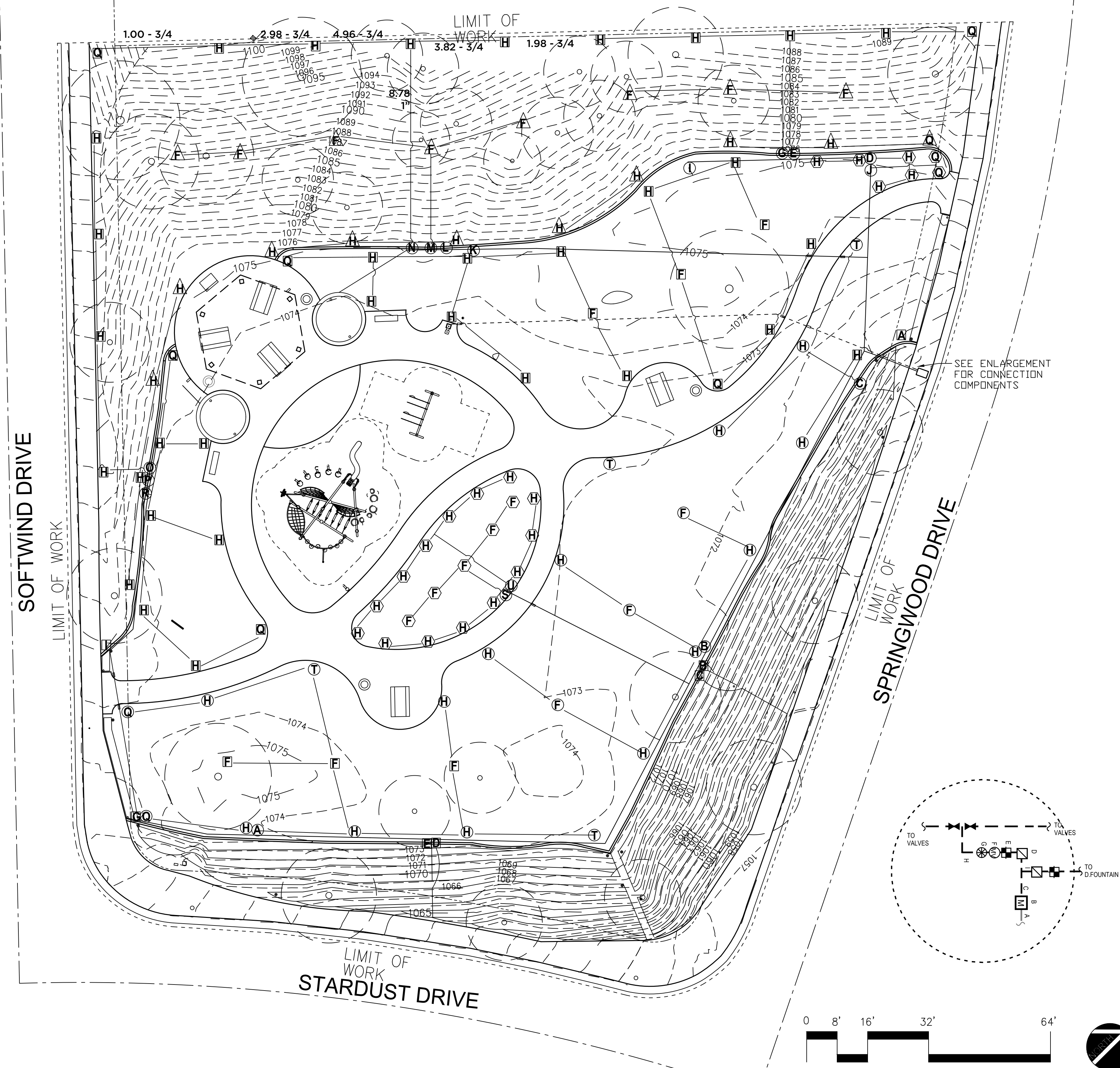

IRRIGATION NOTES:

THE CONTRACTOR SHALL PROVIDE ALL LABOR, MATERIALS, AND MAINTENANCE REQUIRED TO INSTALL A COMPLETE IRRIGATION SYSTEM, THAT IS OPERABLE IN AN EFFICIENT AND SATISFACTORY MANNER PROVIDING COMPLETE AND EVEN COVERAGE. ALL MATERIALS USED SHALL BE PER PLAN, UNLESS ALTERNATE APPROVED BY THE LANDSCAPE ARCHITECT. PRIOR TO INSTALLATION, THE CONTRACTOR SHALL CHECK AND VERIFY ALL SITE CONDITIONS, UTILITIES AND SERVICES. THE CONTRACTOR SHALL REPORT ANY OBSTRUCTIONS, GRADE DIFFERENCES, OR MEASUREMENT DISCREPANCIES TO THE LANDSCAPE ARCHITECT. IN THE EVENT THAT THIS NOTIFICATION IS NOT PERFORMED, THE CONTRACTOR SHALL ASSUME FULL RESPONSIBILITY FOR ANY REVISION NECESSARY. ALL VALVES SHALL BE LOCATED IN PLANTING AREAS. MAIN LINE AND LATERAL LINES MAY BE PLACED IN THE SAME TRENCH AND IN PLANTING AREAS PER PLAN. PROVIDE MINIMUM HORIZONTAL CLEARANCE OF 4" BETWEEN PARALLEL PIPES. ALL PIPING, PVC ELECTRICAL SLEEVES, ETC. UNDER PAVING SHALL BE INSTALLED AND TESTED PRIOR TO PAVING WORK. THE CONTRACTOR SHALL FOLLOW MANUFACTURER'S INSTALLATION INSTRUCTIONS. PIPING AND SPRINKLER HEADS SHALL BE INSTALLED PER PLAN. ALL MAINLINES SHALL BE CAPPED AND TESTED AT 125 PSI FOR TWO HOURS. ALL LATERAL LINES SHALL BE PRESSURE TESTED AT SYSTEM DESIGN PRESSURE FOR ONE HOUR. ANY LEAKS FOUND SHALL BE REPAIRED, BY REMOVING THE LEAKING PIPE OR FITTINGS AND REPLACING THEM WITH NEW MATERIAL. PRIOR TO INSTALLING HEADS, ALL PIPES SHALL BE FLUSHED OUT WITH THE MAXIMUM PRESSURE OF WATER. RISERS TO SPRINKLER HEADS, QUICK COUPLER VALVES, AND CONTROL VALVES WITH STEMS SHALL BE SET PERPENDICULAR TO FINISH GRADE. INSTALL ALL MAINLINES 18" BELOW GRADE AND LATERAL LINES 12" BELOW GRADE. ALL PIPE UNDER PAVING TO BE IN SLEEVES 18" BELOW GRADE. LAY PIPES TO AN EVEN GRADE. INITIAL BACKFILL TO BE FINE GRANULAR MATERIAL WITH NO FOREIGN OBJECTS LARGER THAN 1/2" DIAMETER. TAMP MOIST BACKFILL TO COMPACT AND CONFORM TO ADJACENT GRADES WITHOUT SUNKEN AREAS OR OTHER IRREGULARITIES. WRAP ALL MAINLINE MALE PIPE THREADS WITH TEFLON TAPE. SPRINKLER HEADS ARE AVAILABLE IN VARYING DEGREES OF ARCS. CONTRACTOR SHALL PROVIDE, AT EACH HEAD, THE ARC MOST SUITED TO PROVIDE ADEQUATE COVERAGE AND PREVENT OVER SPRAY ON WALKS, BUILDINGS, ETC. ALL SPRINKLERS AND VALVES SHALL BE ADJUSTED FOR COMPLETE COVERAGE WITH MINIMUM OVERTHROW. ADJUST ALL BUBBLERS TO PREVENT EXCESSIVE FLOODING. INSPECTIONS SHALL BE MADE BY THE LANDSCAPE ARCHITECT AS FOLLOWS: OPEN TRENCHES, COVERAGE TEST, AND FINAL LANDSCAPE INSPECTION. CONTRACTOR SHALL GUARANTEE IRRIGATION SYSTEM FOR A PERIOD OF ONE YEAR AGAINST DEFECTIVE EQUIPMENT, INSTALLATION DEFICIENCY, AND ALL PROBLEMS NOT RELATED TO VANDALISM. CONTRACTOR SHALL CLEAN UP SITE AS EACH PORTION OF WORK PROGRESSES. REFUSE AND EXCESS DIRT SHALL BE REMOVED FROM THE SITE. ALL WALKS AND PAVING SHALL BE SWEEPED AND ANY DAMAGE TO OTHER WORK SHALL BE REPAIRED. COMPLETE SYSTEM SHALL BE MAINTAINED FOR 60 DAYS AFTER COMPLETION OF PLANTING. SYSTEM SHALL BE FLUSHED AND AUTOMATIC CONTROLLER RESET AT COMPLETION OF 60 DAY MAINTENANCE PERIOD. PROVIDE INSTRUCTION TO OWNER FOR IRRIGATION CONTROLLER OPERATION.

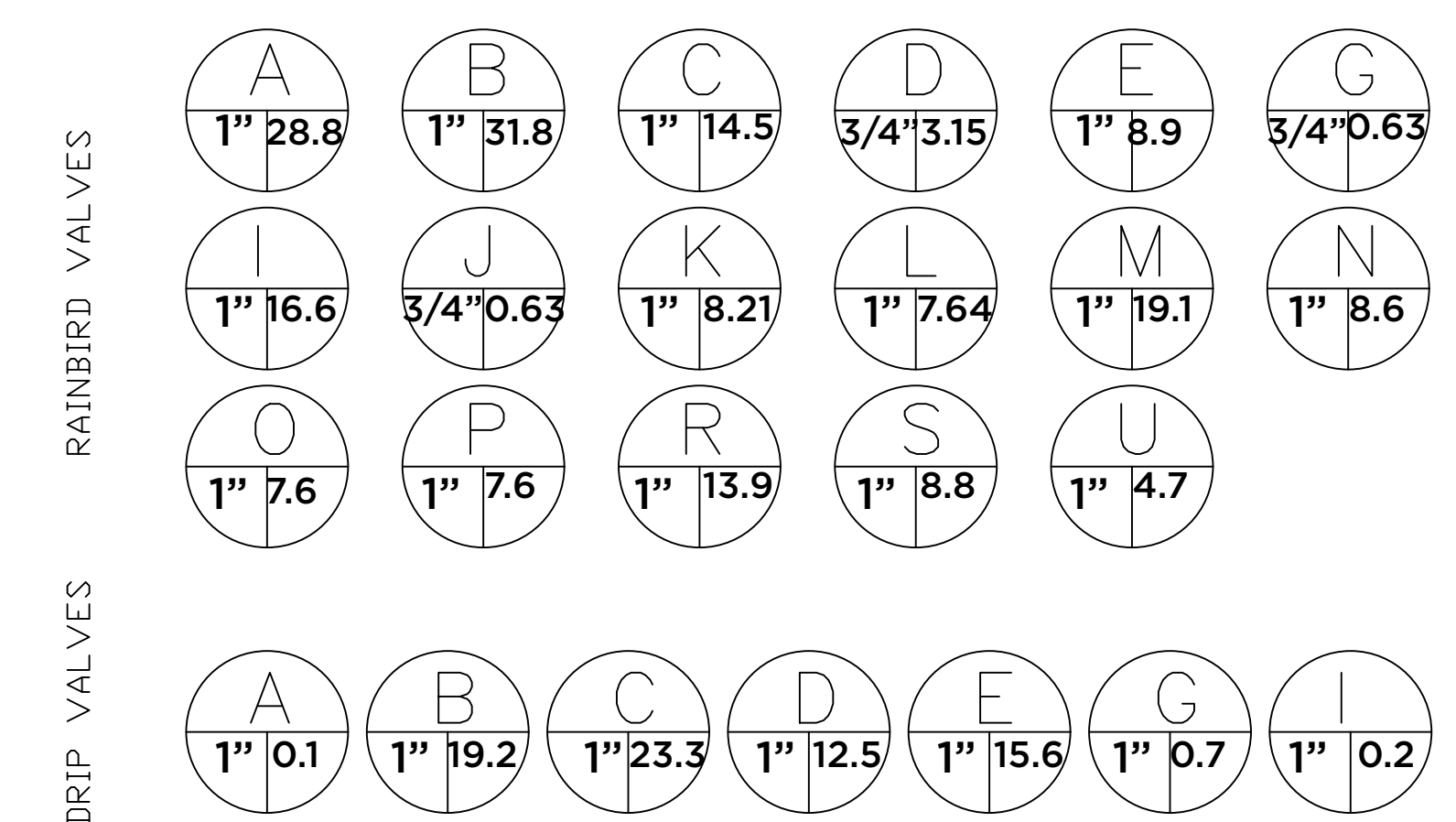

STARDUST
123 FAKE STREET
CHAMLEE INC.
RANCHO
CUCAMONGA, CA

IRRIGATION PLAN
PROCESSED BY AN AUTODESK STUDENT VERSION

RACHAEL DWORK

JEFF CHAMLEE

09/09/2020

1/16" = 1'-0"

1

L-1.1
01 OF 01 SHTS.